

SearchCam® 3000 – Technical Search and Rescue Cameras

The SearchCam® 3000 is designed to locate victims trapped in collapsed buildings. Its articulating waterproof camera head with LED lighting helps pinpoint the victims location so rescuers can extract them.

The SearchCam®'s on-screen graphics help direct rescue teams where to find victims and how to begin extraction. The two-way audio allows rescuers to communicate directly with victims. Rescuers can record audio and video, as well as take still photos during the search.

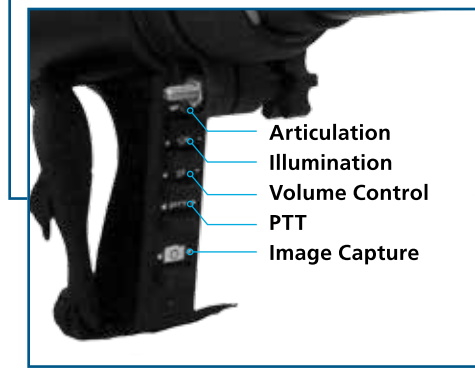
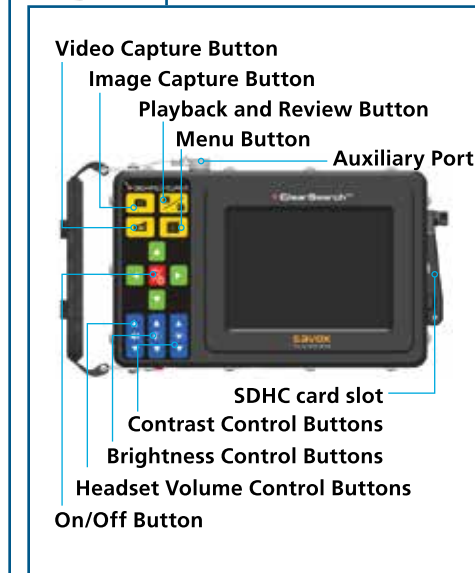

Extension Tube



Long Tube Set

- Key Benefits**
- Rugged, reliable and versatile
 - Lightweight
 - Modular
 - Quick-disconnect cameras – switch from color to infrared
 - Records video, voice and still images
 - 240° articulating camera head
 - Waterproof camera – up to 75' (23 m)
 - Expandable tube sets – camera extends from 92 inches to 223 inches (234cm to 566cm)

1 ClearSearch™ Video Display Unit (VDU) with Quick Disconnect

The primary control unit for the SearchCam® 3000, coiled cable allows for the VDU to be positioned up to 6 feet (2 meters) away from the power module. A second screen can be connected to the auxiliary port for training purposes.

2 Power Module with Lithium Ion Batteries

Interchangeable with the Delsar® Life Detector® batteries.

3 Interchangeable Tube Sets

The SearchCam® 3000 is modular and can be configured to meet a variety of rescue situations using the standard tube set (shown) which extends the reach to 92" (234 cm). By using the optional long tube set and extension tube the reach can be extended to 223" (566 cm).

4 Communicate with the Victim

The speaker and microphone housed in the camera head provide two-way communication between the rescuer and the victim.

5 Quick Disconnect Camera Heads

An innovative quick disconnect camera feature provides rescuers with imaging flexibility — a full resolution color camera with LED lighting or black and white imaging with infrared lighting. Designed to fit through a two-inch hole.

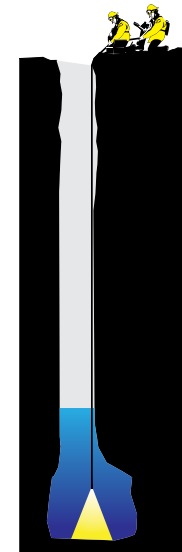

Waterproof Detachable Camera Head

The camera can be lowered into dusty, harsh and wet void spaces such as trenches, sewers, tunnels and elevator shafts, providing teams with a clear well lit view of the search area below.

SearchCam® Technical Comparison

Product Feature	Recon III	SearchCam® 3000
Battery Type	Internal Lithium Ion Stick	Internal Lithium Ion Stick
Illumination	16 white High Output LED	16 white High Output LED with Multiple Levels
System Length	43"-56.5" (109-143.5cm)	Telescopes 41"-92" (104.3cm-234cm)
System Weight	7.5lb (3.40kg)	10lb (4.53kg)
ClearSearch™ Video Display Unit	5" LCD Resolution: 320 x 234	5.75" LCD Resolution: 640 x 480
Second Screen Connectivity	No	Yes
Waterproof Head	Yes, IP68	Yes, IP68
Two-Way Audio	No	Yes
Camera Head Articulation	240°	240°
Interchangeable Camera Heads	Yes	Yes
Interchangeable Tube Set	No	Yes
Extension Cable	No	Yes

New Features of SearchCam® 3000

***Additional Features for existing customers**

New ClearSearch™ Video Display Unit

- Improved visibility in confined space and sunlight
- Extended operational search capability
- Adaptive screen for changing environments

New Blue Lithium-Ion Battery

- Increased work time & battery life
- Replaces old batteries
- Enhanced operational efficiency

New XtraCharge™ Firmware

- Maximize use of new battery performance
- Firmware upgradable by end user
- Existing batteries will have minor improvements through new firmware



**SearchCam® 3000 Kit 1
6000-11-001 includes:**

- 1 x Power Module
- 1 x Standard Length Tube Set
- 1 x Standard Length Coiled Coax Cable
- 1 x Gearbox/Audio Module
- 1 x Environmental Sleeve for Audio Module
- 1 x Color Camera
- 1 x ClearSearch™ Video Display Unit (VDU)
- 1 x Headset
- 1 x 4GB SDHC Card
- 1 x Waterproof Storage Case with Foam
- 1 x 75 foot (23m) Camera Extension Cable
- 1 x 70 foot (21m) Rope with Carabineer
- 1 x Camera Head Rope Coupler
- 4 x Lithium Ion Blue Battery Sticks
- 1 x Gang Charger
- 1 x Power Supply with Cord for Gang Charger
- 1 x Shoulder Sling
- 3 x Tube Strap
- 1 x VOID Orientation Guide
- 1 x Operational Manual
- 1 x Tube of Grease
- 1 x Warranty Card

**SearchCam® 3000 Kit 2
6000-11-002 includes:**

- 1 x SearchCam® 3000 Kit1
- 1 x Long Tube Set
- 1 x Extension Tube
- 1 x Long Coiled Coax Cable
- 1 x Infrared Camera



High Noise Headsets

Improved headphones provide clear

audio signal under high noise conditions and are designed so that they can be worn under head gear.

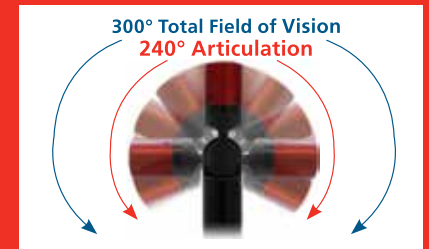

Articulating Camera Head

The rugged, gear-driven camera head with 240° articulation and 300° total field of vision provides greater range of motion and visibility. A clutch-equipped gear box protects the motor and the gears from damage during use. Sealed ball bearings ensures smooth operation with minimal maintenance.



Environmental Sleeve

The Camera Head with the Environmental Sleeve installed, can be submersed in water up to 75 feet (23 meters) deep.

