



**F**  
**FURPHY**  
FOUNDRY EST. 1864

# AQUA-HUB

**W**<sup>TM</sup>  
WaterMark

Supplying water  
to Australian  
communities  
since 1873



[www.furphyfoundry.com.au](http://www.furphyfoundry.com.au)



.....

*For over 156 years, Furphy Foundry has designed and manufactured products that are durable and built to last.*

*Be it agricultural equipment or the famous Furphy water cart that supplied water to Australian communities and soldiers during the early 20th century through to leading urban design furniture, Furphy products have become widely regarded as superior in terms of innovation, durability and functionality.*

*It's no "Furphy" that the tradition of supplying water to Australian communities continues via the 100% Australian made and owned Furphy Aqua-Hub.*

.....



## FEATURES & BENEFITS

- Contemporary, functional and DDA compliant designs compliment public spaces
- Robust steel structure and stainless steel componentry for long life community use
- Innovative and unique pet drinking panel - avoids potential trip hazards, messy footpaths and improves hygiene with fresh running water (doesn't pool/stagnate)
- Bottle filler reduces landfill, making the unit environmentally friendly as well as water efficient and aligns with local government heatwave planning guidelines
- Inspection plates for easy access and maintenance
- Concealed plumbing and internal components
- Laser etched symbols and optional council/park logos that won't wash or fade
- In-ground assembly kit and instructions for easy installation provided
- WaterMark certified (WMK26602, WMTS105:2016) to ensure all plumbing componentry complies with state and territory plumbing codes
- In-line backflow prevention device that protects potable water supplies from contamination/pollution and improves water safety



# AQUA-HUB

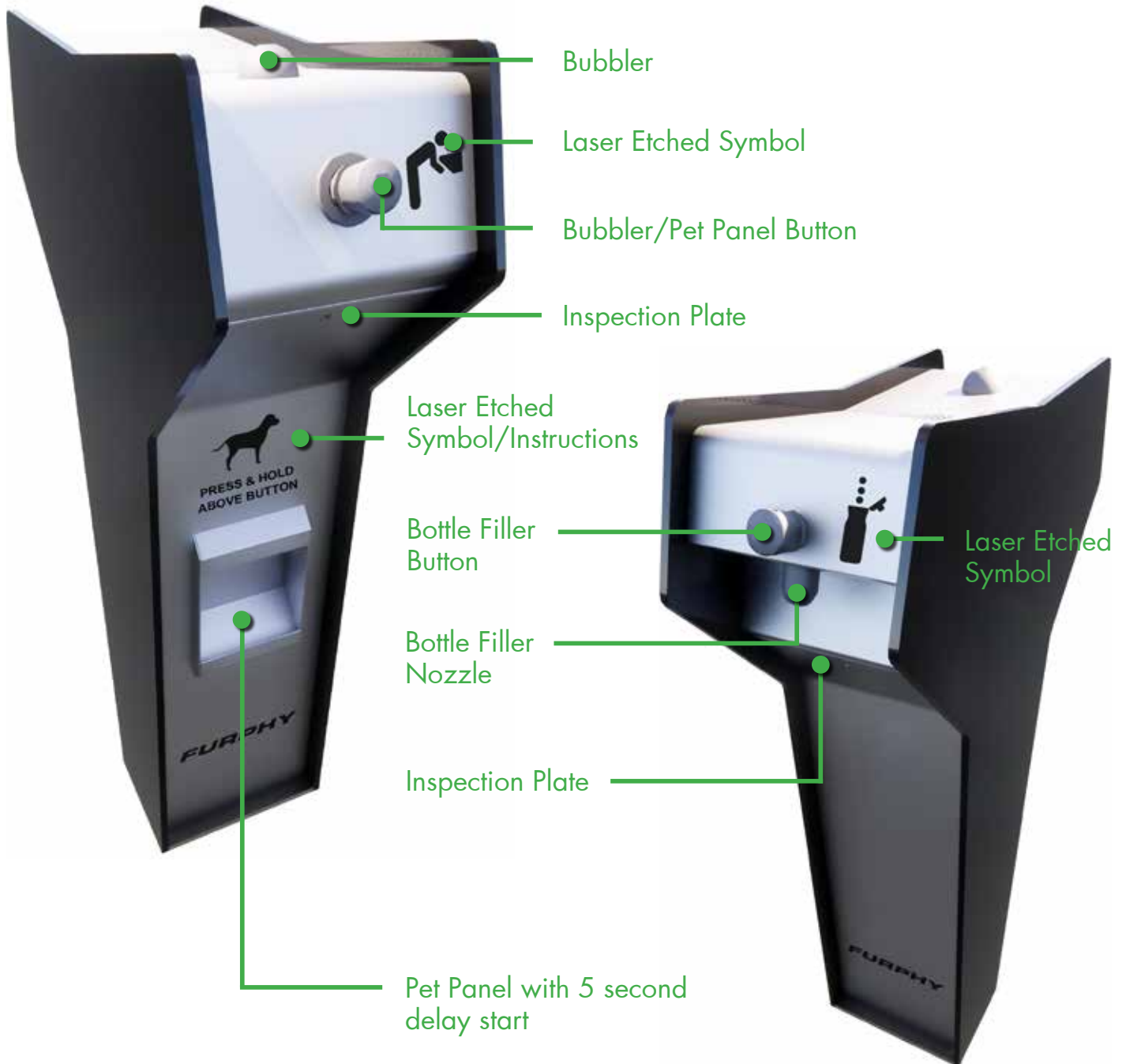

OPTIONS	BUBBLER	PET PANEL	BOTTLE FILLER	IN-GROUND FIXINGS
FFSB009020	✓	-	-	✓
FFSB009021	✓	-	✓	✓
FFSB009022	✓	✓	-	✓
FFSB009023	✓	✓	✓	✓



Standard powder coat colour range, additional powder coat colours available upon request, galvanised/stainless options for coastal applications

# ♿ DDA COMPLIANT AQUA-HUB

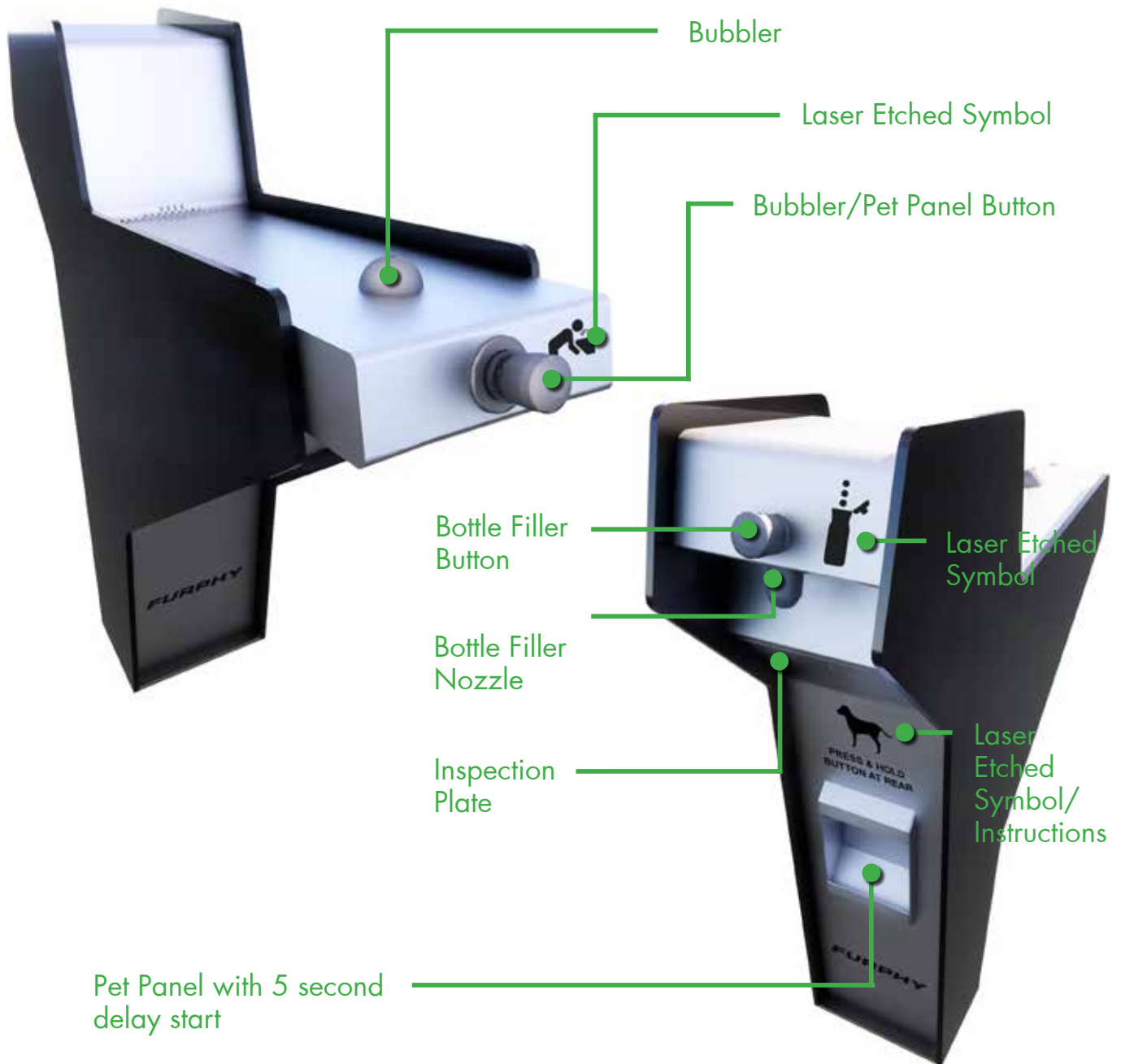

OPTIONS	BUBBLER	PET PANEL	BOTTLE FILLER	IN-GROUND FIXINGS
FFSB009030	✓	-	-	✓
FFSB009031	✓	-	✓	✓
FFSB009032	✓	✓	-	✓
FFSB009033	✓	✓	✓	✓

# DIMENSIONS

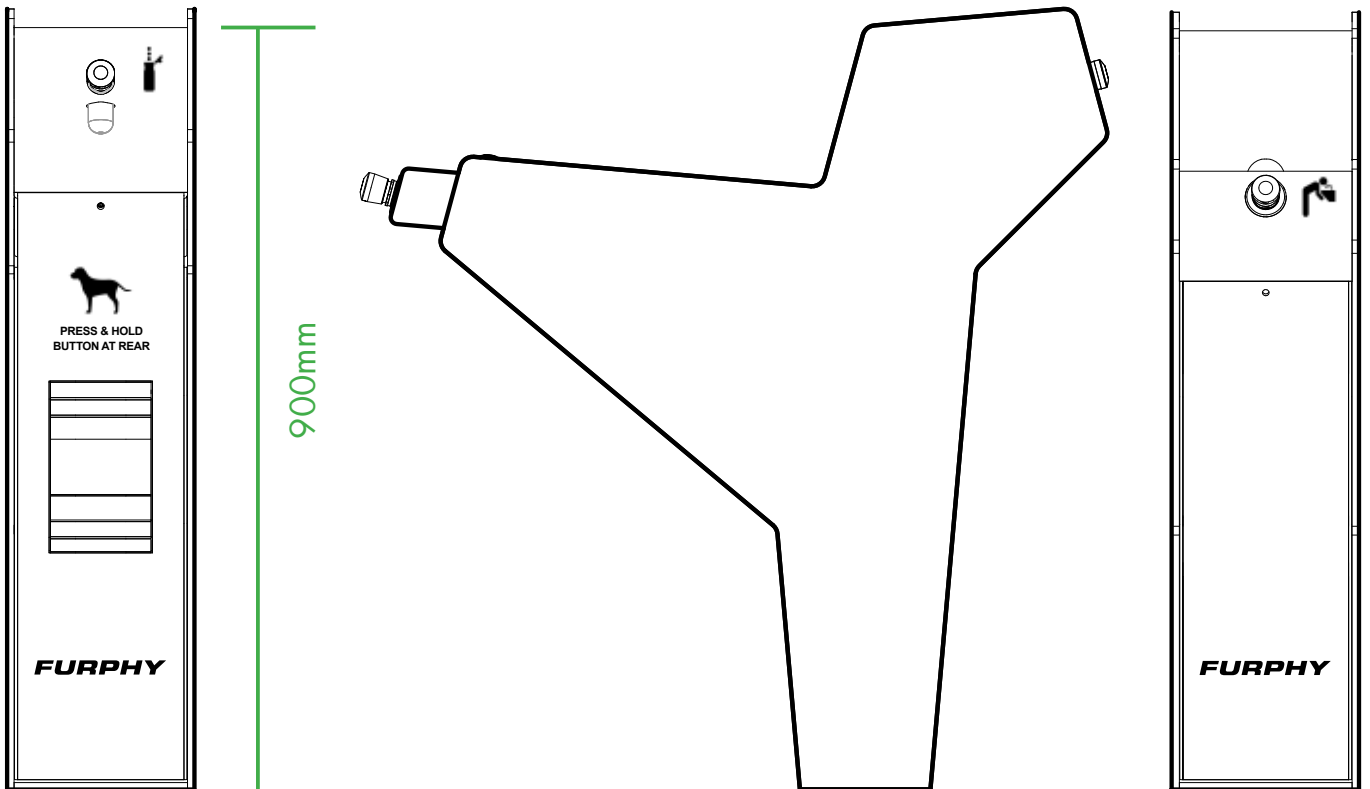
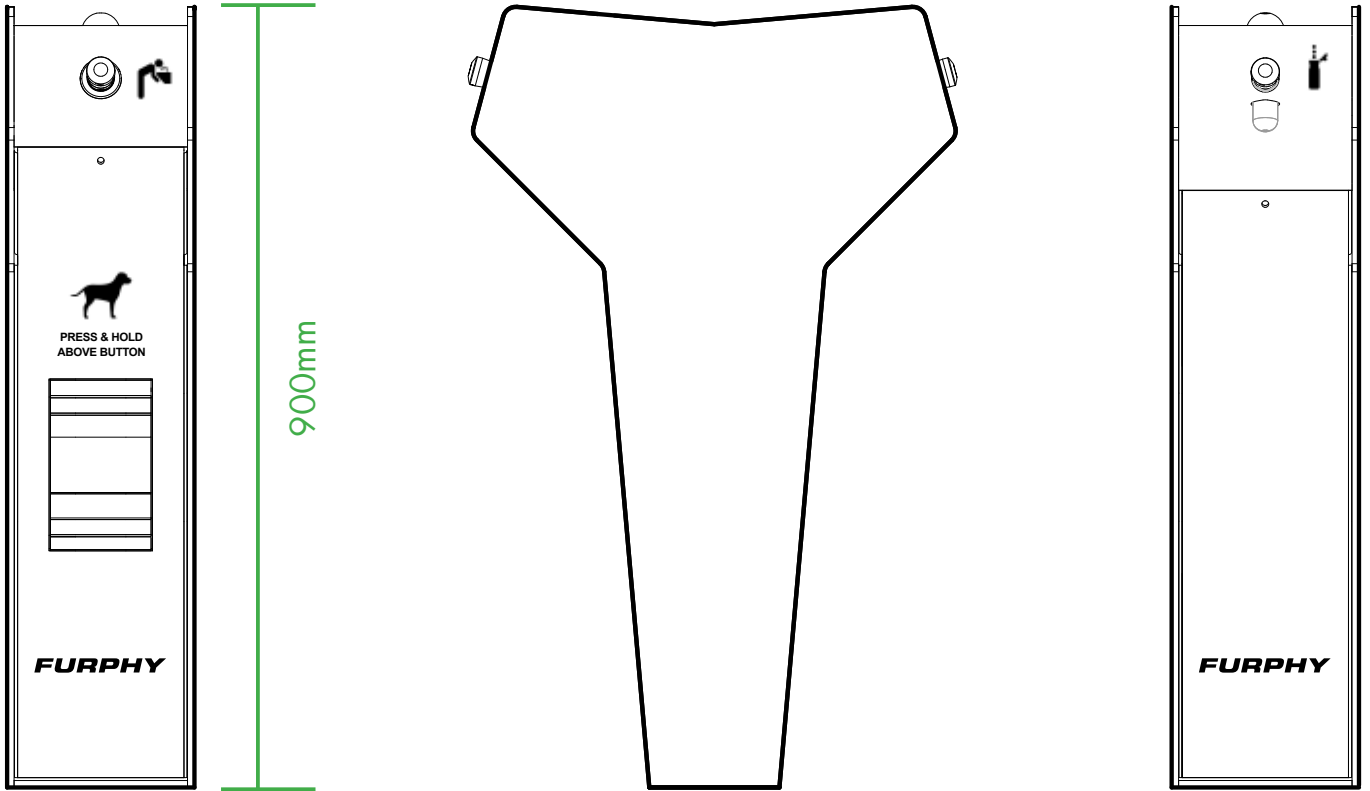

# IN-GROUND FIXINGS

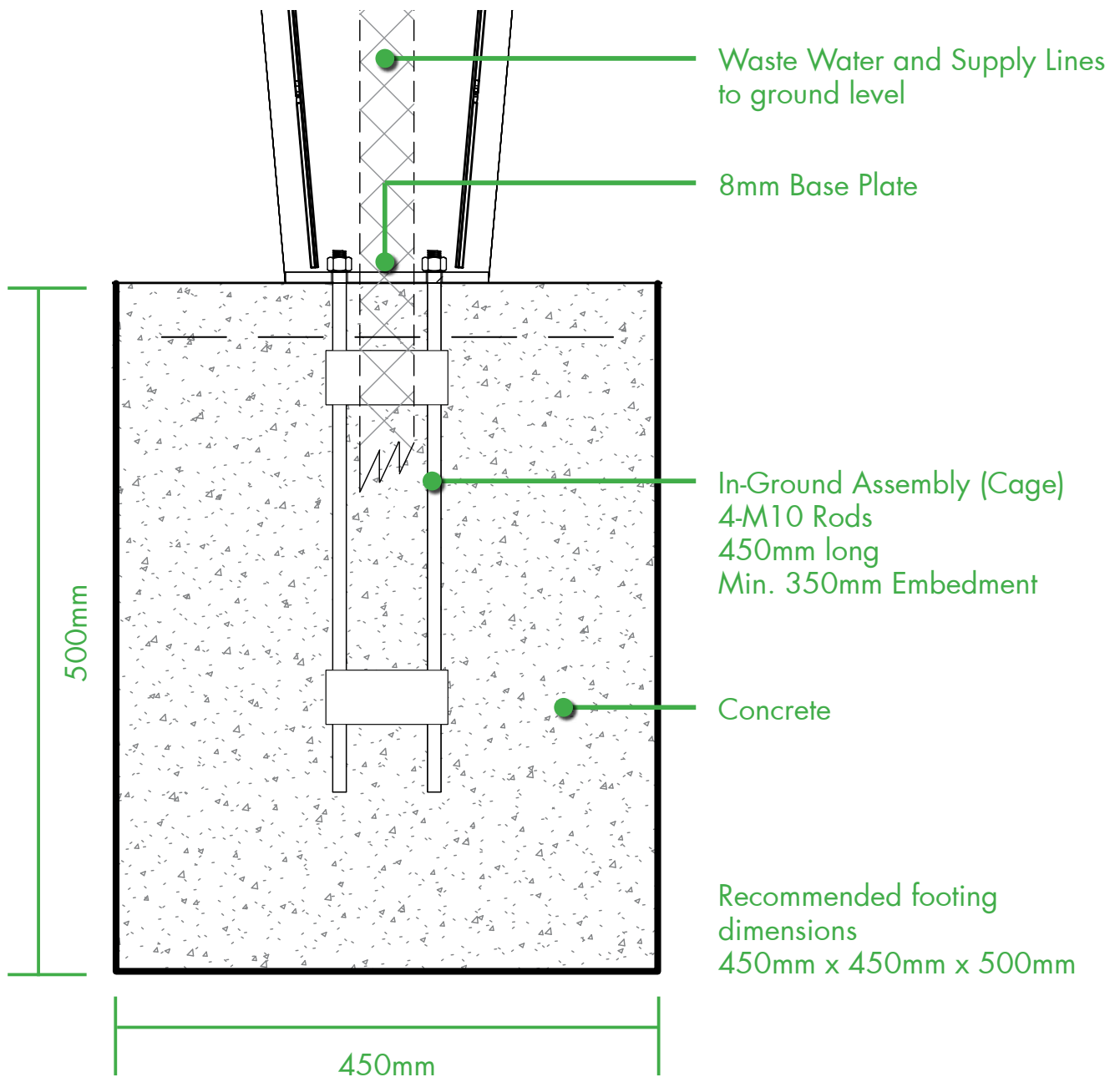



Our range of Furphy Aqua-Hub Drinking Fountains have been created to provide safe, clean and cost effective public drinking facilities that are ideal for public environments.

Hand-made in Australia at the Australian owned Furphy Foundry in Shepparton, each Furphy Aqua-Hub Drinking Fountain has been manufactured under strict quality guidelines based on a commitment developed since 1864.

Furphy Foundry Drinking Fountains have been tried and tested throughout Australia in a range of applications with exceptional results. There are 4x standard and 4x DDA compliant designs available to choose from in the Furphy Aqua-Hub range - WaterMark certified (WMK26602, WMTS105:2016) to ensure all plumbing componentry comply with state and territory plumbing codes

Each unique design has its own set of features, enabling the Furphy Aqua-Hub to be matched with other assets and integrated into public environments.



Call 1300 768 230  
or visit our website  
[furphyfoundry.com.au](http://furphyfoundry.com.au)  
for more info

