

# In Wall Refrigerated Fountain

## DIWR



WaterMark  
WMTS-100  
Lic. WMO0104

Scan QR code  
to view our  
installation notes



### Product Info:

- Sits inside wall cavity
- In built refrigeration unit
- Supplied pre-plumbed
- Lockable service cabinet
- Includes bubbler and bottle filler taps
- Concealed plumbing and fixings

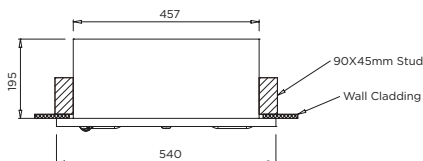

### INSTALLATION NOTES

**1)** Fountain is installed in cavity recess 1475H x 465W x 200D. **2)** Fixing brackets to side of unit affix to inside of wall cavity structure. **3)** Unit is almost freestanding and requires minimal fixings for stability. **4)** Mains water connection to chiller is 1/2" male BSP **5)** Water connection: min = 200kPa, max static = 700kPa. **6)** Fit pressure reducer (not supplied) if pressure exceeds 700kPa. **7)** An in-line filter to prevent debris fouling chiller/outlet is recommended. **8)** Fountain requires access to connect 40mm waste and power supply for 3 pin plug (1.5m lead). **9)** A silicon sealant should be applied to the external perimeter of fountain for additional sealing and securing.

