



Thanks for choosing our product, Please read the manual carefully before use

Technical Specifications

Capacity: 3.6V/38400mAh/138.24Wh
Battery pack capacity: 14.4V/9600mAh/138.24Wh
INPUT:
DC Input:12-24V/3A(Max) Max Solar charging: 60W
USB-C Input: DC5V/3A 9V/3A 12V/3A 15V/3A 20V/3A
OUTPUT:
Cigare Lighter Socket output:12-16V / 10A(max)
USB Output: 5V/3A 9V/2A 12V/1.5A
USB-C Output: DC5V/3A 9V/3A 12V/3A 15V/3A 20V/3A
DC Output: 12V/5A 16.5V/4A 20V/3.5A 24V/3.5A
Measure: 185*121*40mm
N.W: 836.3g

Identification of parts

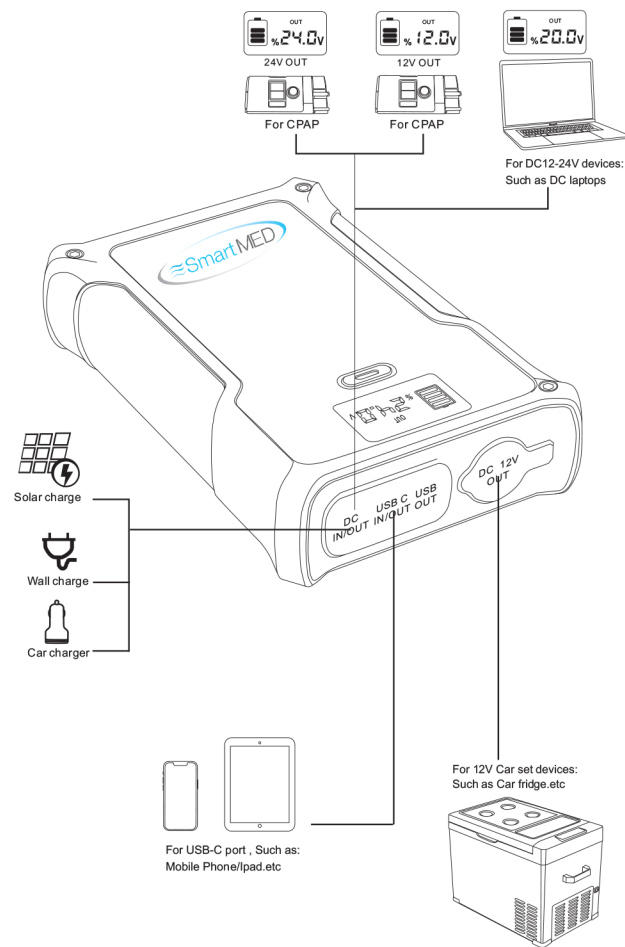
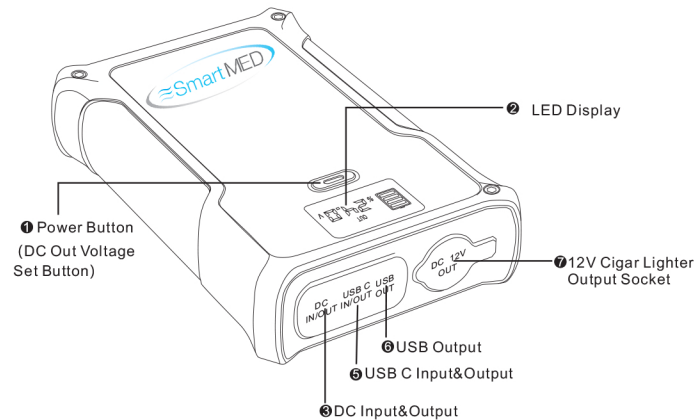

Recharge Power Bank

Use the DC③ Port or USB-C⑤ Port to charge the power bank

1. Please use the standard adapter or solar panel or car charger to charge the power bank
2. Charging Time: It takes about 4 hours to fully charged the power bank with the standard adapter. Solar panel charging is related to solar panel power and sun light intensity, supports Max 60W solar power charging
3. Usage: After the adapter is inserted into the DC③or USB-C⑤. The LED screen displays② IN, The battery's LED power display light flashed. The display stop flashing when the power bank fully charged

LED Display

The digital display screen② shows the power bank battery level:
One grid means 25% battery Power,
Two grid means 50% battery power level,
Three grid means 75%,
Four grid means 100% battery power level (as shown in the picture).



Charge your digital devices

1. USB⑥ and USB C⑤ are suitable for charging mobile phones, tablet and other digital devices.
2. The power bank can automatically charge the device when the devices connected. If the device cannot be charged, Recheck the cable and connection and press the power button①.

Power to other DC input devices

1. Before charging the DC device, Pls choose the correct cable and proper discharging port.
2. After long pressing the voltage button ① for 3 seconds, the voltage on the digital display screen ② will flash and stay on each voltage for 5 seconds. The voltage display show as follow:12V,16.5V,20V,24V, Please select the Correct working voltage according to your equipment
3. When the flashing voltage value is not suitable for your equipment, Please click the voltage adjustment button to adjust the voltage you need. When the voltage stops flashing, the DC③ port is working. The DC③ output will be shut down, If the DC③ interface does not connect the device within 2 hours
4. The DC③ port is suitable for powering CPAP, laptops and other devices

Readjust the working voltage: The operation methods are as follows:

1. Press for 3 seconds to turn off the output. Press and hold for 3 seconds to adjust the voltage
2. Long press the voltage adjustment button again to select the Working voltage when the display voltage pulsates

12V Cigar lighter socket output

1. 12V devices Supported: Car refrigerator/inflator pump, UAC battery/outdoor tent light/ Camp light/ fishing light/hunting light/fan and other devices which under 150W.
2. Plug the devices into 12V cigar lighter socket.
3. The Socket will automatically power the connected device.
4. To Turn off the devices & unplug it from the power pack.

Note: The working voltage of the cigarette lighter is 12-16.8V

For equipment whose starting voltage is slightly lower than the highest voltage of the power bank Cigar lighter socket, If the power bank fully charged, Some of devices will automatically protect against startup and you can't start the device. (For example: Airmini original car charger) Please use other interfaces to discharge properly.

Usage Notes

1. The DC and Type-c ports cannot work simultaneously
2. Unplug the charging cable when charging has completed .
3. It is recommended to use the battery pack in the environment of charging temperature from 0°C to 45°C and discharging temperature from -20°C to 55°C. To avoid irreparable damage to the built-in battery.
4. Use original or authorized cable only.
5. If the power bank is not in frequent use, it is recommended to recharge the power bank every six months.
6. Keep away from liquids. Stop using if it is wet to avoid fire hazards, battery leakage, electric shock or explosion.
7. After the DC output is turn on, the output will be automatically closed after 2 hours without load. You can also press the button for 3 seconds manually to turn off the DC out .
8. Keep away from high temperatures .
9. Never try to dismantle, repair or refit this unit by yourself.
10. Do not knock this product, Avoid dropping .
11. Do not clean this unit with soap or other detergent to avoid damaging .
12. Stop using immediately if deformation, breakage, overheating or abnormal odor occurs.
13. Keep away from flammables, smoke and heat surface .
14. Keep out of reach of children .
15. Dispose this product as per local law and regulations

FAQ

Q1. What's the max discharging power of this power bank ??

A1. Yes, but the total power does not exceed 150W. It is recommended not to connect DC③ when the 12V cigarette lighter⑦ port is working at full load.

Q2. What should we do if the power bank can't recharge?

A2. Please check the charging adapter is connected correctly and the 100v-240v AC charging is enabled, if the problem still exists, please contact the supplier for more professional advices.

Q3. What should we do if the power supply cannot charge other devices?

A3. Please Check the charging line is inserted in the correct port, or check whether the output of this power supply is compatible with the voltage of electronic devices. Refer to your device's manual, product label, or adapter

Warranty

We provide customer with a comprehensive warranty of 12 months from the date of purchase.

