

Technical Data

BySmart Fiber

	BySmart Fiber 3015	BySmart Fiber 4020	
Length	10495	12765	mm
Width	6903	7535	mm
Height	2880	2880	mm

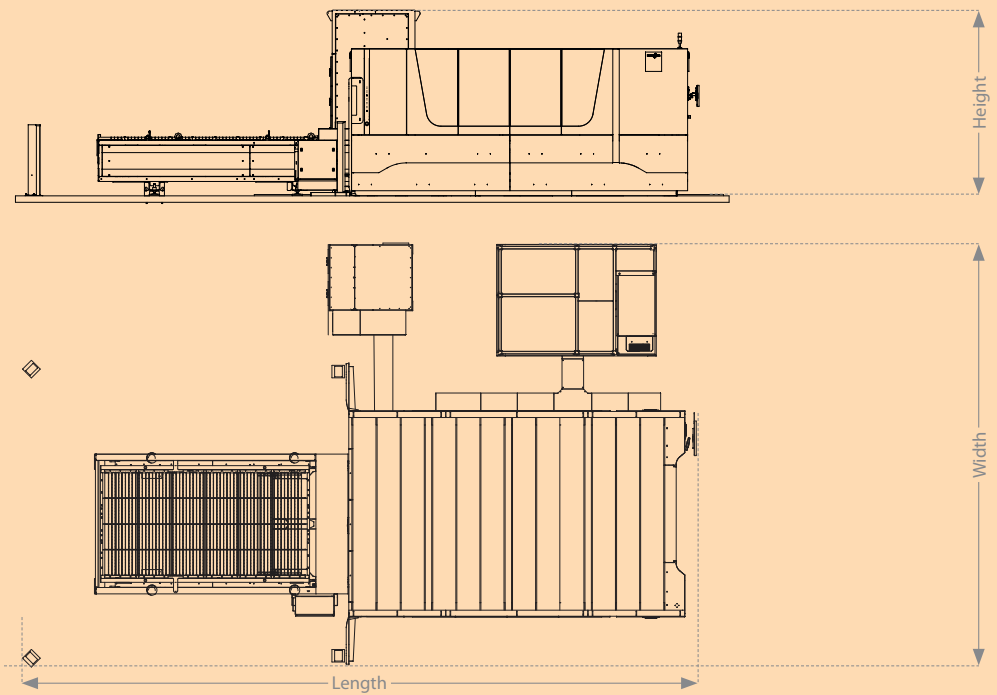

Laser cutting system		BySmart Fiber 3015	BySmart Fiber 4020	
Nominal sheet size	x	3000	4000	mm
	y	1500	2000	
Cutting area	x	3106	4120	mm
	y	1582	2110	
	z	100	100	
Maximum positioning speed parallel axis x, y		100	100	m/min
Maximum simultaneous positioning speed		140	140	m/min
Bilateral repeatability of positioning of one axis R*		0,05	0,05	mm
Averaged, bilateral position deviation of one axis M*		0.1	0.1	mm
Edge detection accuracy		± 0,5	± 0,5	mm
Maximum workpiece weight		1100	1900	kg
Machine weight**		11 800	14 800	kg
Table change over time		27	36	s
Operation via panel		ByVision Cutting Touchscreen and manual control unit		

Laser source	Fiber 2000	Fiber 3000	Fiber 4000	Fiber 6000	Fiber 8000	Fiber 10000	
Power	2000	3000	4000	6000	8000	10000	W
Control range	200–2000	300–3000	400–4000	600–6000	800–8000	1000–10000	W
Wavelength	Fiber	Fiber	Fiber	Fiber	Fiber	Fiber	
Maximum sheet thicknesses***							
Steel	12	20	20	25	25/30 ^{a)}	25/30 ^{a)}	mm
Stainless steel	6	12	15	30	30	30	mm
Aluminum	8	12	15	30	30	30	mm
Brass	4	6	8	15	15	15	mm
Copper	3	6	8	12	12	12	mm
Total electrical consumption of system****							
BySmart Fiber 3015	17	18	19	20	24	25	kW
BySmart Fiber 4020	–	19	20	21	27	28	kW

* Following ISO 230-2:2014(E)

** Entire system without exhaust and chiller

*** In order to cut the maximum thicknesses, the following conditions must be met

– optimally maintained and adjusted laser cutting systems

– the materials must be of the quality specified by Bystronic (laser materials)

**** Entire system with exhaust and chiller: Electrical consumption data shows an average value based on 4 reference cutting plans of mild steel between 1–10 mm thickness

a) with option BeamShaper

The right to make changes to dimensions, construction, and equipment is reserved. ISO-9001-certified.



Bystronic: Best choice.

Cutting | Bending | Automation
bystronic.com