

TOILET PAPER DISPENSERS

WASHROOM ACCESSORIES

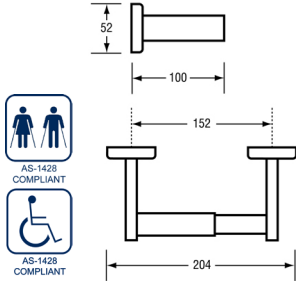

BTX-06-015

S.S. Single Roll Toilet Paper Dispenser

SIZE W 204 x H 52 x D 100mm

MATERIAL #304 Satin Stainless Steel Mounts, Chrome Plated ABS Roller, Satin Stainless Finish

MOUNTING Surface Mount Concealed Fix
CAPACITY Holds one standard toilet roll

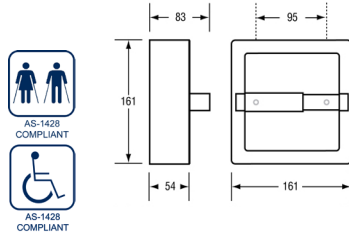

BTX-06-021

S.S. Surface Mounted Toilet Tissue Dispenser - No Hood

SIZE W 161 x H 161 x D 83mm O/A

MATERIAL #304 Stainless Steel Body, Chrome Plated Die Cast Zamak Brackets & ABS Roller, Satin Stainless Finish

MOUNTING Surface Mount Visible Fix
CAPACITY Holds one standard toilet roll

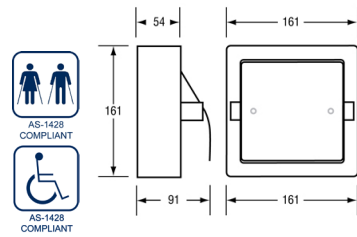

BTX-06-025

S.S. Surface Mount Toilet Tissue Dispenser Hooded

SIZE W 161 x H 161 x D 91mm O/A

MATERIAL #304 Satin Stainless Steel Mounts, Chrome Plated ABS Roller, Satin Stainless Finish

MOUNTING Surface Mount Visible Fix
CAPACITY Holds one standard toilet roll

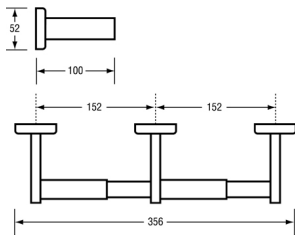

BTX-06-017

S.S. Double Roll Toilet Paper Dispenser

SIZE W 356 x H 52 x D 100mm

MATERIAL #304 Satin Stainless Steel Mounts, Chrome Plated ABS Roller, Satin Stainless Finish

MOUNTING Surface Mount Concealed Fix
CAPACITY Holds two standard toilet rolls

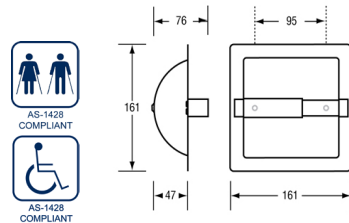

BTX-06-019

S.S. Recessed Toilet Tissue Dispenser - No Hood

SIZE W 161 x H 161 x D 76mm O/A

WALL OPENING W 140 x H 140 x D 51mm
MATERIAL #304 Stainless Steel Body, Chrome Plated Die Cast Zamak Brackets & ABS Roller, Satin Stainless Finish

MOUNTING Recessed Mount Visible Fix
CAPACITY Holds one standard toilet roll

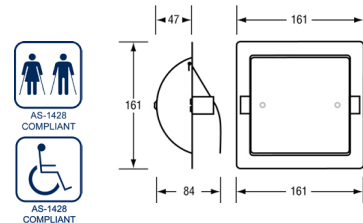

BTX-06-023

S.S. Recessed Toilet Tissue Dispenser Hooded

SIZE W 161 x H 161 x D 84mm O/A

WALL OPENING W 140 x H 140 x D 51mm
MATERIAL #304 Stainless Steel Body, Chrome Plated Die Cast Zamak Brackets & ABS Roller, Satin Stainless Finish

MOUNTING Recessed Mount Visible Fix
CAPACITY Holds one standard toilet roll

VISIT BRITEX.COM.AU TO DOWNLOAD BIM FILES, CAD DRAWINGS AND THE MOST CURRENT PRODUCT LITERATURE.

TOILET PAPER DISPENSERS

TOILET PAPER DISPENSERS

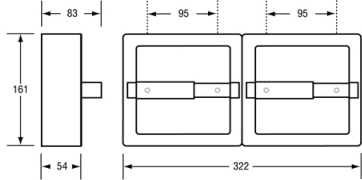

BTX-06-028

S.S. Surface Mount Double Roll Toilet Paper Dispenser - No Hood

SIZE W 322 x H 161 x D 83mm
MATERIAL #304 Stainless Steel Body, Chrome Plated Die Cast Zamak Brackets & Chrome Plated ABS Roller, Satin Stainless Finish
MOUNTING Surface Mount Visible Fix
CAPACITY Holds two standard toilet rolls

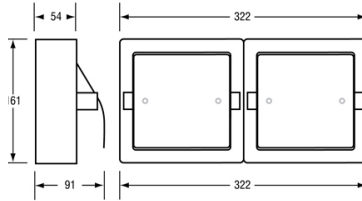

BTX-06-033

S.S. Surface Mount Double Roll Toilet Paper Hooded Dispenser

SIZE W 322 x H 161 x D 91mm O/A
MATERIAL #304 Stainless Steel Body, Chrome Plated Die Cast Zamak Brackets & ABS Roller, Satin Stainless Finish
MOUNTING Surface Mount Visible Fix
CAPACITY Holds two standard toilet rolls

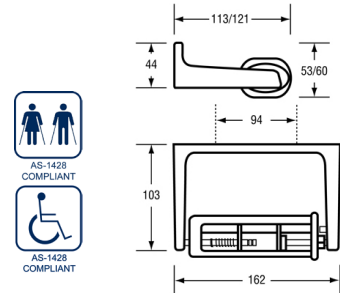

BTX-06-037

Single Roll Toilet Paper Holder

SIZE W 162 x H 44 x D 103mm
MATERIAL Enamel Baked Aluminium Single Mould ABS Holder with Stainless Steel Pins & Spring
MOUNTING Surface Mount Visible Fix
CAPACITY Holds one standard toilet roll
FEATURES Restricted Feed Tamper Resistant Holder

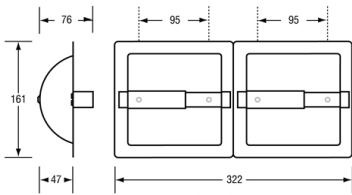

BTX-06-027

S.S. Recessed Double Roll Toilet Paper Dispenser - No Hood

SIZE W 322 x H 161 x D 76mm
WALL OPENING W 299 x H 140 x D 51mm
MATERIAL #304 Stainless Steel Body, Chrome Plated Die Cast Zamak Brackets & ABS Roller, Satin Stainless Finish
MOUNTING Recessed Mount Visible Fix
CAPACITY Holds two standard toilet rolls

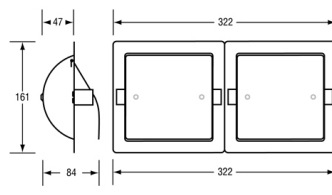

BTX-06-031

S.S. Recessed Double Toilet Tissue Hooded Dispenser

SIZE W 322 x H 161 x D 84mm O/A
WALL OPENING W 299 x H 140 x D 51mm
MATERIAL #304 Stainless Steel Body, Chrome Plated Die Cast Zamak Brackets & ABS Roller, Satin Stainless Finish
MOUNTING Recessed Mount Visible Fix
CAPACITY Holds two standard toilet rolls

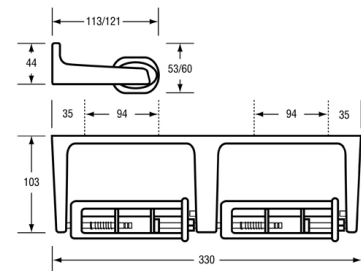

BTX-06-038

Toilet Paper Holder for Two Rolls

SIZE W 330 x H 44 x D 103mm
MATERIAL Enamel Baked Aluminium Single Mould ABS Holder with Stainless Steel Pins & Spring
MOUNTING Surface Mount Visible Fix
CAPACITY Holds two standard toilet rolls
FEATURES Restricted Feed Tamper Resistant Holder

VISIT BRITEX.COM.AU TO DOWNLOAD BIM FILES, CAD DRAWINGS AND THE MOST CURRENT PRODUCT LITERATURE.

TOILET PAPER DISPENSERS



BTX-06-039 **BTX-06-040**

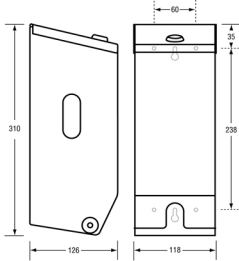

BTX-06-039

S.S. Dual Toilet Paper Dispenser

BTX-06-040

WPC Dual Toilet Paper Dispenser

SIZE W 118 x H 310 x D 126mm

MOUNTING Surface Mount Concealed Fix
CAPACITY Dispenses/Holds two rolls up to 135mmØ

FEATURES Replacement roll held in place by internal Spring Clip and drawn down through side slots after bottom roll is used and core removed & Unit fitted with tumbler lock

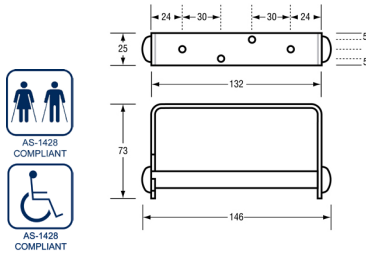

BTX-06-012

S.S. Toilet Roll Holder

SIZE W 146 x H 25 x D 73mm

MATERIAL #304 Satin Stainless Steel Body, Satin Stainless Finish

MOUNTING Surface Mount Visible Fix
CAPACITY Holds one standard toilet roll



BTX-06-041 **BTX-06-042**

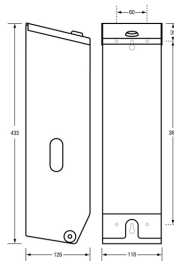

BTX-06-041

S.S. Triple Roll Toilet Paper Dispenser

BTX-06-042

WPC Triple Roll Toilet Paper Dispenser

SIZE W 118 x H 433 x D 126mm

MOUNTING Surface Mount Concealed Fix
CAPACITY Dispenses/Holds three rolls up to 135mmØ

FEATURES Replacement roll held in place by internal Spring Clip and drawn down through side slots after bottom roll is used and core removed & Unit fitted with tumbler lock

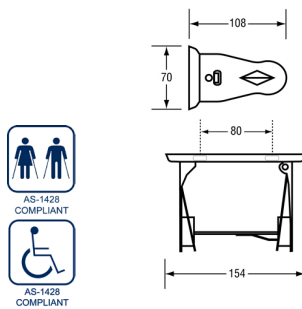

BTX-06-043

Toilet Paper Holder for One Roll

SIZE W 154 x H 70 x D 108mm

MATERIAL Chrome Plated Steel

MOUNTING Surface Mount Visible Fix
CAPACITY Holds one standard toilet roll
FEATURES Tamper Resistant Locking Mechanism

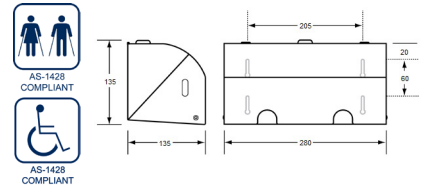

BTX-06-060

S.S. Contour Double Roll Toilet Paper Dispenser

SIZE W 280 x H 135 x D 130mm

MATERIAL #304 Stainless Steel Body
Single Moulded ABS Holders, Satin Stainless Finish

MOUNTING Surface Mount Concealed Fix
CAPACITY Holds two standard toilet rolls
FEATURES Unit fitted with tumbler lock

VISIT BRITEX.COM.AU TO DOWNLOAD BIM FILES, CAD DRAWINGS AND THE MOST CURRENT PRODUCT LITERATURE.

TOILET PAPER DISPENSERS

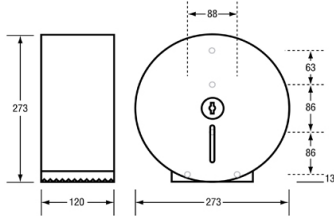

BTX-06-046

S.S. Jumbo Roll Toilet Tissue Dispenser

SIZE W 273 x H 273 x D 120mm projection from wall

MATERIAL #304 Stainless Steel, Satin Stainless Finish

MOUNTING Surface Mount Concealed Fix

CAPACITY Standard Roll up to 108mm wide sheet x 300mm long

FEATURES Unit fitted with security lock

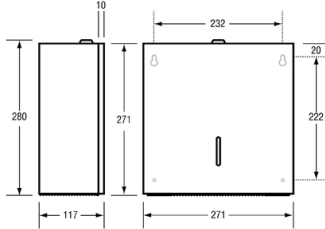

BTX-06-048

S.S. Square Jumbo Roll Toilet Paper Dispenser

SIZE W 271 x H 271 x D 117mm

MATERIAL #304 Stainless Steel, Satin Stainless Finish

MOUNTING Surface Mount Concealed Fix

CAPACITY Standard roll up to W 108mm x L 300mm

FEATURES Fitted with tumbler lock

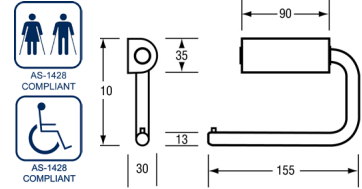

BTX-06-050

S.S. Toilet Roll Holder

SIZE W 155 x H 110 x D 30mm

MATERIAL #304 Stainless Steel, Satin Stainless Finish

MOUNTING Surface Mount Security Concealed Fix

CAPACITY Holds one standard toilet roll

FEATURES Universal Installation - Left or Right & Toilet Roll Locator Pin

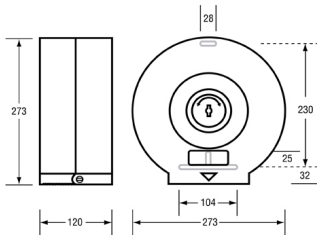

BTX-06-045

Jumbo Toilet Roll Dispenser

SIZE W 273 x H 273 x D 120mm

MATERIAL Heavy Duty ABS

MOUNTING Surface Mount Concealed Fix

CAPACITY Standard Roll up to 108mm wide sheet x 300mm long

FEATURES Unit fitted with security lock

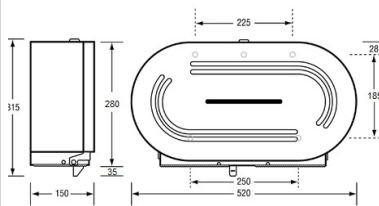

BTX-06-047

S.S. Double Jumbo Roll Toilet Tissue Dispenser

SIZE W 520 x H 284 with 150mm projection from wall

MATERIAL #304 Stainless Steel, Satin Stainless Finish

MOUNTING Surface Mount Concealed Fix

CAPACITY 2 standard rolls up to W 108mm x L 300mm

FEATURES Fitted with tumbler lock

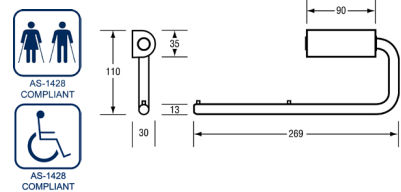
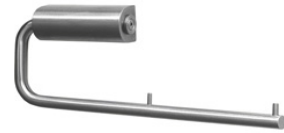

BTX-06-051

S.S. Double Toilet Roll Holder

SIZE W 269 x H 110 x D 30mm

MATERIAL #304 Stainless Steel, Satin Stainless Finish

MOUNTING Surface Mount Security Concealed Fix

CAPACITY Holds two standard toilet rolls

FEATURES Universal Installation - Left or Right & Toilet Roll Locator Pins

VISIT BRITEX.COM.AU TO DOWNLOAD BIM FILES, CAD DRAWINGS AND THE MOST CURRENT PRODUCT LITERATURE.

TOILET PAPER DISPENSERS

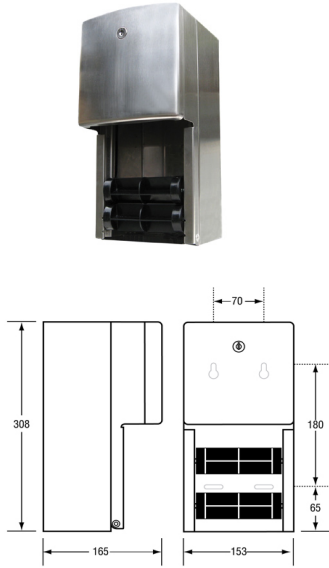

BTX-06-052

S.S. Contour Double Roll Toilet Paper Dispenser

SIZE W 153 x H 308 x D 165mm

MATERIAL #304 Stainless Steel cabinet & mechanism Plastic rollers, Satin Stainless Finish

MOUNTING Surface Mount Semi Concealed Fix

CAPACITY Dispenses/Holds two rolls up to 135mmØ

FEATURES Top roll drops automatically after bottom roll is used up, Unit fitted with tumbler lock & Rounded fascia

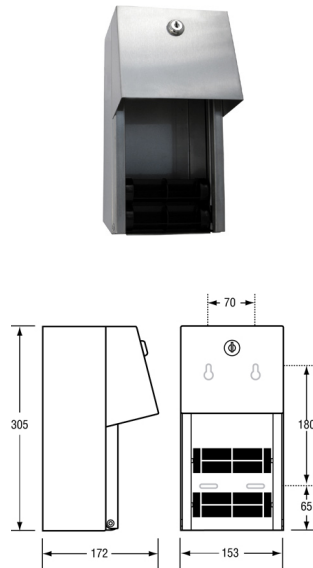

BTX-06-053

S.S. Dual Roll Toilet Paper Dispenser

SIZE W 153 x H 308 x D 172mm

MATERIAL #304 Stainless Steel cabinet & mechanism Plastic rollers, Satin Stainless Finish

MOUNTING Surface Mount Semi Concealed Fix

CAPACITY Dispenses/Holds two rolls up to 135mmØ

FEATURES Top roll drops automatically after bottom roll is used up & Unit fitted with tumbler lock

VISIT BRITEX.COM.AU TO DOWNLOAD BIM FILES, CAD DRAWINGS AND THE MOST CURRENT PRODUCT LITERATURE.