



# MPW5MX1 - REFRIGERATION / GENERAL ASSEMBLY

## 5KW PACKAGE WALL AC UNIT

### MPW5MX1

Wall Mount Packaged HVAC 5kW 415VAC with Heating (3kW) with Pressuriser

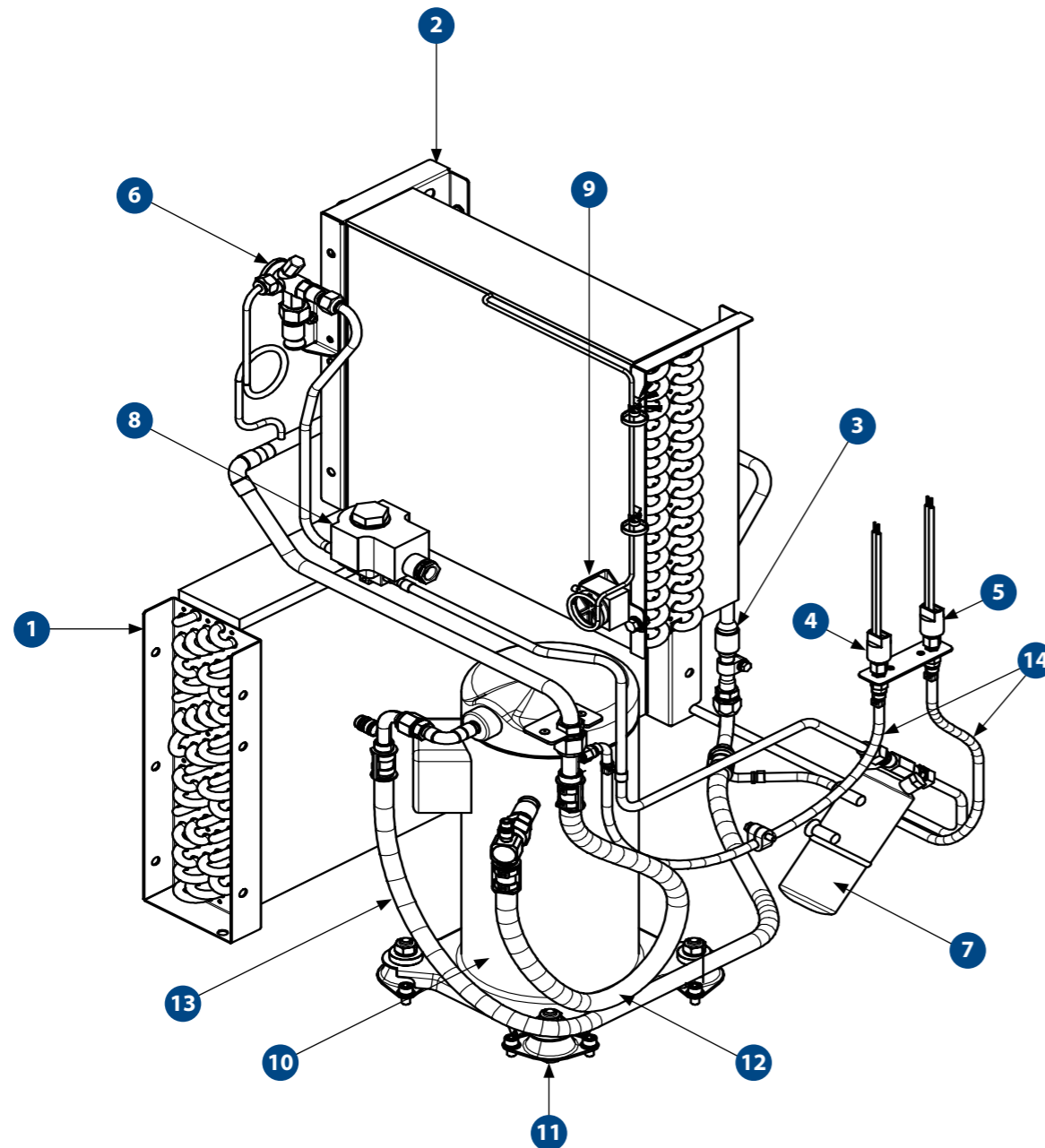

# SPARE PARTS

PART NO.	DESCRIPTION	QTY
H0028308	FILTER MEDIA	1
1 AU110397	CONDENSER COIL 540MM X 381MM X 79MM 5RW MPV5	1
2 AU120492	EVAPORATOR COIL 380MM X 381MM X 88MM 4 RW MPV5	1
3 AU517621	VALVE CHECK 1/2SL STRAIGHT	1
4 AU523365	LOW PRESSURE SWITCH	1
5 AU523655	HIGH PRESSURE SWITCH	1
AU521509	TX VALVE 2T 3/8" IN 1/2" OUT 1/4" EQ R134A	1
AU521504	TX ORIFICE 2T R22 #04	1
7 AU531415	RECEIVER DRIER 3/8" MF 193MM HIGH	1
8 AU522021	SOLENOID VALVE	1
AU668140	COIL SOLENOID 24VDC TYPE 1	1
9 UE016	THERMOSTAT DEICE STUD	1
10 H0304197	COMPRESSOR ASSEMBLY	1
11 AU845248	ANTI VIBRATION MOUNT	4
12 H0227316	SUCTION HOSE ASSEMBLY	1
13 H0227314	DISCHARGE HOSE ASSEMBLY	1
14 H0227302	PRESSURE SWITCH HOSE ASSEMBLY	2
AU821301	DIFFUSER ROUND 75MM PLASTIC	2
AU861125	SEAL D 489X365 ID	2
AU862211	SEAL RUBBER	1
AU517502	VALVE ACCESS 1/4"	1

SPARE PARTS LIST CONTINUED NEXT PAGE

# COMPANION ITEMS

PART NO.	DESCRIPTION
KNHV90029	Installation Kits
PVV50M2	Pressuriser
EB9P4X	Pressuriser
AU679519	Controller
AU6811015	Temperature Sensor

# SPECIFICATIONS

	METRIC	IMPERIAL
<b>Cooling Capacity</b>	5.0 kW	17060 BTU
<b>Heating Capacity</b>	3.0 kW	10236 BTU
<b>Fan Speeds</b>	3	3
<b>Air Flow</b>	200 l/s	424 CFM
<b>Fresh Air (Optional)</b>	30 l/s	64 CFM
<b>Power Supply</b>	415 VAC 3Phase - 50 Hz	415 VAC 3Phase - 50 Hz
<b>Current Draw</b>	17 A	17 A
<b>Refrigerant</b>	R134a	R134a
<b>Maximum Ambient Temperature</b>	54°C	129°F
<b>Packaged Weight (nominal)</b>	160.0 Kg	352.0 lbs
<b>Technical Manual Reference</b>	SM519-4077	SM519-4077

# MAINTENANCE

<b>MONTHLY / 450 HOURS</b>	
<b>H0028308</b>	FILTER MEDIA
<b>ANNUAL / 5,400 HOURS</b>	
<b>AU531415</b>	RECEIVER DRIER 3/8" MF 193MM HIGH
<b>3 YEARS / 16,200 HOURS</b>	
<b>AU521509</b>	TX VALVE 2T 3/8" IN 1/2" OUT 1/4" EQ R134a
<b>UE016</b>	THERMOSTAT DEICE STUD
<b>AU521504</b>	TX ORIFICE 2T R22 #04
<b>AU845248</b>	ANTI VIBRATION MOUNT
<b>H0227316</b>	SUCTION HOSE ASSEMBLY
<b>H0227314</b>	DISCHARGE HOSE ASSEMBLY
<b>H0227302</b>	PRESSURE SWITCH HOSE ASSEMBLY

Please contact SIGMA for more information including details on an overhaul scope and interval. Maintenance periods and scope are dependent on application and site conditions, and are to be used as a guide.

OVERVIEW  
PRESSURISERS  
E SERIES  
H SERIES  
M SERIES  
T SERIES  
PILOT CONTROL BOXES  
SERVICEABLE PARTS  
UNDERSTANDING HVAC  
POLICIES



# MPW5MX1 - ELECTRICAL

## 5KW PACKAGE WALL AC UNIT

**MPW5MX1**  
Wall Mount Packaged HVAC 5kW 415VAC with Heating (3kW) with Pressuriser

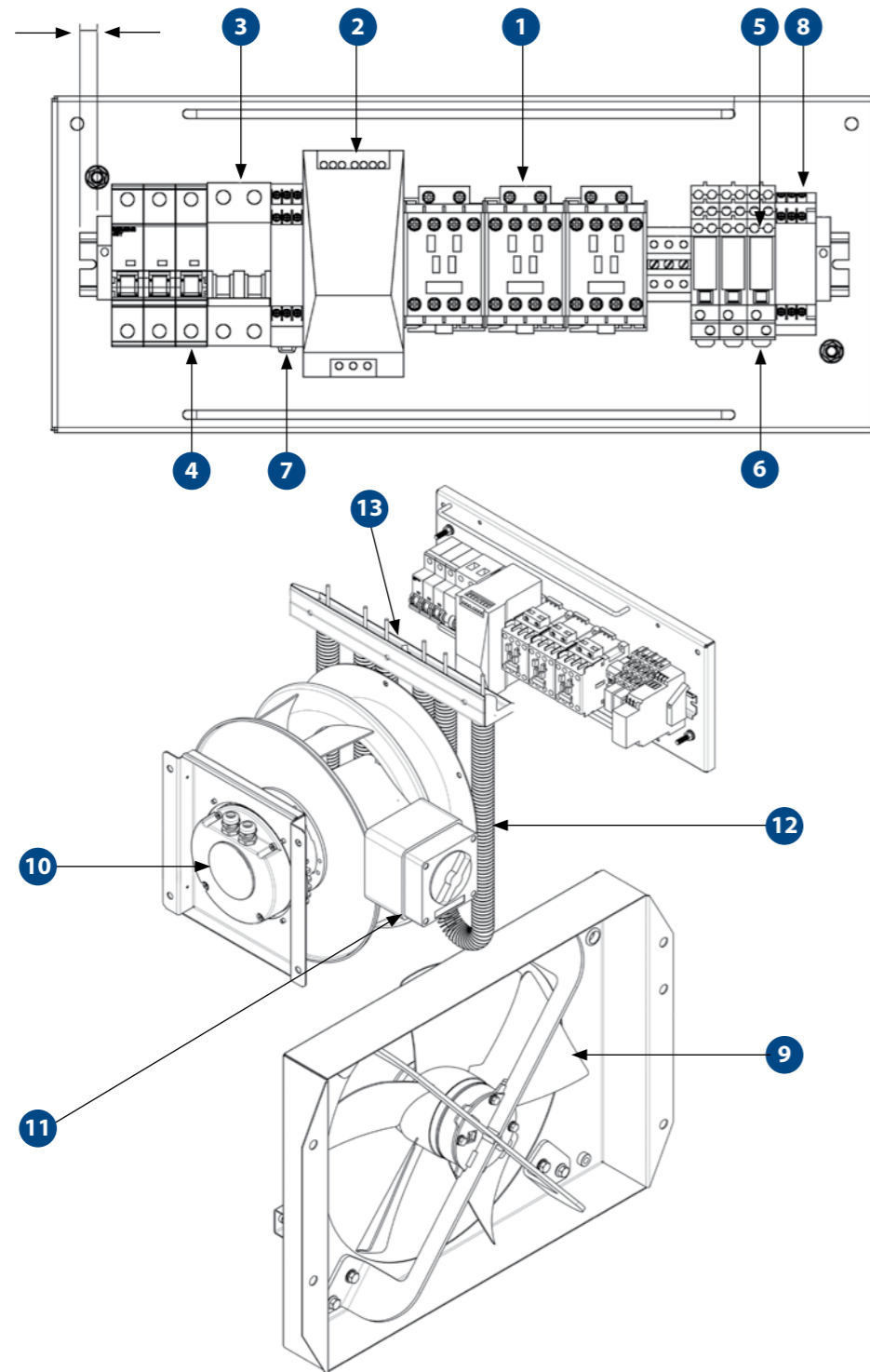

## SPARE PARTS

PART NO.	DESCRIPTION	QTY
1	AU651047 CONTACTOR 12A 3 POLE 24VDC 1NO	3
2	AU677142 CONVERTER AC/DC IN 24VDC OUT 3A	1
3	AU641390 CIRCUIT BREAKER 4A 2 POLE	1
4	AU641093 CIRCUIT BREAKER 16A 3 POLE	1
5	AU661040 RELAY 8 PIN 24VDC 2 POLES	3
6	AU661041 RELAY BASE 8 PIN	3
7	AU661043 RELAY POWER FAILURE 3 PHASE	1
8	AU672500 TIMER ON DELAY 24VDC 0.1SEC-100HR 1 POLE	1
9	AU4201004 FAN AXIAL 400MM 400VAC	1
10	H0023291 BLOWER IMPELLER 307D X 222W 240VAC	1
11	H0023701 SWITCH	1
12	AU691104 HEATER U SHAPE 1.0KW 240V 365MM BRS FIN	3
13	AU681020 THERMOSTAT T5 50°C SPST N/C AUTO	1
	AU679519 CONTROLLER ELECTRICAL 24VDC DISPLAY	1
	AU6811015 THERMOSTAT SENSOR NTC -50 TO 105°C	1

## SPECIFICATIONS

	METRIC	IMPERIAL
<b>Cooling Capacity</b>	5.0 kW	17060 BTU
<b>Heating Capacity</b>	3.0 kW	10236 BTU
<b>Fan Speeds</b>	3	3
<b>Air Flow</b>	200 l/s	424 CFM
<b>Fresh Air (Optional)</b>	30 l/s	64 CFM
<b>Power Supply</b>	415 VAC 3Phase - 50 Hz	415 VAC 3Phase - 50 Hz
<b>Current Draw</b>	17 A	17 A
<b>Refrigerant</b>	R134a	R134a
<b>Maximum Ambient Temperature</b>	54°C	129°F
<b>Packaged Weight (nominal)</b>	160.0 Kg	352.0 lbs
<b>Technical Manual Reference</b>	SM519-4077	SM519-4077
<b>Dimension (L X W X H)</b>	696mm X 665mm X 969mm	27.4in X 26.2in X 38.1in

## COMPANION ITEMS

PART NO.	DESCRIPTION
<b>KNHV90029</b>	Installation Kits

SPARE PARTS LIST CONTINUED ON PREVIOUS PAGE

- DRAGLINE & SHOVEL
- DRILL
- EXCAVATOR
- DOZER
- TRUCK
- WHEEL LOADER
- CONSTRUCTION
- UNDERGROUND EQUIPMENT
- INDUSTRIAL
- SMELTERS
- RAIL SPECIAL VEHICLES