



DRYING CABINET

DC8 HP

8 KG

FEATURES

- Heat pump drying cabinet
- Very low energy consumption, only 0,28 kWh/kg
- Capacity: 8kg
- Hanging length : 16m
- Four automatic programs dry the clothes until they are dry, not a minute longer, thanks to the Humidity Tracking System (HTS)
- One program for time dry
- The doors open 190°
- Hanging rail rotates 180° to the outside
- Lighting inserted
- The feet are adjustable from the inside of the cabinet
- Delivered semi-mounted, top packed as an assembling kit
- Language options: English, French, German, Swedish, Norwegian, Danish and Spanish instructions
- CE approved

OPTIONS

- Hook rack, set of three

MARKETS

Laundries, laboratory, fire brigades, police stations, army, airports, campings, golf clubs, football clubs, diving schools, theatres, spas, horse farms, oil platforms, ski resorts, fish industries, marines, ships



Speak with a Laundry Specialist

t: 1300 222 119

e: info@aqualogic.com.au

w: aqualogic.com.au/contact



DC8 HP	
LOADING CAPACITY (KG)	up to 8 KG
DRYING CAPACITY (G/MIN)	45
HANGING LENGTH (M)	16
DRYING TIME (MIN)	58*
TOTAL POWER (kW)	1,5
ENERGY CONSUMPTION / KG (kWh)	0,28
ELECTRICAL CONNECTIONS	
ELECTRICAL CONNECTION	380-415V/50/60Hz/3Phase+N
FUSE (A)	10
TOTAL POWER (KW)	1,5
DRAIN PIPE (MM)	Ø12
COOLING LIQUID	R407C
PRESSURE DROP (Pa)	max 70
SOUND LEVEL	
AIRBORNE SOUND LEVEL (DB (A))	56
SHIPPING DATA	
NET WEIGHT(KG)	165
CRATE (KG)	15
GROSS WEIGHT (KG)	180
SHIPPING VOLUME (M ³)	1,6
OPTIONAL EXTRAS	
HOOK, RACK, SET OF THREE	Part number POD131071
DIMENSIONS	
WIDTH (MM)	1200
DEPTH (MM)	650
HEIGHT (MM)	1995

* Drying of 6 kg cotton (dry weight), washed and high-spinned to 43% residual moisture, dried to 0% residual moisture

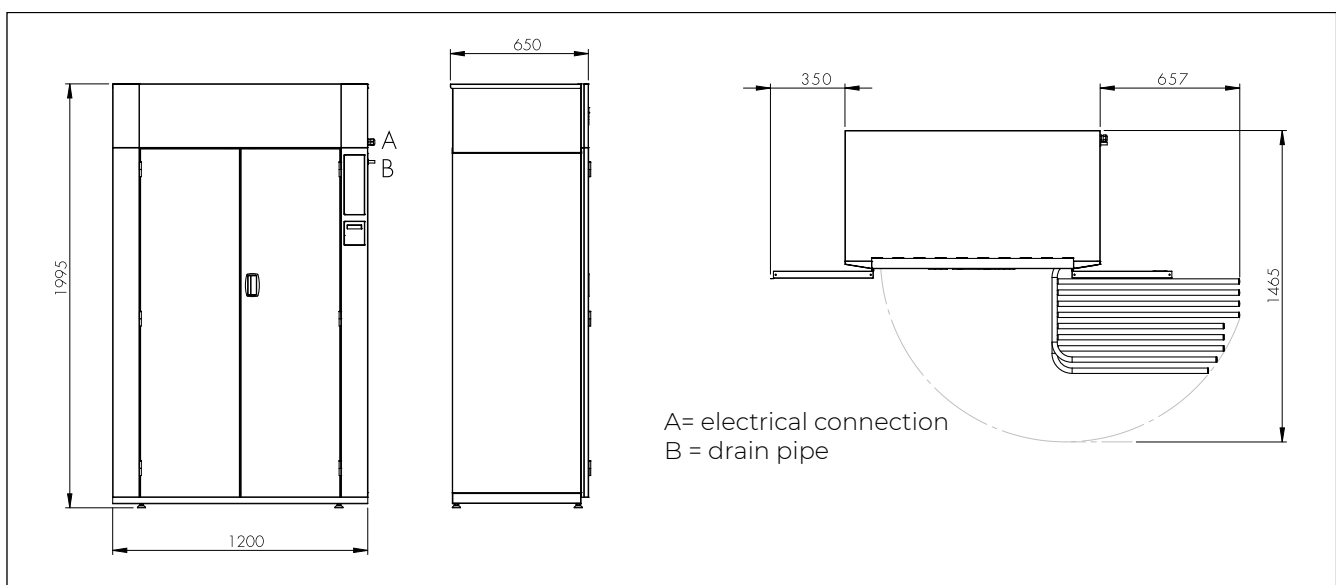

Speak with a Laundry Specialist

t: 1300 222 119 e: info@aqualogic.com.au w: aqualogic.com.au/contact

