

GAS GRIDDLE WITH CHROMIUM SMOOTH PLATE ON OPEN CUPBOARD

CODE
CR0994309

MODEL
D74/10FTTGC

SERIE
DIAMANTE70

Project:

Rev.:

Zone:

Location:



weinnovate cooking



GENERAL FEATURES

- Diamante 70 is available on the worktop, on a compartment base and on ovens in a range of solutions, ideally suited to a vast range of uses and settings, from the smallest to medium and large kitchens. All tops are laser cut to ensure that all components fit together perfectly.
- • AISI 304 stainless steel, Scotch Brite finish, 1.5 mm worktops
- • Swing door with accessories for holding knives, ladles and bottles
- • Digital control panel with waterproof control knobs
- • Double doors: bottom or side hung
- • Functional side panels with up to 7 containers and holders
- • The modular range: 200-400-600-800-1200
- • Simple, functional coupling system
- • Also available in a plinth-mounted version
- • Wide range of accessories

TECHNICAL DATA

- GAS GRIDDLE WITH CHROMIUM SMOOTH PLATE ON OPEN CUPBOARD
- Outer casing and feet in stainless steel.
- Adjustable worktop height, ranging from 840 to 900 mm.
- Recessed hot plate, 40 mm lower than worktop surface.
- Hot surface with hard polished chrome plating smooth.
- Plate slants 10mm forwards.
- Large grease drawer.
- Burner with self-stabilizing flame.
- Temperature adjustment and regulation with safety tap and thermocouple (200-400°C) or thermostat safety valve with thermocouple (110-280°C).

GAS GRIDDLE WITH CHROMIUM SMOOTH PLATE ON OPEN CUPBOARD



we innovate cooking

CODE
CR0994309

MODEL
D74/10FTTGC

SERIE
DIAMANTE70

TECHNICAL INFORMATION

SPECIFICATIONS	DATA
CODE	CR0994309
DEFINITION	D74/10 FTTGC FRY TOP GAS LC M80 VANO G.
MODEL	D74/10 FTTGC
SUPPLY	GAS
WIDTH	800 MM
DEPTH	730 MM
HEIGHT	870 MM
NET WEIGHT	114,800
VOLUME	0,508 M3
PACKAGING LENGTH	850,000
PACKAGING WIDTH	850,000
PACKAGING HEIGHT	1150,000
PACKAGING VOLUME	0,831
PACKAGING GROSS WEIGHT	125,000
GAS TYPE	GPL 28-30/37 mbar
GAS POWER (G30/30 MBAR)	14,00 KW
GAS POWER (G25/25 MBAR)	13,00 KW
CERTIFIED MODEL	D74/10 FTTGC
CERTIFICATION NUMBER	CE-0085BU0308
POT GAS TOT / POT FRIGO2	14,00
CERTIFICATION	0085BU0308
CERTIFICATION BODY	0085
TYPE	A GIORNO
PRODUCT VARIANTS	PIASTRA LISCIA /RIGATA
NUMBER OF MODULES	1/1 MODULO

GAS GRIDDLE WITH CHROMIUM SMOOTH PLATE ON OPEN CUPBOARD



we innovate cooking

CODE
CR0994309

MODEL
D74/10FTTGC

SERIE
DIAMANTE70

ACCESSOIRES

CODE	MODEL	DESCRIPTION
CR0985219	70XFTP4	BACKSPALSH FOR FRY TOP M 400
CR0985229	70XFTP6	BACKSPALSH FOR FRY TOP M 600
CR0985239	70XFTP8	BACKSPALSH FOR FRY TOP M 800
CR1353939		
CR0592079	NXFTC4	CLEANING DRAWER FOR FRY TOP
CR0592089	NXFTC6/8	CLEANING DRAWER FOR FRY TOP
CR0592060	NXFTT	TAP FOR FRY TOP PLATE CLEANING
CR0996979	DBVP4	DOOR M40
CR0997009	DBVPA4	ACCESSORIABLE DOOR M40
CR0997029	DAPC	KNIFE HOLDER
CR0997019	DAPD	DOSATOR HOLDER
CR0997039	DAPS	SPICE RACK
CR0997049	DAPM	LADLE HOLDER
CR0997059	DAPDB	DISPENCER HOLDER
CR1353589	DBVC4	DRAWERS KIT
CR0599729	74/10BH	NEUTRAL BASES WITH HYGIENIC FINISHING, TYPE H2
CR1353569	DRG21	GRILL HOLDERS GN 2/1
CR0592799	NXZF8	FRONTAL PLINTH
CR0592830	NX9ZG	PLINTH JUNCTION
CR0599649	7ZL	SIDE PLINTH NX7ZL
MA97432000	NXR	CASTORS KIT
MA97433000	NXRI	CASTORS KIT
CR0592869	CR0592869	KIT 4 FEET FOR CONCRETE PLINTH INSTALLATION
CR0593580	NX9PT	KIT 4 FEET FOR TOP VERSION
CR0592879	CR0592879	KIT ANTI-TIPPING FEET
CR0592399	NXTVT1	CLOSING PANEL FOR TECHNICAL SPACE
CR0592409	NXTVT2	CLOSING PANEL FOR TECHNICAL SPACE
PTD7DX	PTD7DX	END SIDE RIGHT ELEMENT
PTD7SX	PTD7SX	END SIDE LEFT ELEMENT
CMF0708	CMF0708	FRONTAL HANDRAIL
CMA1808	CMA1808	PERIMETRAL HANDRAIL

GAS GRIDDLE WITH CHROMIUM SMOOTH
PLATE ON OPEN CUPBOARD

CODE
CR0994309

MODEL
D74/10FTTGC

SERIE
DIAMANTE70



weinnovate cooking

we cook with
Diamante

Product's PLUS



The plates tilt 10 mm towards the front of the appliance, optimising flow of fat into the drip drawer.



Plate welded to hob, thus guaranteeing a wider cooking zone and preventing the accumulation of dirt.

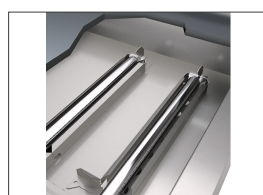

Multiple burners underneath the plate ensure uniform heat distribution.



Thanks to the water jet ingress protection rating, awarded after passing specific tests, knobs and knob bezels can be washed at the end of the working day without affecting performance or safety.

Olis Ali Group S.r.l.

Via Del Boscon, 424 - 32100 Belluno - Italy

W: olis.it M: info@olis.it

T: +39 0437 8558

F: +39 0437 838 274



GAS GRIDDLE WITH CHROMIUM SMOOTH PLATE ON OPEN CUPBOARD

CODE
CR0994309

MODEL
D74/10FTTGC

SERIE
DIAMANTE70

SCHEMA DI INSTALLAZIONE - INSTALLATION DIAGRAM - INSTALLATIONSPLAN - SCHÉMA D'INSTALLATION - ESQUEMA DE INSTALACION -INSTALLATIESCHEMA - IINSTALLATIONSRITNINGAR

MISURE IN cm - DIMENSIONS IN cm - ABMESSUNGEN IN cm
MESURES EN cm - MEDIDAS EN cm - MATEN IN cm

(D) 72/10 TFT.G...

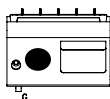

(D) 73/10 TFT.G...

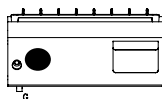

(D) 74/10 TFT.G...

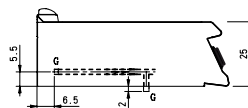
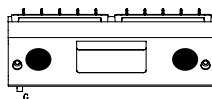

(D) 72/10 FT.G...

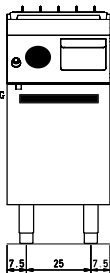

(D) 73/10 FT.G...

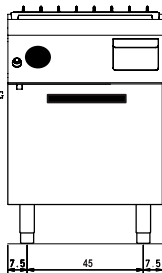

(D) 74/10 FT.G...

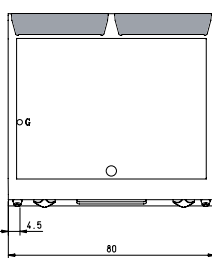
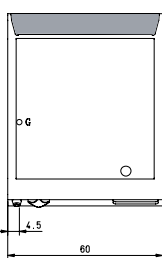
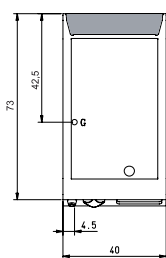
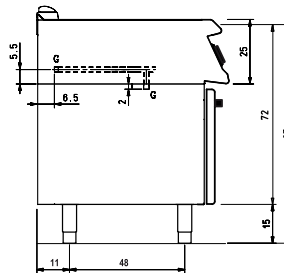
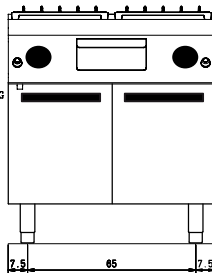

(D) 76/10 TFT.G... (D) 76/10 FT.G...

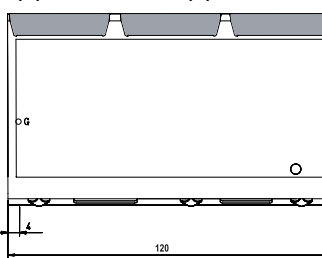

Legenda - Legende - Key - Légende - Leyenda - Legenda

- G** Attacco arrivo gas - Gasanschluss - Gas connection
Arrivée gaz - Union de gas - Gasaansluiting
EN 10226-1 R 1/2; EN ISO 228-1 G 1/2 (DK)