

Hyworth 1.6T Ride On Reach Truck

		Distinguishing Marks		
1.1	Hyworth 1.6T Ride On Reach Truck			
1.2	Model Number			H16BERT75
1.3	Operator Type			Electric
1.4	Rated Capacity / rated load	Q (kg)		1600
1.5	Load centre distance	c (mm)		600
1.6	Load centre distance, centre of drive axle to fork	x (mm)		218
1.7	Wheelbase	y (mm)		1480
		Weight		
2.1	Service Weight	kg		3300
		Tyres		
3.1	Tyres			polyurethane
3.2	Tyre Size: front	mm		285x100
3.3	Tyre size: rear	mm		343x114
		Dimensions		
4.1	Tilt of mast / fork carriage forward / backward	α/β (°)		2/4
4.2	Height: mast lowered	h1 (mm)		3230
4.3	Free lift	h2 (mm)		2540
4.4	Lift	h3 (mm)		7500
4.5	Height: mast extended	h4 (mm)		2200
4.6	Height of overhead guard STD	h6 (mm)		2040
4.7	Length to face of forks	l2 (mm)		1935
4.8	Overall width	b1 (mm)		1270
4.9	Fork dimensions ISO 2331	s/e/l (mm)		40x122x1070
4.10	Distance between fork arms	b2 (mm)		244-882
4.11	Reach Distance	l4(mm)		435
4.12	Aisle width for pallets 1000 x 1200 crossways	Ast (mm)		2921
4.13	Aisle width for pallets 800 x 1200 lengthways	Ast (mm)		2995
4.14	Fork carriage width	b3 (mm)		1000
4.15	Turning radius	Wa (mm)		1735
		Performance data		
5.1	Travel speed	Km/h		103
5.2	Lift speed	m/s		0.280
5.3	Lowering speed	m/s		0.400
5.4	Max. Gradeability	%		10
		Electric engine		
6.1	Drive motor rating S2 60 min	kW		AC6.5
6.2	Lift motor rating at S3 15%	kW		AC 14.5
6.3	Steering Motor			AC 0.67
6.4	Battery voltage: rated capacity	V/Ah		48/500
		Additional data		
8.1	Type of drive control			Full AC
8.2	Manufacturer			CURTIS
10.2	Operating pressure for attachments	bar		165
10.3	Sound level at the drive4rs ear according to EN/DIN 120 53	d β (A)		75

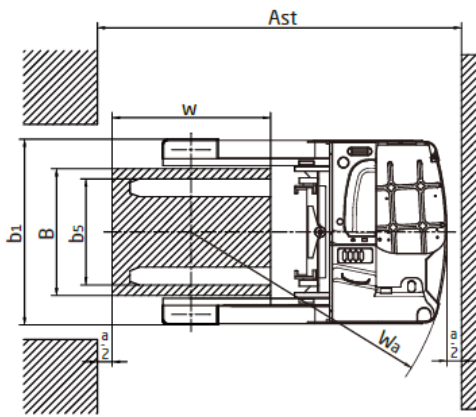
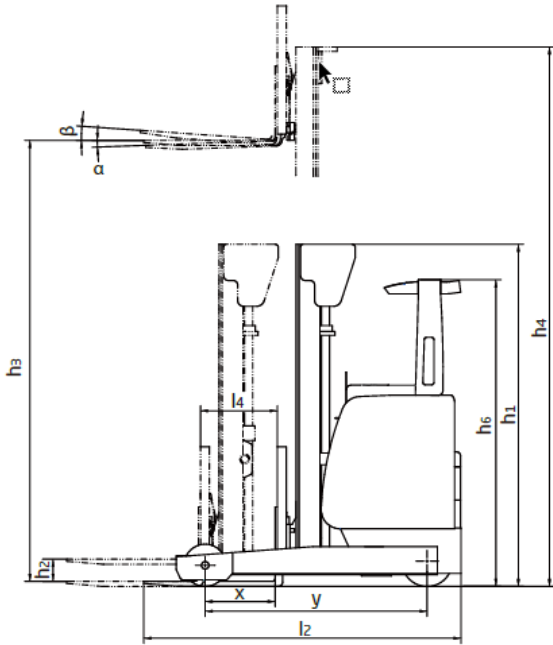

$$Ast = \sqrt{(w-x)^2 + (B/2)^2} + Wa + a$$

a: safety clearance

HYWORTH®

FORKLIFTS

2/12 Weld Street PRESTONS NSW 2170
 1300 HYWORTH (1300 499 678)
 info@hyworthforklifts.com.au
 www.hyworthforklifts.com.au