

Instructions for Applying Neo-Velum

1. Ensure the area is totally clean and dry by washing gently with water. Do not put any cream on the area to be used for the Neo-Velum as this will affect the adhesion.

2. Open the Neo-Velum by peeling back the clear seal on the packaging from the backing.

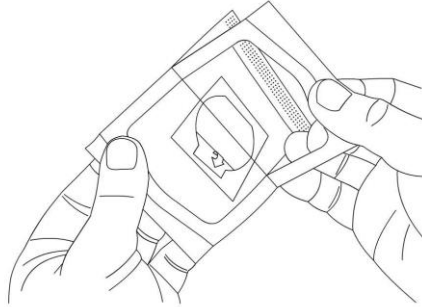

3. Gently remove the Neo-Velum from the backing, trying not to stretch the hydrocolloid material.

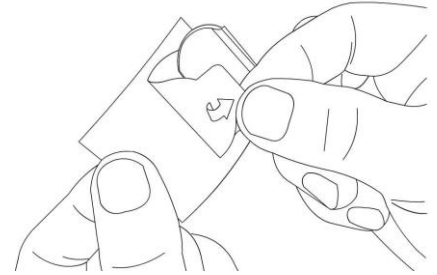

4. Place the Neo-Velum over the area to attach the tube and smooth out any creases or lumps that may cause pressure areas.

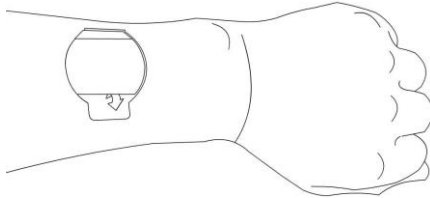

5. Peel away the white backing from the transparent adhesive flap.

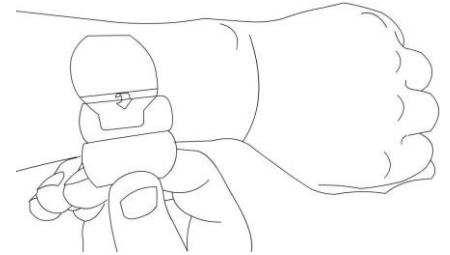

6. Sandwich the tube/catheter between the adhesive flap and hydrocolloid. Close the flap over the tube and secure by smoothing down the flap.

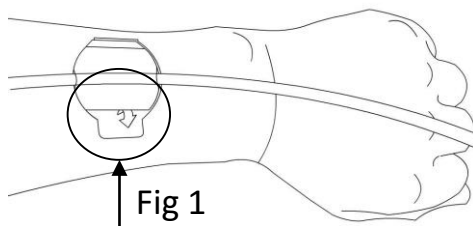

7. Remove the clear plastic backing from adhesive tab as indicated by the blue arrows (Fig 1). Remove the remaining white backing strip to

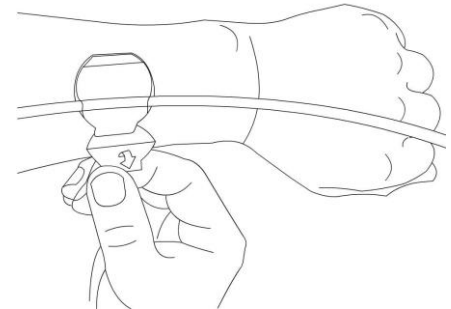

8. The tube is now secured on the patient.

