



**lamber**<sup>®</sup>

**HE2020**

HOSPITALITY EQUIPMENT 2020 PTY LTD



# VEGETABLE WASHERS



“Gentle on soft vegetables”



HOSPITALITY EQUIPMENT 2020 Pty Ltd.  
Unit 3/49-63 Victoria Street, Smithfield,  
NSW 2164 Australia  
[www.lamber.com.au](http://www.lamber.com.au) | [www.he2020.com.au](http://www.he2020.com.au)  
02 9637 3737 | [salesnsw@he2020.com.au](mailto:salesnsw@he2020.com.au)



# VEGETABLE WASHERS



Some areas around the washing tank have the purpose to gather all dirty materials and to guarantee the proper working of the washing cycle's phases.

A frontal filtered zone catches the superficial dirty; a second backward zone guarantees the correct filling levels functioning.

A lower little tank collects finally the dirty that's on the tank bottom



## What's in it for **YOU?** Vegetable washing-drying machine

As a result of careful researches and years of experience, the A81-ek washing-drying machine is a model of advanced technology quality in the International Market.

A "complete" machine that includes all those characteristics of efficiency, functionality and hygiene which makes it an essential component of the modern kitchens. Salad, fruits and vegetables washing usually needs a lot of time and energy to obtain an extremely clean and fresh product. To obtain it, it's also necessary not to handle in a wrong way the products, otherwise their freshness could be damaged



### Advanced Electronics

Totally automatic and with advanced performances, the new A81-ek washing-drying machine is the ideal solution for the washing of every kind of vegetables.

The soft-touch membrane keyboard with digital display to show the washing operations is simple and intuitive. The selection of the required program is really eas. The pressure on a clearly visible button starts the required program.

The various duration of washing (2 minutes) and centrifuging (30 seconds) are pre-programmed in accordance with 10 different programs developed depending on the different kinds of products.



CALL US - 02-9637 3737

EMAIL US - salesnsw@he2020.com.au

WEBSITE: lamber.com.au

2

**HE2020**  
HOSPITALITY EQUIPMENT 2020 PTY LTD

HOSPITALITY EQUIPMENT 2020 Pty Ltd.  
www.he2020.com.au  
Unit 3/49-63 Victoria Street,  
Smithfield, NSW 2164 Australia



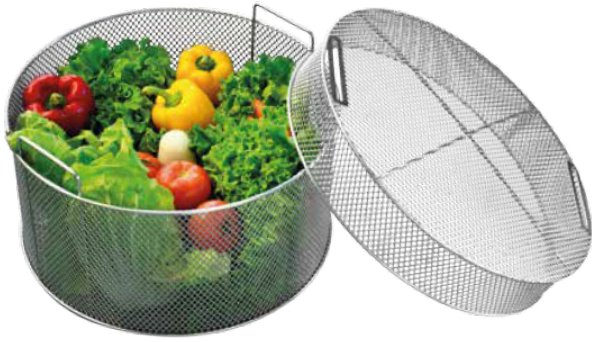

## This machine already have the **drain pump incorporated**

The next type basket makes easier the operations of machine loading and the RILSAN stainless steel guarantees the highest hygiene.

The 8x8 grid allows to wash every kind of vegetables, salad and fruits.

It's imensions (ø450mmxH225mm) have been studied to allow the washing of little and middle quantities of salad and vegetables.

It's anyway possible on demand, to have a different kind of grid according to the users' requirements.

The vibration dumping foot guarantees a high stability anchoring the machine on the floor, in particular during the centrifuging phase



### A81-EK COMMERCIAL VEGETABLE WASHER **50-60KG/HOUR**

#### Features

- S/s construction, double skin with insulatin
- Vegetables per cycle Kg 4/15
- Side & lower stainless steel washing
- 8 x 8 stainless steel basket
- Wash cycle 1-2 minutes, Drying cycle 1-90 seconds
- Capacity: 50/60 kg/h vegetables in leaves.
- 180/225 kg/h fruit & tubers
- Basket Dimensions: 50cm
- W720 x D700 x H910mm
- Volt 230/1/50 Hz

# VEGETABLE WASHERS



## Advanced Electronics

Totally automatic and with advanced performances, the new A81-ek washing-drying machine is the ideal solution for the washing of every kind of vegetables.

The soft-touch membrane keyboard with digital display to show the washing operations is simple and intuitive. The selection of the required program is really easy. The pressure on a clearly visible button starts the required program.

The various duration of washing (2 minutes) and centrifuging (30 seconds) are pre-programmed in accordance with 10 different programs developed depending on the different kinds of products.

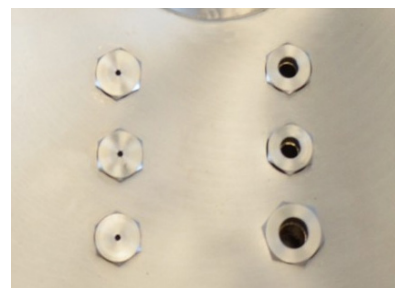

The specific stainless steel washing and rinsing nozzles have been designed to reach the best washing efficiency.

The care in the realisation of all particulars and the choice of high quality materials assure a high reliability for a long life.



CALL US - 02-9637 3737

EMAIL US - [salesnsw@he2020.com.au](mailto:salesnsw@he2020.com.au)

WEBSITE: [lamber.com.au](http://lamber.com.au)

4

**HE2020**  
HOSPITALITY EQUIPMENT 2020 PTY LTD

HOSPITALITY EQUIPMENT 2020 Pty Ltd.  
[www.he2020.com.au](http://www.he2020.com.au)  
Unit 3/49-63 Victoria Street,  
Smithfield, NSW 2164 Australia



The manufacturer reserves the right to make modifications of materials and models without warning

Specifications		A81-ek special	A81-ek	
DIMENSIONS l x p x h		720 x 715 x 890	720 x 715 x 890	mm.
HOUR PRODUCTION		50/60 180/225	50/60 180/225	Kg Kg
BASKET CAPACITY		2,5/3 12/15	2,5/3 12/15	Kg Kg
WASHING		✓	✓	
RINSING		□	✓	
CENTRIFUGING		✓	✓	
STAINLESS STEEL BASKET maglia 8x8 mm - ø 450 x H225		1	1	n.
WASHING FLOW REGULATOR		✓	✓	
SHOWER FOR MACHINE CLEANING		□	✓	
DRAIN PUMP 140 W		□	✓	
DISINFECTANT PUMP		□	□	
SELF-CLEANING PUMP		✓	✓	
DOOR LIMIT STOP		✓	✓	
ADJUSTABLE WASHING TIME FROM 0 TO 9 MINUTES (STANDARD 2 MINUTES)		✓	✓	
ADJUSTABLE CENTRIFUGING TIME FROM 0 TO 360 SECONDS (STANDARD 30 SECONDS)		✓	✓	
ROTATION SPEED OF THE CENTRIFUGING (3 SPEED - STANDARD 240 r/min)		3 speed: 160 r/min- 240 r/min-320 r/min	3 speed: 160 r/min- 240 r/min-320 r/min	r/min
DRAIN ALERT		✓	✓	
FILLING ALERT		✓	✓	
RINSING ALERT		□	✓	
WORK HEIGHT		890	890	mm
VOLTAGE		230/1	230/1	V
WASHING PUMP		650	650	W
BASKET ROTATION MOTOR		370	370	W
TOTAL RATING		1020	1020	W
MAX CURRENT INTENSITY		8	8	A
TANK CAPACITY		50	50	Lt/c.
CYCLE WATER CONSUMPTION		45	45	Lt/c.
WATER CONNECTION		3/4" Gas	3/4" Gas	" Gas
WATER OUTLET		ø 28	ø 28	mm
NET HEIGHT		100	114	Kg
GROSS WEIGHT		115	129	Kg
NOISE		< 60	< 60	dB(A)



It's possible to choose among 3 washing durations (2'-3'-4' or 3'-5'-7' minutes).

The constructive features are the same of the model A81-ek. Some optional functions are available as in the technical data.

## Versatile & Complete

Thanks to its high versatility, it's possible to modify the cycle durations according to the user's requirements. This allows to vary the times during which vegetables are exposed to the washing and always guarantees excellent washing result.

A simple and intuitive program thanks to the luminous display, which shows all the current

operations. The display shows the different washing, rinsing and centrifuging times and, at the end of the cycle, it's possible to know the total taken.

It's moreover possible to govern different alerts and visualize the tank water filling levels which act on the sequence of the different washing, rinsing and centrifuging phases. An acoustic signal informs that the cycle has finished



White Stainless steel basket  
Ø450 x H225mm



CALL US - 02-9637 3737

EMAIL US - salesnsw@he2020.com.au

WEBSITE: lamber.com.au

5

**HE2020**  
HOSPITALITY EQUIPMENT 2020 PTY LTD

**HOSPITALITY EQUIPMENT 2020 Pty Ltd.**  
www.he2020.com.au  
Unit 3/49-63 Victoria Street,  
Smithfield, NSW 2164 Australia



# WATER RECOVERY/ REGENERATION UNIT VR-81



 VR-81 Does not come with machine



## The innovative solution that allows to save considerably in water consumption and to increase the productivity of your **Vegetables Washing-Drying Machine**

Coupled with the water regeneration unit VR-81, your Vegetable Washing-Drying machine A81-EK becomes (GREEN).

The new regeneration tank allows to recover the water used during the wash, regenerating it partly for the next cycles, reducing this way excessive wastes of water.

### **Water recovery/regeneration unit to be combined with the A81-EK vegetable washing machine**

- Reduces the total consumption to just 5 liters of water per cycle
- reduces washing time by 25%
- Stainless steel regeneration tank
- Recovery pump incorporated
- Drain Valve
- 10 Programs



**Reduces water consumption by 40 Liters per cycle**



CALL US - 02-9637 3737

EMAIL US - salesnsw@he2020.com.au

WEBSITE: lamber.com.au

6

**HE2020**  
HOSPITALITY EQUIPMENT 2020 PTY LTD

HOSPITALITY EQUIPMENT 2020 Pty Ltd.  
www.he2020.com.au  
Unit 3/49-63 Victoria Street,  
Smithfield, NSW 2164 Australia



- PLUS multi-filtering system
- double skin with insulation

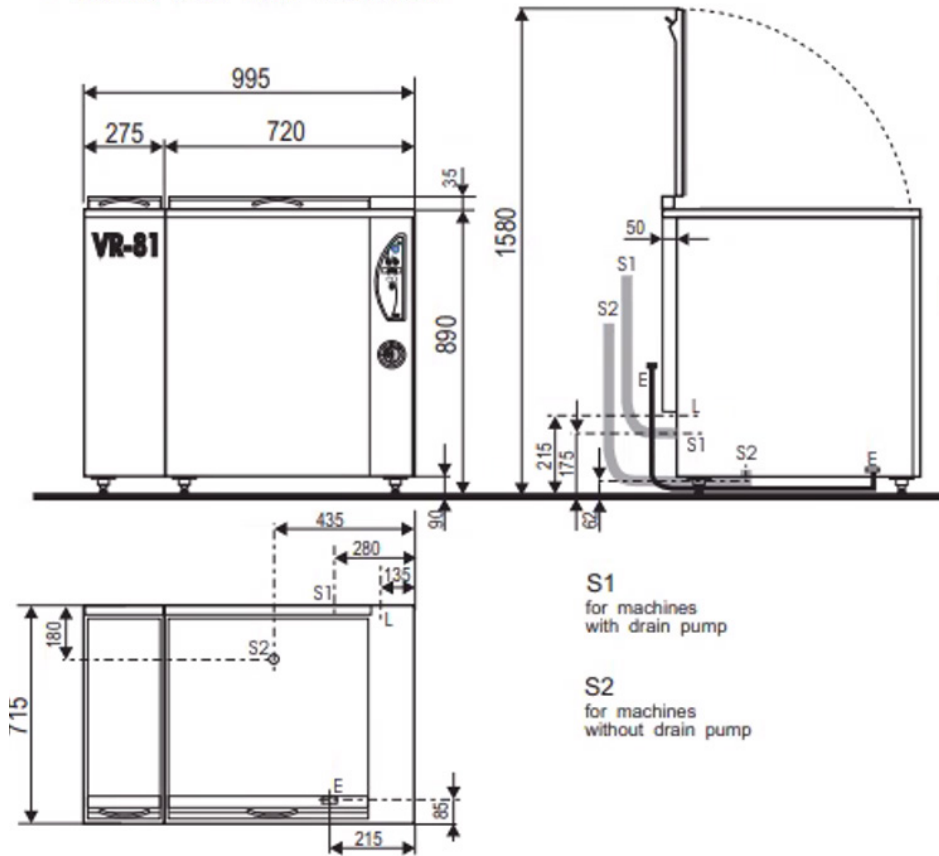

**Reduces  
washing time  
by 25%!**



**CALL US - 02-9637 3737**

**EMAIL US - salesnsw@he2020.com.au**

**WEBSITE: lamber.com.au**

**7**

# lamber®



**CONTACT US FOR A SOLUTION THAT WORKS FOR YOU!**

Unit 3/49-63 Victoria Street, Smithfield, NSW 2164 Australia

02 9637 3737 | [salesnsw@he2020.com.au](mailto:salesnsw@he2020.com.au)

[www.he2020.com.au](http://www.he2020.com.au) | [www.lamber.com.au](http://www.lamber.com.au)



**Dare to Compare**

Est 1985

COMPARE QUALITY BEFORE PRICE