



Accessories

for neonatal and
pediatric care





Dräger original accessories – for your most fragile patients

Original accessories by Dräger – quality you can count on

Every day you and your staff stand up to the challenges of working under pressure, including long working hours and budget constraints, all the while focusing on delivering quality patient care. As Your Specialist in Acute Care, we support you to provide the best possible care for your patients' safety and wellbeing. Our medical accessories are designed to improve your clinical processes and help you to unlock the full potential of your equipment – with quality you can depend on.

Quality pays off

Caring for the smallest and most fragile neonatal and pediatric patients through the entire clinical patient pathway, you need and expect dependable life-saving equipment. Our extensive range of accessories are an integral part of that equipment. Through rigorous testing, original Dräger accessories not only fulfil international standards, they also meet our own strict quality standards.

Ideal solutions – designed with your needs in mind

Suitable for a wide range of clinical applications, we supply you with over 2,000 accessory item solutions. From breathing masks to flow sensors to disposable and reusable breathing circuits, we design and develop all our products according to your specific requirements.

Tested for optimal safety and compatibility

Patient safety is above all else. To ensure precise conformity and interoperability between device and accessory, our original accessories are thoroughly tested in combination with the respective Dräger device and connectors. This means your Dräger devices operate at their full performance potential helping to ensure optimal patient care.



On this way you'll find your accessories:

OVERVIEW	06	INVASIVE AND NON-INVASIVE VENTILATION	
1. LABOR AND DELIVERY	09	Babylog® VN800 and Babylog® VN600	40
RESUSCITATION		Babylog® VN500*	42
Babyroo® TN300	10	Babylog® 8000 plus	44
Resuscitaire®	12	Evita® V800, Evita® V600, Evita® Infinity® V500** and Evita® V300	46
2. TRANSPORT	15	Evita® XL and Evita® 4 edition	48
Isolette® TI500	16	Savina® 300 Select	50
TI500 Globe-Trotter	17	PulmoVista® 500 – Pediatric Belt	52
Globe-Trotter IC	17	Seattle PAP plus / Seattle PAP	54
Oxylog® 3000 plus and Oxylog® VE300	18	BabyFlow® plus – Accessories for non-invasive respiratory support	56
Accessories for Globe-Trotter GT5400	20	Active Humidification – Aquapor H300	60
3. NEONATAL/PEDIATRIC INTENSIVE CARE UNIT (NICU/PICU)	23	Active Humidification – F&P MR850 and F&P950	62
THERMOREGULATION		Advanced accessories	57/65
IncuWarmer (closed and open care)		4. JAUNDICE MANAGEMENT	72
Babyleo® TN500 IncuWarmer	24	Jaundice Meter JM-105	74
Closed Care		BiliLux	75
Caleo®	26	5. MONITORING SYSTEMS	77
Isolette® 8000 plus	28	Infinity® Delta	78
Isolette® 8000	30	Infinity® Acute Care System (IACS)	78
Isolette® C2000	32	Vista 120/Vista 120 S	88
Open Care		Vista 120 SC	88
Babyroo® TN300	34	Tcore® Temperature Monitoring System	92
Babytherm®	36	LITERATURE	93
Developmental Care	38		
Gentle care accessories	39		

* Component of Infinity® Acute Care System Workstation Neonatal Care.

** Component of Infinity® Acute Care System Workstation Critical Care.

Application

Devices

Accessories

1. Labor and Delivery
Neonatology

Resuscitation



Babyroo® TN300



Resuscitaire®

2. Transport
Neonatology Pediatrics



Isolette® TI500



TI500 Globe-Trotter



Globe-Trotter IC



Globe-Trotter GT5400



Oxylog® 3000 plus



Oxylog® VE300

Thermoregulation
Neonatology Pediatrics

IncuWarmer
(closed and open care)



Babyleo®

Closed Care



Isolette® 8000 plus



Isolette® C2000



Isolette® 8000



Caleo®

Dräger offers a wide range of accessories, software and hardware options for the illustrated workstations. Not all products are available worldwide.

PEDIATRIC CARE

3. Neonatal/Pediatric Intensive Care Unit (NICU/PICU)

4. Jaundice Management

Invasive and non-invasive ventilation
 Neonatology Pediatrics

Open Care



Babyroo® TN300



Babytherm®



Babylog® VN800



Evita® V800



Savina® 300 Select



Jaundice Meter JM-105



Babylog® VN600



Evita® V600



PulmoVista® 500



BiliLux



Babylog® VN500



Evita® Infinity® V500



Seattle PAP plus/
Seattle PAP



Aquapor H300



Babylog® 8000 plus



Evita® V300



Fisher&Paykel
MR850/F&P950



Evita® 4 edition



Evita® XL



1. Labor and Delivery

LABOR AND DELIVERY ■ RESUSCITATION

Dräger Babyroo® TN300

The Babyroo® TN300 is a configurable open care warmer with state-of-the-art thermoregulation capabilities as well as advanced integrated technologies to support emergency resuscitation and family-centered care. From the labour & delivery room to the neonatal intensive care unit to the final discharge, the Babyroo® TN300 is scalable to use in a variety of hospital environments along the patient pathway.

- Two combined heat sources
- Central and peripheral temperature monitoring
- Resuscitation module with AutoBreath® and gas mixer options
- SpO₂ and pulse rate measurement
- Integrated scale and pass-through X-ray tray
- Integrated APGAR and SpO₂ pre-ductal target tables
- Features to support developmental care practices



D-36933-2021

Heated gel mattress

The combination of conductive heat of the heatable gel mattress and the radiative heat of the radiant warmer enables a gentle and low-stress warming therapy with reduced fluid loss for premature patients. The mattress is made of high-quality silicone and thus provides a comfortable lying feeling.



D-2406-2021

ACCESSORIES FOR DRÄGER BABYROO® TN300

PATIENT COMPARTMENT	
SoftBed mattress, reusable	MP16297
A Heated Gel Mattress for BabyTherm 8000/8010 and Babyroo TN300, reusable	2M20827
Bed canopy	MU27184
Support for bed canopy	2M21342
Side wall, 23 cm	MU26449
Side wall, 15 cm	MU26448
Side wall, 15 cm, HFV	MU26739
Side wall, 23 cm, HFV	MU26740
Mini-wall	2M20936
DEVELOPMENTAL CARE	
B Cuddling toy	MP16090
SKIN TEMPERATURE REGULATION	
C Skin temperature probe ThermoTrace, disposable, yellow, central, 5 pcs.	MX11000
D Skin temperature probe ThermoTrace, disposable, white, peripheral, 5 pcs.	MX11001
Cover for skin temperature probe CARE-FOR-ME, hydrogel, disposable, large, 100 pcs.	MU06943
Cover for skin temperature probe CARE-FOR-ME, hydrogel, disposable, small, 100 pcs.	MU06944
BREATHING CIRCUITS	
E VentStar® Autobreath N, disposable breathing circuit for Resuscitaire® and TN 300, 25 pcs.	MU10841
VentStar® circuit without Pressure Measurement	MP00310
MASKS	
F Silicone mask, reusable, size 00, small neonate	MP02900
Silicone mask, reusable, size 0, small neonate	MP01910
Silicone mask, reusable, size 1, large neonate	MP01911
SEATTLE PAP	
G Seattle PAP plus	MP02260
Seattle PAP	MP02250
HUMIDIFIER	
F&P configuration for MR850 and F&P950	8414144

ACCESSORIES FOR SUCTION	
Vacuum regulator VarioVac P Rail	MP00660
Vacuum regulator VarioVac D Rail	MP00511
Ejector VarioAir D Rail	MP00542
Ejector VarioAir P Rail	MP00545
Suction bottle with filter and tube, 800 ml (27.05 fl. oz.), 20 pcs.	MU10918
Suction canister holder for GCX	3702751

GAS SUPPLY	
Central supply hoses	8601697

EXAMINATION LIGHTS	
H VarioLux EU	MP00601
VarioLux US	MP00602
VarioLux GB	MP00603
VarioLux AUS	MP00606
VarioLux JP	MP00608

PHOTOTHERAPY	
Dräger BiliLux	MU20100

SPO ₂	US	JP	
Masimo® SET Mcable			MS20667
Masimo® cable RD SET, 1.5 m	MS33755	MS33744	MS33736
Masimo® cable RD SET, 3.6 m	MS33756	MS33775	MS33737
Masimo® cable LNCS, 1.2 m	MP03027	MP03106	MP00800
Masimo® cable LNCS, 3 m	MP03025	MP03107	MP00797
Masimo® cable LNCS, 4.3 m	MP03026	MP03105	MP03194
SpO ₂ Masimo® sensor LNCS-YI Multi	MP03023	MP03102	MP00789
Masimo® SpO ₂ sensor RD SET NeoPt, box of 20	MS33749	MS33768	MS33730
Masimo® SpO ₂ sensor RD SET Neo, box of 20	MS33748	MS33767	MS33729
Masimo® SpO ₂ sensor LNCS Neo, box of 20	MP03014	MP03092	MP00792
Masimo® SpO ₂ sensor LNCS NeoPt., box of 20	MP03015	MP03093	MP00794
Masimo® trauma sensor LNCS Neo	MP03017	MP03095	MP03192



Not all products are available worldwide.

LABOR AND DELIVERY ■ RESUSCITATION

Resuscitaire®

The Resuscitaire® is the ideal device to have during labor and delivery procedures. It combines an effective warming therapy platform along with the components you need for clinical emergencies and resuscitation.

- Integrated APGAR timer
- Alarm free pre-warm function
- Integrated suction
- Resuscitation module with AutoBreath®



D-30714-2011

Disposable breathing circuits

Dräger offers a wide range of disposable breathing circuits for different applications. All disposable breathing circuits are made of high quality material and all gas leading components are PVC -free (no harm through softeners like e.g. DE HP) and biocompatibility tested.

Dräger focuses on the interaction between the Dräger device and the related breathing circuit. System compatibility declarations represent the intensive testing which was completed in various scenarios based on our extensive experience concerning device and accessory interactions.



MT-1139-2005

ACCESSORIES FOR RESUSCITAIRE®

A	Skin temperature probe Premi-Probe® 3, reusable	MU11225
B	Skin temperature probe Premi-Probe® 3, disposable, 10 pcs.	MU11228
	Cover for skin temperature probe CARE-FOR-ME, hydrogel, disposable, large, 100 pcs.	MU06943
C	Cover for skin temperature probe CARE-FOR-ME, hydrogel, disposable, small, 100 pcs.	MU06944
D	Mattress SoftBed, for Resuscitaire®, with scale, reusable*	MP01404
D	Mattress SoftBed, for Resuscitaire®, without scale, reusable*	MP01402
E	VentStar® Autobreath N, disposable breathing circuit for Resuscitaire® and TN 300, 25 pcs.	MU10841
	Breathing hose for breathing bag, disposable, 15 mm (0.6 in), 25 pcs.	MU10900
F	VentStar® circuit without Pressure Measurement	MP00310
G	Breathing circuit for Resuscitaire® VentStar® (N), disposable, press. meas. line, 1 m (3.3 ft), 25 pcs., not made with natural rubber latex	MP00311
H	Silicone mask, reusable, size 00, premature baby	MP02900
	Silicone mask, reusable, size 0, small neonate	MP01910
	Silicone mask, reusable, size 1, large neonate	MP01911
I	Suction bottle, disposable, 40 ml (1.35 fl. oz.), 10 pcs.	MU10917
J	Suction bottle with filter and tube, disposable, 800 ml (27.05 fl. oz.), 20 pcs.	MU10918
K	Suction bottle with holder, disposable, 40 ml (1.35 fl. oz.)	MU10916
	Suction bottle, reusable, 600 ml (20.29 fl. oz.)	MU22310
	T-connector, disposable, Ø 15 mm (0.6 in), 25 pcs.	MU10902
L	T-piece adapter for MX300/MX300i and Resuscitaire® breathing circuit, disposable, 20 pcs.	MP01880

*Lining: 100% polyurethane, fabric: 100% polyester.

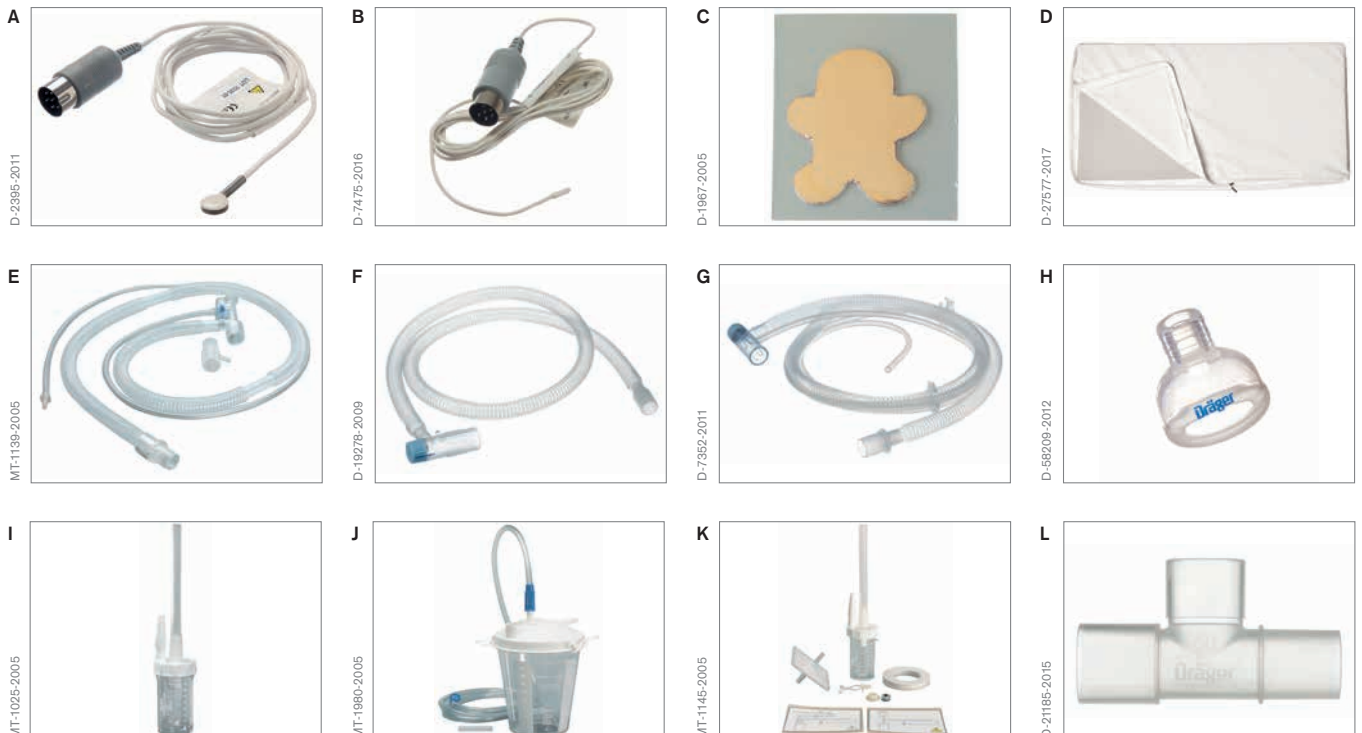

Not all products are available worldwide.



2. Transport



TRANSPORT ■ ISOLETTE® TI500

Isolette® TI500

Transport neonates safely, comfortably while minimizing stress with an integrated, fully-featured, high-performance transport incubator. Caregivers can select temperature, humidity and oxygen concentration for an optimal microenvironment.

- Inter- and intra-hospital transport
- Quick access to the infant
- Clear view to the infant
- Flexible power options



IM-1789-2005

ACCESSORIES

A	Skin temperature probe Premi-Probe® 1, reusable	MU06951
B	Skin temperature probe Premi-Probe® 1, disposable, 10 pcs.	MU06933
	Cover for skin temperature probe CARE-FOR-ME, hydrogel, disposable, large, 100 pcs.	MU06943
	Cover for skin temperature probe CARE-FOR-ME, hydrogel, disposable, small, 100 pcs.	MU06944
C	Mattress SoftBed, for TI500 and TI500 Globe-Trotter, reusable*	MP01419
	Iris port sleeve, disposable, 100 pcs.	MU03876
	Hand port cuff, disposable, oval, 100 pcs.	MU06570
	Humidity pad, disposable, antibacterial, 25 pcs.	MU06008
	Air intake filter for TI500 and TI500 Globe-Trotter, disposable, 6 pcs.	MU04472
D	Restraining strap, disposable, 10 pcs.	MU06011

*Lining: 100% polyurethane, fabric: 100% polyester.



MT-1968-2005



D-7474-2016



D-27577-2017



MT-1026-2005

Not all products are available worldwide.

TRANSPORT ■ TI500 GLOBE-TROTTER AND GLOBE-TROTTER IC

TI500 Globe-Trotter and Globe-Trotter IC

The TI500 Globe-Trotter and the Globe-Trotter IC are designed to meet your neonatal transport needs. In addition to all of the features offered by the more compact Isolette® TI500, the TI500 Globe-Trotter and the Globe-Trotter IC include a fully-integrated ventilator for the transport of intubated neonates.

- Complete neonatal transport solution
- Enhanced safety features
- Quick access to the infant
- Clear view to the infant
- Convenient connectivity
- Flexible power options



ACCESSORIES

A	Skin temperature probe Premi-Probe® 1, reusable	MU06951
B	Skin temperature probe Premi-Probe® 1, disposable, 10 pcs.	MU06933
	Cover for skin temperature probe CARE-FOR-ME, hydrogel, disposable, large, 100 pcs.	MU06943
	Cover for skin temperature probe CARE-FOR-ME, hydrogel, disposable, small, 100 pcs.	MU06944
C	Mattress SoftBed, for TI500 and TI500 Globe-Trotter, reusable*	MP01419
	Iris port sleeve, disposable, 100 pcs.	MU03876
	Hand port cuff, disposable, oval, 100 pcs.	MU06570
	Humidity pad, disposable, antibacterial, 25 pcs.	MU06008
D	Restraining strap, disposable, 10 pcs.	MU06011
	Air intake filter for TI500 and TI500 Globe-Trotter, disposable, 6 pcs.	MU04472
	Mechanical Block Assembly (TI500 Globe-Trotter only)	MU04852
	EZ GO suction pump (TI500 Globe-Trotter only)	MU04778
	GT suction pump (Globe-Trotter IC only)	MU01029
	GT patient component (Globe-Trotter IC only)	MU00996
	Patient Hose System Heated (Globe-Trotter IC only)	MU01005

*Lining: 100% polyurethane, fabric: 100% polyester.



Not all products are available worldwide.

TRANSPORT ■ OXYLOG® 3000 PLUS AND OXYLOG® VE300

Oxylog® 3000 plus

Offering high ventilation performance with features such as AutoFlow®, integrated capnography and non-invasive ventilation (NIV), the compact and robust Oxylog® 3000 plus helps you transport your patients safely and provides feedback on correctness of intubation and ventilation effectiveness.

- Non-invasive ventilation
- AutoFlow® (optional)
- Integrated capnography (optional)
- Tidal volume of 0.05 to 2 liters (1.69 to 67.63 fl. oz.)



MT-5609-2008

Oxylog® VE300

The straightforward and user-friendly Dräger Oxylog® VE300 is built to face your challenges in preclinical emergency services. With reliable ventilation technology, robustness and intuitive operation, it provides you with reliable and safe assistance in an emergency.

- Preset parameters for fast ventilation start (adult, child, infant)
- VC-CMV / VC-AC, VC-SIMV, PC-BIPAP*, SPN-CPAP/PS with NIV, PS
- For patients with a tidal volume of 50 mL upward
- Capnography: main-stream CO₂ measurement

*Trademark used under license.



D-22878-2020



D-46841-2015

READY FOR PEDIATRIC PATIENTS

A specially designed, dedicated pediatric patient circuit with reduced dead space and low compliance is available for use with the Oxylog® 3000 plus and Oxylog® VE300. This enables you to provide quality ventilation to an even wider range of patients with a single device.

ACCESSORIES FOR OXYLOG® 3000 PLUS AND OXYLOG® VE300

A	Breathing circuit Oxylog 3000, 3000+ VentStar® (P), disposable, 1.9 m (6.2 ft), 5 pcs., not made with natural rubber latex	5704964	G	SediStar® anesthesia face mask, disposable, w/o hook ring, size 1, small infant, 30 pcs.	MP01701
B	Electrostatic filter and HME TwinStar® 25 Plus, disposable, ~25 ml deadspace, 100 pcs.	MP05815	H	SediStar® anesthesia face mask, disposable, w/o hook ring, size 2, large infant, 30 pcs.	MP01702
	Electrostatic filter and HME TwinStar® 9 Plus, disposable, ~9 ml deadspace, 100 pcs.	MP05820	I	SediStar® anesthesia face mask, disposable, w/o hook ring, size 3, child, 30 pcs.	MP01703
C	Electrostatic filter CareStar® 20 Plus, disposable, ~20 ml deadspace, 100 pcs.	MP05770		Hook ring for SediStar® anesthesia masks, disposable, 22 mm ID, for sizes 3 – 7, 30 pcs.	MP01708
D	CO ₂ cuvette disposable, pediatric, 10 pcs.	MP01063	J	Silicone mask, reusable, size 2, small child	MP01912
	CO ₂ cuvette reusable, pediatric, for CO ₂ sensors 6871500, 6870300, 6871950	6870280		Silicone mask, reusable, size 3, large child	MP01913
E	CO ₂ mainstream sensor, for Evita® Infinity® V500, Babylog® VN500 and V(VN)600/800, Infinity® M540 and Oxylog® 3000 plus, reusable	6871950	K	Hook ring for silicone masks, reusable, 15 mm (0.6 in) OD, for sizes 00 – 1, 10 pcs.	MP01916
F	Catheter mount ErgoStar® CM 60, disposable, 10 cm (3.9 in), small, double swivel elbow, 50 pcs.	MP01860		Hook ring for silicone masks, reusable, 22 mm ID, for sizes 2 – 5, 10 pcs.	MP01917
	Pediatric nasal mask MiniMe2 non vented, disposable, size S	MP01555	L	Headgear, disposable, soft fabric, small	MP01559
	Pediatric nasal mask MiniMe2 non vented, disposable, size L	MP01556		Headgear, disposable, soft rubber, small	MP01561
	Pediatric nasal mask MiniMe2 vented, disposable, size S	MP01553		Pressure difference flow sensor, PPSU, disinfectable and sterilizable	8412034
	Pediatric nasal mask MiniMe2 vented, disposable, size L	MP01554			

▶ All shown part numbers are compatible with Oxylog 3000 plus and Oxylog VE300.

For more device-specific accessories, please have a look at the Oxylog & more catalog.

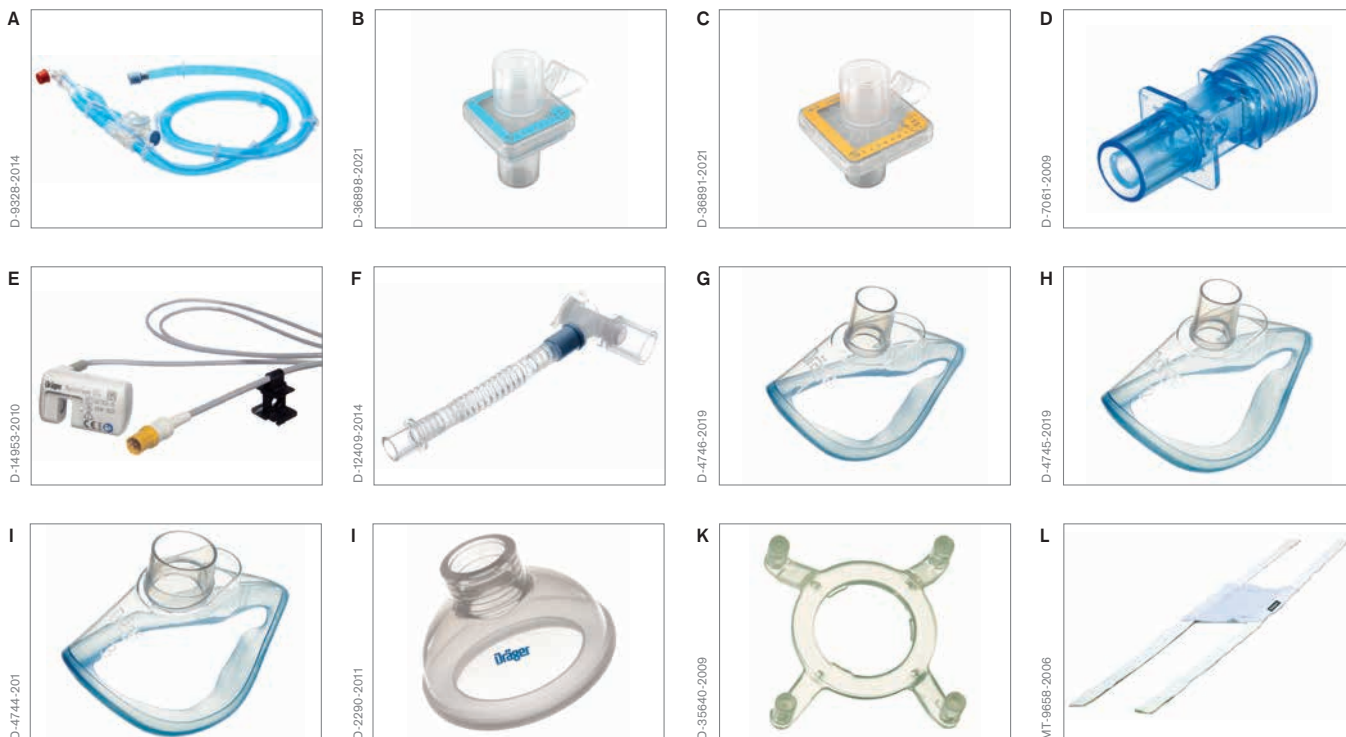

Not all products are available worldwide.

ACCESSORIES FOR GLOBE-TROTTER GT5400

INCUBATOR SPECIFIC ACCESSORIES

A	Mattress SoftBed, for TI500 and TI500 Globe-Trotter, reusable*	MP01419
B	Restraining strap, disposable, 10 pcs.	MU06011
	Tubing grommet for TI500 and TI500 Globe-Trotter, reusable	MU04366
C	Iris port sleeve, disposable, 100 pcs.	MU03876
D	Hand port cuff, disposable, oval, 100 pcs.	MU06570
E	Humidity pad, disposable, antibacterial, 25 pcs.	MU06008

*Lining: 100% polyurethane, fabric: 100% polyester.

BREATHING ACCESSORIES

F	Breathing circuit for active humidification, disposable, neonate, 20 pcs., not made with natural rubber latex	MU24409
G	Flow sensor for Crossvent 2i+, disposable, infant, 10 pcs.	MU24401
H	O₂ sensor for Crossvent 2i+	MU24402

SKIN TEMPERATURE SENSORS

I	Skin temperature probe Premi-Probe® 1, reusable	MU06951
J	Skin temperature probe Premi-Probe® 1, disposable, 10 pcs.	MU06933
	Cover for skin temperature probe CARE-FOR-ME, hydrogel, disposable, large, 100 pcs.	MU06943
	Cover for skin temperature probe CARE-FOR-ME, hydrogel, disposable, small, 100 pcs.	MU06944

PULSE OXIMETRY (SPO₂)

	US	JP	
K	SpO₂ adhesive sensor Masimo® LNCS Neo, disposable, neonate, 20 pcs.	MP03014	MP00792
	SpO₂ adhesive sensor Masimo® LNCS NeoPt, disposable, premature baby, 20 pcs.	MP03015	MP00794
	SpO₂ multisite sensor Nellcor® DURA -Y™, reusable		MX01004

MISCELLANEOUS

L	Air intake filter for TI500 and TI500 Globe-Trotter, disposable, 6 pcs.	MU04472
----------	--	----------------



Not all products are available worldwide.





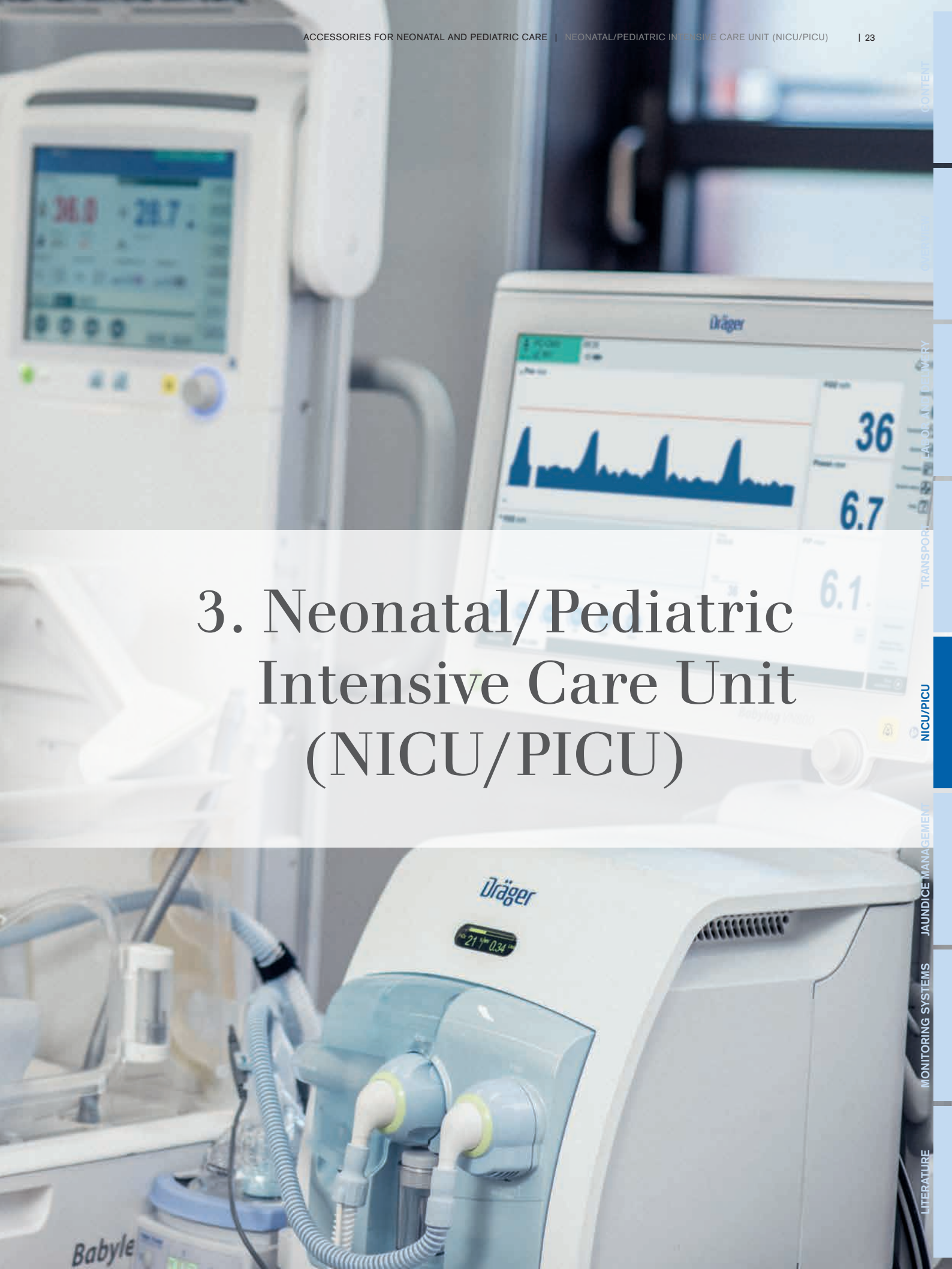

3. Neonatal/Pediatric Intensive Care Unit (NICU/PICU)

NEONATAL/PEDIATRIC INTENSIVE CARE UNIT (NICU/PICU) ■ THERMOREGULATION ■ INCUWARMER (CLOSED AND OPEN CARE)

Babyleo® TN500 IncuWarmer

The Babyleo® TN500 is Dräger's first IncuWarmer that provides optimal thermoregulation for neonates in open care, closed care and transition. With the combination of three heat sources, this device protects your little patients so they can grow while making your workflow easier with quick and comfortable access to the baby.

- Redefining Thermoregulation – Keeping the temperature stable
- Welcoming family centered care
- Designed with infection prevention in mind
- Making your workflow easy and more efficient



D-43871-2015

Incubator Cover

The specially designed incubator cover protects the neonate from bright light and helps implement a day and night rhythm. The phototherapy flap enables the use of phototherapy without disturbing other patients in the room.

Softbed Mattress

Thanks to the viscoelastic foam core, the Dräger Softbed mattress supports patient comfort. The design takes into account the special needs of sensitive, immature skin. The soft material minimizes conductive heat losses, which helps contribute to the positive development of the infant since cold stress can be avoided.

Babyleo® Cuddly Toy

Mom holds the toy. The infant can smell her sent for comfort.



D-26324-2020



D-10415-2016



D-27576-2017

ACCESSORIES FOR BABYLEO® TN500 INCUWARMER

CONTAINERS, SHELVES AND HOLDERS

Additional shelf	MK08493
Basket 150	M26146
Basket 300	M26145
Basket 600	M25121
Trash bag container	M24695
Box of trash bags (100 pcs.)	M26240
Infusion arm, vertical rail, 300 60/60	G25885
Small equipment pole 500	G15676
IV pole, 760 mm	MK08876
Swivel arm, vertical rail, VESA, 200	G25773
Swivel arm, vertical rail, VESA, 300	G25774
Swivel arm, vertical rail, slide, 300	G27413
Holder for cylinder packet for GCX profile	4118453
Rail, 100 mm for GCX profile	4118555
Clamp for GCX rail, 5 pcs.	2M60401
Connection hose holder	2M85446
Hook	2M21293

ACCESSORIES FOR DEVELOPMENTAL CARE

Towel doll Babyleo® TN500, lion, orange	MP03737
Incubator cover for Babyleo® TN500, reusable**	MP03730

ACCESSORIES FOR SKIN TEMPERATURE REGULATION

Skin temperature probe ThermoTrace, disposable, yellow, central, 5 pcs.	MX11000
Skin temperature probe ThermoTrace, disposable, white, peripheral, 5 pcs.	MX11001
Cover for skin temperature probe CARE-FOR-ME, hydrogel, disposable, large, 100 pcs.	MU06943
Cover for skin temperature probe CARE-FOR-ME, hydrogel, disposable, small, 100 pcs.	MU06944

ACCESSORIES FOR VENTILATION

Infinity® ACS hinged arm	MP00690
Quickstop hinged arm 1	2M85705
Quickstop hinged arm 2	2M85706

ACCESSORIES FOR SUCTION

Vacuum regulator VarioVac P Rail, max. vacuum -55 kPa, max. flow 20 L/min (676.28 fl. oz./min)	MP00660
Vacuum regulator VarioVac D Rail, max. vacuum -16 kPa, max. flow 18 L/min (608.65 fl.oz./min)	MP00511

Ejector VarioAir P Rail, max. vacuum -48 kPa, max. flow 20 L/min (676.28 fl. oz./min)	MP00545
Ejector VarioAir D Rail, max. vacuum -16 kPa, max. flow 18 L/min (608.65 fl.oz./min)	MP00542
A TN500 suction accessories	MP00598
Cylinder holder	2M85180
Cylinder cap	2M85011
Container	2M85594
Secretion sight glass	M07582
Suction hose	M25780
Connection hose holder	2M85446
Suction hose holder	2M85239
Holder for cylinder packet for GCX profile	4118453

ACCESSORIES FOR PATIENT COMPARTMENT

Mattress SoftBed TN500, reusable*	2M60390
B Heated mattress for TN500	2M60170
Ventilation hose holder, reusable, 40 cm	8411075
Grommet, central***	2060059
Grommet, NE SW***	2M60062
Grommet, NW SE***	2M60063
C Gastroschisis arm, complete	2M60180

SUPPLY ACCESSORIES

Central supply hoses	8601697
----------------------	---------

EXAMINATION LIGHTS

D VarioLux EU	MP00601
---------------	---------

MISCELLANEOUS

O ₂ sensor Oxycell, for Babyleo® TN500	6873065
Air intake filter for Caleo® and Babyleo® TN500, reusable, 20 pcs.	MX17015
Water transfer hose for Caleo® and Babyleo® TN500, disposable, 20 pcs.	MX17018
Dräger USB stick	8416347
Cable for nurse call	2M60773

*Lining: 100% polyurethane, fabric: 100% polyester.

**Outer fabric: 100% polyester, inner fabric: 100% polyester.

***Please order 2 of each part number for complete exchange of grommets



Not all products are available worldwide.

NEONATAL/PEDIATRIC INTENSIVE CARE UNIT (NICU/PICU) ■ THERMOREGULATION ■ CLOSED CARE

Caleo®

The Caleo provides an ideal microenvironment for neonates by delivering advanced thermoregulation parameters. The Caleo was designed to offer intelligent accessibility and the nurturing power of developmental care. It brings ease of use and practical benefits to infants, caregivers and parents.

- Thermomonitoring
- Servo and automatic humidity control
- External electronic tilting mechanism
- Unique Kangaroo Mode
- X-ray without opening sidewall
- Quiet operation



MT-1213-2004

SoftBed™

The Dräger Softbed has been especially designed for neonates. The medical grade viscoelastic memory foam ensures highest comfort for our tiny and fragile patients, while relieving pressure points and preserving skin integrity. The foam is highly ventilated and even washable.

D-27577-2017



ACCESSORIES FOR CALEO®

A	Skin temperature probe ThermoTrace, disposable, yellow, central, 5 pcs.	MX11000
B	Skin temperature probe ThermoTrace, disposable, white, peripheral, 5 pcs.	MX11001
	Cover for skin temperature probe CARE-FOR-ME, hydrogel, disposable, large, 100 pcs.	MU06943
	Cover for skin temperature probe CARE-FOR-ME, hydrogel, disposable, small, 100 pcs.	MU06944
C	Mattress SoftBed, for Caleo®, reusable*	MX17012
D	Air intake filter for Caleo® and Babyleo® TN500, reusable, 20 pcs.	MX17015
E	Infusion holder, 3 hooks, for poles with Ø 38 mm (1.5 in), reusable	2M21514
F	Water transfer hose for Caleo® and Babyleo® TN500, disposable, 20 pcs.	MX17018
G	Tubing grommet for Caleo®, reusable, angle	2M50385
H	Tubing grommet for Caleo®, reusable, flap	2M50412
I	O ₂ sensor OxyTrace, for Caleo®	MX01050
J	Incubator cover for Caleo®, reusable**	MP01423
K	Ventilation hose holder, reusable, 40 cm (15.8 in)	8411075
L	Water tank and water transfer hose, reusable	2M50040

*Lining: 100% polyurethane, fabric: 100% polyester.

**Outer fabric: 100% cotton, inner fabric: 100% polyester.

► Find developmental care products on page 38.

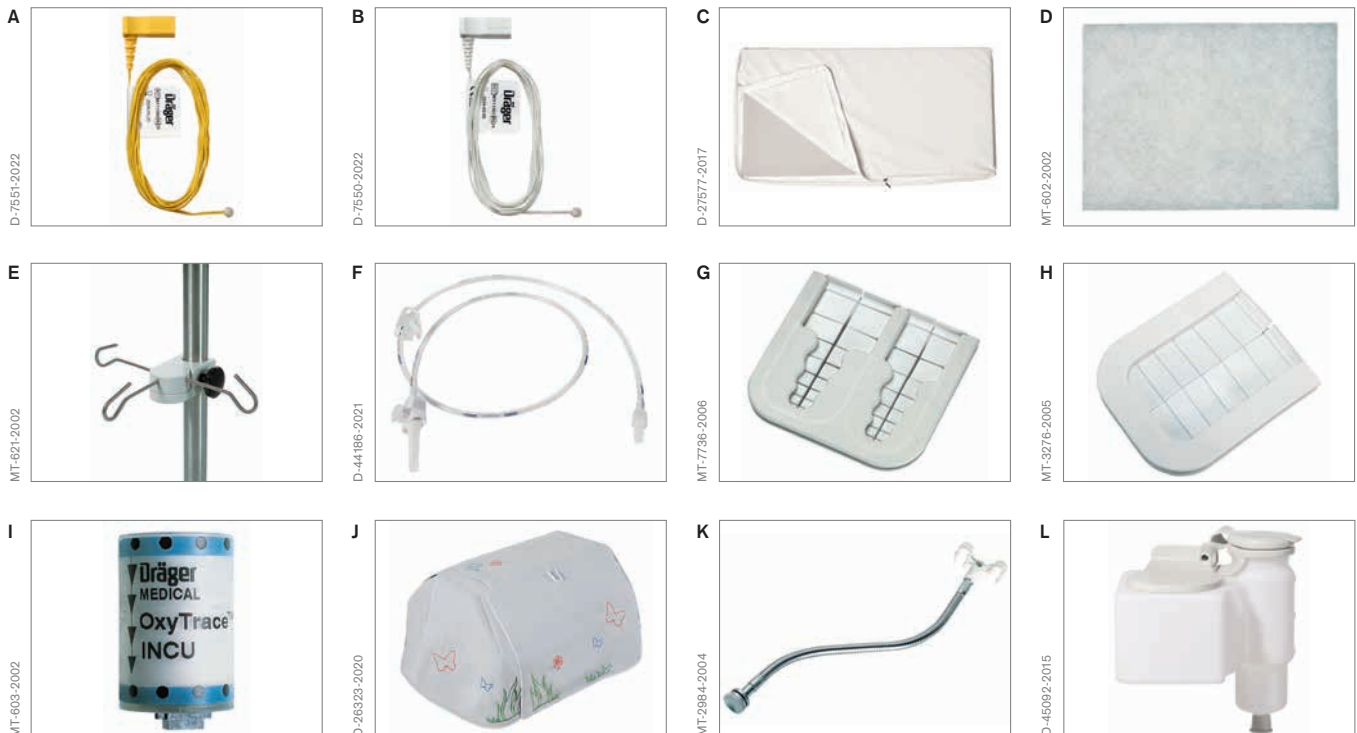

Not all products are available worldwide.

NEONATAL/PEDIATRIC INTENSIVE CARE UNIT (NICU/PICU) ■ THERMOREGULATION ■ CLOSED CARE

Isolette® 8000 plus

Dräger sets the standard for thermoregulation with a host of performance features designed to provide a stable, cocoon-like environment for the baby.

To ensure that the Thermo-Neutral Zone is maintained, the Isolette® 8000 plus enables you to continuously monitor both the central and peripheral body temperature.

- Focused on Developmental Care
- Designed with your workflow in mind



ACCESSORIES FOR ISOLETTE® 8000 PLUS

A	Skin temperature probe Premi-Probe® for Isolette® 8000 plus, disposable, yellow, central, 10 pcs.	MU26041
B	Skin temperature probe Premi-Probe® for Isolette® 8000 plus, disposable, white, peripheral, 10 pcs.	MU26042
	Cover for skin temperature probe CARE-FOR-ME, hydrogel, disposable, large, 100 pcs.	MU06943
	Cover for skin temperature probe CARE-FOR-ME, hydrogel, disposable, small, 100 pcs.	MU06944
C	Mattress SoftBed, for Isolette® C2000, 8000 and 8000 plus***, reusable*	MP01401
C	Mattress SoftBed, for Isolette® 8000 plus, reusable, US only	MP01203
D	Incubator cover for Isolette® C2000, 8000 and 8000 plus, reusable**	MP01424
	Tubing grommet for Isolette® C2000, 8000 and 8000 plus, reusable	MU12609
E	O ₂ sensor for Isolette® C2000, 8000 and 8000 plus, reusable, 2 pcs.	MU24903
F	Air intake filter for Isolette® C2000, 8000 and 8000 plus, reusable, 4 pcs.	MU12504
	Condensate management hoses for Isolette® 8000 and 8000 plus, disposable, 20 pcs.	MU21120
G	Suction bottle with filter and tube, disposable, 800 ml (27.05 fl. oz.), 20 pcs.	MU10918
H	Iris port sleeve, disposable, 100 pcs.	MU03876
	Ventilator tubing support kit	MU18660
	Monitor shelf	MU12937
	Kit, HFV access doors with grommits	MU18916

*Lining: 100% polyurethane, fabric: 100% polyester.

**Outer fabric: 100% cotton, inner fabric: 100% polyester.

***Excluding for US.

► Find developmental care products on page 38.

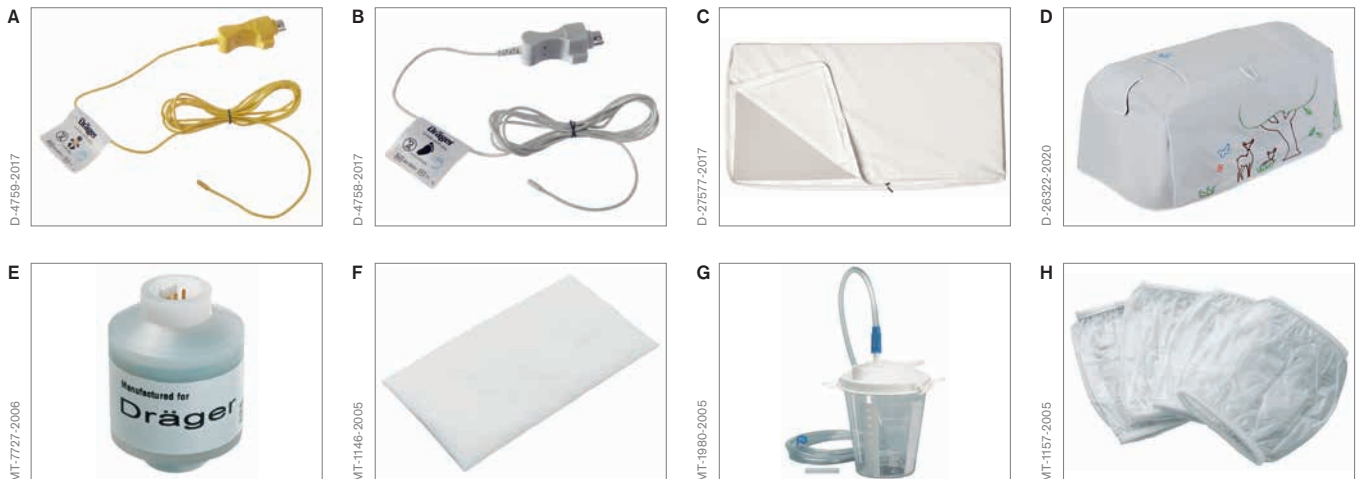

NEONATAL/PEDIATRIC INTENSIVE CARE UNIT (NICU/PICU) ■ THERMOREGULATION ■ CLOSED CARE

Isolette® 8000

Our ability to reliably sustain a stable thermo-neutral microenvironment has made Dräger a trusted resource in thermoregulation. The advanced thermoregulation system in the Isolette® 8000, controlled by Dräger's elaborate PID algorithm, works to keep the baby's temperature stable.

- Dual air curtains
- Dual access panels
- Removable water reservoir and integrated evaporator for complete and easy cleaning

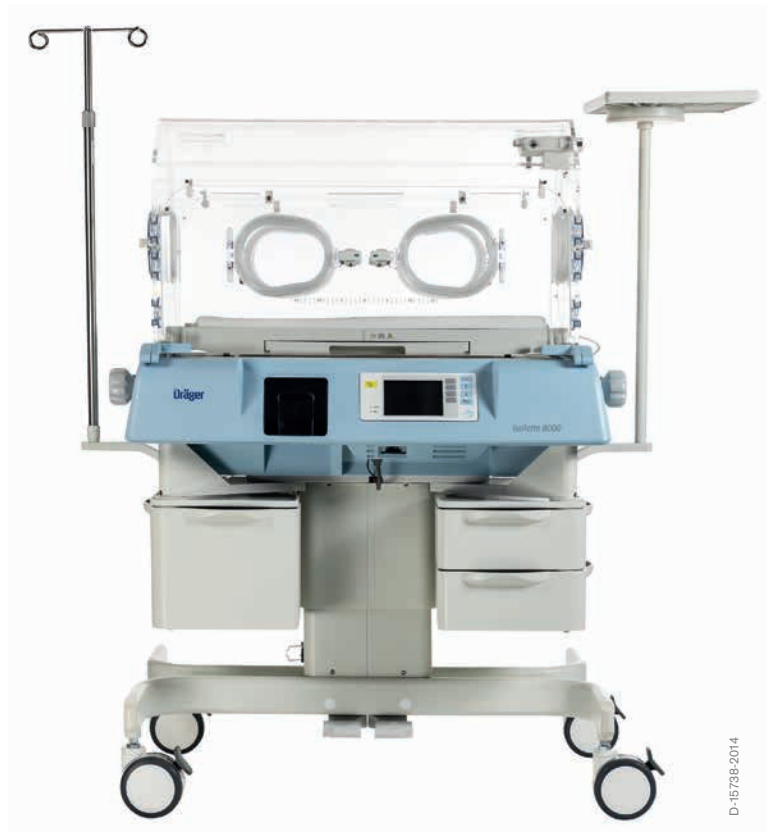

D-15758-2014

Incubator Cover

The specially designed incubator cover protects the neonate from bright light and helps implement a day and night rhythm.

The unique phototherapy flap enables the use of phototherapy without disturbing other patients in the room.



D-26322-2020

ACCESSORIES FOR ISOLETTE® 8000

A	Skin temperature probe Premi-Probe® 5 for kangaroo care, disposable, 1.5 m (59.1 in), 10 pcs.	MU12551
B	Skin temperature probe Premi-Probe® 5, reusable	MU12533
C	Cover for skin temperature probe CARE-FOR-ME, hydrogel, disposable, large, 100 pcs.	MU06943
D	Cover for skin temperature probe CARE-FOR-ME, hydrogel, disposable, small, 100 pcs.	MU06944
E	Mattress SoftBed, for Isolette® C2000, 8000 and 8000 plus, reusable*	MP01401
	Tubing grommet for Isolette® C2000, 8000 and 8000 plus, reusable	MU12609
F	O ₂ sensor for Isolette® C2000, 8000 and 8000 plus, reusable, 2 pcs.	MU24903
G	Air intake filter for Isolette® C2000, 8000 and 8000 plus, reusable, 4 pcs.	MU12504
H	Condensate management hoses for Isolette® 8000 and 8000 plus, disposable, 20 pcs.	MU21120
I	Suction bottle with filter and tube, disposable, 800 ml (27.05 fl. oz.), 20 pcs.	MU10918
J	Iris port sleeve, disposable, 100 pcs.	MU03876
	Ventilator tubing support kit	MU18660
	Oxygen tank bracket	MU12952
	Monitor shelf	MU12937
	Kit, HFV access doors with grommits	MU18916
K	Incubator cover for Isolette® C2000, 8000 and 8000 plus, reusable**	MP01424
L	Cuddling toy Isi, deer green	MP03738

*Lining: 100% polyurethane, fabric: 100% polyester.

**Outer fabric: 100% cotton, inner fabric: 100% polyester.

► Find developmental care products on page 38.

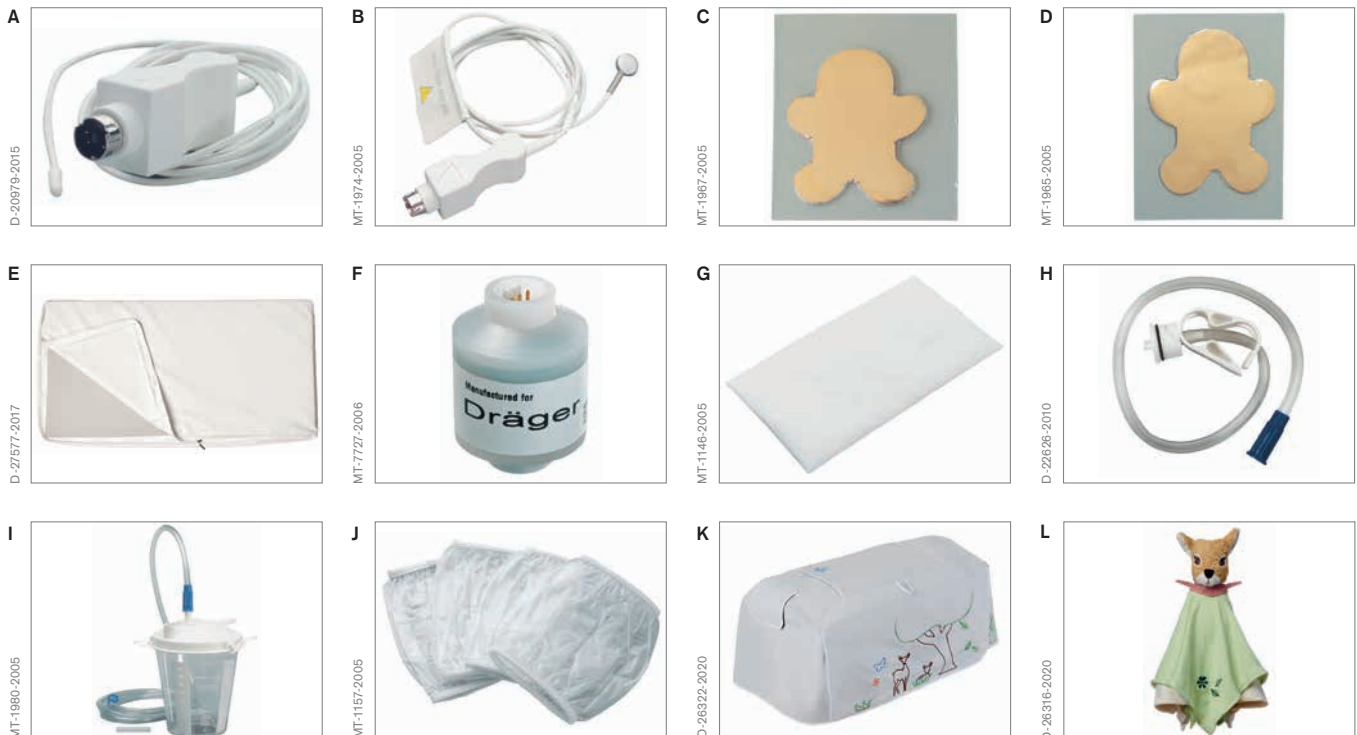

Not all products are available worldwide.

NEONATAL/PEDIATRIC INTENSIVE CARE UNIT (NICU/PICU) ■ THERMOREGULATION ■ CLOSED CARE

Isolette® C2000

Combines the essential microclimate neonates need to thrive with the ergonomics, accessibility and mobility required in today's NICU environments. With its compact design and small footprint it fits easily into almost any NICU design.

- Thermomonitoring
- Dual air curtain
- Humidification
- Front and rear double-wall design



MT-0581-2008

Skin Temperature Probes

Dräger temperature probes ensure safe temperature readings. Probe covers such as CARE-FOR-ME support a stable position of the temperature probes while superior hydrogel protects the immature patient's skin even in high humidity surroundings.



MT-1079-2005

ACCESSORIES FOR ISOLETTE® C2000

A	Skin temperature probe Premi-Probe® 5 for kangaroo care, disposable, 1.5 m (59.1 in), 10 pcs.	MU12551
B	Skin temperature probe Premi-Probe® 5, reusable	MU12533
C	Cover for skin temperature probe CARE-FOR-ME, hydrogel, disposable, large, 100 pcs.	MU06943
D	Cover for skin temperature probe CARE-FOR-ME, hydrogel, disposable, small, 100 pcs.	MU06944
E	Mattress SoftBed, for Isolette® C2000, 8000 and 8000 plus, reusable*	MP01401
F	Tubing grommet for Isolette® C2000, 8000 and 8000 plus, reusable	MU12609
G	O ₂ sensor for Isolette® C2000, 8000 and 8000 plus, reusable, 2 pcs.	MU24903
H	Air intake filter for Isolette® C2000, 8000 and 8000 plus, reusable, 4 pcs.	MU12504
	Iris port sleeve, disposable, soft, 100 pcs.	MU06571
I	Hand port cuff, disposable, oval, 100 pcs.	MU06570
	Ventilator tubing support kit	MU18660
	Oxygen tank bracket	MU12952
	Monitor shelf	MU12937
	Kit, HFV access doors with grommits	MU18916
J	Incubator cover for Isolette® C2000, 8000 and 8000 plus, reusable**	MP01424

*Lining: 100% polyurethane, fabric: 100% polyester.

**Outer fabric: 100% cotton, inner fabric: 100% polyester.

► Find developmental care products on page 38.

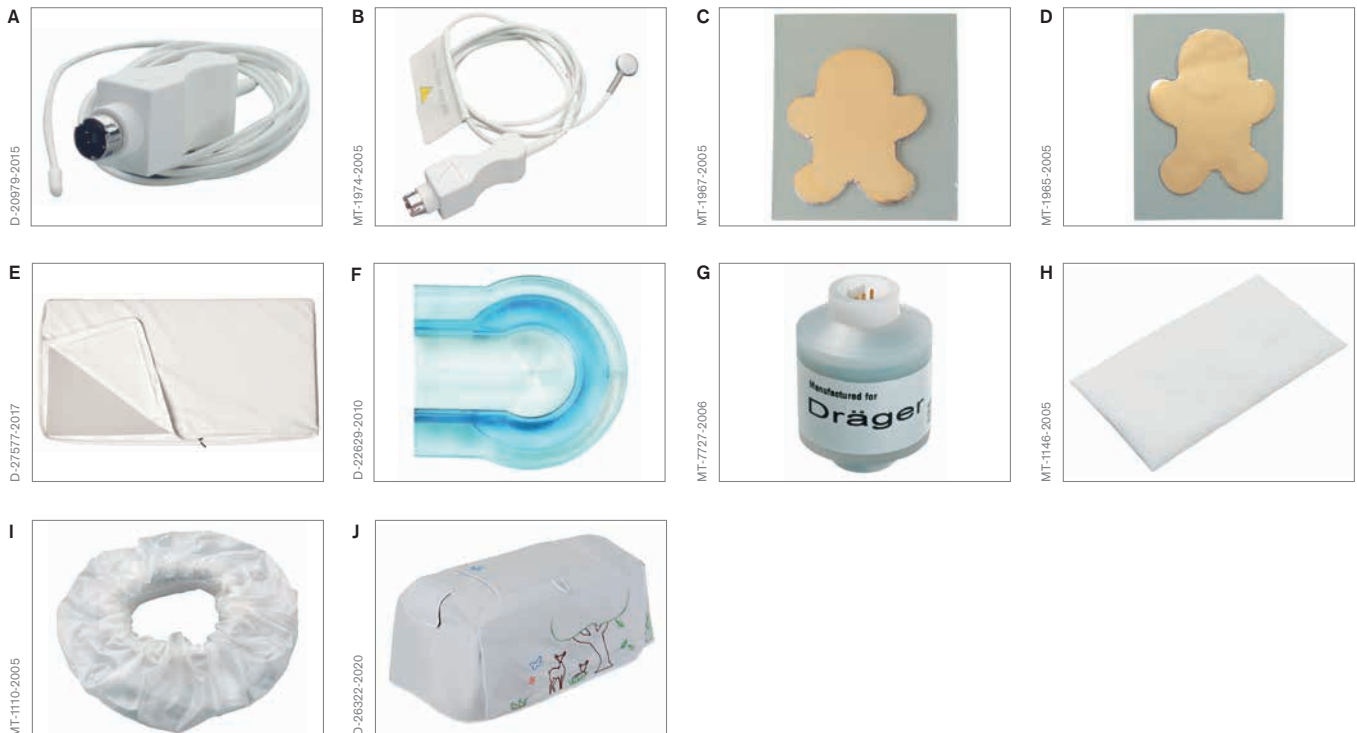

Not all products are available worldwide.

Dräger Babyroo® TN300

The Babyroo® TN300 is a configurable open care warmer with state-of-the-art thermoregulation capabilities as well as advanced integrated technologies to support emergency resuscitation and family-centered care. From the labour & delivery room to the neonatal intensive care unit to the final discharge, the Babyroo® TN300 is scalable to use in a variety of hospital environments along the patient pathway.

- Two combined heat sources
- Central and peripheral temperature monitoring
- Resuscitation module with AutoBreath® and gas mixer options
- SpO₂ and pulse rate measurement
- Integrated scale and pass-through X-ray tray
- Integrated APGAR and SpO₂ pre-ductal target tables
- Features to support developmental care practices



D-36633-2021

Heated gel mattress

The combination of conductive heat of the heatable gel mattress and the radiative heat of the radiant warmer enables a gentle and low-stress warming therapy with reduced fluid loss for premature patients. The mattress is made of high-quality silicone and thus provides a comfortable lying feeling.



D-2406-2021

ACCESSORIES FOR DRÄGER BABYROO® TN300

PATIENT COMPARTMENT		ACCESSORIES FOR SUCTION				
	SoftBed mattress, reusable	MP16297	Vacuum regulator VarioVac P Rail	MP00660		
A	Heated Gel Mattress for BabyTherm 8000/8010 and Babyroo TN300, reusable	2M20827	Vacuum regulator VarioVac D Rail	MP00511		
	Bed canopy	MU27184	Ejector VarioAir D Rail	MP00542		
	Support for bed canopy	2M21342	Ejector VarioAir P Rail	MP00545		
	Side wall, 23 cm	MU26449	Suction bottle with filter and tube, 800 ml (27.05 fl. oz.), 20 pcs.	MU10918		
	Side wall, 15 cm	MU26448	Suction canister holder for GCX	3702751		
	Side wall, 15 cm, HFV	MU26739				
	Side wall, 23 cm, HFV	MU26740				
	Mini-wall	2M20936				
DEVELOPMENTAL CARE		GAS SUPPLY				
B	Cuddling toy	MP16090	Central supply hoses	8601697		
SKIN TEMPERATURE REGULATION		EXAMINATION LIGHTS				
C	Skin temperature probe ThermoTrace, disposable, yellow, central, 5 pcs.	MX11000	H VarioLux EU	MP00601		
D	Skin temperature probe ThermoTrace, disposable, white, peripheral, 5 pcs.	MX11001	VarioLux US	MP00602		
	Cover for skin temperature probe CARE-FOR-ME, hydrogel, disposable, large, 100 pcs.	MU06943	VarioLux GB	MP00603		
	Cover for skin temperature probe CARE-FOR-ME, hydrogel, disposable, small, 100 pcs.	MU06944	VarioLux AUS	MP00606		
			VarioLux JP	MP00608		
BREATHING CIRCUITS		PHOTOTHERAPY				
E	VentStar® Autobreath N, disposable breathing circuit for Resuscitaire® and TN 300, 25 pcs.	MU10841	Dräger BiliLux	MU20100		
	VentStar® circuit without Pressure Measurement	MP00310				
MASKS		SPO ₂	US	JP		
F	Silicone mask, reusable, size 00, small neonate	MP02900	Masimo® SET Mcable	MS20667		
	Silicone mask, reusable, size 0, small neonate	MP01910	Masimo® cable RD SET, 1.5 m	MS33755	MS33744	MS33736
	Silicone mask, reusable, size 1, large neonate	MP01911	Masimo® cable RD SET, 3.6 m	MS33756	MS33775	MS33737
			Masimo® cable LNCS, 1.2 m	MP03027	MP03106	MP00800
			Masimo® cable LNCS, 3 m	MP03025	MP03107	MP00797
			Masimo® cable LNCS, 4.3 m	MP03026	MP03105	MP03194
			SpO ₂ Masimo® sensor LNCS-YI Multi	MP03023	MP03102	MP00789
			Masimo® SpO ₂ sensor RD SET NeoPt, box of 20	MS33749	MS33768	MS33730
			Masimo® SpO ₂ sensor RD SET Neo, box of 20	MS33748	MS33767	MS33729
			Masimo® SpO ₂ sensor LNCS Neo, box of 20	MP03014	MP03092	MP00792
			Masimo® SpO ₂ sensor LNCS NeoPt., box of 20	MP03015	MP03093	MP00794
			Masimo® trauma sensor LNCS Neo	MP03017	MP03095	MP03192
SEATTLE PAP						
G	Seattle PAP plus	MP02260				
	Seattle PAP	MP02250				
HUMIDIFIER						
	F&P configuration for MR850 and F&P950	8414144				



Not all products are available worldwide.

Babytherm® 8004/8010

Dräger's Babytherm® infant warming systems sets standards in open care – supporting premature and full-term neonates with a unique thermal environment, while giving you ease of access so you can provide the best possible care.

- SmartSwivel radiant heater
- ThermoMonitoring
- Quick heat up
- Heated conductive gel mattress (Babytherm® 8010)
- X-ray tray (Babytherm® 8004)
- Integrated Phototherapy option
- Integrated scale option



MT-1223-2004

Warm Gel Mattress

The soft feel and soothing comfort of the actively heatable gel mattress enables the reduction of the radiant heater output, which in turn reduces insensible water loss. In addition, the combination of conductive warmth from the heated gel mattress and radiant warmth from the overhead heater allows you to warm up cold babies quickly.



MT-2979-2004

ACCESSORIES FOR BABYTHERM® 8004/8010

A	Skin temperature probe ThermoTrace, disposable, yellow, central, 5 pcs.	MX11000	G	Ejector VarioAir P Rail, max. vacuum -48 kPa, max. flow 20 L/min (676.28 fl. oz./min)	MP00545
B	Skin temperature probe ThermoTrace, disposable, white, peripheral, 5 pcs.	MX11001	H	Vacuum regulator VarioVac P Rail, max. vacuum -55 kPa, max. flow 20 L/min (676.28 fl. oz./min)	MP00660
	Cover for skin temperature probe CARE-FOR-ME, hydrogel, disposable, large, 100 pcs.	MU06943	I	Ejector VarioAir D Rail, max. vacuum -16 kPa, max. flow 18 L/min (608.65 fl.oz./min)	MP00542
	Cover for skin temperature probe CARE-FOR-ME, hydrogel, disposable, small, 100 pcs.	MU06944	J	Vacuum regulator VarioVac D Rail, max. vacuum -16 kPa, max. flow 18 L/min (608.65 fl.oz./min)	MP00511
C	Heated Gel Mattress for BabyTherm 8000/8010 and Babyroo TN300, reusable	2M20827		Bottle package 1 × 0.7 l (23.67 fl. oz.)	
D	Mattress SoftBed, for Babytherm®, reusable*	2M21012	K	Rail clamp, for attachment to poles of different diameters	2M85274
E	Holder for hinged hood for Babytherm® 8000 WB, 8004 and 8010, neonatal, mounts to hand rail, reusable	2M21342	L	Secretion jar set, with rail holder and secretion jar 700 ml (23.67 fl. oz.)	2M85163
F	Breathing hose holder for Babytherm®, neonatal, for 10 mm (0.4 in) breathing hose, mounts to Babytherm® side access panels	2M21191		Bottle package 2 × 0.7 L (23.67 fl. oz.)	
	SUCTION FOR BABYTHERM®		M	Wall holder, with fixing screws, for compact suction unit and secretion jar set	M26859
	Bronchial compact suction (choose one regulator)		N	Secretion jar set, 2 × 0.7 L (23.67 fl. oz.) volume	2M85056

*Lining: 100% polyurethane, fabric: 100% polyester.

▶ Find developmental care products on page 38.

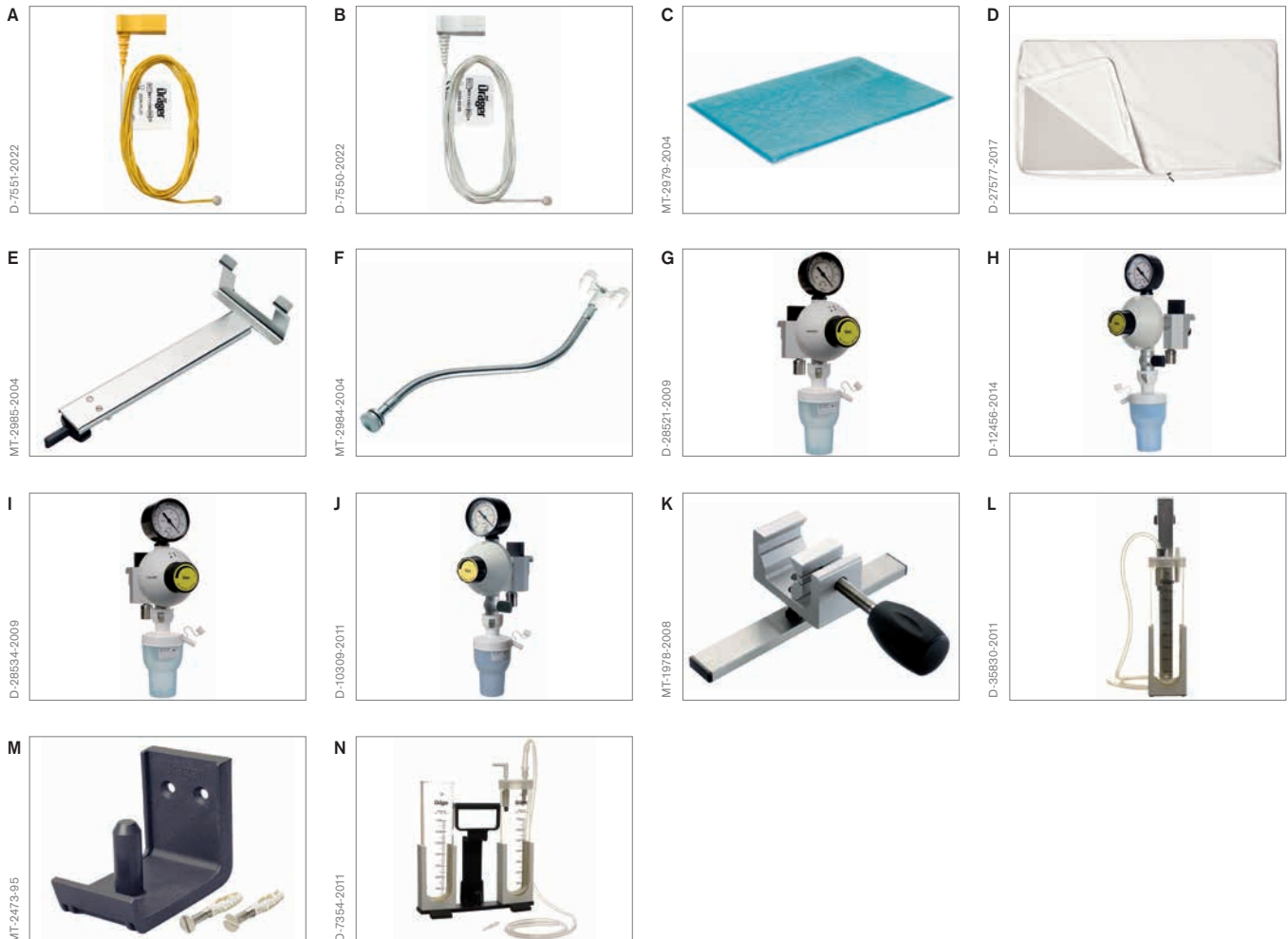

Not all products are available worldwide.

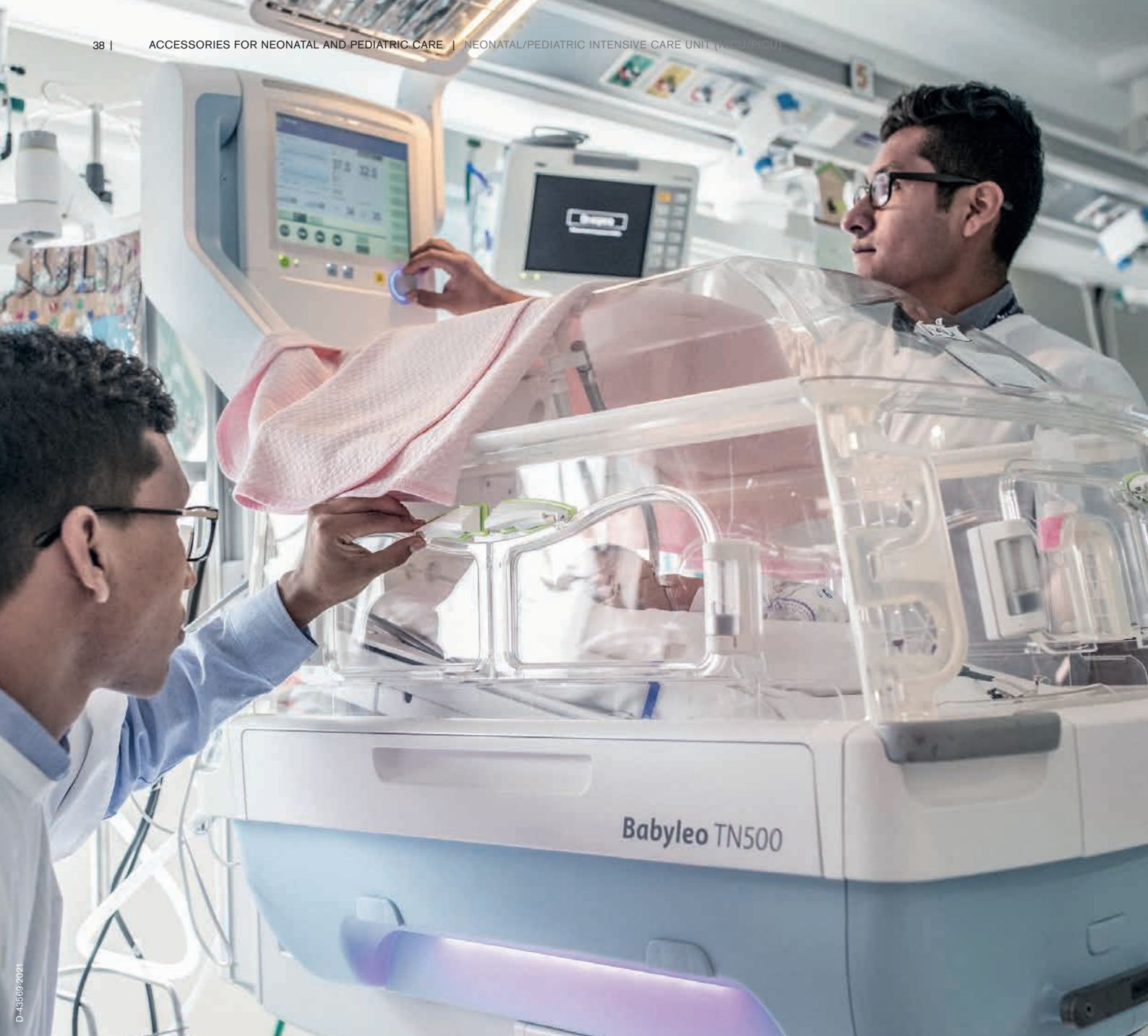

Developmental Care

Developmental Care is the human counterpart to high tech medical and pharmacological care in the NICU and seeks to look at each infant individually, using the infant's response as the guide for delivering care. Healthcare professionals not only have to assure the infants' survival, but have to optimise their developmental course and outcome. Even in the absence of disability, there are high reported rates of difficulties in attention, behaviour and cognition. Greater emphasis is now being placed on improvement of neurodevelopmental outcomes.*

Appropriate covers for the incubators dampen light and noise. The design and functionalities of Babyleo TN500 as well as its accessories like the hood cover, transform an incubator into a cozy space and minimizes the disturbances coming from the surrounding equipment. This also comforts the parents, giving their child the best temporary "home" possible.

* Kenner A, McGrath J, NANN, Developmental Care of Newborns & Infants: A Guide for Health Professionals (Developmental Care of Newborns & Infants: A Guide for Health Professionals). Mosby. 2004; Bustani P C Developmental care: does it make a difference? Arch Dis Child – Fetal and Neonatal Edition 2008;93:F317-F321.

GENTLE CARE ACCESSORIES

A	Incubator cover for Babyleo® TN500, reusable*	MP03730	H	SoundEar®	G24925
B	Incubator cover for Caleo®, reusable*	MP01423	H	SoundEar® plug power supply	G24926
C	Incubator cover for Isolette® C2000, 8000 and 8000 plus, reusable*	MP01424			
				*Outer fabric: 100% polyester, inner fabric: 100% polyester.	
D	Cuddling toy Cally, reusable, light blue or pink	2M30462		With our devices and accessories we easily provide Bonding and Kangarooing. There are e.g. extra long breathing circuits or TempProbes for Kangaroo Care.	
E	Cuddling toy Babyleo® TN500, lion, orange	MP03737			
F	Cuddling toy Isi, deer green	MP03738			
G	Cuddling toy	MP16090			



Not all products are available worldwide.

NEONATAL/PEDIATRIC INTENSIVE CARE UNIT (NICU/PICU) ■ INVASIVE AND NON-INVASIVE VENTILATION

Babylog® VN800 and Babylog® VN600*

In order to prevent pulmonary injury, immature lungs and underdeveloped breathing require extremely gentle ventilation and advanced technology. Babylog® VN800 and VN600 provide high-performance ventilation capabilities from conventional to high-frequency oscillation, non-invasive ventilation as well as oxygen therapy*.

- Set of treatment tools in order to apply lung and brain protective ventilation strategies
- Ease of use with a tablet-like operating philosophy
- Flexible workplace integration and transport option

*Not all products and functions are available worldwide.



D-992-2019



D-991-2019



D-15747-2018

BABYFLOW® PLUS – ACCESSORIES FOR NON-INVASIVE RESPIRATORY SUPPORT

We want your patients to feel comfortable. The less discomfort a patient experiences, the greater the opportunity for healthy growth and development.

The BabyFlow® plus respiratory support system is designed to address the current issues with non-invasive respiratory support therapy. Every single component, including individually sized masks and nasal prongs, has been engineered to maximize performance and patient comfort.

ACCESSORIES FOR BABYLOG® VN800 AND BABYLOG® VN600

A	VentStar® Helix, dual heated (N) plus	MP02650	Silencer	8415230
B	VentStar® Helix, heated (N) plus	MP02608	Membrane, complete (for exhalation valve)	8413661
C	Humidifier Chamber (N), disposable, 10 pcs.	MP02590	Humidifier holder chassis, swiveling	G93111
	Reusable Breathing circuit (N), 900MR782*	MP17128	Humidifier holder for side rail	8416325
D	CO ₂ cuvette disposable, pediatric, 10 pcs.	MP01063	Universal holder with DIN rail	G93140
E	CO ₂ cuvette reusable, pediatric, for CO ₂ sensors 6871500, 6870300, 6871950	6870280	Rail clamp for F&P humidifier	8411074
	CO ₂ mainstream sensor, for Evita® Infinity® V500, Babylog® VN500 and V(VN)600/800, Infinity® M540 and Oxylog® 3000 plus, reusable	6871950	Gas bottle holder	G93110
F	Medication nebulizer Aeroneb Pro	MP01010	Water bag holder 900 MR 290	MP01008
G	Nebulizer unit with filler cap for Aeroneb Pro	MP01030	Holder, lateral (F&P 900 MR 309), including 8411074	MP01009
H	T-piece set with plug for Aeroneb Pro (N), 15 mm (0.6 in), w/ adapter 10 mm (0.4 in), 5 pcs.	MP01032	Bedside rail claw for bed coupling	8419801
I	T-connector for Aeroneb Pro (N), 12 mm (0.5 in), with plug, 5 pcs.	MP01037	Pressure reducer OxyLine for bottle operation	MP00100
J	Pneumatic medication nebulizer (P/N)	8411030	L Hinged arm Infinity® ACS	MP00690
	Demo lung to simulate neonatal lungs, with suitcase	8418077	Hinged arm 240°	8409609
	Neonatal Test Lung, reusable, 50 ml, 1 pc.	MP20050	Hinged arm Quickstop 2, w/ universal ball holder system	2M85706
	Expiratory valve, for neonatal/pediatric patients (Non-RFID), reusable	8415296		
K	Neonatal flow sensor ISO 15, PSU, reusable, (N/P)	8411130		
	Insert for neonatal flow sensor, PSU, sterilizable, 5 pcs.	8410179		
	Flow sensor cable for V-series with Neo option and VN-series	8416600		

*Tradeware

► Find BabyFlow® plus on page 56.

Find Active Humidification – Aquapor H300 on page 60.

Find Active Humidification – F&P humidifier MR850 and F&P950 on page 64.

For more device-specific accessories, please have a look at the Babylog® & more catalog.



Not all products are available worldwide.

NEONATAL/PEDIATRIC INTENSIVE CARE UNIT (NICU/PICU) ■ INVASIVE AND NON-INVASIVE VENTILATION

Babylog® VN500*

The Babylog® VN500 provides comprehensive, state-of-the-art ventilation therapy for neonatal and pediatric patients. Conventional and non-invasive ventilation functionalities offer the clinician a wide range of modern therapy and monitoring assessment tools in a single device.

- Smart Pulmonary View
- Flexible transport and back up solutions
- Sensitive proximal triggering system
- Intuitive user interface with color touch screen
- Comprehensive conventional ventilation options
- Non-invasive respiratory support modi and oxygen therapy
- Powerful High Frequency Oscillation**

*Component of Infinity® Acute Care System Workstation Neonatal Care.

**This functionality is not available in the US.



D-73341-2012



D-48865-2015

MASKS AND PRONGS

The carefully produced silicone prongs and masks are available in different sizes. Their shapes are optimised anatomically, and ensure both safe use and an outstanding fit, despite specific facial features.

ACCESSORIES FOR BABYLOG® VN500

A	VentStar® Helix, dual heated (N) plus	MP02650	Silencer	8415230
B	VentStar® Helix, heated (N) plus	MP02608	Membrane, complete (for exhalation valve)	8413661
	Reusable Breathing circuit (N), 900MR782*	MP17128	Humidifier holder chassis, swiveling	G93111
C	Humidifier Chamber (N), disposable, 10 pcs.	MP02590	Humidifier holder for side rail	8416325
D	CO ₂ cuvette disposable, pediatric, 10 pcs.	MP01063	Universal holder with DIN rail	G93140
	CO ₂ cuvette reusable, pediatric, for CO ₂ sensors 6871500, 6870300, 6871950	6870280	Rail clamp for F&P humidifier	8411074
	CO ₂ mainstream sensor, for Evita® Infinity® V500, Babylog® VN500 and V(VN)600/800, Infinity® M540 and Oxylog® 3000 plus, reusable	6871950	Gas bottle holder	G93110
E	Medication nebulizer Aeroneb Pro	MP01010	Water bag holder 900 MR 290	MP01008
F	Nebulizer unit with filler cap for Aeroneb Pro	MP01030	Holder, lateral (F&P 900 MR 309), including 8411074	MP01009
G	T-piece set with plug for Aeroneb Pro (N), 15 mm (0.6 in), w/ adapter 10 mm (0.4 in), 5 pcs.	MP01032	Bedside rail claw for bed coupling	8419801
H	T-connector for Aeroneb Pro (N), 12 mm (0.5 in), with plug, 5 pcs.	MP01037	Pressure reducer OxyLine for bottle operation	MP00100
I	Pneumatic medication nebulizer (P/N)	8411030	L Hinged arm Infinity® ACS	MP00690
	Demo lung to simulate neonatal lungs, with suitcase	8418077	Hinged arm 240°	8409609
J	Neonatal Test Lung, reusable, 50 ml, 1 pc.	MP20050	Hinged arm Quickstop 2, w/ universal ball holder system	2M85706
	Expiratory valve, for neonatal/pediatric patients (Non-RFID), reusable	8415296		
	Expiratory valve for Babylog® VN 500, reusable	8415270		
K	Neonatal flow sensor ISO 15, PSU, reusable, (N/P)	8411130		
	Insert for neonatal flow sensor, PSU, sterilizable, 5 pcs.	8410179		
	Flow sensor cable for V-series with Neo option and VN-series	8416600		

*Tradeware

► Find BabyFlow® plus on page 56.

Find Active Humidification – Aquapor H300 on page 60.

Find Active Humidification – F&P humidifier MR850
and F&P950 on page 64.For more device-specific accessories,
please have a look at the Babylog® & more catalog.

Not all products are available worldwide.

Babylog® 8000 plus

If you use a Babylog® 8000 plus, you can be sure you're giving the little patient in your care the best possible ventilation. Whatever mode you require – CPAP, IMV, triggered modes such as SIMV, SIPPV, Pressure Support Ventilation or Volume Guarantee – the Babylog® 8000 plus can meet your demands.

An operating concept designed to fit to your needs as a user and a tailored monitoring system serve to optimize ventilation. This frees you from many arduous tasks usually associated with device operation so you can spend more time concentrating on your little patient.

- Pressure support ventilation
- Volume Guarantee
- BabyFlow® system for non-invasive respiratory support
- Easy operation, ergonomic design



D-19879-2015



D-46881-2015

MICROFIBER CAPS

The flexible and breathable microfiber caps are available in seven sizes.

The disposable caps include side straps and top straps to help secure and stabilize the BabyFlow® plus.

ACCESSORIES FOR BABYLOG® 8000 PLUS

A	VentStar® Helix, dual heated (N) plus	MP02650
B	VentStar® Helix, heated (N) plus	MP02608
C	Humidifier Chamber (N), disposable, 10 pcs.	MP02590
	Reusable Breathing circuit (N), 900MR782*	MP17128
D	Pneumatic medication nebulizer (P/N)	8411030
	Expiratory valve for Babylog® 8000	8408950
E	Neonatal flow sensor ISO 15, PSU, reusable, (N/P)	8411130
F	Insert for neonatal flow sensor, PSU, sterilizable, 5 pcs.	8410179
G	Flow sensor cable, for neonatal flow sensor, e.g., Babylog® 8000 plus	8409626
	Demo lung to simulate neonatal lungs, with suitcase	8418077
H	Neonatal Test Lung, reusable, 50 ml, 1 pc.	MP20050
I	Medication nebulizer Aeroneb Pro	MP01010
J	Nebulizer unit with filler cap for Aeroneb Pro	MP01030
K	T-piece set with plug for Aeroneb Pro (N), 15 mm (0.6 in), w/ adapter 10 mm (0.4 in), 5 pcs.	MP01032
L	T-connector for Aeroneb Pro, 12 mm (0.5 in), with plug, 5 pcs.	MP01037

Hinged arm 240°	8409609
Hinged arm Quickstop 2, w/ universal ball holder system	2M85706
Rail clamp for F&P humidifier	8411074
Holder for F&P humidifier U-shaped, for trolley, with rail clamp	MP01002
Water bag holder 900 MR 290	MP01008

*Tradeware

► Find BabyFlow® plus on page 56.

Find Active Humidification – Aquapor H300 on page 60.

Find Active Humidification – F&P humidifier MR850 on page 64.

For more device-specific accessories, please have a look at the Babylog® & more catalog.



Not all products are available worldwide.

NEONATAL/PEDIATRIC INTENSIVE CARE UNIT (NICU/PICU) ■ INVASIVE AND NON-INVASIVE VENTILATION

Evita® V800, Evita® V600, Evita® Infinity® V500 and Evita® V300

In intensive care, where the patient range covers adults, infants and neonates, one ventilator for all patient types is often desired. The option Neonatal ventilation for Evita® V800/V600 and the option NeoFlow® for Evita® Infinity® V500 and Evita® V300 provides precision ventilation for patients of every age. The options offer flow measurement at the Y-piece. This provides precise, compliance-independent volume monitoring of the patient system hose and allows accurate and responsive triggering in neonatal patients.

- Proximal flow sensor at Y-piece for precise flow/volume monitoring and quick trigger response
- Down to 2 ml in volume control ventilation
- Pressure control and volume guarantee with AutoFlow®
- Automatic leakage compensation (ATC®)
- Continuous base flow of 6 L/min
- Compensation of hose compliance



D-990-2019

Evita® V800



D-989-2019

Evita® V600



D-2106-2015

Evita® Infinity® V500



D-2103-2015

Evita® V300

ACCESSORIES FOR EVITA® V800, EVITA® V600, EVITA® INFINITY® V500 AND EVITA® V300

A	Breathing circuit VentStar® (P), disposable, basic, 1.8 m (5.9 ft), 25 pcs., not made with natural rubber latex	MP00351	Infinity® ID, expiratory valve, for Evita V500/V300, disposable, 10 pcs.	MP01060/ MP20108
B	Breathing circuit VentStar®, disposable, N, heated, 1.2 m, 10 pcs., not made with natural rubber latex	MP00308	Expiratory valve, for Evita V600/V800, disposable, 10 pcs.	MP01061/ MP20109
	VentStar® MRI (N) 300, 3 m, 10 pcs.	MP04802	Expiratory valve for Evita V500/V300, reusable	8415270
C	VentStar® Helix, dual heated, 10 pcs.	MP02606	Expiratory valve for Evita Infinity® V500/V300, reusable	8416750
D	VentStar® Helix, heated, 10 pcs.	MP02607	Expiratory valve for Evita V600/V800, reusable, for adult/pediatric patients	8417050
E	VentStar® Helix, heated (N) plus	MP02608	Exhalation valve for Evita V600/V800, reusable, for neonates/pediatric patients	8415296
	VentStar® Helix, dual heated (N) plus	MP02650	Neonatal Test Lung, reusable, 50 ml, 1 pc.	MP20050
	VentStar® Aquapor dual heated, Adult and Pediatric, 10 pcs.	MP07130	Neonatal flow sensor ISO 15, PSU, reusable, (N/P)	8411130
	VentStar® Aquapor, heated, Adult and Pediatric, 10 pcs.	MP07131	Insert for neonatal flow sensor, PSU, sterilizable, 5 pcs.	8410179
	VentStar® Aquapor, dual heated, N plus, 10 pcs.	MP07150	Flow sensor cable for V-series with Neo option and VN-series	8416600
	VentStar® Aquapor, heated, N plus, 10 pcs.	MP07151	Membrane, complete (for exhalation valve)	8413661
	Reusable Breathing circuit (N), 900MR782*	MP17128	Humidifier holder chassis, swiveling	G93111
	Reusable Breathing circuit (A), 900MR784*	MP17129	Universal holder with DIN rail	G93140
F	BlueSet Ventilation HME (A/P), reusable	8412860	Humidifier holder for side rail	8416325
	Double connector 11ID/15OD, disposable, 10 pcs.	MP02655	Water bag holder 900 MR 290	MP01008
G	CO ₂ cuvette reusable, pediatric, for CO ₂ sensors 6871500, 6870300, 6871950	6870280	Holder, lateral (F&P 900 MR 309), including 8411074	MP01009
H	CO ₂ cuvette disposable, pediatric, 10 pcs.	MP01063	Infinity® ACS hinged arm	MP00690
	CO ₂ mainstream sensor, for Evita® Infinity® V500, Babylog® VN500 and V(VN)600/800, Infinity® M540 and Oxylog® 3000 plus, reusable	6871950	Quickstop hinged arm 2	2M85706
	Demo lung to simulate neonatal lungs, with suitcase	8418077	Hinged arm 240°	8409609

*Tradeware

► Find BabyFlow® plus on page 56.

Find Active Humidification – Aquapor H300 on page 60.

Find Active Humidification – F&P humidifier MR850 and F&P950 on page 64.

For more device-specific accessories, please have a look at the Evita® & more catalog.

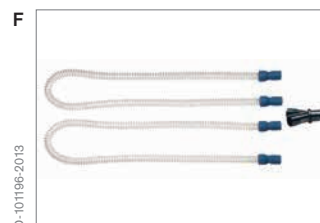

Not all products are available worldwide.

NEONATAL/PEDIATRIC INTENSIVE CARE UNIT (NICU/PICU) ■ INVASIVE AND NON-INVASIVE VENTILATION

Evita® XL and Evita® 4 edition

In intensive care, where the patient range covers adults, infants and neonates, one ventilator for all patient types is often desired. The option Neonatal ventilation for Evita® XL and Evita® 4 edition provides precision ventilation for patients of every age.

The options offer flow measurement at the Y-piece. This provides precise, compliance-independent volume monitoring of the patient system hose and allows accurate and responsive triggering in neonatal patients.

- Proximal flow sensor at Y-piece for precise flow/volume monitoring and quick trigger response
- Down to 2 ml in volume control ventilation
- Pressure control and volume guarantee with AutoFlow®
- Automatic leakage compensation (ATC®)
- Continuous base flow of 6 L/min
- Compensation of hose compliance



MT-6127-2008



MT-1026-2008

ACCESSORIES FOR EVITA® XL AND EVITA® 4 EDITION

Reusable Breathing circuit (N), 900MR782*	MP17128	H Neonatal flow sensor ISO 15, PSU, reusable, (N/P)	8411130
Reusable Breathing circuit (A), 900MR784*	MP17129	I Insert for neonatal flow sensor, PSU, sterilizable, 5 pcs.	8410179
CO ₂ cuvette disposable, pediatric, 10 pcs.	MP01063	J Flow sensor cable, for neonatal flow sensor	8409626
CO ₂ cuvette reusable, pediatric, for CO ₂ sensors 6871500, 6870300, 6871950	6870280	Hinged arm 240°	8409609
CO ₂ mainstream sensor, for Evita® 2 dura, Evita® 4 Edition and Evita® XL	6871500	Hinged arm Quickstop 2	2M85706
Expiratory valve for Evita®, reusable	8410580	Rail clamp for F&P humidifier and Seattle PAP bubble box	8411074
Membrane for Evita® 2 dura, Evita® 4 edition, Evita® XL, for expiratory valve	8412015	Holder for F&P humidifier U-shaped, for trolley, with rail clamp	MP01002
A Water trap for Evita® 2 dura, Evita® 4 edition, Evita® XL, reusable	8413125		
B Demo lung to simulate neonatal lungs, with suitcase	8418077		
C Neonatal Test Lung, reusable, 50 ml, 1 pc.	MP20050		
D Pack2Go® Evita® invasive vent. pack w/ breathing circuit VentStar®, basic, + cuvette (only for Evita® XL and Evita® 4 edition)	MP01656		
E Pack2Go® Evita® invasive vent. pack w/ breathing circuit VentStar®, basic, 1.8 m (5.9 ft) (only for Evita® XL and Evita® 4 edition)	MP01657		
F Pack2Go® Evita® invasive vent. pack w/ breathing circuit VentStar®, coaxial, + cuvette (only for Evita® XL and Evita® 4 edition)	MP01676		
G Pack2Go® Evita® invasive vent. pack w/ breathing circuit VentStar®, coaxial, 1.8 m (5.9 ft) (only for Evita® XL and Evita® 4 edition)	MP01677		

*Tradeware

► Find BabyFlow® plus on page 56.

Find Active Humidification – Aquapor H300 on page 60.

Find Active Humidification – F&P humidifier MR850 on page 64.

For more device-specific accessories,
please have a look at the Evita® & more catalog.

Not all products are available worldwide.

NEONATAL/PEDIATRIC INTENSIVE CARE UNIT (NICU/PICU) ■ INVASIVE AND NON-INVASIVE VENTILATION

Savina® 300 Select

Around the globe, Savina® ventilators have provided more than 2 billion hours of quality ventilation.

The Savina® 300 Select comes with an integrated safety concept that makes it a partner you can rely on. It is designed to meet the ventilation needs of even critical ill patients (infants starting from 5 kg body weight to adults), yet it is flexible enough to be used nearly anywhere in your hospital.

- Optimised flow/volume monitoring and quick trigger response
- Down to 20 ml in volume control ventilation
- AutoFlow®
- Automatic leakage compensation (ATC®)
- Compensation of hose compliance



D-12285-2016



D-46399-2015

Option PediatricPlus (8421316)

ACCESSORIES FOR SAVINA® 300 SELECT

	Reusable Breathing circuit (A), 900MR784*	MP17129		
A	BlueSet Ventilation (N/P), reusable consists of breathing circuits, 2 water traps, Y-piece and catheter mounts	8412344	I	Medication nebulizer Aeroneb Pro (please consider country-specific specification)
B	Blue Set Ventilation (A/P), reusable	8413146		MP01010
C	BlueSet Ventilation HME (A/P), reusable	8412860		Pneum. Medication Nebulizer
D	Breathing circuit VentStar® (P), disposable, water trap, 1.8 m (5.9 ft), 25 pcs., not made with natural rubber latex	MP00361		8412935
E	Breathing circuit VentStar® (P), disposable, coaxial, 1.5 m (4.9 in), 20 pcs., not made with natural rubber latex	MP00379		Humidifier holder chassis, swiveling
	CO₂ cuvette disposable, pediatric, 10 pcs.	MP01063		G93111
	CO₂ cuvette reusable, pediatric	6870280		Universal holder with DIN rail
	Expiratory valve for Savina® 300 Select, reusable	8417050		G93140
F	Expiratory valve, disposable, 10 pcs.	MP01061		Rail clamp for F&P humidifier
G	Pack2Go® Savina® invasive ventilation pack with breathing circuit VentStar®, coaxial, 1.8 m (5.9 ft)	MP01673		8411074
H	Pack2Go® Savina® invasive ventilation pack with breathing circuit VentStar®, basic, 1.8 m (5.9 ft)	MP01674	J	Water bag holder 900 MR 290
				MP01008
				Flow sensor SpiroLife®, PPSU, sterilizable
				MK01900
				Flow sensor Spirolog®, PC/ABS, 5 pcs.
				8403735
				CO₂ sensor Savina 300
				8420757

*Tradeware

▶ Find Active Humidification – Aquapor H300 on page 60.

Find Active Humidification – F&P humidifier MR850 on page 64.

For more device-specific accessories, please have a look at the Savina® & more catalog.

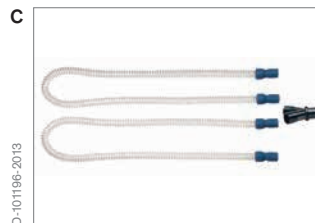

Not all products are available worldwide.

Dräger PulmoVista® 500

Electrode belt and patient cable for pediatric patients

PulmoVista® 500 enables assessment of regional ventilation distribution as well as changes in endexpiratory lung volumes. You can observe the effects of therapeutic manoeuvres and monitor the results over time. With these insights, PulmoVista® 500 helps you maintain the best possible distribution of air within the lungs. Electrical impedance tomography visualizes adverse effects such as atelectasis, overinflation, air-trapping, pleural effusion or pneumothorax.

Clinical Scenarios¹⁾

- Assessing response to recruitment maneuvers and PEEP optimization.
- Detecting pleural effusion.
- Assessing the effect of position changes.
- Assessing weaning progression.



D-5534-2010



D-6835-2019

Dedicated electrode belt and patient cable for pediatric patients: from infants to adolescents. Making ventilation visible and enabling truly personalized respiratory therapy.



D-6836-2019

Following the patient's anatomy. Electrode belts in sizes 4XS and 3XS have a cutout for the armpits which allows the correct belt placement.

¹⁾Davies et al., "Clinical Scenarios of the Application of Electrical Impedance Tomography in Paediatric Intensive Care." Scientific Reports Volume 9. 2019

ACCESSORIES FOR DRÄGER PULMOVISTA® 500 FOR PEDIATRIC PATIENTS

A Patient cable – 16 electrode snaps, snap colour: white

Size	Range
One size fits all for all pediatric belts sizes (14.2 to 28.3 in) (XS – 4XS)	36 to 72 cm

B Electrode belt

Size	Range
4XS 4XS	36 to 44 cm (14.2 to 17.3 in)
3XS 3XS	42 to 52 cm (16.5 to 20.5in)
2XS 2XS	49 to 60 cm (19.3 to 23.6 in)
XS XS	58 to 72 cm (22.8 to 28.3 in)

▶ Please order pediatric belts via 8420005 PulmoVista kits.

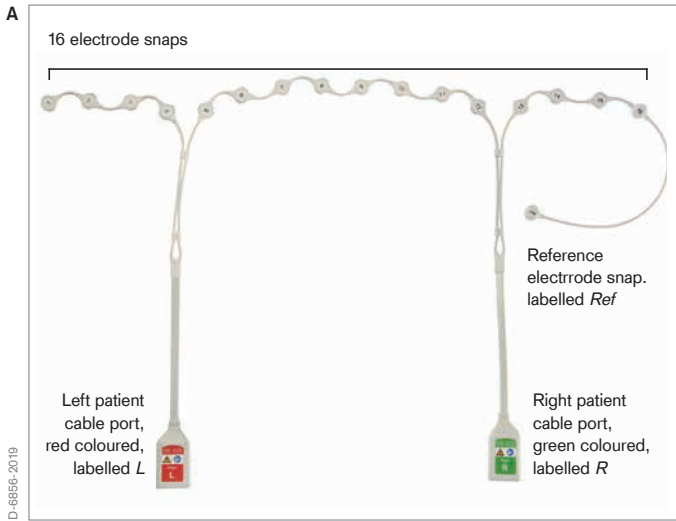



Seattle PAP* plus/Seattle PAP* Non invasive respiratory support for neonates and patients up to 10 kg

Helping infants with respiratory distress breathe easier. The Seattle-Positive Airway Pressure (PAP) system is an innovation, which uses the proven advantages of Bubble CPAP therapy, such as oscillatory effects similar to high frequency ventilation and combines it with a unique design. Seattle PAP / Seattle-PAP plus is effective and easy to use.

It was designed to:

- Promote infant safety with a uniquely designed pressure manifold with pressure relief valve.
- Safety tube lock to avoid unintended changes of the PEEP level.
- Provide comfort and optimum CPAP support to the infant due to disposable BabyFlow® interfaces complementing the system.
- Include funnel with the filling tube which minimises spillages.
- The swivel connector to the expiratory limb prevents unnecessary disconnections and pressure loss.
- The water trap in the expiratory limb prevents unwanted pressure peaks due to condensation in the expiratory limb.

It requires only oxygen and compressed air, both to be administered by an O₂ blender like the Oxymixer from from Dräger and a humidification source for the circuit.

*Availability of the version depending on the country.

ACCESSORIES FOR SEATTLE PAP/SEATTLE PAP PLUS – BUBBLE CPAP SYSTEM

A	Seattle PAP plus	MP02260	Oxymixer configuration	
B	Seattle PAP	MP02250	Configurable Oxymixer**	MP04200
C	Multi-P trolley* equipped, including base with 5 castors, Ø 38 mm (1.5 in) pole, 3 rail clamps, basket	MP13020	I Oxymixer Low Flow	MP04203
D	Multi-P trolley*, including base with 5 castors and Ø 38 mm (1.5 in) pole for accessories	MP13021	J Oxymixer Low Flow with monitor	MP04204
	Trolley	5790148	K Oxymixer Low Flow with 1 – 15 L flowmeter right	MP04229
E	Universal holder profile 30 × 5 for wall rails 25 × 8 to 35 × 10 mm, for secretion jars Medela	MP00634		
F	Adapter, with 6 mm nozzle, e.g., for disposable breathing masks, 9/16" connection	MP00416		
G	Rail clamp for F&P humidifier and Seattle PAP bubble box*	8411074		
H	Rail clamp, for attachment to poles of different diameters, rotatable by 90° to left and right, length of standard rail (profile 25 × 10 mm): 20 cm	2M85274		

*Tradeware
 **Produced by DEHAS

► Find BabyFlow® plus on page 56.

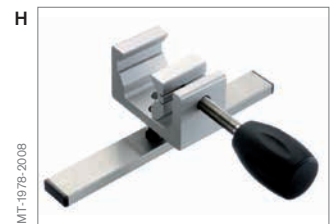

Not all products are available worldwide.



BabyFlow® plus – accessories for non-invasive respiratory support

The BabyFlow® plus respiratory support system was designed based on the results of state-of-the-art technology (Computational Flow Analysis) to minimize the imposed work of breathing for the patient. The streamlined adapter head optimizes the flow distribution.

The flexible, kink resistant hoses enable optimal positioning of the patient. Swivel connectors reduce the necessary disconnections of the breathing circuit to a minimum, thus ensuring stable CPAP pressures.

More stable CPAP levels reduce noise levels, making the BabyFlow® plus a low noise level respiratory support system, therefore, supporting Developmental Care practices and offering the best possible therapy for your tiny patients.

ACCESSORIES FOR NON-INVASIVE RESPIRATORY SUPPORT – BABYFLOW® PLUS

A	BabyFlow® plus, disposable, size S, 20 pcs.	MP03700	STANDARD PRONGS	
	BabyFlow® plus, disposable, size M, 20 pcs.	MP03701	Prong BabyFlow®, disposable, size XS, 10 pcs.	8418415
	BabyFlow® plus, disposable, size L, 20 pcs.	MP03702	Prong BabyFlow®, disposable, size S, 10 pcs.	8418605
B	Demo package BabyFlow® plus, disposable, size S	MP03703	Prong BabyFlow®, disposable, size M, 10 pcs.	8418416
	Demo package BabyFlow® plus, disposable, size M	MP03704	D Prong BabyFlow®, disposable, size L, 10 pcs.	8418531
	Demo package BabyFlow® plus, disposable, size L	MP03705	Prong BabyFlow®, disposable, size XL, 10 pcs.	8418417
C	Soft connector (N), disposable, 20 pcs.	MP03826	E Prong BabyFlow®, disposable, size XXL, 10 pcs.	8418617
			F WIDE PRONGS	
			Prong BabyFlow®, disposable, size 3, 10 pcs.	8418603
			Prong BabyFlow®, disposable, size 4, 10 pcs.	8418607
			Prong BabyFlow®, disposable, size 5, 10 pcs.	8418609
			Prong BabyFlow®, disposable, size 6, 10 pcs.	8418611

▶ Please find more information about the Demo package on the Dräger website.

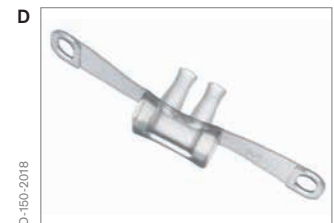

ACCESSORIES FOR NON-INVASIVE RESPIRATORY SUPPORT – BABYFLOW® PLUS

MASKS

A	Neo-mask, silicone, disposable, size S, 10 pcs.	8418491
	Neo-mask, silicone, disposable, size M, 10 pcs.	8418490
	Neo-mask, silicone, disposable, size L, 10 pcs.	8418619
B	Neo-mask, TPE, disposable, size 4, 10 pcs.	MP01494
C	Neo-mask, TPE, disposable, size 5, 10 pcs.	MP01495
D	Neo-mask, TPE, disposable, size 6, 10 pcs.	MP01496

HEADGEARS

E	Headgear, disposable, size XXS, 17 – 20 cm (6.7 – 7.9 in) head circumference, 5 pcs.	MP03880
	Headgear, disposable, size XS, 20 – 23 cm (7.9 – 9.1 in) head circumference, 5 pcs.	MP03881
F	Headgear, disposable, size S, 23 – 27 cm (9.1 – 10.6 in) head circumference, 5 pcs.	MP03882
	Headgear, disposable, size M, 27 – 31 cm (10.6 – 12.2 in) head circumference, 5 pcs.	MP03883
G	Headgear, disposable, size L, 31 – 37 cm (12.2 – 14.6 in) head circumference, 5 pcs.	MP03884
	Headgear, disposable, size XL, 37 – 42 cm (14.6 – 16.5 in) head circumference, 5 pcs.	MP03885



ACCESSORIES FOR NON-INVASIVE RESPIRATORY SUPPORT – BABYFLOW® PLUS

CAPS

A ①	Cap BabyFlow®, disposable, size XS, white, 18 – 20.5 cm (7.1 – 8.1 in) head circumference, 5 pcs.	8418533
	Cap BabyFlow®, disposable, size S, yellow, 20.5 – 23 cm (8.1 – 9.1 in) head circumference, 5 pcs.	8418534
	Cap BabyFlow®, disposable, size M, red, 23 – 25.5 cm (9.1 – 10 in) head circumference, 5 pcs.	8418535
A ②	Cap BabyFlow®, disposable, size L, green, 25.5 – 28 cm (10 – 11 in) head circumference, 5 pcs.	8418536
A ③	Cap BabyFlow®, disposable, size XL, orange, 28 – 30.5 cm (11 – 12 in) head circumference, 5 pcs.	8418537
	Cap BabyFlow®, disposable, size XXL, blue, 30.5 – 33 cm (12 – 13 in) head circumference, 5 pcs.	8418538
B	Cap BabyFlow®, disposable, size XXL+, white/black, 33 – 36 cm (13 – 14.2 in) head circumference, 5 pcs.	8418539

FIXATION STRAP

	Fixation strap BabyFlow, disposable, 13 cm (5,12 in), 10 pcs.	MP03870
	Fixation strap BabyFlow, disposable, 15 cm (5.91 in) 10 pcs.	MP03871
	Fixation strap BabyFlow, disposable, 18 cm (7,09 in), 10 pcs.	MP03872
	Fixation strap BabyFlow, disposable, 20 cm (7,87 in), 10 pcs.	MP03873

MASKS FOR NON-INVASIVE RESPIRATORY SUPPORT

C	Pediatric nasal mask MiniMe2 non vented, disposable, size S	MP01555
	Pediatric nasal mask MiniMe2 non vented, disposable, size L	MP01556
D	Pediatric nasal mask MiniMe2 vented, disposable, size S	MP01553
	Pediatric nasal mask MiniMe2 vented, disposable, size L	MP01554





Active Humidification – Aquapor H300

During mechanical ventilation, the natural warming, humidifying and secretion transport functions of the upper respiratory tract are compromised. In patients who require mechanical ventilation for longer periods, it is vital that measures are taken to mitigate these effects and reduce the likelihood of serious ventilator-associated lung infections (VALI).¹⁾ The Aquapor H300 provides optimally conditioned breathing gas, compensating for the heat and water loss caused by artificial ventilation with cold, dry medical gases.^{2, 3)}

- Three operating modes - NIV, IV and FREE
- Simple, three stage adjustment of the humidification level
- Adjustable heating power level of the expiratory hose
- Automatic water level detection
- Large 3.5" TFT-colour display

Literature

- ¹⁾ Williams R, Rankin N, Smith T, Galler D, Seakins P. Relationship between the humidity and temperature of inspired gas and the function of the airway mucosa. *Critical Care Medicine* 1996; 24(11):1920-1929.
- ²⁾ According to International Organization for Standardization (ISO) 8185:1997, the moisture output of an HH should be at least 33 mg/l (=75 % of the saturation humidity of 44 mg H₂O/l at a body temperature of 37 °C)
- ³⁾ Ryan SN, Rankin N, Meyer E, Williams R (2002) Energy balance in the intubated human airway is an indicator of optimal gas conditioning. *Crit Care Med* 30:355-361

ACCESSORIES FOR ACTIVE HUMIDIFICATION – AQUAPOR H300

	<u>Aquapor H300 - Configuration</u>	<u>MP01000</u>		<u>VentStar® Aquapor dual heated, Adult and Pediatric, 10 pcs.</u>	<u>MP07130</u>
A	<u>Aquapor H300 Basic unit 230V</u>	<u>MP07101</u>			
	<u>Aquapor H300 Basic unit 115V</u>	<u>MP07102</u>	D	<u>VentStar® Aquapor, heated, Adult and Pediatric, 10 pcs.</u>	<u>MP07131</u>
B	<u>H300 Heater wire adapter, insp</u>	<u>MP07106</u>	E	<u>VentStar® Aquapor, dual heated, N plus, 10 pcs.</u>	<u>MP07150</u>
C	<u>H300 Heater wire adapter, dual</u>	<u>MP07107</u>	F	<u>VentStar® Aquapor, heated, N plus, 10 pcs.</u>	<u>MP07151</u>
	<u>H300 Temp. sensor cable*, 160 cm</u>	<u>MP07108</u>			
	<u>H300 Temp. sensor cable</u>	<u>MP07109</u>			

*Tradeware

Aquapor H300 respiratory humidifier for optimally conditioned breathing gas



Not all products are available worldwide.

ADVANCED ACCESSORIES – ACCESSORIES FOR ACTIVE HUMIDIFICATION – F&P MR850 AND F&P950

Accessories for Active Humidification – F&P MR850 and F&P950

Optimal respiratory gas humidification results in optimal mucociliary clearance in ventilated patients. This supports gas exchange and reduces the risk of cross-infection. The complications that are the result of unfavorable humidity conditions are reduced by optimal respiratory gas humidification. Fisher&Paykel's F&P 950 and MR850 products are available for neonatal and pediatric respiratory humidification.



D-11601-2019

ACCESSORIES FOR ACTIVE HUMIDIFICATION – F&P MR850 AND F&P950

A/B F&P configuration for MR850 and F&P950	8414144	F&P temperature sensor for MR850, 1.5 m	8414966
ACCESSORIES FOR F&P 950		HEATED BREATHING CIRCUITS FOR MR850	
F&P 950 sensor cartridge	MP16002	C VentStar® Helix, dual heated (N) plus	MP02650
F&P 950 heater wire adaptor	MP16003	D VentStar® Helix, heated (N) plus	MP02608
F&P 950 neonatal disposable breathing circuit	MP16005	E Humidifier Chamber (N), disposable, 10 pcs.	MP02590
F&P 950 neonatal disposable breathing circuit (for Northamerica)	MP16016	F VentStar® Helix, dual heated, 10 pcs.	MP02606
ACCESSORIES FOR MR850		G VentStar® Helix, heated, 10 pcs.	MP02607
F&P heater wire for MR850, single heated	8414992	H AutoFeed Water Chamber, disposable, 10 pcs.	MP02605
F&P heater wire for MR850, dual heated	MP01006	Breathing circuit Infinity® ID, disposable, N, heated, 1.2 m, 10 pcs., not made with natural rubber latex	MP00343
F&P temperature sensor for MR850, 1.1 m	8414989		



D-876-2022



D-11595-2019



D-50801-2015



D-7479-2016



D-42729-2015



D-2202-2015



D-652-2016



D-35831-2011

Not all products are available worldwide.

ADVANCED ACCESSORIES – VENTILATION ACCESSORIES

VENTILATION ACCESSORIES

DISPOSABLE BREATHING CIRCUITS/SETS AND RELATED ACCESSORIES

A Breathing circuit Infinity® ID (P), disposable, basic, 1.8 m (5.9 ft), 25 pcs., not made with natural rubber latex	MP01340
B Breathing circuit Infinity® ID (P), disposable, water trap, 1.8 m (5.9 ft), 25 pcs., not made with natural rubber latex	MP01341
C Breathing bag set Infinity® ID (P), disposable, 1 L (33.81 fl. oz.), 1.1 m (3.61 ft), 25 pcs., not made with natural rubber latex	MP01343

PICU/ICU

D Breathing circuit VentStar® (P), disposable, basic, w/o LL, 1.5 m (4.92 ft), 25 pcs., not made with natural rubber latex	MP00338
E Breathing circuit VentStar® (P), disposable, basic, 1.8 m (5.9 ft), 25 pcs., not made with natural rubber latex	MP00351
F Breathing circuit VentStar® (P), disposable, basic, 2.5 m (8.2 ft), 25 pcs., not made with natural rubber latex	MP00352

PICU/ICU/OR

G Breathing circuit VentStar® (P), disposable, water trap, 1.8 m (5.9 ft), 25 pcs., not made with natural rubber latex	MP00361
H Breathing circuit VentStar® (P), disposable, water trap, w/o LL, 1.8 m (5.9 ft), 25 pcs., not made with natural rubber latex	MP00362



Not all products are available worldwide.

ADVANCED ACCESSORIES – VENTILATION ACCESSORIES

OR			
A	Anesthesia set VentStar® (P), disposable, w/o Luer Lock, 1.5 m/1.1 m (4.92/3.61 ft), 25 pcs., not made with natural rubber latex	<u>MP00331</u>	<u>Breathing circuit VentStar® (N), disposable, MRI, 3 m, 10 pcs., not made with natural rubber latex</u> <u>MP04802</u>
B	Breathing bag set VentStar® (P), disposable, 1 L (33.81 fl. oz.), 1.1 m (3.61 ft), 25 pcs., not made with natural rubber latex	<u>MP00384</u>	<u>Breathing bag set VentStar® (N), disposable, 0.5 L (16,91 fl. oz.), 1.1 m (3.61 ft), 25 pcs., not made with natural rubber latex</u> <u>MP00383</u>
C	Anesthesia set VentStar® (P), disposable, WT, 1 L (33.81 fl. oz.), 1.8 m/1.1 m (5.91/3.61 ft), 10 pcs., not made with natural rubber latex	<u>MP00374</u>	H Anesthesia set VentStar® (N), disposable, 1.8 m/1.1 m (3.61 ft), 25 pcs., not made with natural rubber latex <u>MP00333</u>
D	Anesthesia set VentStar® (P), disposable, WT, w/o LL, 1 L (33.81 fl. oz.), 1.8 m/1.1 m (5.91/3.61 ft), 10 pcs., not made with natural rubber latex	<u>MP00375</u>	I Breathing circuit Infinity® ID (N), disposable, basic, 1.8 m (5.9 ft), 25 pcs., not made with natural rubber latex <u>MP01327</u>
E	Breathing circuit VentStar® (N), disposable, basic, 1.8 m (5.9 ft), 25 pcs., not made with natural rubber latex	<u>MP00353</u>	<u>Breathing circuit Infinity® ID (N), disposable, water trap, 1.8 m (5.9 ft), 25 pcs., not made with natural rubber latex</u> <u>MP01328</u>
F	Breathing circuit VentStar® (N), disposable, water trap, 1.8 m (5.9 ft), 25 pcs., not made with natural rubber latex	<u>MP00363</u>	J Breathing bag set Infinity® ID (N), disposable, 0.5 L (16,91 fl. oz.), 1.1 m (3.61 ft), 25 pcs., not made with natural rubber latex <u>MP01329</u>
G	Breathing circuit VentStar® (P), disposable, coaxial, 1.5 m (4.92 ft), 20 pcs., not made with natural rubber latex	<u>MP00379</u>	
			<u>VENTSTAR® BREATHING BAGS</u>
			K Breathing Bag 0.5 L (16,91 fl. oz.), 25 pcs. <u>MP02710</u>
			Breathing Bag 1 L (33.81 fl. oz.), 25 pcs. <u>MP02711</u>
			Breathing Bag 2 L (67.63 fl. oz.), 25 pcs. <u>MP02712</u>

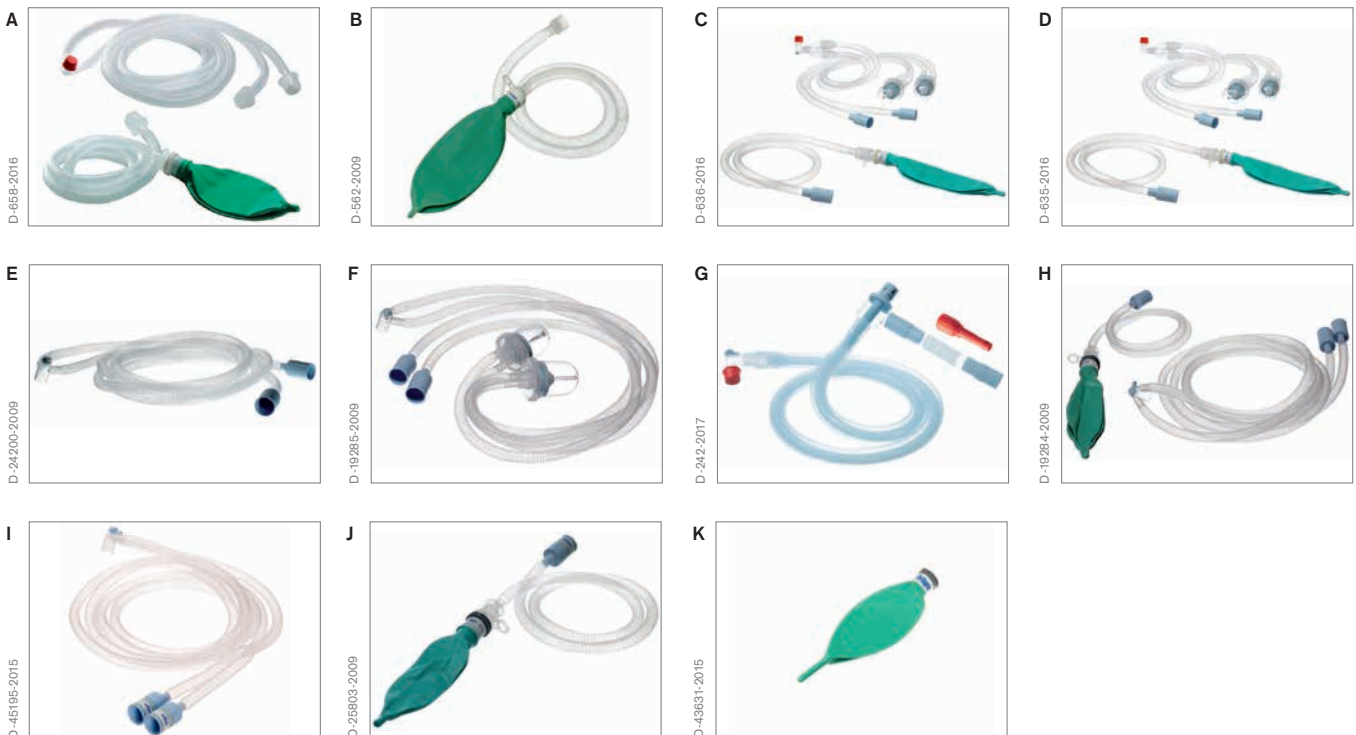

Not all products are available worldwide.

ADVANCED ACCESSORIES – VENTILATION ACCESSORIES

REUSABLE VENTILATION SYSTEMS:

BLUESET VENTILATION

A	BlueSet Ventilation (N)	8412344
B	BlueSet Ventilation (P/A)	8413146
C	BlueSet Ventilation HME (P/A)	8412860

REUSABLE ANESTHESIA SYSTEMS:

BLUESET ANESTHESIA

D	BlueSet Anesthesia water trap (P/A)	MK04248
E	BlueSet Anesthesia (N)	M27542
F	BlueSet Anesthesia (P/A)	M30146

TRANSPARENT BREATHING BAGS

OF SILICONE ELASTOMER

G	Breathing bag, silicone, reusable, 0.5 L (16,91 fl. oz.)	2166054
H	Breathing bag, silicone, reusable, 1.5 L (52,79 oz)	2166127

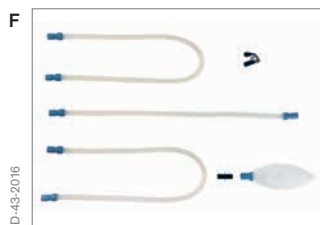
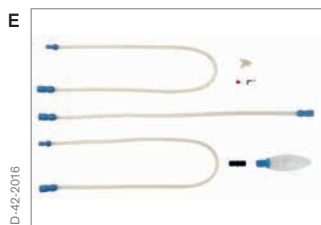
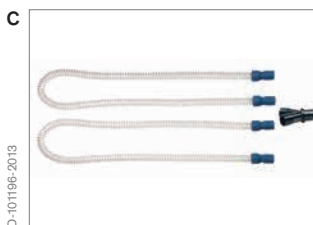

Not all products are available worldwide.

ADVANCED ACCESSORIES – VENTILATION ACCESSORIES

ANESTHESIA MASKS AND ACCESSORIES

A	Pediatric nasal mask MiniMe2 non vented, disposable, size S	MP01555	I	Anesthesia mask ComfortStar®, disposable, hook ring, standard, size 0, premature baby, 20 pcs.	MP01510
	Pediatric nasal mask MiniMe2 non vented, disposable, size L	MP01556		Anesthesia mask ComfortStar®, disposable, hook ring, standard, size 1, neonatal, 20 pcs.	MP01511
B	Pediatric nasal mask MiniMe2 vented, disposable, size S	MP01553		Anesthesia mask ComfortStar®, disposable, hook ring, standard, size 2, baby, 20 pcs.	MP01512
	Pediatric nasal mask MiniMe2 vented, disposable, size L	MP01554		Anesthesia mask ComfortStar®, disposable, hook ring, standard, size 3, infant, 20 pcs.	MP01513
C	SediStar® anesthesia face mask, disposable, w/o hook ring, size 1, small infant, 30 pcs.	MP01701		Anesthesia mask ComfortStar®, disposable, hook ring, standard, size 4, adult S, 20 pcs.	MP01514
D	SediStar® anesthesia face mask, disposable, w/o hook ring, size 2, large infant, 30 pcs.	MP01702	J	Silicone mask, reusable, size 00, premature baby	MP02900
	SediStar® anesthesia face mask, disposable, w/o hook ring, size 3, child, 30 pcs.	MP01703		Silicone mask, reusable, size 0, small neonate	MP01910
E	Hook ring for SediStar® anesthesia masks, disposable, 22 mm ID, for sizes 3 – 7, 30 pcs.	MP01708	K	Silicone mask, reusable, size 1, large neonate	MP01911
F	Anesthesia mask LiteStar®, disposable, w/o hook ring, size 1, infant S, 30 pcs.	MP11001		Silicone mask, reusable, size 2, small child	MP01912
G	Anesthesia mask LiteStar®, disposable, w/o hook ring, size 2, infant L, 30 pcs.	MP11002		Silicone mask, reusable, size 3, large child	MP01913
	Anesthesia mask LiteStar®, disposable, w/o hook ring, size 3, child, 30 pcs.	MP11003	L	Hook ring for silicone masks, reusable, 15 mm OD, for sizes 00 – 1, 10 pcs.	MP01916
H	Hook ring for LiteStar® anesthesia masks, disposable, 22 mm ID, for sizes 3 – 7, 30 pcs.	MP11008	L	Hook ring for silicone masks, reusable, 22 mm ID, for sizes 2 – 5, 10 pcs.	MP01917
				Headgear, disposable, soft fabric, small	MP01559
				Headgear, disposable, soft fabric, large	MP01560
				Headgear, disposable, soft rubber, small	MP01561
				Headgear, disposable, soft rubber, large	MP01562



Not all products are available worldwide.

ADVANCED ACCESSORIES – VENTILATION ACCESSORIES

BREATHING SYSTEM FILTERS AND HMEs

A	Electrostatic filter and HME TwinStar® 25 Plus, disposable, ~25 ml deadspace, 100 pcs.	MP05815
B	Electrostatic filter and HME TwinStar® 9 Plus, disposable, ~9 ml deadspace, 100 pcs.	MP05820
C	Electrostatic filter CareStar® 20 Plus, disposable, ~20 ml deadspace, 100 pcs.	MP05770
D	HME HumidStar® 25 Plus, disposable, ~25 ml deadspace, 100 pcs.	MP05735
E	HME HumidStar 2 Plus, disposable, 2 ml deadspace, 100 pcs.	MP05845

CATHETER MOUNTS AND AIRWAY CONNECTORS

F	Catheter mount ErgoStar® CM 60, disposable, 10 cm (3.94 in), small, double swivel elbow, 50 pcs.	MP01860
----------	--	----------------



ADVANCED ACCESSORIES – VENTILATION ACCESSORIES

CO₂ CUVETTES

A	CO₂ cuvette disposable, pediatric, 10 pcs.	MP01063
B	CO₂ cuvette reusable, pediatric, for CO₂ sensors 6871500, 6870300, 6871950	6870280

MCABLE – MAINSTREAM CO₂

C	CO₂ mainstream sensor, for Evita® Infinity® V500, Babylog® VN500 and V(VN)600/800, Infinity® M540 and Oxylog® 3000 plus, reusable	6871950
----------	---	----------------

OXYGEN (O₂) AND AEROSOL THERAPY MASKS, VENTURI MASK KITS, NASAL CANNULAS AND ACCESSORIES

D	O2Star™ Oxygen nasal cannula straight with connection tube 2.1 m (6.9 ft), disposable, S, 50 pcs.	MP02920
	O2Star™ Oxygen nasal cannula straight with connection tube 2.1 m (6.9 ft), disposable, M, 50 pcs.	MP02921
E	O2Star™ Oxygen nasal cannula curved with connection tube 2.1 m (6.9 ft), disposable, S, 50 pcs.	MP02924
	O2Star™ Oxygen nasal cannula curved with connection tube 2.1 m (6.9 ft), disposable, M, 50 pcs.	MP02925
F	O2Star™ Oxygen nasal cannula flared with connection tube 2.1 m (6.9 ft), disposable, S, 50 pcs.	MP02928
	O2Star™ Oxygen nasal cannula flared with connection tube 2.1 m (6.9 ft), disposable, M, 50 pcs.	MP02929
G	O2Star™ Oxygen nasal cannula curved-flared with connection tube 2.1 m (6.9 ft), disposable, S, 50 pcs.	MP02932
	O2Star™ Oxygen nasal cannula curved-flared with connection tube 2.1 m (6.9 ft), disposable, M, 50 pcs.	MP02933
H	O2Star™ Non-rebreather oxygen mask with connection tube 2.1 m (6.9 ft), disposable, S, 50 pcs.	MP01930
I	O2Star™ Medium concentration oxygen mask with connection tube 2.1 m (6.9 ft), disposable, S, 50 pcs.	MP01931

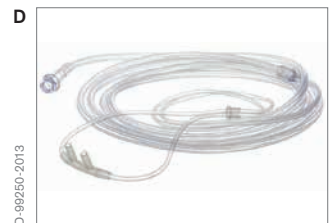

ADVANCED ACCESSORIES – WARD EQUIPMENT

WARD EQUIPMENT

OXYGEN THERAPY

A	O ₂ flowmeter, 4 L/min (135.26 fl. oz.), CS, DIN, ISO and neutral color, M34×1.5 and 9/16" for accessories and sterile water systems	MP04551
B	O ₂ flowmeter, 4 L/min (135.26 fl. oz.), rail with NIST gas inlet, ISO, DIN, M34×1.5 and 9/16" for accessories and sterile water systems	MP04552
	O ₂ flowmeter, 16 L/min (541.02 fl. oz.), CS, DIN, ISO and neutral color, M34×1.5 and 9/16" for accessories and sterile water systems	MP04558
	O ₂ flowmeter, 16 L/min (541.02 fl. oz.), rail, NIST gas inlet, ISO, neutral color, M34×1.5, adapter 9/16"	MP04567
C	Clickflow Compact Flowmeter Configurator	MP13000
	Further flowmeter and Clickflow versions on request.	

OXYMIXER**

	Oxymixer configuration Configurable Oxymixer	MP04200
D	Oxymixer High Flow	MP04201
E	Oxymixer High Flow with monitor	MP04202
F	Oxymixer Low Flow	MP04203
G	Oxymixer Low Flow with monitor	MP04204
H	Oxymixer Low Flow with 1 – 15 L flowmeter right	MP04229
I	Oxymixer sound damper 9/16"	MP04218

	Oxymixer sound damper 22 and 15 mm	MP04219
	Adapter, with 6 mm nozzle, e.g., for disposable breathing masks, 9/16" connection	MP00416

TROLLEY

J	Multi-P trolley* equipped, including base with 5 castors, Ø 38 mm (1.5 in) pole, 3 rail clamps, basket	MP13020
K	Multi-P trolley*, including base with 5 castors and Ø 38 mm (1.5 in) pole for accessories	MP13021

CS HOSES

L	Please order hoses to connect Flowmeter, Compact Flowmeter with rail fixation and Oxymixer to the central gas supply separately	
	Central supply hoses	8601697

HUMIDIFIER, ADAPTER AND APPLICATION

	Humidifier-bubbler, for oxygen humidification up to appr. 60% relative humidity and flows up to 5 L/min (52,79 fl.oz./min)	2M85834
	Humidifier-nebulizer, for oxygen humidification up to 100% relative humidity and flows up to 5 L/min (52,79 fl.oz./min)	2M85835

*Tradeware

**Produced by DEHAS



Not all products are available worldwide.

ADVANCED ACCESSORIES – WARD EQUIPMENT

ASPIRATION

A Vacuum regulator VarioVac® P Rail, for bronchial suction, gas connection VAC Max. vac: -55 to 0 kPa (-550 to 0 mbar) Max. flow: 20 L/min (676.28 fl. oz./min)	MP00660	G Vacuum regulator VarioVac® MRT P Rail, for bronchial suction, gas connection VAC Max. vac: -55 to 0 kPa (-550 to 0 mbar) Max. flow: 20 L/min (676.28 fl. oz./min)	MP03223
B Ejector VarioAir® P Rail, for bronchial suction, gas connection AIR Max. vac: -48 to 0 kPa (-480 to 0 mbar) Max. flow: 20 L/min (676.28 fl. oz./min)	MP00545	H Ejector VarioAir® MRT P Rail, for bronchial suction, gas connection AIR Max. vac: -48 to 0 kPa (-480 to 0 mbar) Max. flow: 20 L/min (676.28 fl. oz./min)	MP03221
C Vacuum regulator VarioVac® P compact, for bronchial suction, gas connection VAC Max. vac: -55 to 0 kPa (-550 to 0 mbar) Max. flow: 20 L/min (676.28 fl. oz./min)	MP00661	I Bacterial and viral filter system VarioSafe, for VarioAir® & VarioVac®, disposable, 10 pcs.	MP00555
D Ejector VarioAir® P compact, for bronchial suction, gas connection AIR Max. vac: -48 to 0 kPa (-480 to 0 mbar) Max. flow: 20 L/min (676.28 fl. oz./min)	MP00547	J Secretion jar set, with 700 ml (23.67 fl. oz.) secretion jars (2 pcs.) and 1.5 m (59.1 in) suction hose	2M85056
E Vacuum regulator VarioVac® D Rail, for continuous and wound drainage, gas connection VAC Max. vac: -16 to 0 kPa (-160 to 0 mbar) Max. flow: 18 L/min (608.65 fl.oz./min)	MP00511	K Secretion jar set, with rail holder and secretion jar 700 ml (23.67 fl. oz.)	2M85163
F Ejector VarioAir® D Rail, for continuous and wound drainage, gas connection AIR Max. vac: -16 to 0 kPa (-160 to 0 mbar) Max. flow: 18 L/min (608.65 fl.oz./min)	MP00542		



ADVANCED ACCESSORIES – RAIL ACCESSORIES

RAIL ACCESSORIES

MEDICAL EXAMINATION LIGHT VARIOLUX®
WITH LED TECHNOLOGY

The Dräger VarioLux is a cool, highly efficient examination light with variable light intensities which was specially designed for use in neonatal intensive care settings. Made for single-handed operation, it features adjustable color temperature settings as well as a dimmer function.

Operating mode:	Continuous operation
Weight:	1.5 kg (3.3 lbs)
Electrical values:	100 – 240 V, 50/60 Hz
Max. illumination intensity E _c at 0.5 m (19.7 in):	30,000 lx
Dimming levels:	30,000 lx, 24,000 lx, 18,000 lx, 12,000 lx, 7,000 lx
Light field diameter d10 at 0.5 m (19.7 in):	20 cm (7.9 in)
Light field diameter d50 at 0.5 m (19.7 in):	9 cm (3.5 in)
Color temperature adjustable:	Cool white (blue) 4,700 K, Neutral white (white) 4,100 K, Warm white (red) 3,500 K
Min. service life of bulb (LEDs):	> 35,000 h
Color reproduction index:	R _a = 96 (at 3,500 K) R ₉ = 89 (at 3,500 K)
Max. radiant power at 0.5 m (19.7 in):	105 W/m ²

A VarioLux® EU	MP00601
VarioLux® US	MP00602
VarioLux® GB	MP00603
VarioLux® AUS	MP00606
VarioLux® JPN	MP00608
Power cable EU, 1.8 m (5.9 ft), 2 pin	MP00591
Power cable US/JPN, 1.8 m (5.9 ft), 2 pin	MP00592
Power cable GB, 1.8 m (5.9 ft), 2 pin	MP00593
Power cable AUS, 1.8 m (5.9 ft), 2 pin	MP00626
B Rail claw for lamp	MP00615
C Turn knob, compl.	MP00587
D Control panel	MP00589
E Rail clamp, for attachment to poles of different diameters	2M85274
F Compact rail, for 38 mm (1.5 in) tube, standard rail profile 25 × 10 mm (1 x 0.4 in), each side 10 cm (3.9 in)	2M85337

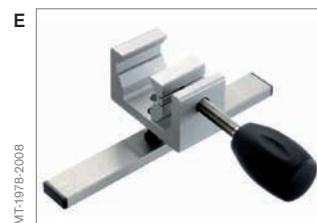



4. Jaundice Management



NEONATAL/PEDIATRIC INTENSIVE CARE UNIT (NICU/PICU) ■ JAUNDICE MANAGEMENT

Jaundice Meter JM-105 (MU20105)

The Dräger Jaundice Meter JM-105 gives you consistent quality screening, cost-effectively delivered over the lifetime of the device. As a result you optimize the efficiency of your jaundice management program, save time and money while delivering an exceptional standard of care.

Learn more about jaundice management and our products: draeger.com/jaundice

**ACCESSORIES FOR JAUNDICE METER JM-105**

A	Docking station with built-in checker, CE, JM-A33, en	MU24805
B	USB cable T-A15 for data transmission software	MU24774
	Data transmission software, CD-ROM/USB, SW JM-S1w	MU24775
	AC adapter, JM-A32	MU19791
	AC adapter, JM-A32 CE	MU19792



NEONATAL/PEDIATRIC INTENSIVE CARE UNIT (NICU/PICU) ■ JAUNDICE MANAGEMENT

BiliLux LED Phototherapy Light

The BiliLux is a compact and lightweight LED phototherapy light system for the treatment of neonatal jaundice. It provides superior phototherapy performance, individualised therapy with electronic documentation capabilities and the flexibility for seamless integration into practically every workplace.

Learn more about jaundice management and our products: draeger.com/jaundice



D-16206-2017



D-12195-2016

ACCESSORIES FOR BILILUX LED PHOTOTHERAPY LIGHT

Dräger BiliLux	MU20100	Radiometer	MU26079	MOUNTING ADAPTERS	
A Phototherapy mask Eyemax 2, disposable, micro, 20 pcs.	MP03770	USB flash drive	8416347	Rail claw for lamp	MP00615
B Phototherapy mask Eyemax 2, disposable, premie, 20 pcs.	MP03771	Trolley	MU26076	Compact rail	2M85337
C Phototherapy mask Eyemax 2, disposable, regular, 20 pcs.	MP03772	Cable holder for trolley pole	G13171	Rail clamp	2M85274
D Light shield curtain for BiliLux, reusable*	MP03760	Spring arm	MU26077	Duct pivot rail, Kit	4118453

* Woven fabric: 100% cotton, miscellaneous: Polyester (PES)



D-4767-2017



D-4766-2017



D-4765-2017



D-17862-2017

Not all products are available worldwide.





5. Monitoring Systems



CONTENT
OVERVIEW
LABOR AND DELIVERY
TRANSPORT
NICU/PICU
JAUNDICE MANAGEMENT
MONITORING SYSTEMS
LITERATURE

MONITORING SYSTEMS

Infinity® Delta

Provides continuous monitoring and data collection both at the bedside and on transport – eliminating the need for separate transport monitors.

- Hospital-wide standardization
- Pick and Go® supports efficient patient transport
- Seamless wired-to-wireless networking



MT-1799-Delta

Infinity® Acute Care System (IACS)

In acute care environments, patient care has become increasingly complex. There is a growing need among clinicians for systems that are both easy to use and are aligned with hospital workflow. Dräger created the Infinity® Acute Care System monitoring solution to meet the needs of all care areas – both at the bedside and while on transport.



D-28325-2017

ACCESSORIES FOR MONITORING SYSTEMS

**1. INFINITY® MONITORING:
GAMMA, DELTA AND KAPPA SERIES**

1.1 MULTIMED® PODS

A	Multiparameter cable NeoMed Pod, for ECG, resp., SpO ₂ , temp., and FiO ₂ , 2.5 m (8.2 ft)	5590539
B	Holder for MultiMed® 5/6, MultiMed® Plus/OR, and NeoMed Pods, swiveling 360°	MP00721
C	Universal pole mount	7485621

1.2 ELECTROCARDIOGRAPHY (ECG)

ELECTRODES

ECG electrodes, single-patient use, neonate, 300 pcs.	5195024
---	---------

NEONATAL ECG

D	Electrode adapter, to connect neonatal electrodes to MultiMed® pod, 10 pcs.	5194779
E	ECG intermediate cable, 3-lead, for NeoMed Pod, 1.5 m (59.1 in)	5592162
	ECG electrodes, single-patient use, neonate, 300 pcs.	5195024

1.3 PULSE OXIMETRY (SPO₂)

DRÄGER CABLES

SpO ₂ intermediate cables for connection to MultiMed® 5, 6, 12 and NeoMed Pods.		
F	SpO ₂ intermediate cable Dräger/Nellcor®, for MultiMed® 5/6 and NeoMed pods, 1 m (3.3 ft)	3368433
	SpO ₂ intermediate cable Dräger/Nellcor®, for MultiMed® 5/6 and NeoMed pods, 2 m (6.6 ft)	3375834

DRÄGER DISPOSABLE SENSORS

G	SpO ₂ adhesive sensor Dräger, cloth, disposable, baby, 24 pcs.	MS16447
H	SpO ₂ adhesive sensor Dräger, cloth, disposable, neonate, 24 pcs.	MS16446



Not all products are available worldwide.

ACCESSORIES FOR MONITORING SYSTEMS

MASIMO® LNCS CABLES

SpO₂ intermediate cables for connection to MultiMed® 5, 6, 12 and NeoMed Pods.

A SpO₂ intermediate cable Dräger/Nellcor®, for MultiMed® 5/6 and NeoMed pods, 1 m (3.3 ft) 3368433

SpO₂ intermediate cable Dräger/Nellcor®, for MultiMed® 5/6 and NeoMed pods, 2 m (6.6 ft) 3375834

SpO₂ intermediate cables for connection to Masimo® SET Pod.

B SpO₂ intermediate cable Masimo® LNCS, 3 m (9.8 ft) MS17522

B SpO₂ intermediate cable Masimo® LNCS, 1.2 m (3.9 ft) MS24303

MASIMO® LNCS

REUSABLE SENSORS

US

JP

SpO₂ Masimo® sensor LNCS-YI Multisite, reusable, neonate/pediatric/adult MP03023 MP03102 MP00789

MASIMO® LNCS

DISPOSABLE SENSORS

US

JP

C SpO₂ adhesive sensor Masimo® LNCS Inf, disposable, baby, 20 pcs. MP03013 MP03091 MP00791

D SpO₂ adhesive sensor Masimo® LNCS Neo, disposable, neonate, 20 pcs. MP03014 MP03092 MP00792

E SpO₂ adhesive sensor Masimo® LNCS NeoPt, disposable, premature baby, 20 pcs. MP03015 MP03093 MP00794

MASIMO® LNCS DISPOSABLE

TRAUMA SENSORS

US

JP

Masimo® LNCS Trauma sensors are for use with Masimo® SET technology only.

F Masimo® LNCS Trauma sensor, infant/pedi, 20 pcs. MP03018 MP03096 MP03193

G Masimo® LNCS Trauma sensor, neonate, 20 pcs. MP03017 MP03095 MP03192



ACCESSORIES FOR MONITORING SYSTEMS

MASIMO® RD SET CABLES

SpO₂ intermediate cables for connection to Masimo® SET Pod.

A	SpO ₂ intermediate cable Masimo® RD SET, 1.2 m (3.9 ft)	MS34436
	SpO ₂ intermediate cable Masimo® RD SET, 3 m (9.8 ft)	MS34437

MASIMO® RD SET ADAPTER CABLES

	US	JP		
B	Adapter cable RD SET to LNOP	MS33750	MS33769	MS33731
C	Adapter cable RD SET to LNCS	MS33751	MS33770	MS33732
C	Adapter cable RD SET to MultiMed®	MS33752	MS33771	MS33733

MASIMO® RD SET DISPOSABLE TRAUMA SENSORS

	US	JP		
Masimo® RD SET Trauma sensors are for use with Masimo® SET technology only.				
D	Masimo® Trauma sensor RD SET, disposable, infant/pedi	MS40089	MS40090	MS40091
E	Masimo® Trauma sensor RD SET, disposable, neonate	MS40092	MS40093	MS40094

MASIMO® RD SET

DISPOSABLE SENSORS

	US	JP		
F	Masimo® RD SET sensor, infant, disposable	MS33747	MS33766	MS33728
G	Masimo® RD SET sensor, neonatal, disposable	MS33748	MS33767	MS33729
H	Masimo® RD SET sensor, neonatal preterm, disposable	MS33749	MS33768	MS33730

MASIMO® RD SET REUSABLE SENSORS

	US	JP		
I	Masimo® RD SET sensor YI Multisite, neonatal/pediatric/adult, reusable	MS40068	MS40069	MS40070

MASIMO® ACCESSORIES

	US	JP		
J	SpO ₂ adhesive wrap Masimo® Multisite-Wrap, for LNOP YI SpO ₂ sensor, 100 pcs.	MP03046	MP03148	7496917
K	SpO ₂ adhesive wrap Masimo® Petite-Wrap, for LNOP YI SpO ₂ sensor, 100 pcs.	MP03047	MP03149	7496909
L	SpO ₂ adhesive square Masimo®, 12 pcs.	MP03048	MP03150	7496875
	SpO ₂ foam wrap Masimo® Foam-Wrap, neonate, for LNOP YI SpO ₂ sensor, 12 pcs.	MP03049	MP03151	7496891



D-954-2019



D-271-2017



D-257-2017



D-949-2019



D-944-2019



D-262-2017



D-263-2017



D-264-2017



D-940-2019



MT-4305-2004



D-445-2014



D-2368-2011

Not all products are available worldwide.

ACCESSORIES FOR MONITORING SYSTEMS

NELLCOR® CABLES

SpO ₂ intermediate cables for connection to MultiMed® 5, 6, 12 and NeoMed Pods.	
A SpO ₂ intermediate cable Dräger/Nellcor®, for MultiMed® 5/6 and NeoMed pods, 1 m (3.3 ft)	3368433
SpO ₂ intermediate cable Dräger/Nellcor®, for MultiMed® 5/6 and NeoMed pods, 2 m (6.6 ft)	3375834
SpO ₂ intermediate cables for connection to MultiMed® plus/plus OR and Nellcor® Oximax.	
B SpO ₂ intermediate cable Dräger/Nellcor®, for MultiMed® Plus/Plus OR, 1.2 m (3.9 ft)	MS18683
C SpO ₂ intermediate cable Dräger/Nellcor®, for MultiMed® Plus/Plus OR, 3 m (9.8 ft)	MS17330

NELLCOR® DISPOSABLE SENSORS

D SpO ₂ adhesive sensor Nellcor® Oximax® Max-I, disposable, child, 24 pcs.	MX50067
E SpO ₂ adhesive sensor Nellcor® Oximax® Max-N, disposable, neonate/adult, 24 pcs.	MX50068



Not all products are available worldwide.

ACCESSORIES FOR MONITORING SYSTEMS

1.4 TEMPERATURE

ADAPTER CABLES

A	Y-cable, reusable, 7-pin connector, for 2 temperature probes	5592154
---	--	---------

SINGLE-PATIENT USE TEMPERATURE PROBES

B	Skin temperature probe, single-patient use, child/neonatal, 7-pin connector, 1.6 m (5.3 ft)	MP00997
	Skin temperature probe, single-patient use, child/neonatal, 7-pin connector, 3 m (9.8 ft)	MP00998

REUSABLE TEMPERATURE PROBES

C	Skin temperature probe, reusable, with 7-pin connector, 1.5 m (59.1 in)	4329822
C	Skin temperature probe, reusable, with 7-pin connector, 3 m (9.8 ft)	5204669

1.5 NON-INVASIVE BLOOD PRESSURE (NIBP)

NIBP HOSES

D	NIBP hose, neonate, 2.4 m (7.9 ft)	2870298
---	------------------------------------	---------

NIBP CUFFS NEONATAL, DISPOSABLE

E	NIBP cuff, disposable, neonate, size 1, 3.1 – 5.7 cm (1.2 – 2.2 in), 10 St.	2870181
F	NIBP cuff, disposable, neonate, size 2, 4.3 – 8 cm (1.7 – 3.2 in), 10 pcs.	2870199
G	NIBP cuff, disposable, neonate, size 3, 5.8 – 10.9 cm (2.3 – 4.3 in), 10 pcs.	2870207
H	NIBP cuff, disposable, neonate, size 4, 7.1 – 13.1 cm (2.8 – 5.2 in), 10 pcs.	2870215
I	NIBP cuff, disposable, neonate, size 5, 8.3 – 15 cm (3.3 – 5.9 in), 10 pcs.	2870173

1.6 CAPNOGRAPHY ETCO₂

ETCO₂ ACCESSORIES FOR CAPNOSTAT III

J	etCO ₂ airway adapter, reusable, neonate	4721788
---	---	---------

ETCO₂ MICROSTREAM ADAPTERS AND CANNULAS

K	etCO ₂ Microstr. Intubated Infant/Neonatal - Extended Duration, 25 pcs.	MP15003
L	etCO ₂ Microstr. Nasal Infant/Neonatal - Extended Duration, 25 pcs.	MP15007



Not all products are available worldwide.

ACCESSORIES FOR MONITORING SYSTEMS

2. INFINITY® ACUTE CARE SYSTEM

2.1 ELECTROCARDIOGRAPHY (ECG)

NEONATAL ECG

ECG neonatal 3-lead adapter cable, 2 m (6.6 ft) MS25951

ECG electrodes, single-patient use, neonate, 300 pcs. 5195024

2.2 PULSE OXIMETRY (SpO₂)

MASIMO® LNCS CABLES US JP

For connection of LNCS sensors to Masimo® SET Mcable.

A SpO₂ intermediate cable Masimo® LNCS, 1.2 m (3.9 ft) MP03027 MP03106 MP00800

A SpO₂ intermediate cable Masimo® LNCS, 3 m (9.8 ft) MP03025 MP03107 MP00797

A SpO₂ intermediate cable Masimo® LNCS, 4.3 m (14.1 ft) MP03026 MP03105 MP03194

For connection of LNCS sensors to Masimo® rainbow SET Mcable.

B SpO₂ intermediate cable Masimo® Red LNCS, 1.2 m (3.9 ft) MP03030 MP03109 MP02991

B SpO₂ intermediate cable Masimo® Red LNCS, 3 m (9.8 ft) MP03031 MP03110 MP02992

B SpO₂ intermediate cable Masimo® Red LNCS, 4.3 m (14.1 ft) MP03032 MP03111 MP03196

MASIMO® LNCS REUSABLE SENSORS US JP

SpO₂ Masimo® sensor LNCS-YI Multisite, reusable, neonate/pediatric/adult MP03023 MP03102 MP00789

MASIMO® LNCS DISPOSABLE SENSORS US JP

C SpO₂ adhesive sensor Masimo® LNCS Neo, disposable, neonate, 20 pcs. MP03014 MP03092 MP00792

D SpO₂ adhesive sensor Masimo® LNCS NeoPt, disposable, premature baby, 20 pcs. MP03015 MP03093 MP00794

MASIMO® LNCS TRAUMA DISPOSABLE SENSORS US JP

Masimo® LNCS Trauma sensors are for use with Masimo® SET technology only.

E Masimo® LNCS Trauma sensor, infant/pedi, 20 pcs. MP03018 MP03096 MP03193

F Masimo® LNCS Trauma sensor, neonate, 20 pcs. MP03017 MP03095 MP03192



D-502-2014



D-466-2014



D-32560-2011



D-32550-2011



D-462-2014



D-461-2014

ACCESSORIES FOR MONITORING SYSTEMS

MASIMO® RD SET CABLES				US	JP	MASIMO® RD SET DISPOSABLE SENSORS				
Connection of RD SET sensors to Masimo® SET Mcable.						MASIMO® RD SET TRAUMA SENSORS				
A	RD SET intermediate cable for Masimo® SET Mcable, 1.5 m	MS33755	MS33744	MS33736	E	Masimo® RD SET sensor, infant, disposable	MS33747	MS33766	MS33728	
A	RD SET intermediate cable for Masimo® SET Mcable, 3.6 m	MS33756	MS33775	MS33737	F	Masimo® RD SET sensor, neonatal, disposable	MS33748	MS33767	MS33729	
For connection of RD SET sensors to Masimo® rainbow SET Mcable.						G	Masimo® RD SET sensor, neonatal preterm, disposable	MS33749	MS33768	MS33730
B	RD SET intermediate cable for Masimo® rainbow SET Mcable, 1.5 m	MS33757	MS33776	MS33738	MASIMO® RD SET REUSABLE SENSORS					
B	RD SET intermediate cable for Masimo® rainbow SET Mcable, 3.6 m	MS33758	MS33777	MS33739	J	Masimo® RD SET DC-IP sensor, pediatric, reusable	MS33760	MS33779	MS33741	
MASIMO® RD RAINBOW SET DISPOSABLE SENSORS				US	JP	Masimo® RD SET sensor YI Multisite, neonatal/pediatric/adult, reusable				
Masimo® RD rainbow SET sensors are for use with Masimo® rainbow SET technology only.						I	Masimo® Trauma sensor RD SET disposable, neonatal	MS40092	MS40093	MS40094
C	Masimo® RD rainbow SET senso disposable, infant	MS40080	MS40081	MS40082	MASIMO® RD SET REUSABLE SENSORS					
D	Masimo® RD rainbow SET senso disposable, neonatal	MS40083	MS40084	MS40085	J	Masimo® RD SET DC-IP sensor, pediatric, reusable	MS33760	MS33779	MS33741	



Not all products are available worldwide.

ACCESSORIES FOR MONITORING SYSTEMS

MASIMO® ACCESSORIES	US	JP	
A SpO ₂ adhesive wrap Masimo® Multisite-Wrap, for LNOP YI SpO ₂ sensor, 100 pcs.	MP03046	MP03148	7496917
B SpO ₂ adhesive wrap Masimo® Petite-Wrap, for LNOP YI SpO ₂ sensor, 100 pcs.	MP03047	MP03149	7496909
C SpO ₂ adhesive square Masimo®, 12 pcs.	MP03048	MP03150	7496875
D SpO ₂ foam wrap Masimo® Foam-Wrap, neonate, for LNOP YI SpO ₂ sensor, 12 pcs.	MP03049	MP03151	7496891
NELLCOR® CABLES			
E Nellcor® intermediate cable, 1.2 m (3.9 ft)			MP00748
Nellcor® intermediate cable, 3 m (9.8 ft)			MS20979
NELLCOR® DISPOSABLE SENSORS			
F SpO ₂ adhesive sensor Nellcor® Oximax® Max-I, disposable, child, 24 pcs.			MX50067
G SpO ₂ adhesive sensor Nellcor® Oximax® Max-N, disposable, neonate/adult, 24 pcs.			MX50068

2.3 TEMPERATURE

ADAPTER CABLES

H Y-cable, reusable, 7-pin connector, for 2 temperature probes	5592154
--	---------

SINGLE-PATIENT USE TEMPERATURE PROBES

I Skin temperature probe, single-patient use, child/neonatal, 7-pin connector, 1.6 m (5.3 ft)	MP00997
---	---------

Skin temperature probe, single-patient use, child/neonatal, 7-pin connector, 3 m (9.8 ft)	MP00998
--	---------

REUSABLE TEMPERATURE PROBES

J Skin temperature probe, reusable, with 7-pin connector, 1.5 m (59.1 in)	4329822
---	---------

Skin temperature probe, reusable, with 7-pin connector, 3 m (9.8 ft)	5204669
---	---------

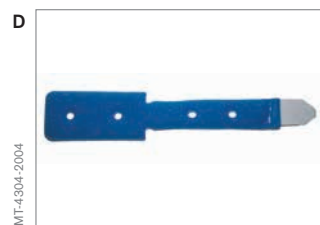

ACCESSORIES FOR MONITORING SYSTEMS

2.4 NON-INVASIVE BLOOD PRESSURE (NIBP)

NIBP HOSES

A	NIBP hose, neonate, 2.4 m (7.9 ft)	2870298
----------	---	----------------

NIBP CUFFS NEONATAL, DISPOSABLE

B	NIBP cuff, disposable, neonate, size 1, 3.1 – 5.7 cm (1.2 – 2.2 in), 10 pcs.	2870181
----------	---	----------------

C	NIBP cuff, disposable, neonate, size 2, 4.3 – 8 cm (1.7 – 3.2 in), 10 pcs.	2870199
----------	---	----------------

D	NIBP cuff, disposable, neonate, size 3, 5.8 – 10.9 cm (2.3 – 4.3 in), 10 pcs.	2870207
----------	--	----------------

E	NIBP cuff, disposable, neonate, size 4, 7.1 – 13.1 cm (2.8 – 5.2 in), 10 pcs.	2870215
----------	--	----------------

F	NIBP cuff, disposable, neonate, size 5, 8.3 – 15 cm (3.3 – 5.9 in), 10 pcs.	2870173
----------	--	----------------

2.5 CO₂

Infinity® MCable-Microstream CO₂	MS32641
--	----------------

Microstream CO₂ extension cable	6872159
---	----------------

CO₂ MICROSTREAM ADAPTERS AND CANNULAS

G etCO₂ Microstr. Intubated Infant/Neonatal - Extended Duration, 25 pcs.	MP15003
--	----------------

H etCO₂ Microstr. Nasal Infant/Neonatal - Extended Duration, 25 pcs.	MP15007
--	----------------

2.6 MOUNTS

I Universal pole mount	7485621
-------------------------------	----------------

Holder for Masimo® SET MCable and Nellcor Oximax MCable	MS26266
--	----------------

Holder for Masimo® rainbow SET MCable	MS28576
--	----------------



Not all products are available worldwide.

VISTA 120/VISTA 120 S/VISTA 120SC

Vista 120/Vista 120 S

Hospitals have a common challenge: provide the best care possible in an environment where patient populations are growing, financial constraints are increasing and caregivers are overburdened. Dräger offers patient monitors to meet the clinical needs in these environments: the Vista 120 and Vista 120 S.

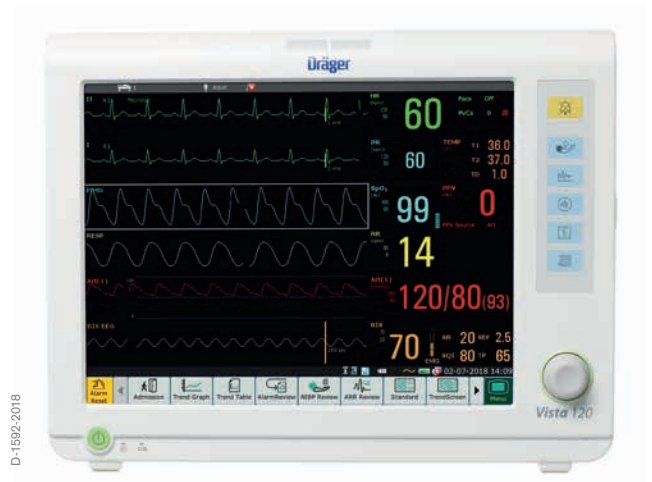

D-1592-2018

Vista 120 SC

With increasing demands on clinicians, it's essential to have an easy-to-use vital signs monitor that can enhance your clinical processes and help you make informed decisions that can positively impact patient care. Providing both spot check and continuous bedside monitoring capabilities, it's the ideal monitor for your various clinical needs.



D-863-2021

NEONATAL ACCESSORIES FOR VISTA 120/VISTA 120 S

ELECTROCARDIOGRAPHY (ECG)

A	ECG trunk cable, 3-lead, for neonates, IEC & AHA	2606492
	ECG electrodes, single-patient use, neonate, 300 pcs.	5195024
	ECG defib trunk cable, Neonate, single-pin, 1.5 m	2612026
	ECG defib trunk cable, Neonate, single-pin, 2.5 m	2612027
B	ECG ESU trunk cable, Neonate, single-pin, 1.5 m	2612028
	ECG ESU trunk cable, Neonate, single-pin, 2.5 m	2612029

DRÄGER SPO₂

C	SpO ₂ sensor, neonate, 0.5 m, disposable, 25 pcs.	2606211
D	SpO ₂ extension cable, 2 m, reusable	2606487

NELCOR OXIMAX SPO₂

E	Nellcor® intermediate cable, 1.2 m	MP00748
	Nellcor® intermediate cable, 3 m	MS20979
F	SpO ₂ multisite sensor Nellcor® DURA -Y™, reusable	MX01004



NEONATAL ACCESSORIES FOR VISTA 120/VISTA 120 S

NON-INVASIVE BLOOD PRESSURE (NIBP)

A	NIBP cuff, neonatal #1, 3 – 6 cm, disposable, 20 pcs., Vista 120	2607034
B	NIBP cuff, neonatal #2, 4 – 8 cm, disposable, 20 pcs., Vista 120	2607035
C	NIBP cuff, neonatal #3, 6 – 11 cm, disposable, 20 pcs., Vista 120	2607036
D	NIBP cuff, neonatal #4, 7 – 13 cm, disposable, 20 pcs., Vista 120	2607037
E	NIBP cuff, neonatal #5, 8 – 15 cm, disposable, 20 pcs., Vista 120	2607038
F	NIBP tube, 3 m	2601195

TEMPERATURE

G	Temperature probe skin, neonate/infant, 3 m, reusable	2601200
H	Temperature probe, rectal/oral, neonatal/Infant, 3 m, reusable	2601199
I	Protective cover for general-purpose temperature probe, contains latex, 10 pcs.	7014616

CO₂ MAINSTREAM

J	etCO ₂ sensor Capnostat 5, reusable	2606226
K	CO ₂ airway adapter, neonatal (infant/pediatric), disposable, 10 pcs.	2606228

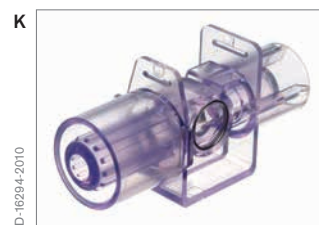

Not all products are available worldwide.

NEONATAL ACCESSORIES FOR VISTA 120 SC

DRÄGER SPO₂

A	SpO ₂ sensor, neonate, 0.5 m, disposable, 25 pcs.	2606211
B	SpO ₂ extension cable, 2 m, reusable	2606487

NELLCOR SPO₂

C	Nellcor® intermediate cable, 1.2 m	MP00748
	Nellcor® intermediate cable, 3 m	MS20979
D	SpO ₂ multisite sensor Nellcor® DURA -Y™, reusable	MX01004
E	SpO ₂ adhesive sensor max N, 24 pcs.	MX50068

NON-INVASIVE BLOOD PRESSURE (NIBP)

F	NIBP cuff, neonatal #1, 3 – 6 cm, disposable, 20 pcs.	2607034
	NIBP cuff, neonatal #2, 4 – 8 cm, disposable, 20 pcs.	2607035
	NIBP cuff, neonatal #3, 6 – 11 cm, disposable, 20 pcs.	2607036
	NIBP cuff, neonatal #4, 7 – 13 cm, disposable, 20 pcs.	2607037
G	NIBP cuff, neonatal #5, 8 – 15 cm, disposable, 20 pcs.	2607038
H	NIBP tube, 3 m	2601195

TEMPERATURE

I	TAT-5000S thermometer	2600946
J	TAT 5000S probe caps	2600948
	TAT 5000S Tubular sheaths	2600949
K	Filac 3000 quick temp pod oral/axi	2600146
L	Filac 3000 quick temp pod rectal	2600147



Not all products are available worldwide.

MONITORING SYSTEMS ■ TCORE® TEMPERATURE MONITORING SYSTEM

Tcore® Temperature Monitoring System

Tcore® – a new non-invasive technology

Tcore employs a unique dual-sensor heat flux technology, which, following a short ramp-up time, calculates core body temperature continuously and accurately.

A simple, self-adhesive sensor placed on the patient's forehead is all that's required. This single-use sensor can be connected through a battery-powered adapter to Dräger monitors, eliminating the need for a dedicated display.

Mild and moderate hypothermia often occurs in patients undergoing medical procedures and can go unnoticed by caregivers.

Thermal monitoring is not a universal practice, and many of the methods currently in use deliver insufficient accuracy or are unreasonably invasive.

Studies have shown that patients who become even mildly hypothermic during medical procedures have longer recovery room times, longer ICU stays and require more analgesics than patients who maintain normal core temperatures. Maintaining normal core temperature helps reduce infections, complications and postoperative mortality rates which can lower the total cost of treatment. In fact, because of the positive impacts, many insurers provide additional compensation when active thermal management is used.

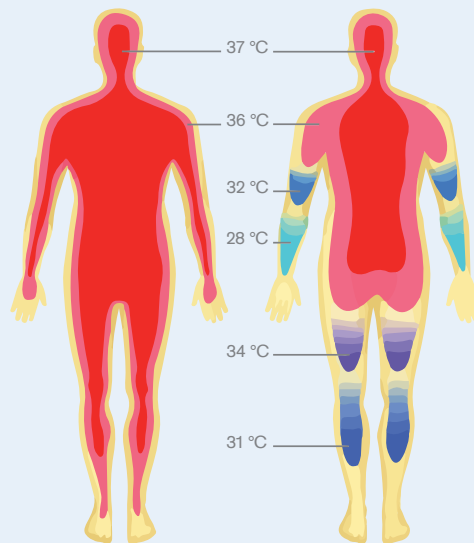

D-64722-2012

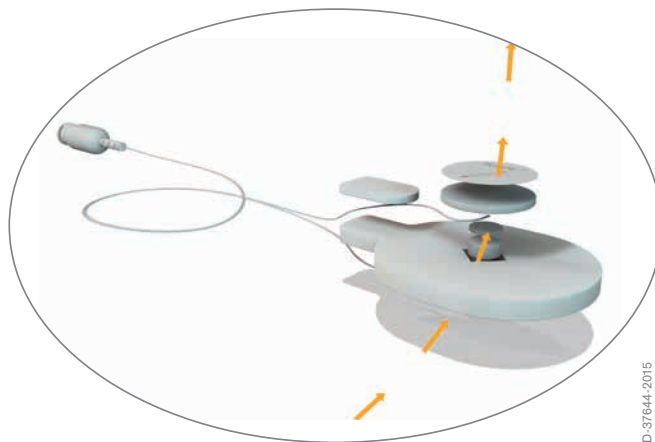

D-37644-2015

ACCESSORIES FOR TCORE® TEMPERATURE MONITORING SYSTEM

A	Tcore® adapter, reusable	MP00999
B	Tcore® sensor, single patient use	MP00989
C	Holder for MultiMed®	MP00721



D-19408-2015



D-19411-2015



MT-8451-2005

Not all products are available worldwide.

LITERATURE

Booklets:

**High-Frequency Oscillatory Ventilation:
Theory and Practical Applications**
(Jane Pillow)

Understanding Newborn Jaundice

Assistance respiratoire non invasive aux nouveau-nés
(Prof. Charles Christoph Roehr)

**Volume Guarantee – New Approaches in Volume Controlled
Ventilation for Neonates**
(Jag Ahluwalia, Colin Morley, Hans Georg Wahle)

▶ Please contact the Dräger sales.

Available in German and English.

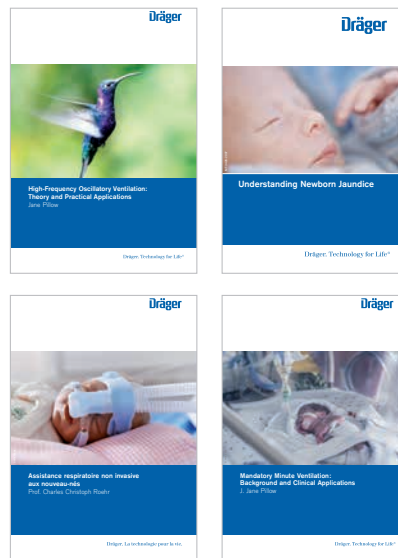

Books for children's: Operation Dreamland + Mission Sleepwell

Operation Dreamland – Tim goes under anesthesia

Inducing anesthesia in children is complicated. Five-year-old Tim has broken his leg – and now he has to undergo surgery. This book depicts what he experiences at the hospital (suitable for children aged 3 and up).

Mission Sleepwell – Max travels to the dream world of anesthesia

Ten-year-old Max fell off his skateboard and has to have surgery. This book tells the story of what he experiences at the hospital (suitable for children ages 6 and up).

▶ Please download the shown material on the Dräger website or contact Dräger sales.

Available in English, German, Italian, French and Spanish.



BabyFirst

Clinical knowledge & family focus. All in one place. The BabyFirst website is a clinical and informational knowledge base for neonatal professionals and parents of premature babies. BabyFirst was created to provide pertinent neonatal clinical information and satisfy a demand for educational tools needed by doctors, nurses, and hospitals. It is also a valuable tool for parents that are thrust into this very emotional and unfamiliar situation and are looking for information.

▶ <http://babyfirst.com/en/home/>







Please download here the
Dräger Accessory Catalog,
order number 9066485.



Not all products, features, or services are for sale in all countries.
Mentioned Trademarks are only registered in certain countries and not necessarily in the country in which this material is released. Go to www.draeger.com/trademarks to find the current status.

CORPORATE HEADQUARTERS

Drägerwerk AG & Co. KGaA
Moislinger Allee 53–55
23558 Lübeck, Germany

www.draeger.com

Manufacturer:

Drägerwerk AG & Co. KGaA
Moislinger Allee 53–55
23558 Lübeck, Germany

REGION EUROPE

Drägerwerk AG & Co. KGaA
Moislinger Allee 53–55
23558 Lübeck, Germany
Tel +49 451 882 0
Fax +49 451 882 2080
info@draeger.com

REGION ASIA PACIFIC

Dräger Singapore Pte. Ltd.
61 Science Park Road
The Galen #04-01
Singapore 117525
Tel +65 6872 9288
Fax +65 6259 0398

REGION CENTRAL

AND SOUTH AMERICA
Dräger Indústria e Comércio Ltda.
Al. Pucurui - 51 - Tamboré
06460-100 - Barueri - São Paulo
Tel. +55 (11) 4689-4900
relacionamento@draeger.com

REGION MIDDLE EAST, AFRICA

Drägerwerk AG & Co. KGaA
Branch Office
P.O. Box 505108
Dubai, United Arab Emirates
Tel +971 4 4294 600
Fax +971 4 4294 699
contactuae@draeger.com

REGION NORTH AMERICA

Dräger, Inc.
3135 Quarry Road
Telford, PA 18969, USA
Tel +1 800 4DRAGER
(+1 800 437 2437)
Fax +1 215 723 5935
info.usa@draeger.com

Locate your Regional Sales
Representative at:
www.draeger.com/contact



