

### Features and Benefits

UN31H1/Y Approved  
 Field Proven Design  
 Reduced Contamination  
 Minimal Residual  
 Low Profile

### Usage

Delivery  
 Storage  
 Transportation  
 Decanting

### Capacities

1,000 litre

### Applications

Hazardous Liquids  
 Corrosive Liquids  
 General Service

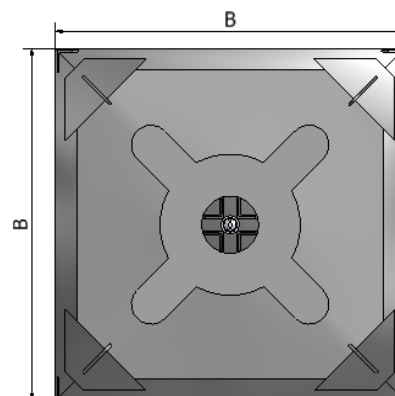
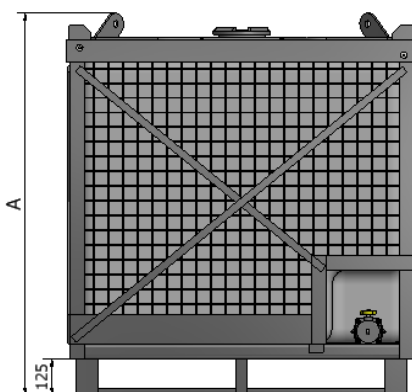

### Standard Equipment

- Discharge: 50mm Ball Valve Camlock
- Fill: 150mm screwed cap
- Bottom lift: 4 way fork entry
- Top Lift: 4 lifting lugs

### Materials

- Bladder: Polyethylene
- Frame: Galvanised steel
- Valve: Polypropylene
- Camlock: Polypropylene

### Options

- Dry break couplings
- Desiccant filtration
- Vapour recovery point
- Pressure & vacuum vents
- IBC Cover

Dimensions, Capacities & Weights are nominal only.

| Code       | Capacity | Dim A (mm) | Dim B (mm) | Weight (kg) | Maximum liquid specific gravity | Test Pressure |
|------------|----------|------------|------------|-------------|---------------------------------|---------------|
| CHEPHD1000 | 1,000 L  | 1298       | 1198       | 265         | 2.0                             | 250 kPa       |