

Braun ThermoScan® PRO 6000 Thermometer Inservice



Table of Contents

1. Overview
2. Cleaning the Probe Tip
3. Cleaning the Body and Accessories
4. Approved Cleaning Solutions
5. Probe Covers
6. Taking a Temperature
7. Interferences
8. Contraindications
9. Memory and Temperature Scale
10. Manual Timer
11. Error Messages and Solutions
12. Batteries
13. Cradles and Charging Station
14. Security
15. Security Function
16. Resources

Overview

Displayed Temperature Range: 68–108 °F (20–42.2 °C)

Age Range: Full-term newborns, pediatrics, and adults

Secure

- Customizable security features to prevent theft, including security tether and wall mountable cradle

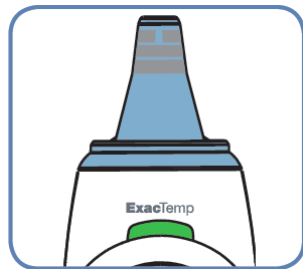

Improved Accuracy

- PerfectTemp™ technology increases accuracy of tympanic measurement compared to core temperature, especially when probe positioning is not, ideal by correcting for shallow placement
- ExacTemp® light to ensure proper, steady probe positioning
- Pre-heated probe tip for more accurate and faster readings

MC12686

Cleaning the Probe Tip

- Gently wipe surface of probe lens window with cotton swab or cloth slightly moistened with **isopropyl or ethyl alcohol only**. Use gentle pressure.
- With probe facing down, wipe the probe with a damp cloth or cleaning wipe moistened with **isopropyl or ethyl alcohol**. Gently wipe with dry, clean cotton swab or cloth immediately.
- Allow at least **5 minutes** drying time before taking temperature. Make sure probe lens window is clean and dry prior to use.

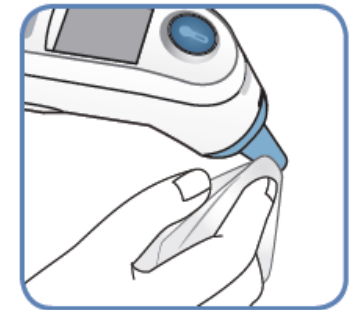
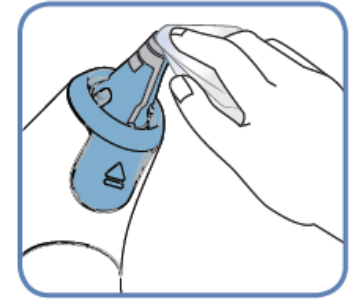

Cleaning the Body and Accessories

- For additional protection, place a new probe cover on the thermometer probe to protect this area when cleaning the body of the thermometer.
- Use a damp cloth or cleaning wipe with **cleaning solution from the Approved Cleaning Solutions Table**. To clean the body, ensure that the wipe is moist, not saturated. Wipe with display facing up.
- Clean accessories using same method. **Dry 5 min.**

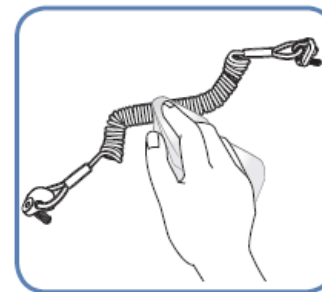
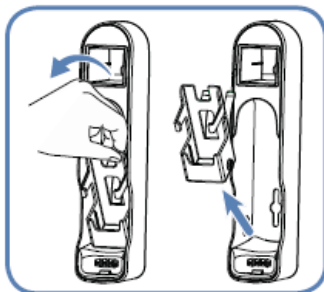
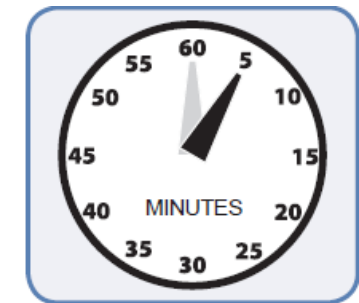
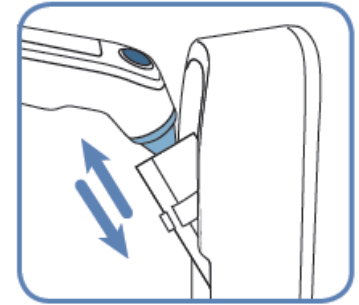

Approved Cleaning Solutions

Approved cleaning solutions					
Family	Solution or Brand	Probe Lens Window	Probe	Thermometer Body & Cradle	Tether
Chlorine and Chlorine Compounds	10% Chlorine Bleach solution	No	No	Yes	Yes
Quaternary Ammonium Compounds	CaviWipes™ Clinell® Universal Wipes SaniCloth Metrex	No	No	Yes	Yes
Hydrogen Peroxide	Virox Oxivir	No	No	Yes	Yes
Alcohol	70% isopropyl or ethyl alcohol	Yes	Yes	Yes	Yes

Probe Covers

Probe covers

- Are intended for **single use only!**
- Always use PRO 6000 disposable probe covers **ONLY.**
- **Damaged, perforated, or soiled covers can lead to inaccurate temperatures.**
- The device will **not** take a temperature without a probe cover in place.



To install the new probe cover box into the cradle

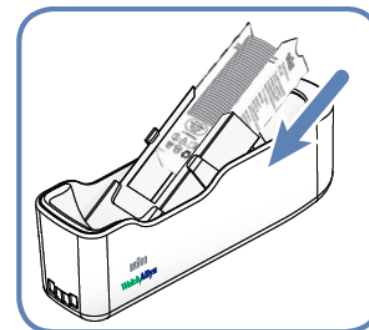
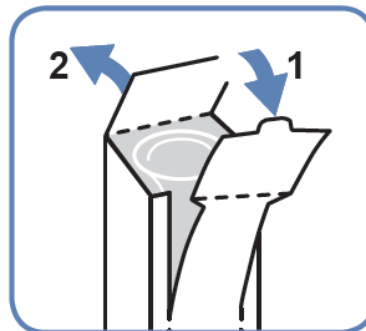
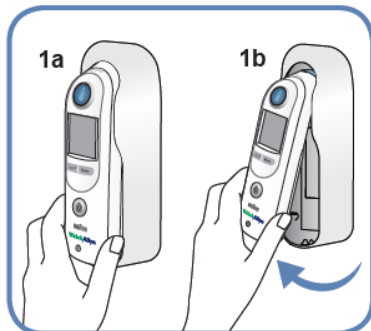

MC12686

Taking a Temperature

Operation and technique

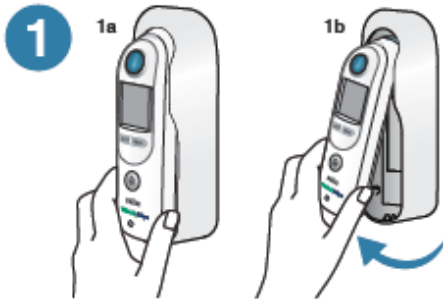

Remove thermometer from cradle by gripping thermometer at base and pivoting up. Thermometer will turn on automatically. Probe cover icon  will flash on display indicating a new probe cover is needed.

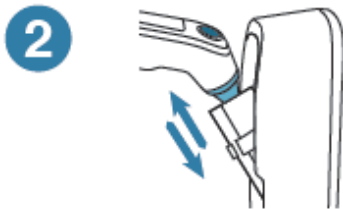

Attach a new probe cover by pushing probe tip straight into box, then pulling thermometer out.



Wait for the ready indication. Ring around MEASURE  button turns green, thermometer will beep once and three lines on display indicate thermometer is ready.

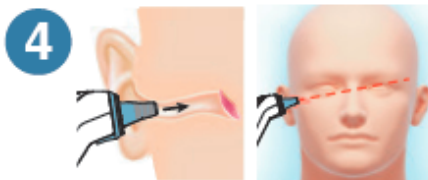

Place probe snugly in ear canal and direct toward opposite temple. Keep thermometer probe steady in the ear canal. Correct probe placement is essential for accurate measurements.

Proper Probe Placement Guide

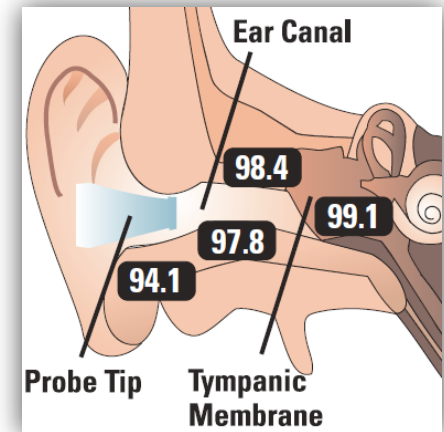

Taking a Temperature

5



Press and release **MEASURE**  button. The thermometer will beep once, running dashes will appear on the display then the green ExacTemp light will flash, indicating consistent probe position.

6



Temperature measurement. A long beep and steady green ExacTemp light will signal the end of the measuring process. The temperature will show on the display.

7



Remove used probe cover by pressing Probe Cover Ejector button .

To achieve accurate measurements, use a new, clean probe cover for each measurement.

To take another measurement, place a new, clean probe cover on the thermometer.

NOTE: If no action is taken the thermometer will enter SLEEP after 10 seconds or upon returning to the cradle or host device.

Interferences

External factors may influence ear temperatures, including:

Factor	Affected	Not affected
Used probe cover	✓	
Ambient temperature		✓
Wet / dirty / damaged lens	✓	
Hearing aid	✓	
Lying on pillow	✓	
Moderate cerumen (ear wax)		✓
Otitis media (ear infections)		✓
Tympanostomy tubes		✓

For persons wearing **hearing aids** or in **extreme ambient temperatures**, remove the hearing aid or the individual from the situation and wait 20 minutes prior to taking a temperature.

Contraindications

- **Do not** use if there is **blood or drainage** in the external ear canal.
- **Do not** use if a patient exhibits symptoms of an acute or chronic **inflammatory condition** of the external ear canal.
- **Not** intended for **pre-term babies** or **small-for-gestational age babies**
- **Complete ear canal occlusion** due to cerumen (ear wax) can result in **lower temperature readings**.
- Use the **untreated ear** if prescription **ear drops** or other **ear medications** have been placed in the ear canal.
- Patients who have **deformities of the face and/or ear** may not be able to have a temperature taken with an ear thermometer.

Memory and Temperature Scale

Memory

Press the MEMORY button to display last complete temperature.

- The temperature will show with a MEM indicator until the MEMORY button is pushed again, a new probe cover is applied, or the thermometer enters sleep state.

Memory can also be accessed from the sleep mode and will display for 5 seconds.

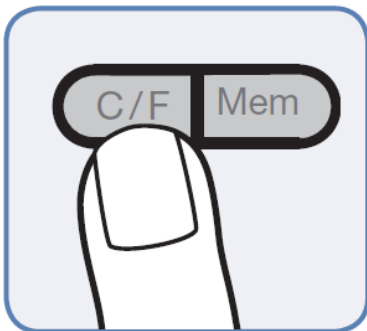
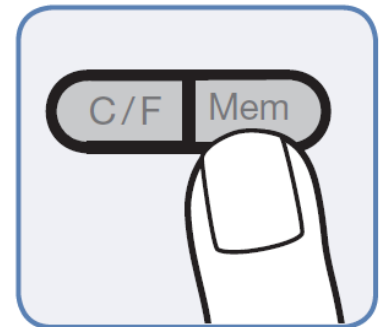

Temperature Scale

Switch to alternative temperature scale by pushing the C/F button while a reading is being displayed.

- Press C/F button again to revert back
- Also reverts back when unit goes to sleep

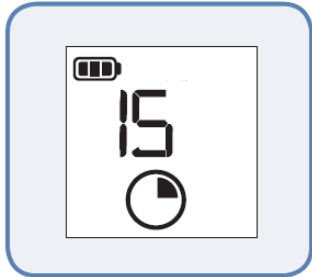

Manual Timer

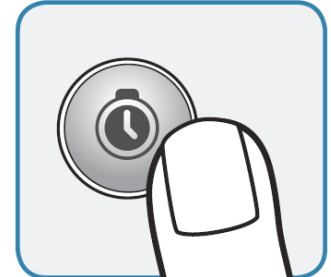

Includes a **60-second timer** that features an **audible notification** and **visual indicator** at 0, 15, 30, 45, and 60 seconds. This feature can be used to time pulse, respirations, etc.







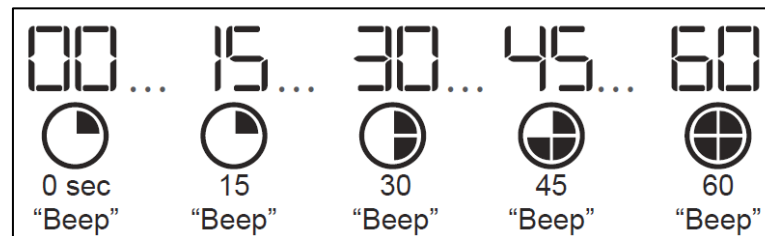

To use:

1. Press and hold timer button  for one second to activate timer (a beep is heard at initiation of timer)
2. The timer will beep at the completion of each 15-second interval. Then the current segment will become solid and the next segment will flash.
3. At 60 seconds a long beep will sound, all quadrants will appear solid, ending the timer function.
4. The thermometer will exit the timer mode after an additional 5 seconds
5. To stop the timer at any time, press the timer button 









Error Messages and Solutions

Error message	Situation	Solution
	No probe cover is attached (animates ON).	Attach new, clean probe cover.
	Used probe cover is attached (animates OFF).	Discard probe cover that is on and attach new, clean probe cover if taking another temperature measurement.
	(POS = position error) The infrared monitor cannot find a temperature equilibrium and allows no measurement.	Change the probe cover to reset. Restrict patient movement and ensure that the positioning of the probe is correct and remains stable while taking new temperature.
	Ambient temperature is not within the allowed operating range (50 – 104 °F or 10 – 40 °C) or changing too rapidly.	Wait 20 sec. until thermometer turns off automatically, then turn on again. Ensure thermometer and patient are in an environment for 30 minutes where the temperature is between 50 °F and 104 °F or 10 °C and 40 °C.
	Temperature taken is not within typical human temperature range. HI will be displayed when temperature is higher than 108°F (42.2°C).	Change probe cover to reset. Then, make sure thermometer is properly inserted and take a new temperature.
	LO will be displayed when temperature is lower than 68°F (20°C).	

MC12686

WelchAllyn[®]

Error Messages and Solutions

Error message	Situation	Solution
 <p>or</p> 	<p>System error (All icons display or display is blank)</p> <p>If error persists,</p> <p>If error still persists,</p> <p>If error still persists,</p>	<p>Wait 20 seconds until the thermometer turns off automatically, then turn on again.</p> <p>... reset the thermometer by removing the batteries and putting them back in.</p> <p>... batteries are dead. Insert new batteries.</p> <p>... contact local Welch Allyn Service Center or representative</p>
	Battery is low, but thermometer will still operate correctly.	Insert new batteries.
	Battery is too low to allow temperature measurement.	Insert new batteries.
	PerfectTemp technology is not functioning or disabled.	... contact local Welch Allyn Service Center or representative
	U is "Unadjusted Operating Mode". Mode used for raw temperature measurement. Requires service tool access to enable.	See 11.3 Advanced function settings and adjust settings via Service Tool or contact local Welch Allyn Service Center or Representative

Batteries

- Uses two (2) AA alkaline batteries
 - 1,000 measurements from new set
- Can use rechargeable batteries
 - 700 measurements per charge
 - Requires Charging Station (sold separately)

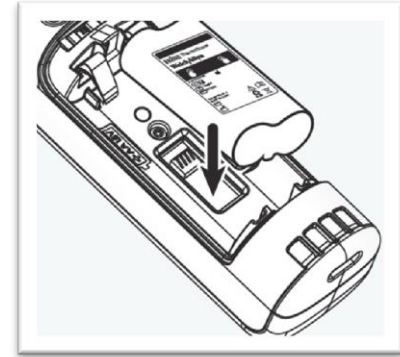

Rechargeable battery pack

To install the AA alkaline batteries

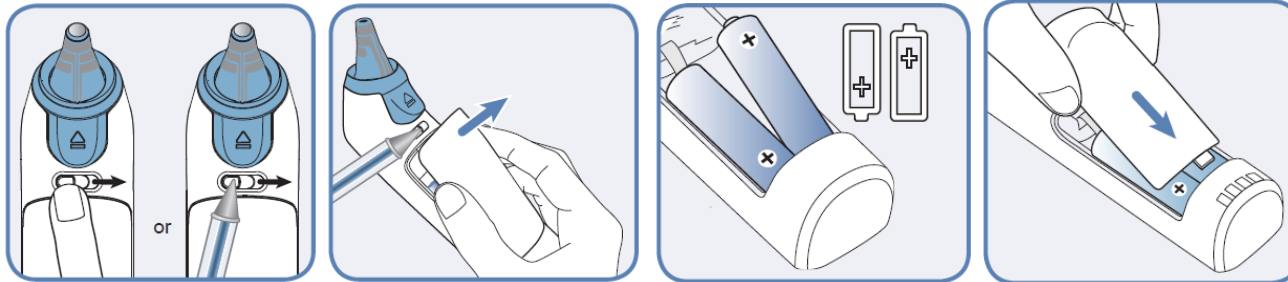

If needed, change the C/F default setting with switch in the battery compartment using a pen or pointed object

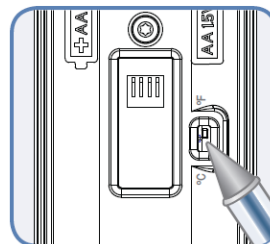

Cradles and Charging Station

Two Protective Cradles available to choose from

Small Cradle



Portable, holds 1 box probe covers

Large Cradle



Wall mountable, holds 2 boxes probe covers

- Cradles can be used with Charging Station
- Tethers can be attached between thermometer and cradle for added security

Optional Charging Station available separately

- For use with rechargeable batteries
- Fully recharges in approximately 3-4 hours from empty
- Fast Charge Nickel-metal Hydride battery type
- Up to 700 measurements from a full charge
- Also holds a sleeve of 200 probe covers



Security

Large Cradle Mounting Option

- Large cradle can be temporarily or permanently screwed to a wall surface

Optional Security Tether

- 1.8 m (6ft) and 2.7 m (9ft) security tethers screw to the cradle and thermometer
 - Tether also attaches to Connex[®] Spot Monitor

Electronic Time Security (see next slide)

- Select 1-12 hours operation until thermometer locks
- To unlock, dock the device and cradle into any Charging Station
 - Requires Charging Station (or Connex Spot Monitor) and Service Tool software to activate security function

Security Function

1. When the security function is enabled, an unlocked icon is displayed next to the battery indicator during normal use to show that the security function is active.
2. When the device is within 60 minutes of the time limit, a countdown clock shows the number of minutes remaining next to the unlocked icon. At 5 minutes prior to expiration, the thermometer will begin to beep once per minute and the unlocked icon will flash.
3. Upon expiration of the time limit, the unlocked icon and countdown timer will be replaced with the locked icon and the thermometer will beep once every 5 minutes to indicate locked state. Unlock the thermometer by returning it to the charging station.

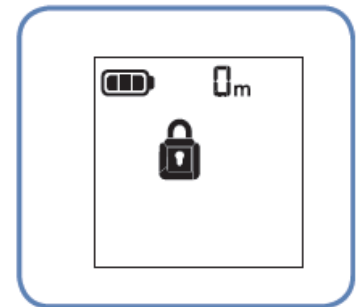
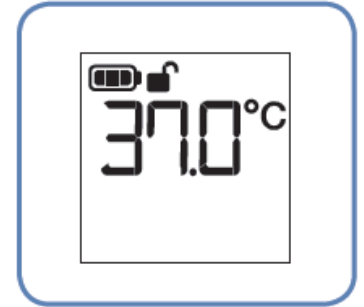

**NOTE: Requires Charging Station and Service Tool software
set up done by Biomedical Engineering**

Resources

Thank you for choosing

WelchAllyn[®]

**Customer Care:
1-800-535-6663**

**Website:
www.welchallyn.com**

