



Alen BreatheSmart 45i HEPA Air Purifier

USER MANUAL



We would love to hear from you. If you have any questions, please contact us at **1(800) 630-2396** or email **service@alen.com**.

TABLE OF CONTENTS

- Air Purifier Safety 3**
- Using Your Air Purifier 4**
 - Operating Your Unit
 - Identification of Parts
- Know Your Air Purifier 6**
 - Getting Started
 - Features
- Care & Maintenance 6**
 - Cleaning Instructions
 - Filter Care
 - Alen’s Filter Subscription Program
 - How to Replace the Filter
- Troubleshooting Tips 9**
- Regulatory Information 10**



The 8 hr TWA Ozone for this product is 0.001 ppmv when tested in a 30 m3 chamber. Refer to safety instructions in manual for more information. See back of unit for rating label and regulatory markings.

AIR PURIFIER SAFETY

This manual provides important safety messages regarding your electrical home appliance. Always read, follow, and, save all safety directions.

Location Requirements

- Use a level surface at least 6" (15.2cm) from heat sources such as ranges, dryers, or heaters.
- Do not block air vent openings.
- Never insert fingers or foreign objects into air vents.
- Do not place air purifier on a soft or unstable surface such as a bed or sofa.
- Do not use in a window.
- Do not use next to a source of heat such as a range, heater, or dryer.
- Do not use near any source of water such as a sink, bath, shower, or swimming pool.
- Operate indoors only.

Electrical and Safety Requirements — Reduce the risk of fire or electric shock.

Failure to follow these instructions can result in property damage, injury, or death.



- Do not connect unit to any electrical socket that is damaged.
- Do not plug the air purifier into an outlet controlled by a dimmer switch.
- Do not insert or pull out plug with wet hands, it may cause electric shock.
- Do not use an adapter. Do not use an extension cord.
- Use only in the proper electrical socket type. Socket type (voltage & hertz) can be found on the unit's back panel label. Incorrect socket use can damage/destroy the unit.
- Do not exceed the rating of the power outlet or connection device. May cause electric shock or fire due to excess heat generation.
- Never try to take apart or repair the unit by yourself.
- Disconnect power immediately if you notice strange sounds, smells, or smoke.
- Change your filter at the recommended interval to avoid particle and dust buildup.
- Ensure filter is correctly installed before turning on unit. Do not run unit without a filter.
- Do not cover the unit or impede airflow.
- Do not drop the unit, as this can result in damage.
- Do not place heavy objects on the power cord and be sure the cord is not compressed as there is danger of fire or electric shock.
- Do not spray insecticides or any other flammable sprays near the unit. It may cause explosion or fire.
- **WARNING!** To reduce the risk of electric shock, this equipment has a polarized plug (one blade is wider than the other). This plug will fit in a polarized outlet only one way. If the plug does not fit fully in the outlet, reverse the plug. If it still does not fit, contact qualified personnel to install the proper outlet. Do not alter the plug in any way.

USING YOUR AIR PURIFIER

PLEASE NOTE:

The BreatheSmart 45i has capacitive touch control panels. The buttons only operate with a quick, light touch. Holding the buttons down will not activate the controls properly. A chime will indicate that the control has registered your touch.

Operating Your Unit:

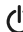
1. Plug your air purifier into a grounded outlet.
2. Touch  Power Button in the center to start the air purifier. When your unit is on, the lights will illuminate. To turn off display lighting, press the  Power Button. To turn off the air purifier, touch the  Power Button again after the lights have turned off. The LIGHT Button can also be used to control the display lighting.
3. The BreatheSmart 45i has a Color Ring around the  Power Button indicating air quality, as measured by the particle sensor.

| COLOR | MEANING |
|--------|---|
| Blue | Very low level of airborne particles detected |
| Green | Low level of airborne particles detected |
| Orange | Medium level of airborne particles detected |
| Red | Significant level of airborne particles detected |
| Purple | Very significant level of airborne particles detected |

4. Press IONIZER to activate the ozone-safe ionizer. Activation of the ionizer enhances your unit's ability to remove airborne particles (similar to the way dust is attracted to a TV screen). Press the ionizer button again to turn off.
5. FILTER life Indicator — There are three lights above the FILTER button: Green, Yellow, and Red. The Green light will be illuminated for most of the life of the filter. The Yellow light will come on shortly before your filter should be replaced. This is the ideal time to order a new filter. The Red light will be illuminated when it is time to replace the filter.
6. After changing the filter, hold the FILTER button down for five seconds. This will reset the Red light to Green.
7. Touch LIGHT to adjust display lighting (LO, HI, or OFF). LO dims lights by 50%.

Identification of Parts – BreatheSmart 45i Control Panel

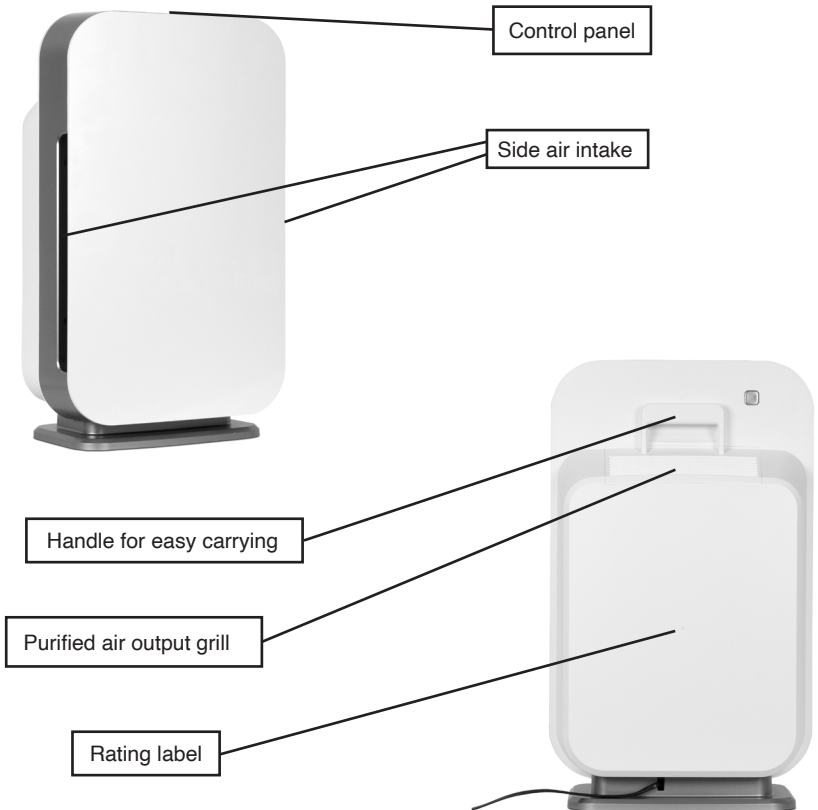
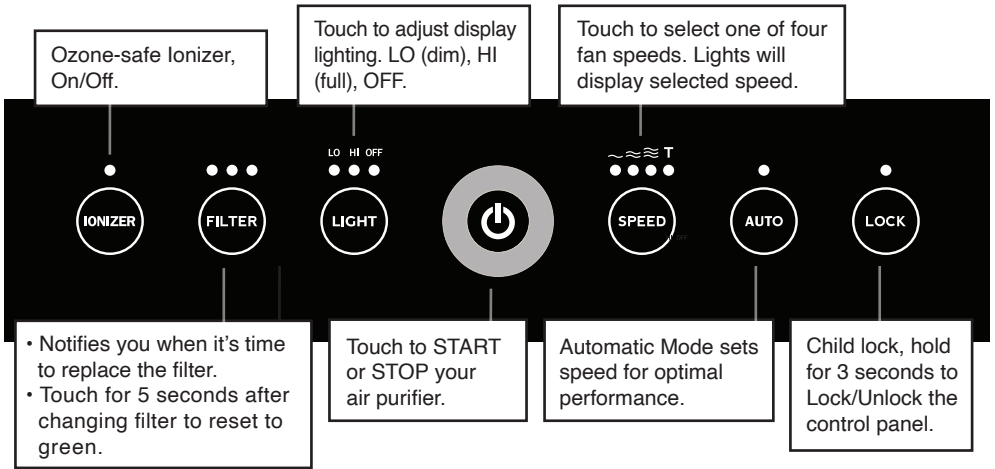

KNOW YOUR AIR PURIFIER

Getting Started

When using the air purifier for the first time, we recommend that you use a higher fan speed, such as speed three (3) or Turbo (T), for at least two hours to quickly clean the room's air. Then, we recommend that the air purifier run continuously on speed two (2) or three (3) to maintain air quality, or set your unit to Auto mode.

BreatheSmart 45i Features

- True HEPA filtration captures dust, allergens, and airborne pollutants
- Four fan speeds to control air circulation
- Three settings to control display lighting
- Filter change indicator light keeps replacements on schedule
- Simple and intuitive touch button controls
- Auto-off safety feature when front cover is removed

Turn The Lights Off/On

To turn your unit's display lighting off, touch the LIGHT button and select OFF. The lights will go out, but the unit will continue running. To dim the lights on your unit, select LO.

CARE & MAINTENANCE

Cleaning Instruction

To avoid scratching the control panel, do not use abrasive/caustic cleaning solutions or scrubbing pads. With the unit unplugged, dampen a clean towel lightly with soap and water to clean the control panel, then dry gently with a soft cloth or paper towel. Glass cleaner (e.g. Windex) is also OK. To avoid damaging electronic components, DO NOT allow liquid to seep into the unit.

Prefilter Cleaning

The black mesh layer on the front of the filter, known as the prefilter, captures large dust and hair. This layer is held on with Velcro®-like strips. This prefilter can be vacuumed in place to maintain efficient operation of the unit.

Replacing The Filter

The Filter Indicator has three lights: Green, Yellow, and Red. The Green light will be illuminated for most of the life of the filter. The yellow light will come on shortly before your filter should be re-placed. This is the ideal time to order a new filter. You may order a new filter at www.alen.com/filters or by calling 1-800-630-2396. The Red light will be illuminated when it is time to replace the filter.

The filters used in Alen Air Purifiers are not designed to be washed, cleaned, or otherwise reused. Over time, the filters become overloaded with particles, decreasing their filtration performance. We recommend regular filter replacements to extend the life of your air purifier and maximize performance.

Reset the Filter Indicator

After replacing the filter, hold the FILTER button down for five seconds. The Red light will be reset to Green.

Why You Should Replace Your Filter

- You purchased an Alen Air Purifier to improve the quality of your indoor air.
- Changing your filters on time is the only way to maintain an optimal level of air quality.
- Excessively dirty filters can compromise the level of clean air your air purifier can provide.

ALEN'S FILTER SUBSCRIPTION PLAN — Pure Air Made Simple

Regular replacement of your filter will extend the life of your air purifier and keep your air clean. Alen filters provide efficient filtration for 9 to 12 months depending on usage and conditions. With Alen's convenient Filter Subscription Plan, your filters will be shipped right to your door, exactly when needed.

Savings — Save 5% over retail and get FREE SHIPPING on every filter.

Convenience — Choose your desired shipping frequency and never run out of filters.

Superior Coverage — Alen's exclusive Forever Guarantee begins when you complete Product Registration and activate your Filter Subscription.

To get started, simply visit www.alen.com/activate or call 1-800-630-2396.

How To Replace The Filter

1. Always unplug the unit when installing a filter.
2. Distinguish the front side from the back side of the filter. The front side has a mesh prefilter attached with Velcro®-like strips.
3. Place the used filter in a plastic bag to prevent dust from re-entering the air.



1. To remove cover, pull firmly on the cover near the top of the intake vents with both hands to release the magnets.

2. After pulling the cover out, lift it away from the unit.

3. Remove the used filter by pulling out on the ribbon loop. Place the used filter in a plastic bag to prevent dust from re-entering the air.



4. **Take the new filter out of the plastic bag** and insert it into the purifier with the tab facing outward.

5. Insert the bottom hooks on the front cover first and then the upper part of the cover will snap into place.





WARNING! RISK OF ELECTRIC SHOCK - To reduce risk of electric shock, do not perform any servicing other than that contained in the operating instructions.

TROUBLESHOOTING TIPS

How do I reset the filter indicator lights? I put in a new filter but the red or yellow lights are still illuminated.

After changing the filter, RESET the filter indicator by holding down the FILTER button for five seconds while the unit is ON. The light above the FILTER button should reset to green.

How do I find out what electrical specifications my unit needs?

Please refer to the rating label on the back of the unit. Here you will find your unit's voltage, hertz, amps, and outlet requirements.

Can I clean the filter?

The black mesh layer on the front of the filter, known as the prefilter, captures large dust and hair. This layer is held on with Velcro®-like strips. This prefilter can be vacuumed in place or replaced with a new prefilter to maintain efficient operation of the unit. No other layers or parts of the filter can be washed, cleaned, or otherwise reused. Please replace the filter regularly to maintain optimal performance.

I have an issue not listed in this manual.

Please visit www.alen.com, send us a message at service@alen.com, or call 1-800-630-2396 during business hours. A customer service representative will respond to your inquiry in a timely manner.

What information do I need when I contact customer service for warranty?

Please refer to the rating label on the back of the unit. This rating label has your unit's serial number and other important information we need to assist you.

WARRANTY AND EXTENDED COVERAGE

Please visit <https://alen.com/foreverguarantee> for all warranty information. For any questions, please contact customer service by calling 1-800-630-2396 or email service@alen.com

Alen Corporation
9200 Waterford Center Blvd. Suite 600
Austin, TX. 78758

REGULATORY INFORMATION

FCC Statement

This device complies with Part 15 of the FCC Rules. Operation is subject to the following two conditions: (1) This device may not cause harmful interference, and (2) this device must accept any interference received, including interference that may cause undesired operation.

Warning

Changes or modifications to this unit not expressly approved by the party responsible for compliance could void the user's authority to operate the equipment.

NOTE: This equipment has been tested and found to comply with the limits for a Class B digital device, pursuant to Part 15 of the FCC Rules. These limits are designed to provide reasonable protection against harmful interference in a residential installation. This equipment generates, uses and can radiate radio frequency energy and, if not installed and used in accordance with the instructions, may cause harmful interference to radio communications. However, there is no guarantee that interference will not occur in a particular installation. If this equipment does cause harmful interference to radio or television reception, which can be determined by turning the equipment off and on, the user is encouraged to try to correct the interference by one of the following measures:

- Reorient or relocate the receiving antenna.
- Increase the separation between the equipment and receiver.
- Connect the equipment into an outlet on a circuit different from that to which the receiver is connected.
- Consult the dealer or an experienced radio/TV technician for help.

FCC/ISED RF Exposure Information: This equipment should be installed and operated with a minimum distance of 20 centimeters between the radiator and your body.

Canada

This Class B digital apparatus complies with Canadian ICES-003.

This device contains licence-exempt transmitter(s)/receiver(s) that comply with Innovation, Science and Economic Development Canada's licence-exempt RSS(s). Operation is subject to the following two conditions: (1) This device may not cause interference, and (2) this device must accept any interference, including interference that may cause undesired operation of this device.

L'émetteur/récepteur exempt de licence contenu dans le présent appareil est conforme aux CNR d'Innovation, Sciences et Développement économique Canada applicables aux appareils radio exempts de licence. L'exploitation est autorisée aux deux conditions suivantes : (1) L'appareil ne doit pas produire de brouillage; (2) L'appareil doit accepter tout brouillage radioélectrique subi, même si le brouillage est susceptible d'en compromettre le fonctionnement.

Cet appareil numérique de la classe B est conforme à la norme NMB-003 du Canada.

FCC/ISED Informations sur l'exposition RF: Ce matériel doit être installé et exploité à une distance minimale de 20 cm entre le radiateur et votre corps.



Copyright © 2021 Alen Corp. All Rights Reserved.
BreatheSmart 45i October-13-2021