

MA STER SERIES

CNC WORKING CENTRE
FOR STONE



LATEST-GENERATION TECHNOLOGY



The **Master Series** is the range of machining centres dedicated to stone processing. These technologies can machine sheets of natural materials, ceramics and synthetic materials used for floors, façades and cladding, furnishings, kitchen tops and funerary applications.

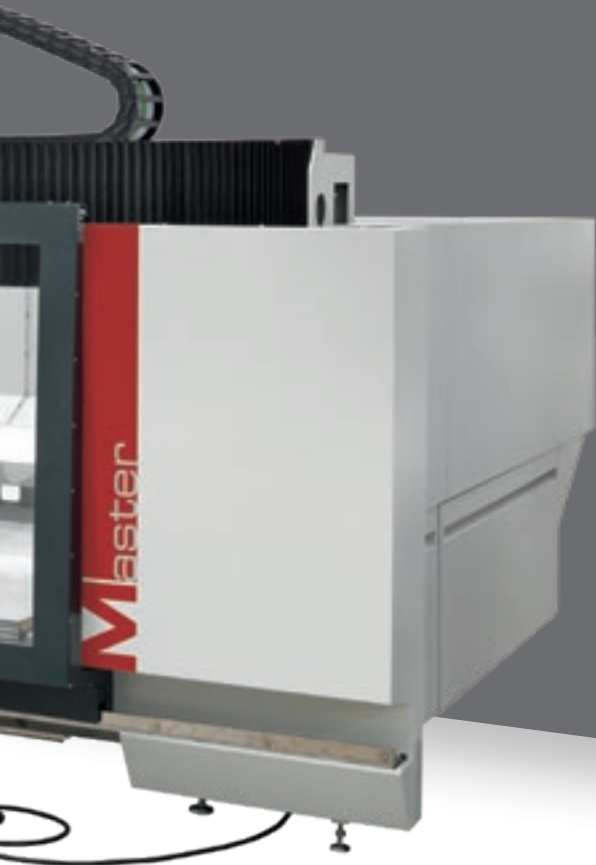

MASTER SERIES

- ✓ UNPRECEDENTED QUALITY AND FINISH.
- ✓ FLEXIBILITY AND VERSATILITY IN ALL MACHINING OPERATIONS AND WITH ALL MATERIALS, FOR UNRIVALLED PRODUCTIVITY.
- ✓ SUPERB PERFORMANCE EVEN WHEN CARRYING OUT THE MOST COMPLEX MACHINING OPERATIONS.
- ✓ REDUCED TOOLING TIMES.
- ✓ EXTENSIVE CHOICE OF TOOLS, READY FOR ALL TYPES OF MACHINING OPERATION.
- ✓ FUNCTIONAL DESIGN AND ERGONOMIC PROTECTION FOR OPTIMUM VISIBILITY AND MAXIMUM SAFETY DURING MACHINING.

UNPRECEDENTED QUALITY AND FINISH

The Master series is capable of performing the most complex and varied machining operations, providing users with superb finish quality when working with natural stone, granite, marble and synthetic and ceramic materials for bath tops and kitchen tops.



MASTER PROCESSING CENTRES ARE DESIGNED TO OFFER OPTIMUM FINISH QUALITY ON SHEETS AND BLOCKS OF NATURAL AND SYNTHETIC MATERIALS AND CERAMICS, GUARANTEEING MAXIMUM RELIABILITY AT ALL TIMES.

FLEXIBLE AND VERSATILE IN ALL MACHINING OPERATIONS AND WITH ALL MATERIALS



Ideal for all types of machining operation:

- ▣ Boring
- ▣ Milling
- ▣ Grinding and polishing
- ▣ Recesses
- ▣ Cup grinding
- ▣ Tapering
- ▣ Writing and engraving
- ▣ Ageing
- ▣ Engraving
- ▣ Profiling



QUALITY THAT IS UNEQUALLED ON THE MARKET

Cup grinding and polishing on the external profile and the internal squared bore, using an aggregate with magnetic tool change.



Drainage channels on a tilted table for kitchen tops.



45° disc cuts for joints.

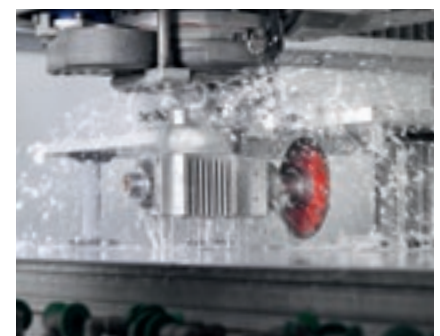

Aggregate for undercuts on kitchen tops.

ENDLESSPOSSIBILITIES

The solid 5-axis hi-tech working head is capable of machining kitchen tops and slabs and blocks with perfect results, demonstrating the renowned quality of Biesse work centres.



Disc cut at any angle.



Polishing of rounded profiles on slabs.



Bevel with variable angle.



Cup grinding of the external edge.

INNOVATION

The background of the page is a blurred, high-angle photograph of a 5-axis CNC machine. The machine's head is positioned over a white, intricately carved part, possibly a decorative architectural element. The machine's components, including a red vertical beam and various cables, are visible but out of focus, creating a sense of depth and technical precision.

5-AXIS TECHNOLOGY

High level technology for the best results and extremely easy to use.

The 5-axis head with endless rotation C axis and tilting A axis (from -90° to $+90^{\circ}$) ensures excellent flexibility and pushes the limit for the execution of complex machining operations.

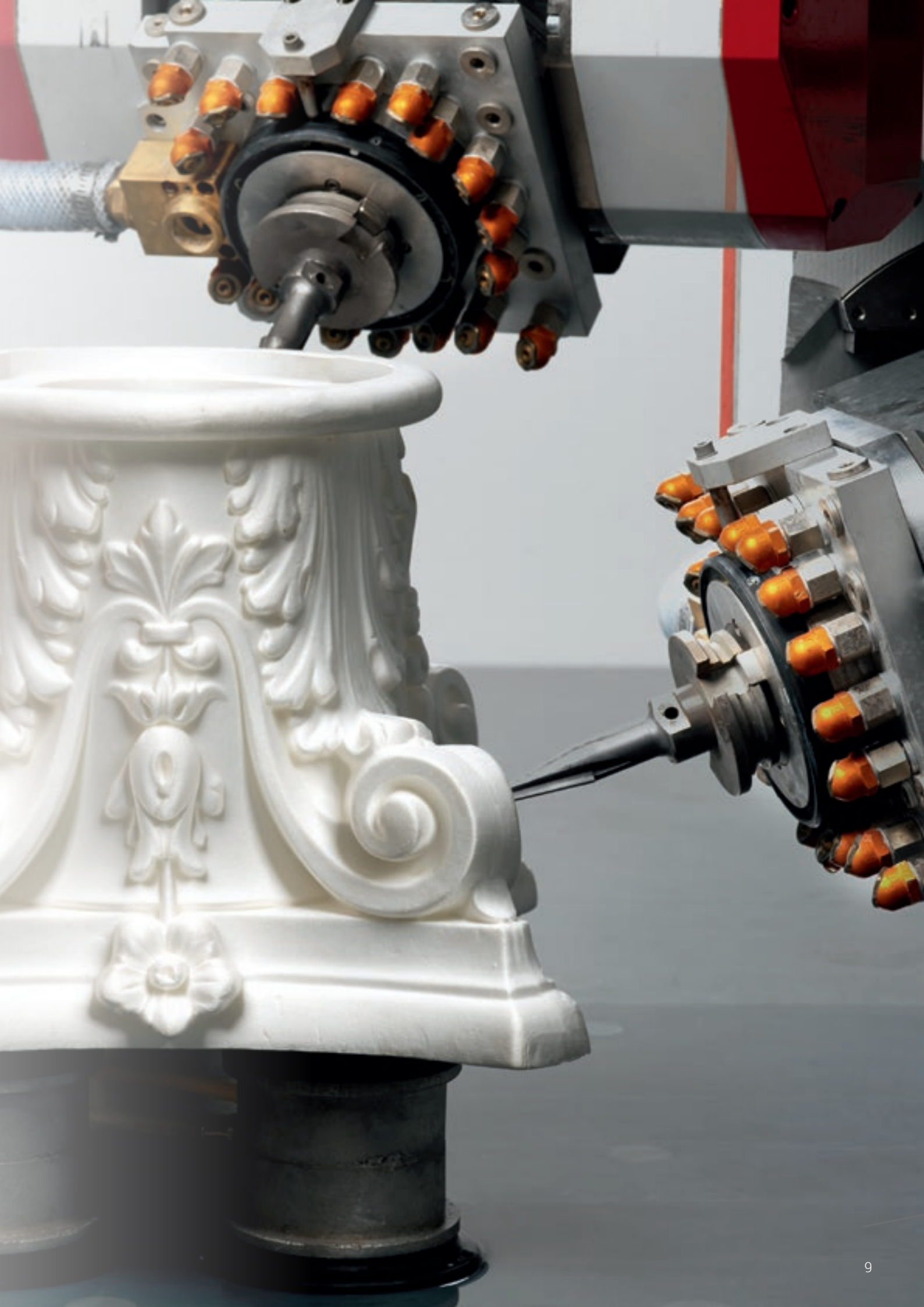

HIGHPERFORMANCE

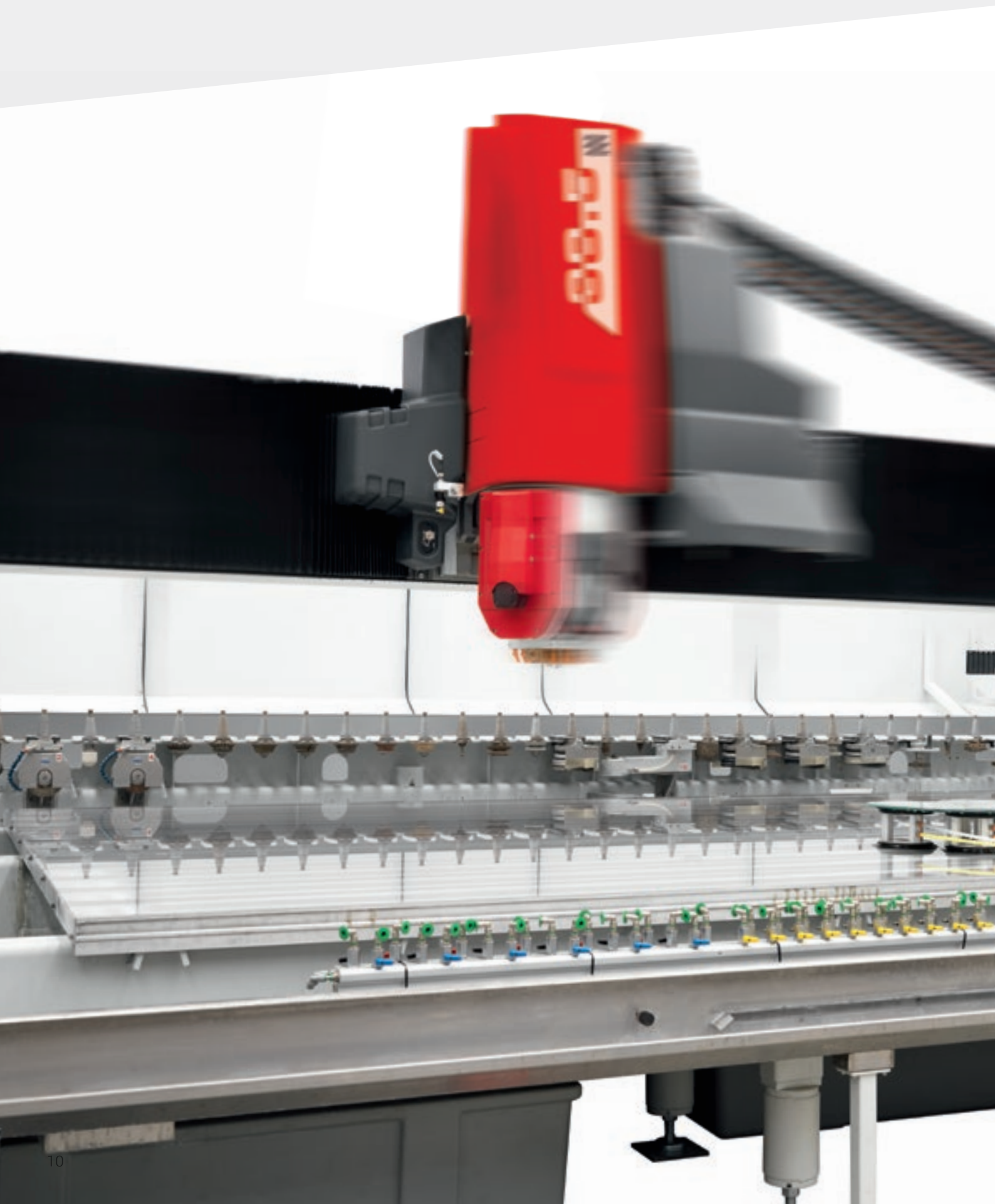

In line with requirements, the machine can be equipped either with a C Axis or a T Axis.

Maximum acceleration and axle speeds, minimising waiting times and enabling cycle times to be reduced.



C axis with endless rotation, for the perfectly smooth and accurate execution of even the most complex machining operations.



Tilting T axis ($\pm 2.5^\circ$) for making recesses for kitchen tops on the tilted table.

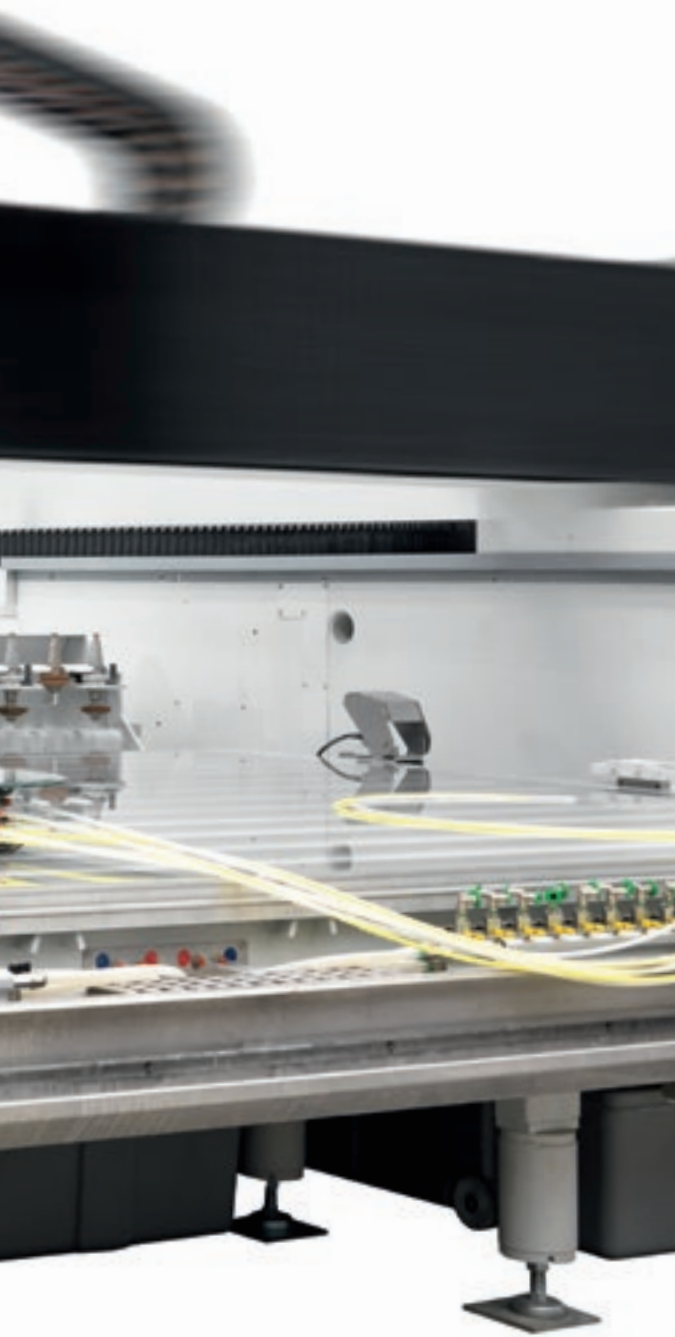

CUSTOMISABLE ACCORDING TO REQUIREMENTS

The machine work table is an extremely rigid structure upon which is placed an aluminium worktable calibrated to grant maximum flatness of the work area, fundamental for first class machining results. The machine is designed to work in twin-station mode too.

The beam is moved by means of twin-motor gantry technology to ensure greater accuracy and a longer lifespan.



The size of the work table is optimised for all production requirements.



The dual height of the work table (525 or 730 mm) simplifies loading and unloading of panels in line with the varying requirements.



Compact width and height for smaller working dimensions.



Master processing centres can also be configured in the Plus version for companies that need to machine particularly thick pieces.

MAXIMUM MACHINING RELIABILITY AND PRECISION



The Master range is fitted with spindles manufactured by HSD - a world leader in its sector. They guarantee optimum power, compact dimensions and extremely high finishing standards.

- ✔ **+60% spindle lifespan and noise reduction** thanks to 4 ceramic bearings that offer greater resistance to mechanical stress.
- ✔ **Greater reliability** thanks to the use of stainless steel and the 55mm spindle shaft.

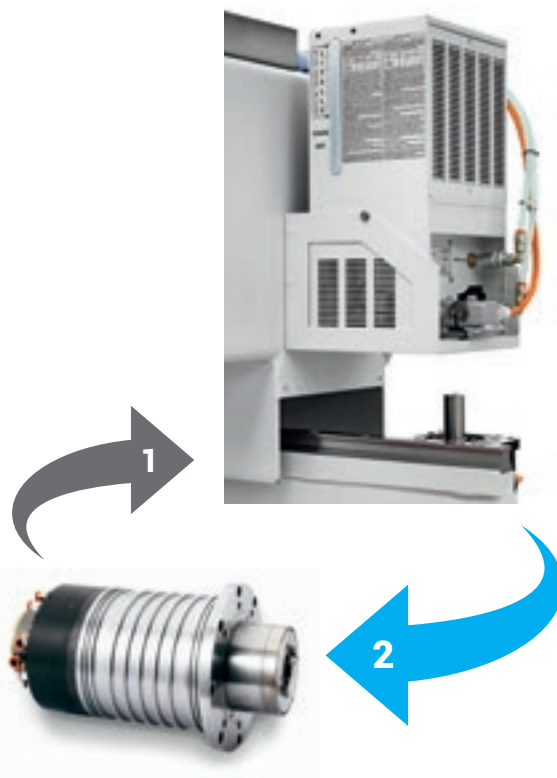

Glycol-based cooling systems with a closed circuit that guarantees constant results over time and resistance to the maximum machining stress levels.

1. **High-temperature fluid** (cooling system with heat exchanger).
2. **Low-temperature fluid**

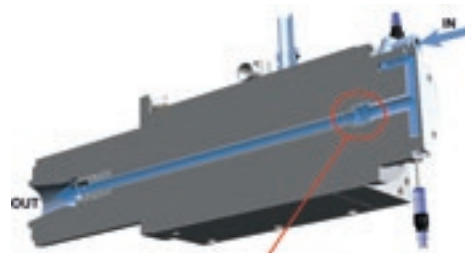

DPC (patented) - Controlled loss distributor
A patented system that ensures excellent reliability and a long lifespan, thanks to the innovative seal system with no mechanical contact.

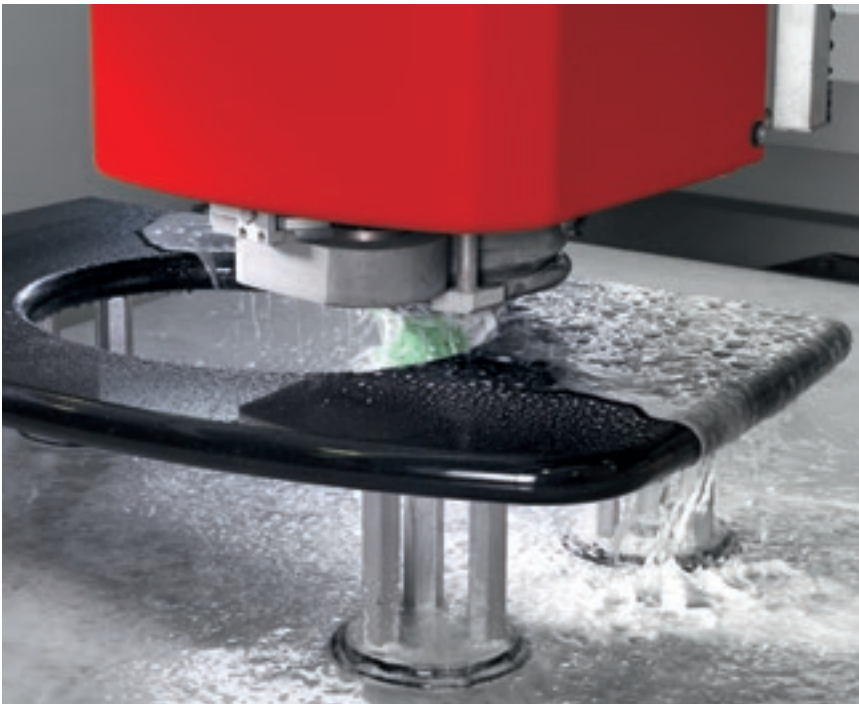

Spindle absorption is constantly measured by the NC, and the pressure exerted by the tool on the piece is then proportionally adjusted to guarantee the best possible finish quality.



The entire Master range is equipped with an integrated system for the automatic greasing of the movement axes, ensuring constant and precise maintenance every day.

WIDERANGE OF TOOLS READY TO USE ON THE MACHINE

The Master Series offers the option of equipping the machine with a large number of ready-to-use tools for any type of machining operation, with automatic loading via the working unit.



Rear single row magazine.

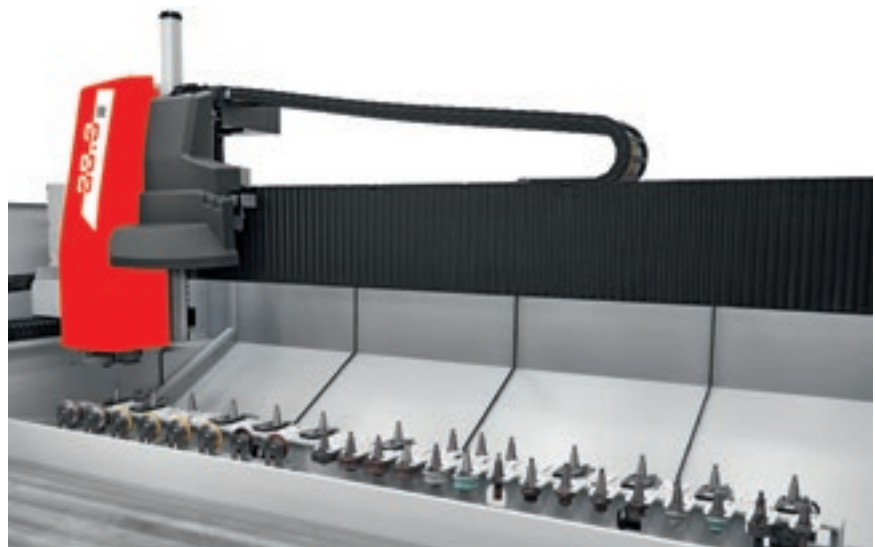

Rear dual row magazine.



8-position rotary magazine on the head, reducing the time taken to replace the most frequently used tools.



Magazine dedicated to tool change operations for aggregates, with magnetic change.

Maximum results thanks to the ability to equip the machine with high quality components.



The mechanical pre-setter checks the degree of wear on the diamond tools (with a frequency set by the machine operator) and automatically updates the tool parameters in the machine control, thereby guaranteeing constant machining results over time and preventing potential operator error.

The dressing devices are positioned near the working area for fast, easy tool dressing operations that guarantee constant top quality and speedy execution. The dressers make the Master fully automatic, even for the longest machining operations, which means that manual operations are also simplified.



Drill dressing

The dressing device is placed near the working area for the immediate dressing of tools, to guarantee the best quality and quickest execution all the time.

REDUCED TOOLING AND SET-UP TIMES



The laser projector is used to make the preparation of the working area quick and easy, reproducing the position of all the suction cups and pieces to be machined on the table and preventing head movements.



The cross-hairs laser guides the operator through the positioning of suction cups and stops, speeding up the preparation of the work surface.



3-axis head mechanical thickness tracer.

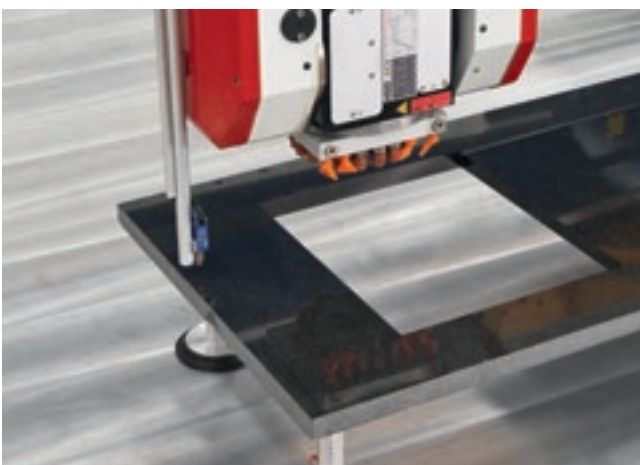
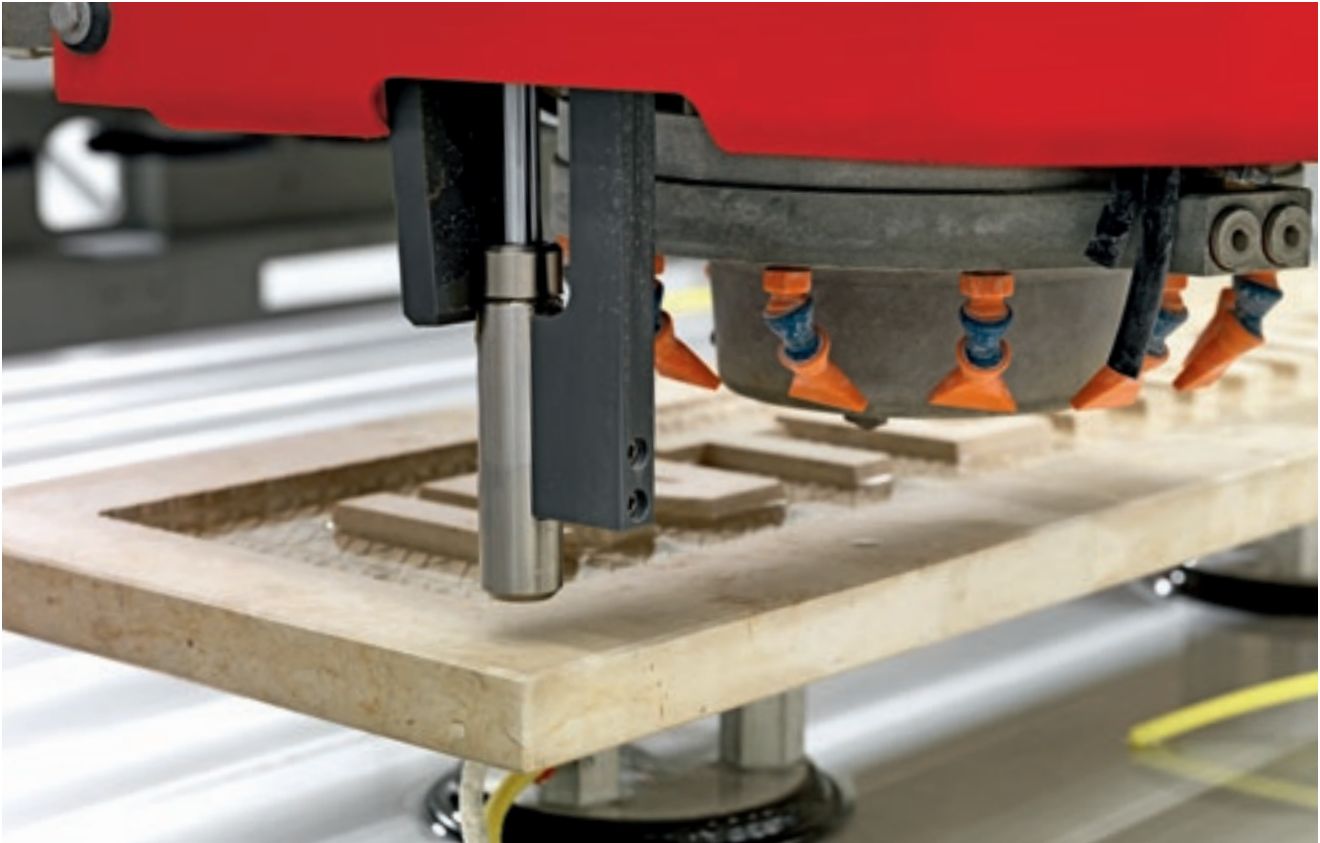

The variable Z thickness tracer is capable of preserving constant quality when writing on, grinding, milling and scoring pieces of irregular thickness.

EASE OF USE

Extremely easy to use, thanks to the ergonomic console and user-friendly operator interface.

The use of a PC with Windows guarantees a particularly easy, user-friendly approach for the operator and allows for CAD-CAM programming directly beside the machine.

Console with mobile arm for improved organisation and management of work.

The operator interface in Windows enables operators to:

- easily set the work list to optimise production
- rapidly handle the work origins and tool parameters
- view the execution time for each piece



Optimum convenience in the operations thanks to a hand-held terminal with:

- Quick, simple positioning of the stops and suction cups thanks to the option of tooling the work table with doors open
- Simplified tool preparation, thanks to the optimum control of the working head directly on the piece to be machined
- No limits between operator and Master
- Machining speed control
- Emergency button always near the operator's hand
- Start buttons for the two machining stations
- Machining pause and restart button

PROTECTION AND SAFETY FOR ALL MACHINING OPERATIONS

Intermac has always paid the utmost attention to the health and safety of its customers. The protection of every operator during the use of the machine is of vital importance, preventing any possible distraction or error that could lead to inconvenience or even accidents.



One indispensable condition for obtaining any sort of financing is the respect of the machinery directives and workplace health and safety regulations.

With Master working centres, the operator is protected by:

- Active safety features in the front protection devices and rotation magazine.
- Ergonomic front guards of a suitable height that are also explosion-proof (certified by external bodies with "detonation" tests).
- Side and rear guards made of a metallic material subjected to special anti-corrosion painting cycles.
- Electric and pneumatic systems fully integrated in the machine and protected by closed doors.
- Inaccessibility of moving machine parts.
- A clean working environment (water and machining residues are not dispersed).
- Reduced noise levels, fully complying with the machinery directive.

The Master series is equipped with ergonomic protection devices that enable better visibility of the machining operation during the process.

MAXIMISED PRODUCTIVITY

MASTER WITH INNOVATIVE MTS SYSTEM - MATRIX TELESCOPIC SYSTEM

The MTS system can process various types of glass sheets of different shapes and sizes as part of a Batch One production process, with no need to worry about changing the positioning of the suction cups in the machine each time, thus enabling different sheets to be machined in succession.

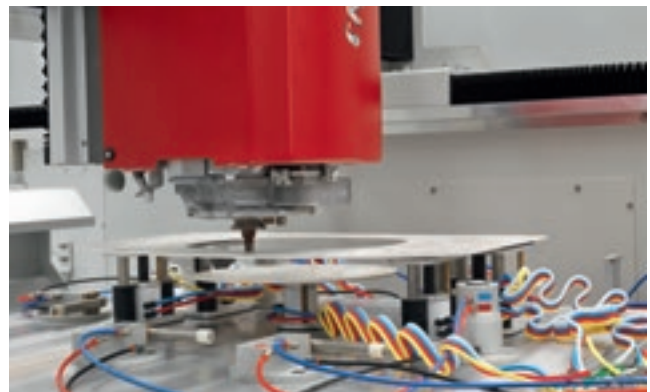

ADAPTS TO THE WHOLE MASTER LINE*

With MTS, the work table can be configured with up to 40 suction cups of differing sizes and shapes. MTS systems are automatically managed by the PLC machine software, and can be programmed using the specific CAM functionalities developed by InterMac.

There are 3 possible configurations:

- ▣ 20 telescopic suction cups (basic configuration)
- ▣ 30 telescopic suction cups (optional)
- ▣ 40 telescopic suction cups (optional)

Both telescopic and standard suction cups can be fitted on the work table simultaneously.

*except Plus versions

FACILITATED OPERATIONS

Smart scheduling



CENTRING SYSTEM WITH AUTOMATIC SETTING

The CAM functions developed make it easier for the operator to position the piece in relation to the telescopic suction cup matrix, using different colours to indicate the suction cup status.

- ▣ suction cup active (green ●)
- ▣ suction cup active for waste (purple ●)
- ▣ suction cup disabled (grey ●)

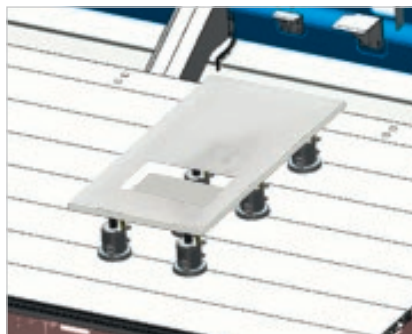

WASTE MANAGEMENT

During the machining operation, the waste material is managed automatically. This means the next machining task can be started without the operator's intervention as the waste is automatically unloaded.

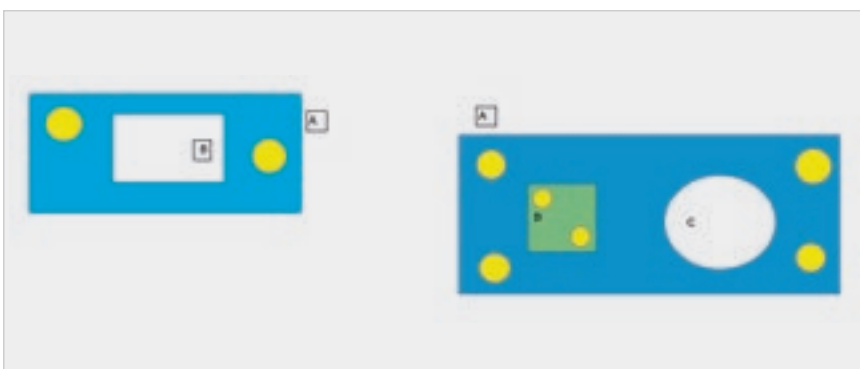

PIECE - TRACKER

The piece-tracker system identifies piece rototranslation automatically. The stops are not therefore needed, and the telescopic suction cup matrix is used to centre the piece to be machined.

THE HORIZONTAL EVOLUTION

The benefits of Master solutions

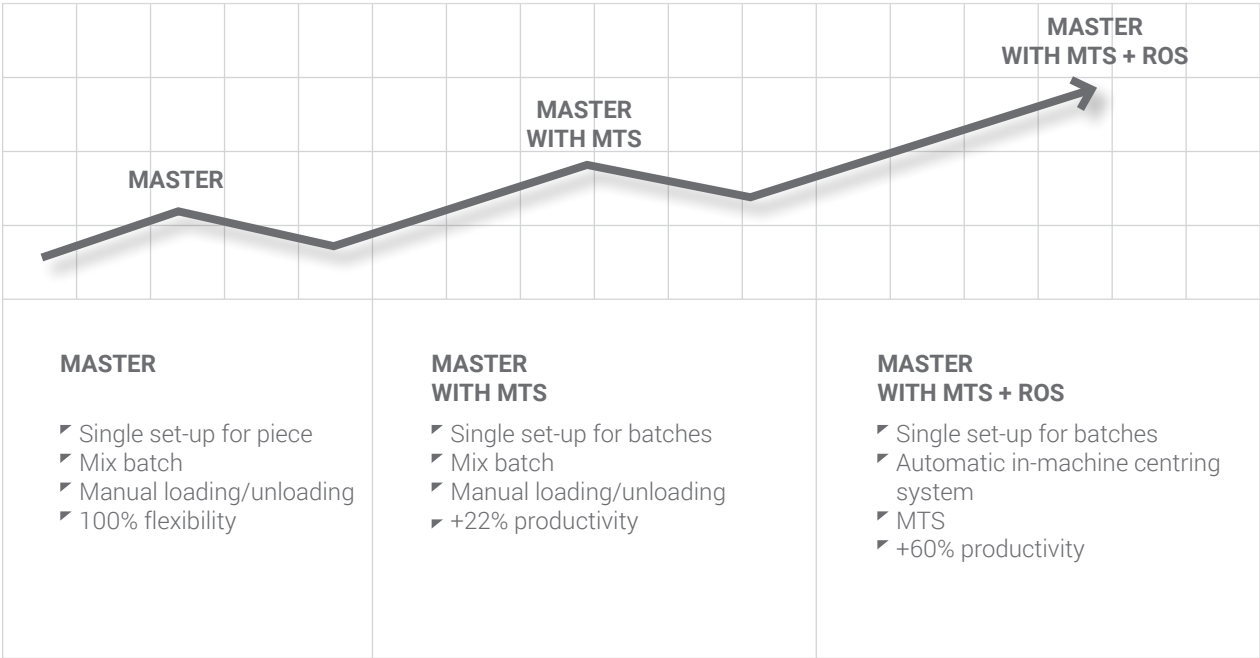

INDUSTRY 4.0 READY

Industry 4.0 is the latest industry frontier, based on digital technologies and machines that speak to the companies. The products can be interconnected with the production processes via smart networks.



Intermac's commitment is to transform our customers' factories with real-time technology, ready to guarantee digital manufacturing opportunities, with smart machines and software packages becoming vital tools that facilitate the daily tasks of people all over the world who machine glass, stone, metal and more. Our philosophy is a practical one: to supply entrepreneurs with solid data that can help them to lower their costs, optimise their processes and improve their results.

And that means being 4.0 ready.

TECHNICAL SPECIFICATIONS

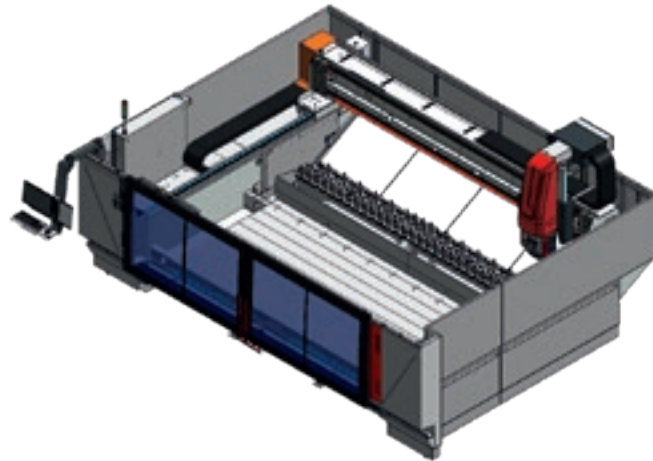

OVERALL DIMENSIONS

	33.x	38.x	45.x
Overall machine dimensions LxWxH MAX	3490x6250x2600	3895x6750x2600	4420x7455x2600
Overall machine dimensions LxWxH max equipped with side tool magazine	3490x6510x2600	3895x7010x2600	4420x7715x2600
Overall machine dimensions LxWxH max equipped with rear tool magazine single raw	3895x6250x2600	4945x6750x2600	5470x7455x2600
Overall machine dimensions LxWxH max equipped with rear tool magazine double raw	4525x6250x2600	4945x6750x2600	5470x7455x2600

OVERALL DIMENSIONS

	33.X PLUS	38.X PLUS	45.X PLUS
Overall machine dimensions LxWxH MAX	3490 x 6250 x 3175	3895 x 6750 x 3175	4420 x 7455 x 3175
Overall machine dimensions LxWxH max equipped with side tool magazine	3490 x 6510 x 3175	3895 x 7010 x 3175	4420 x 7715 x 3175
Overall machine dimensions LxWxH max equipped with rear tool magazine single raw	3895 x 6250 x 3175	4945 x 6750 x 3175	5470 x 7455 x 3175
Overall machine dimensions LxWxH max equipped with rear tool magazine double raw	4525 x 6250 x 3175	4945 x 6750 x 3175	5470 x 7455 x 3175

(L=length W=width H=height)

Overall dimensions are intended with closed doors, without considering the hanging control panel (front, side tool magazine, electrical control cabinet).
L + 1000 mm considering maximum dimension of hanging control panel.

The technical specifications and drawings are non-binding. Some photos may show machines equipped with optional features. Biesse Spa reserves the right to carry out modifications without prior notice.

Weighted sound pressure level A (LpA) during machining at the operator's workstation on the vane-pump machine Lpa=79dB(A) Lwa=96dB(A) Weighted sound-pressure level A (LpA) at the operator's workstation and sound power level (LwA) during machining on the cam-pump machine Lwa=83dB(A) Lwa=100dB(A) Measurement uncertainty K dB(A) 4.

The measurement was carried out in compliance with UNI EN 848-3:2007, UNI EN ISO 3746: 2009 (sound power) and UNI EN ISO 11202: 2009 (sound pressure levels at workstation) during panel machining. The noise levels shown are emission levels and do not necessarily correspond to safe operation levels. Despite the fact that there is a relationship between emission and exposure levels, this may not be used in a reliable manner to establish whether further measures need to be taken. The factors determining the exposure level for the workforce include length of exposure, work environment characteristics, other sources of dust and noise, etc. i.e. the number of other adjoining machines and processes. At any rate, the above information will enable the operator to better evaluate dangers and risks.

MASTER 3 AXIS - 3 AXIS PLUS

		Master 33.3 Master 33.3 Plus	Master 38.3 Master 38.3 Plus	Master 45.3 Master 45.3 Plus
Maximum workable piece (3 axis grinding with 100 mm tool diameter)	mm/inch	3.300 x 1.550 130 x 61	3.800 x 2.000 149 x 78	4.500 x 2.500 177 x 98
Z axis stroke	mm/inch	465 / 18	465 / 18	465 / 18
Z axis stroke plus version	mm/inch	650 / 25.5	650 / 25.5	650 / 25.5
C axis stroke (optional)	mm/inch	∞	∞	∞
T axis stroke (optional)	mm/inch	+/- 2,5°	+/- 2,5°	+/- 2,5°
Maximum axis speed (X, Y, Z)	m/min ft/min	60, 70, 18 196, 229, 59	60, 70, 18 196, 229, 59	60, 70, 18 196, 229, 59
Working table height (high version)	mm/inch	535 (740) / 20 (29)	535 (740) / 20 (29)	535 (740) / 20 (29)
Electrospindle power in S1 (S6)	kW	15 (18)	15 (18)	15 (18)
Maximum electrospindle rotation	rpm	12000	12000	12000
Tool attachment		ISO 40	ISO 40	ISO 40
Tool magazine (optional)	N.	45	53	61
Required power	kW / HP	22,5 / 30	22,5 / 30	22,5 / 30
Weight	Kg / Pound	5800 / 12.800	6800 / 15.000	8600 / 19.000
Shipment via land		Full truck (44,6 ft)	Full truck (44,6 ft)	Special without escort
Shipment via sea		Container 40" OT	Container 40" OT	Wooden case

MASTER 5 AXIS - 5 AXIS PLUS

		Master 33.5 Master 33.5 Plus	Master 38.5 Master 38.5 Plus	Master 45.5 Master 45.5 Plus
Maximum workable piece (3 axis grinding with 100 mm tool diameter)	mm/inch	3.300 x 1.550 130 x 61	3.800 x 2.000 149 x 78	4.500 x 2.500 177 x 98
Z axis stroke	mm/inch	465 / 18	465 / 18	465 / 18
Z axis stroke plus version	mm/inch	650 / 25.5	650 / 25.5	650 / 25.5
C axis stroke (optional)	mm/inch	∞	∞	∞
T axis stroke (optional)	mm/inch	+/- 90°	+/- 90°	+/- 90°
Maximum axis speed (X, Y, Z)	m/min ft/min	60, 70, 18 196, 229, 59	60, 70, 18 196, 229, 59	60, 70, 18 196, 229, 59
Working table height (high version)	mm/inch	535 (740) / 20 (29)	535 (740) / 20 (29)	535 (740) / 20 (29)
Electrospindle power in S1 (S6)	kW	15 (18)	15 (18)	15 (18)
Maximum electrospindle rotation	rpm	12000	12000	12000
Tool attachment		ISO 40	ISO 40	ISO 40
Tool magazine (optional)	N.	45	53	61
Required power	kW / HP	25 / 30	25 / 30	25 / 30
Weight	Kg / Pound	5800 / 12.800	6800 / 15.000	8600 / 19.000
Shipment via land		Full truck (44,6 ft)	Full truck (44,6 ft)	Special without escort
Shipment via sea		Container 40" OT	Container 40" OT	Wooden case

EASYSTONE: ALL FUNCTIONS JUST A CLICK AWAY

EASYSTONE IS CAD/CAM SOFTWARE SPECIALISED FOR THE MACHINING OF MARBLE, GRANITE, STONE AND SYNTHETIC MATERIALS USING CNC MACHINING CENTRES. IT IS USED WIDELY IN THE SECTOR AND ALLOWS FOR THE EXECUTION OF THE MOST COMMON MACHINING OPERATIONS FOR STONE. THE SOFTWARE IS COMPATIBLE WITH PREVIOUSLY INSTALLED EASYSTONE PACKAGES AND ALLOWS FOR FLEXIBLE CONFIGURATION ON THE BASIS OF THE CUSTOMER'S NEEDS.

▸ **Simple and intuitive**

It can even be used by individuals who don't have specialised computer skills: all functions are "just a click away".

▸ **Complete**

Manages every aspect of CNC machining at 360°, guiding the operator from the design to the distribution of the pieces on the work table, to collision control with 3D simulations, to the optimisation of the machining operation workflow for the tools, to the generation of the machine programs.

▸ **Automated**

The pieces to be created can be designed rapidly thanks to a library of parametric components. The automatic CAM module can pair the machining operations with the pieces automatically.

▸ **Ideal for every type of machining operation**

Allows for the programming of all the typical machining operations used on stone: shaping and polishing edges, kitchen tops, bathroom unit tops, engraving, bas relief, shower trays, shaping and finishing solid pieces, polishing surfaces for 5-axis machining operations, using all types of tools.

EASY STONE

DESIGNED TO ALLOW THE EASY PROGRAMMING OF MACHINING OPERATIONS FOR STONE TO BE EXECUTED BY CNC MACHINING CENTRES, BRINGS OUT THE POTENTIAL OF THE MASTER RANGE.



EASYSTONE: INTUITIVE AND IMMEDIATELY ACCESSIBLE INCLUDING BY LESS EXPERIENCED USERS

EASYSTONE MASTER - 3 AXIS

- ✔ Create and import 2D and 3D designs in the most widely used standard formats (.dxf, .stl, .iges).
- ✔ Program 2D machining operations for sheets: boring, milling, edgebanding, engraving, recessing, tracing.
- ✔ Program 3-axis machining operations for the emptying and finishing of solid pieces (shower trays, sinks, tubs, vases).
- ✔ Option of importing images in standard formats (.jpg, .bmp) and converting them into surfaces for the programming of bas relief and high relief machining operations.
- ✔ Simulates the removal of material.

EASYSTONE MASTER - 5 AXIS

Besides the EasySTONE Master 3-Axis functions, allows for the programming of 5-axis machining operations (bevels, capitals, statues).

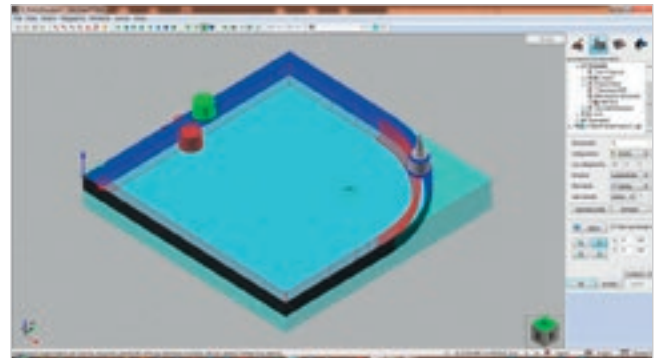
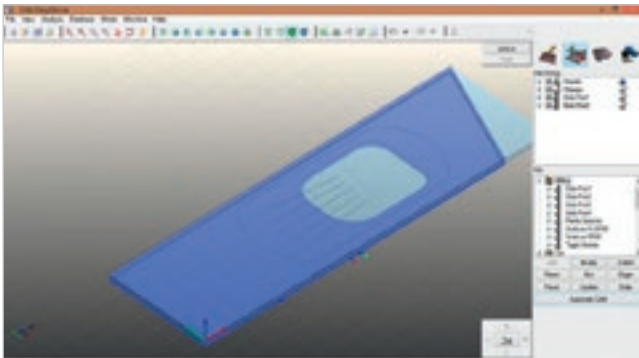

EASY STONE

OPTIONAL PACKAGES

- **Automatic CAM:** automatic pairing of machining operations with the pieces on the basis of rules defined by the user for design properties such as layer type of geometry.
- **Office station, multi-centre and network key:** option of generating different types of programs for the office and the Master from a single station beside the machine and of sharing the EasySTONE licence with up to 10 stations connected to the network.
- **Machining operations from below:** option of programming cutting and boring operations from below.

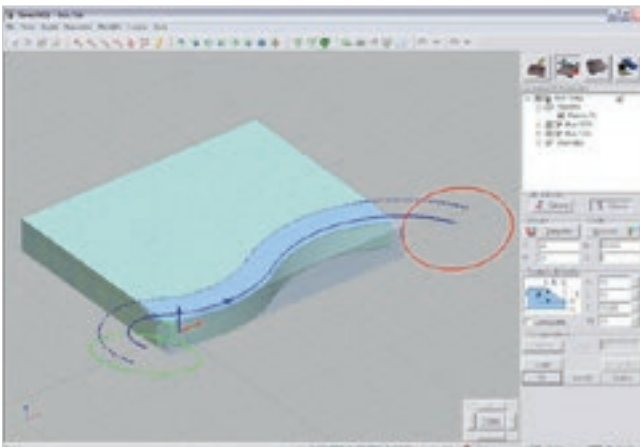
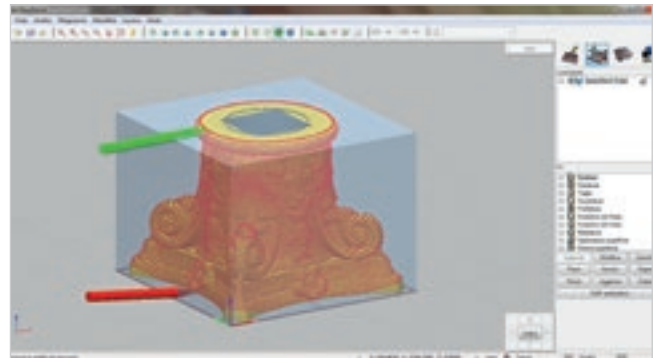
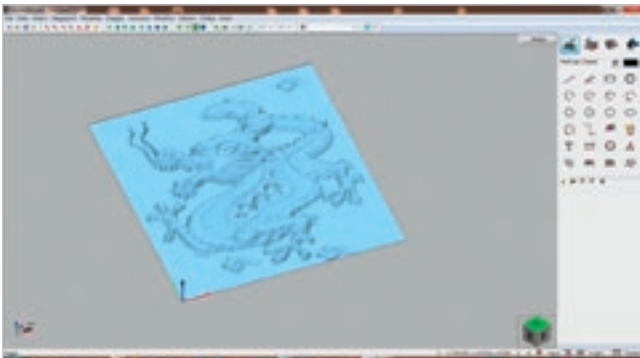

THE MOST SIMPLE ANSWER

WITH OVER 6,500 PACKAGES INSTALLED, ICAM GUARANTEES THE ELEVATED COMPETENCE OF THE GLOBAL SERVICE. COMPATIBLE WITH THE INTERMAC MACHINES ALREADY INSTALLED.



ICAM

THE MASTER CAN ALSO BE EQUIPPED WITH ICAM SOFTWARE, WHICH IS EXTREMELY RELIABLE AND EASY TO USE.

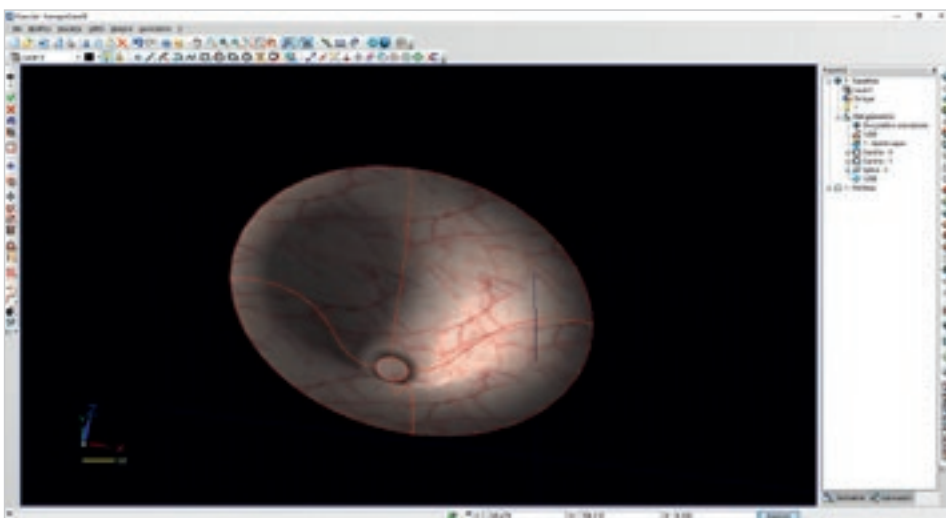
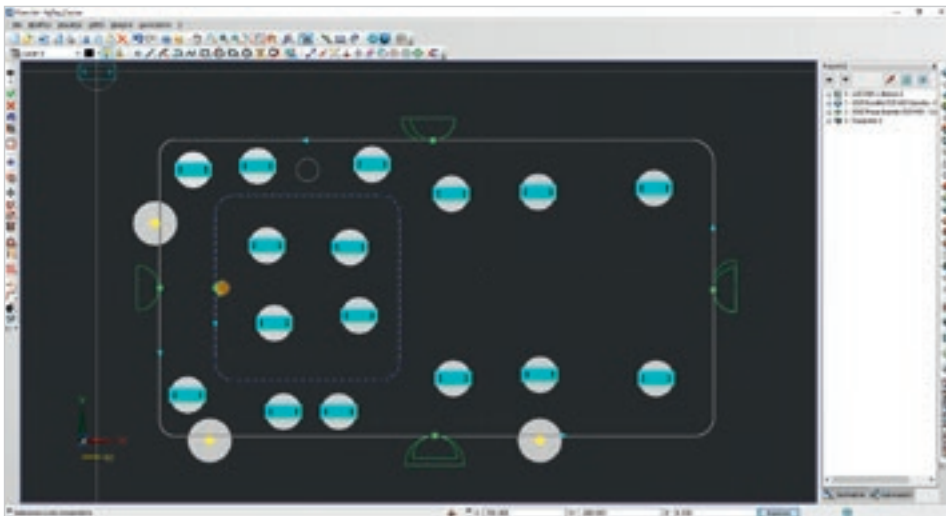

CUSTOMER CARE IS WHO WE ARE

SERVICES is a new experience for our customers, to offer not just excellent technology but the added value of an increasingly direct connection with the company, the professionals who work there and the experience they embody.



ADVANCED DIAGNOSTICS

Digital channels for remote interaction online 24/7. Always ready to intervene on-site seven days a week.



A WORLDWIDE NETWORK

39 branch offices, over 300 certified agents, retailers in 120 countries, and spare parts warehouses in America, Europe and the Far East.



SPARE PARTS AVAILABLE IMMEDIATELY

Identification, shipping and delivery of spare parts for every need.



EVOLVED TRAINING OPPORTUNITIES

Lots of on-site, online and classroom training modules for personalised growth.



VALUABLE SERVICES

A wide range of services and software packages to help our customers achieve continuous improvements in performance.

AN EXCELLENT LEVEL OF SERVICE

+550

HIGHLY SPECIALISED
TECHNICIANS AROUND
THE WORLD, READY TO HELP
CUSTOMERS WITH EVERY
NEED

90%

OF MACHINE DOWN CASES
WITH RESPONSE TIME
UNDER 1 HOUR

+100

EXPERTS IN DIRECT
CONTACT THROUGH
REMOTE CONNECTIONS
AND TELESERVICE

92%

OF SPARE PARTS ORDERS
FOR MACHINE DOWNTIME
PROCESSED WITHIN 24
HOURS

+50.000

ITEMS IN STOCK IN THE
SPARE PARTS WAREHOUSES

+5.000

PREVENTIVE MAINTENANCE
VISITS

80%

OF SUPPORT REQUESTS
SOLVED ONLINE

96%

OF SPARE PARTS ORDERS
DELIVERED IN FULL ON TIME

88%

OF CASES SOLVED WITH
THE FIRST ON-SITE VISIT

SOPHIA

GREATER VALUE FROM MACHINES

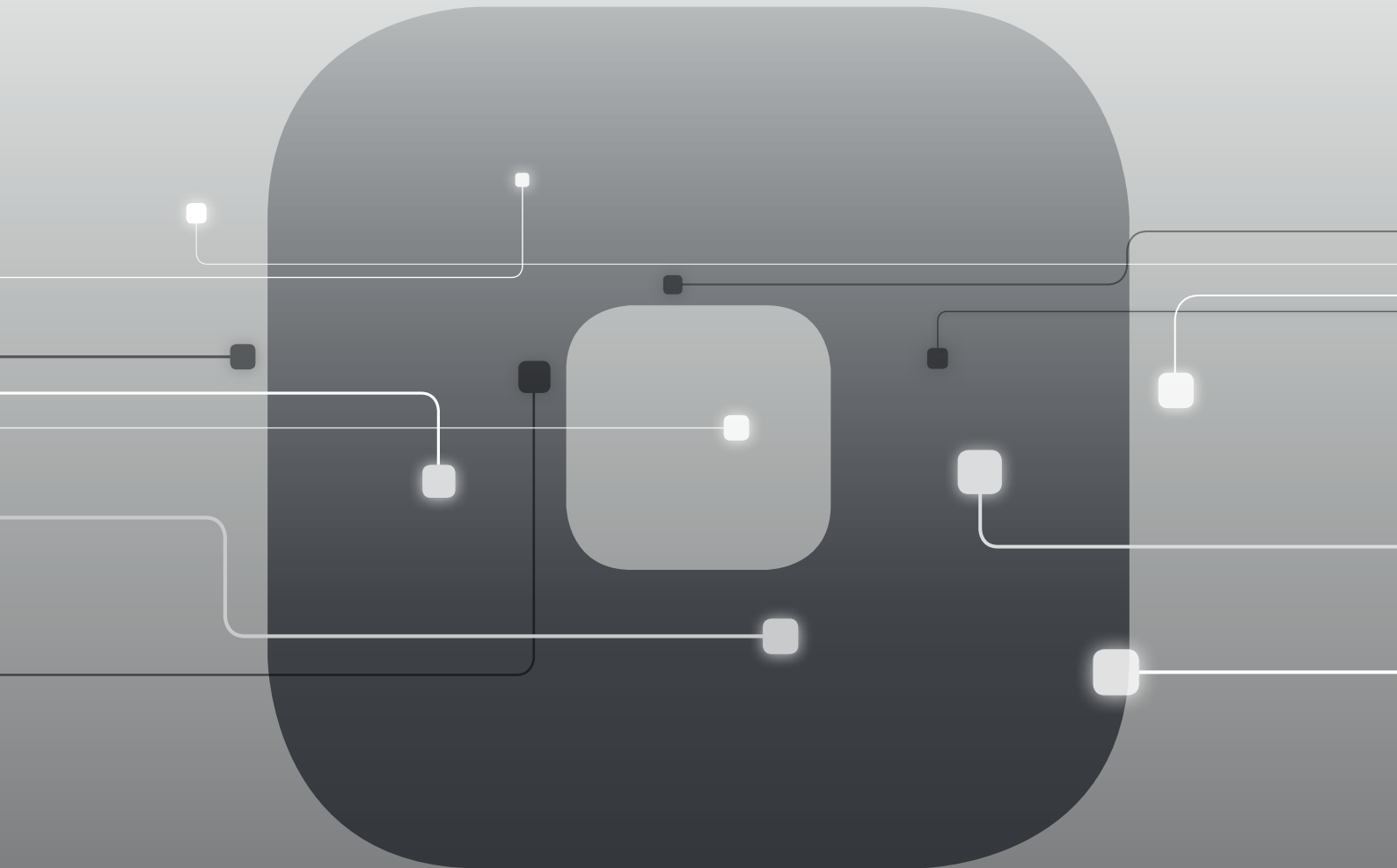

SOPHIA is the IoT platform created by Biesse in collaboration with Accenture which enables its customers to access a wide range of services to streamline and rationalise their work management processes.

It allows alerts and indicators to be sent to the customer in real time, in relation to production, the machines used and the type of process carried out. These are detailed instructions for more efficient use of the machine.

10% CUT IN COSTS

50% REDUCTION
IN MACHINE DOWNTIME

10% INCREASE
IN PRODUCTIVITY

80% REDUCTION IN PROBLEM
DIAGNOSTICS TIME

SOPHIA TAKES THE INTERACTION BETWEEN
CUSTOMER AND SERVICE TO A HIGHER LEVEL.

iOT
SOPHIA

IoT - SOPHIA provides a comprehensive overview of the specific machine performance features, with remote diagnostics, machine stoppage analysis and fault prevention. The service includes a continuous connection with the control centre, the option of calling for assistance from within the customer app (such calls are managed as priorities), and an inspection visit for diagnostic and performance testing within the warranty period. Through SOPHIA, the customer receives priority technical assistance.

PARTS
SOPHIA

PARTS SOPHIA is the easy new, user-friendly and personalised tool for ordering Biesse spare parts. The portal offers customers, dealers and branches the chance to navigate within a personalised account, consult the constantly updated documentation of the machines purchased, and create a spare parts purchase basket indicating the real time availability in the warehouse and the relative price list. In addition, the progress of the order can be monitored at all times.

 **Biesse**

MADE WITH BIESSE

NATURE CALLS, INTERMAC ANSWERS

Generelli SA, a company from Ticino with headquarters in Rivera, Switzerland, has been converting natural stone into superb manufactured products for over forty years. At Generelli the most advanced stone processing techniques are constantly paired with the skilful artisan craftsmanship fostered in Ticino. With this mission the Swiss company, which was founded in **1974** and directed by founder **Generelli Guido** before his son **Moreno** took the helm, has now reached the third generation with **Matteo**. Natural stone, quartz compounds, plastic materials and ceramic are the daily bread of creativity and are converted into art, "from a simple granite windowsill to more complex 3D machining," says Moreno as he explains how slabs of stone become "everyday" objects: not just surfaces for kitchens and bathrooms, but also stairs, floors,

fireplaces and swimming pools, destined to enrich and highlight living spaces all over the world.

"Thanks to Intermac technology we can achieve complex shapes, and increase productivity and autonomous work." Nothing is outsourced: Generelli carries out every single step internally, to guarantee the highest quality. "Today technology is an integral and irreplaceable part of our company: we wouldn't be where we are today without it" Matteo confirmed. If that technology comes from Italy, which is where Moreno believes the best companies are still to be found, all the better. For production, in fact, the crown goes to the **Master 33** and the **Primus 5-axis** waterjet by Intermac, a company whose history of collaboration with Generelli dates all the way back to 1996. And it's the Primus, one of the newest additions in

production, that has helped the company surpass previous limits, as Matteo explains: "With it we are capable of producing shapes of various sizes, with very precise cuts, and can create double-curved 3D inlays, increasing productivity and autonomous work". Equipped with the latest generation of tools, "with technical features that are more evolved compared to the past", these mechanical powerhouses were designed for power and precision and anticipate a time in the future when, as envisioned by Matteo, "technology will increasingly be present throughout production and will play a greater role in designing and programming thanks to increasing levels of intelligence and autonomy. But all this can only be achieved if the companies that use these machines are able to evolve with the machines".



Founded in Italy,
international native.

We are an international company that manufactures integrated lines and machines to process wood, glass, stone, plastic and composite materials and what will come next.

Thanks to our rooted competence nurtured by an ever-growing worldwide network, we support your business evolution – empowering your imagination.

Master of materials, since 1969.

We simplify your
manufacturing
process to make
the potential of
any material
shine.



Join the
Biesse world.

[biesse.com](https://www.biesse.com)



