

DIECI
AUSTRALIA

APOLLO  26.6





ZERO EMISSIONS

LOW NOISE

OPTIMISED EFFICIENCY

APOLLO 26.6

ZERO EMISSIONS. FULL PERFORMANCE.

The Apollo-e 26.6 delivers the core strengths Dieci is known for - technology, reliability, and durability; now in a fully electric, low-noise, zero emissions package.

Engineered through continuous innovation, customer insight, and real-world application, Dieci telehandlers are built to perform across Australia's toughest and most varied environments.

Compact in size but big on capability, the Apollo-e 26.6 is purpose-built for restricted and hard-to-access areas. Its robust boom design provides impressive lifting performance, allowing you to handle loads confidently at height without compromising stability.

Smooth, precise controls and responsive handling make operation effortless, while the zero-emissions electric drive-train opens up job sites where diesel machines can't go - including indoor, enclosed, and compliance-restricted environments.

With three steering modes - 2WS, 4WS, crab steer, and an intuitive control layout; the Apollo-e 26.6 offers exceptional manoeuvrability and ease of use on any job site.

Compatible with a full range of attachments, the Apollo-e 26.6 is a highly versatile, zero-emissions solution ready to adapt to your application.

QUIET COMFORT: ITALIAN DESIGN AND STYLE



Dieci telehandlers have always been a combination of **comfort** and **functionality** which makes them stand out all over the world.

Electric Advantages

- Reduced running costs - reduced fuel & engine maintenance costs
- Zero emissions – ideal for indoor and environmentally sensitive worksites
- Low maintenance – fewer moving parts compared to diesel machines
- Reduced noise – safer and more comfortable for operators
- No compromise on lifting power or operational capability

Charging and Power

The Apollo-e 26.6 is equipped with multiple charging options for maximum convenience on Australian worksites:

- Mode 3 Type 2 socket (charging stations) 
- 240V industrial socket 
- 415V 3-phase socket 

All charging points are positioned for easy access and can be used with the bonnet closed, improving safety and protecting against tampering.

The machine is also compatible with external fast chargers, enabling rapid recharge when required.

Flexible Battery System

With a modular battery system, the Apollo-e 26.6 can be configured to match your job requirements. Scale your battery capacity for longer runtime or lighter operation - giving you the flexibility to work smarter and stay productive longer.

- Configurable battery setup – choose 1 or 2 batteries depending on workload
- Expandable system – upgrade battery capacity at any time, including after purchase
- Lithium (LiFePO4) battery technology
- ECE R100 approved batteries

This modular approach provides maximum flexibility while optimising upfront investment and long-term operating efficiency.



Apollo 26.6

FULL ELECTRIC



5.73m
Max Lift Height

2,600kg
Max Capacity

25hp / 19kW
Traction Motor Rated Power

30hp / 22kW
Hydraulic Motor Rated Power

Modular Battery System

The twin battery setup at 456Ah offers a full days work on a single charge. Extra spare batteries are available, and changes are quick & easy. Also compatible with after-market battery options.

Smart Charging System

The on-board charging system is compatible with a variety of voltages and power sources including Mode 3 Type 2, 240V industrial socket and 415V 3-phase socket.

62L Hydraulic Flow Rate

The dedicated electric hydraulic motor achieves a 62lpm hydraulic flow rate that maximises manoeuvrability and lifting power in all applications, offering full power independent of the engines RPM.

Fully Electric Transmission

The drive pedal only controls the machines speed, and thus the boom acts completely independent from the drive motors RPM, resulting maximum power and no need for an inching pedal.

One Joystick. Total Control

Operate all boom functions with a single, easy-to-use joystick. Smooth, proportional controls allow multiple movements at once, while integrated FNR makes direction changes fast and effortless.

Reinforced Chassis

Manufactured completely in-house by Dieci, the chassis has been reinforced with thicker side steel members and side-boom guides resulting in high torsional rigidity and stability.



TECHNICAL DATA

PERFORMANCE

Maximum capacity	2,600 kg	Towing force	4,100 daN
Maximum lifting height	5.73 m	Maximum climb angle	40 %
Maximum horizontal extension	3.3 m	Unladen weight	5,100 kg
Fork swiveling angle	129 °	Maximum speed	24 km/h
Pull-out force	5,510 daN		

ELECTRIC MOTORS

Traction motor type	Asynchronous	Hydraulic motor type	Reluctance synchronous
Traction motor nominal voltage	96 V	Hydraulic motor nominal voltage	96 V
Traction motor cooling	Air	Hydraulic motor cooling	Air
Traction motor rated power	19 kW (25 HP)	Hydraulic motor rated power	22 kW (30 HP)
Traction motor peak power	56 kW (75 HP)	Hydraulic motor peak power	27 kW (36 HP)

BATTERY

Battery type	Lithium Ion	On-board charger power (240V)	3.3 kW
Battery chemistry	LiFePo4	On-board charger power (415V)	6.6 kW
Battery nominal voltage	96 V	Optional external charger power	18 kW
Standard battery capacity	228 Ah	Battery capacity with optional second battery	456 Ah
Standard battery charge time (240V)	5.3h	Charge time w/ optional second battery (240V)	11h
Standard battery charge time (415V)	2.7h	Charge time w/ optional second battery (415V)	3.5h
Standard battery charge time w/ optional external charger (415V)	1h	Charge time w/ optional second battery and optional external charger (415V)	2h

On-board charger compatibility

110V-240V-415V-IEC 61851 mode 2 and 3 with socket type 2

TRANSMISSION

Type	Single speed electric
Drive mode	Eco / Normal / Power

HYDRAULIC SYSTEM

Hydraulic pump type	Gear pump low noise for power steering and movements
Hydraulic pump capacity	62 l/min
Maximum operating pressure	23 MPa (3,336 psi)
Boom hydraulic sockets	With quick couplings
Distributor control	Electrically operated proportional 4in1 joystick
Distributor type	Single-lever proportional hydraulic with simultaneous controls and ALS system
Hydraulic tank capacity	60 l

DIFFERENTIAL AXLES

Steering axles	2 steering, with 4 epicycloidal reduction gears
Type of steering	4 wheels / transversal / 2 wheels
Service brake	Oil bath on front axle
Park brake	Negative actuation with electrical control

TYRES

Size	12.0/75-18
------	------------

APOLLO-e 26.6

DIMENSIONS

A	300 mm
B	985 mm
C	2,350 mm
D	760 mm
F	3,585 mm
G	4,100 mm
H	1,980 mm
I	860 mm
L	1,500 mm
M	1,860 mm
P	1,290 mm
Q	3,400 mm
S	1,485 mm

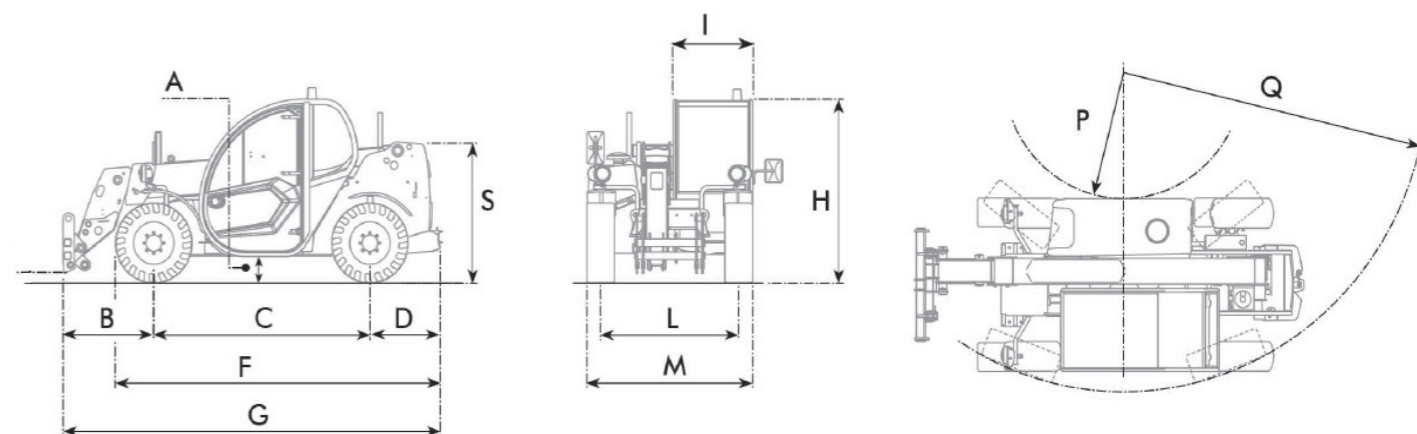

LOAD CHART

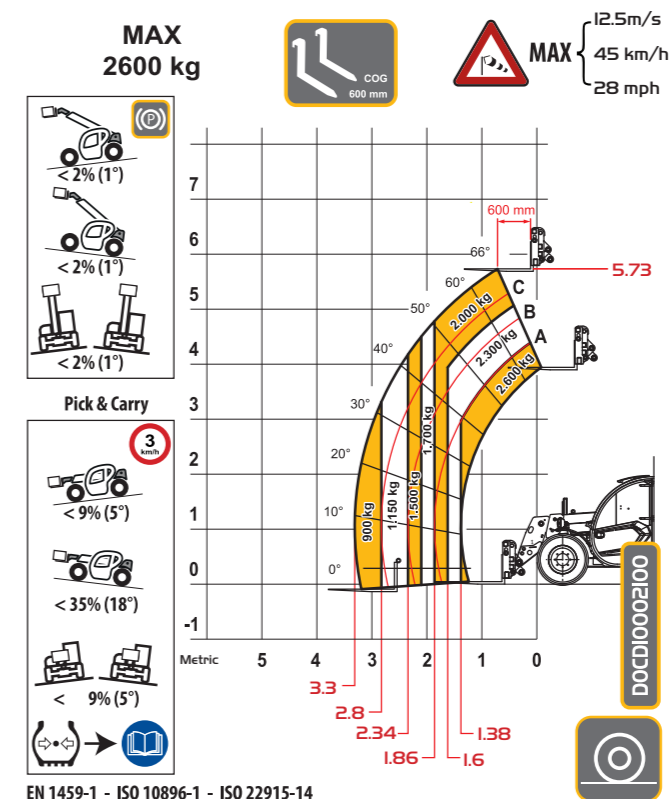

APOLLO-e 26.6



NEW SOUTH WALES

Sydney Branch

1/5 Melito Court,
Prestons, NSW 2170

WESTERN AUSTRALIA

Perth Branch

32 Allott Way,
Maddington, WA 6109

VICTORIA

Melbourne Branch

169 Studley Court,
Derrimut, VIC 3026

QUEENSLAND

Brisbane Branch

1/7 Australand Drive,
Berrinba, QLD 4117

Brisbane North Branch

69 Griffin Crescent,
Brendale, QLD 4500



www.dieciaustralia.com.au | ph: 1300 888 479 | sales@dieciaustralia.com.au

Distributed by Dieci Australia

Illustrations and photos show the standard international models and may or may not include optional equipment, accessories, customer installed or modified parts, optional parts and all standard equipment with some differences in colour and features. Machine specifications are subject to change without notice and additional load charts and machine or attachment specifications may be available on request. Please refer to the user and maintenance manuals located on Dieci Australia's website for correct machine and attachment operation.