



## Tray og Wrap-around Packer

Combined packing of products.

The Tray and Wrap-Around packer is both the result of and the process involved in the work performed by this machine. It moulds packaging material around bottles, cans, cartons, bags and similar products. These can be packed together to give the advantage of a combined wrap-around carton or tray and, if required, subsequently shrink-wrapped. The design of the individual machine depends on the customer's needs, as the system comprises standard modules which can be combined as required.

## Technical data

<b>Model</b>	R057	
<b>Products</b>	Bottles, cans, cartons, bags and similar.	
<b>Capacity</b>	Wrap-around: 15 pcs/min. ,Trays: 20 pcs/min. Depends on product and pack pattern.	
<b>Size range, min/max</b>	<b>Wrap-around:</b> L: 220-600 mm B: 110-400 mm D: 80-300 mm	<b>Trays:</b> L: 220-600 mm B: 110-400 mm D: 30-150 mm

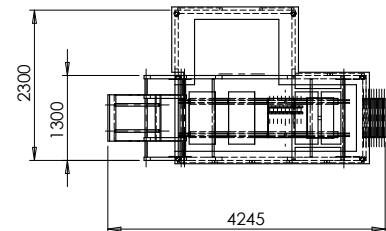
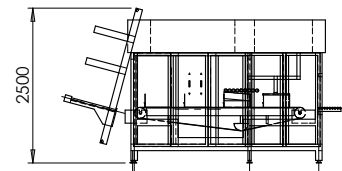
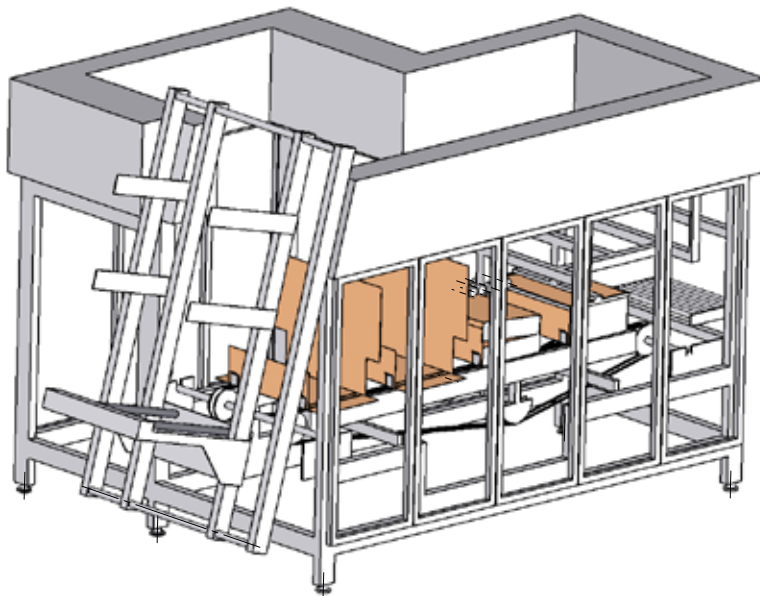

**NB:** We reserve the right to make alterations to technical specifications without prior notice.

## Feeding modules

- Multiline:** Distributes a product flow of round products from one to several rows, after which a special gate and relief system create the required packaging patterns.
- Singleline:** Groups required packaging patterns from a product flow in a single row. Can pack both round and square products.
- Pick & Place unit:** Makes it possible - in connection with single-line feeding - to group products and put them into packages with the help of a pick & place unit.
- Erecting wheel device:** Erects cartons so they are turned on their sides, and also groups them in the required packaging patterns.
- Lifting system:** Stacks cartons, cans, etc., in two or more layers.
- Special systems:** Developed in accordance with current requirements with regard to packaging patterns and capacities.

