

# Kelba Shear Beam Load Cell (500-5000 Kg)

## KPA 6245A

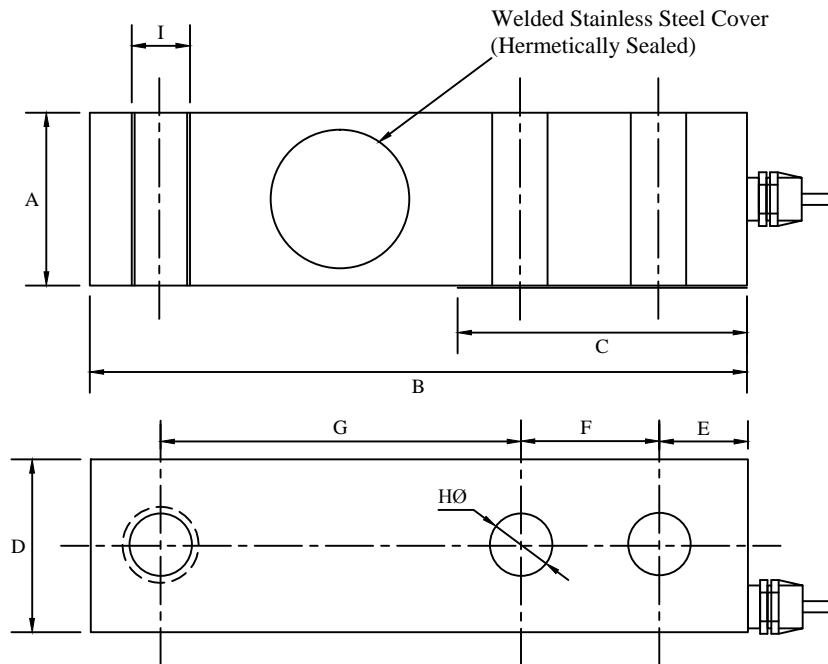

Size: mm

Model	Capacity	A	B	C	D	E	F	G	H	I (THREAD)
KPA 6245 - 500	500 Kg									
KPA 6245 - 1000	1000 Kg									
KPA 6245 - 1500	1500 Kg	30	130	57	30.6	16	25.4	73.2	13	M12
KPA 6245 - 2000	2000 Kg									
KPA 6245 - 3000	3000 Kg	36.5	136.5	58	37	16	25.4	76.2	13	20.5 dia
KPA 6245 - 5000	5000 Kg	42.3	174.5	70.6	43	16	38	95.2	19	20.5 dia

### General Specifications:

Standard Capacity: 500, 1000, 1500, 2000, 3000, 5000 Kg

Material: Stainless Steel

### Electrical:

Cable Length: 6 Meters  
 Rated Output: 2.00 mV/V± 0.1%  
 Accuracy class: 0.03  
 Non-linearity: 0.03% F.S  
 Hysteresis: 0.02% F.S  
 Non-repeatability: 0.03% F.S  
 Creep in 30 minutes: 0.03% F.S  
 Temperature effect span: 15PPM/ °C of Applied Load  
 Temperature effect zero: 26 PPM/ °C of Applied Load  
 Compensated temperature range: -10 °C ~40°C  
 Operating temperature range: -40°C ~65°C  
 zero balance: ± 1% F.S  
 Input resistance: 385 ± 15 ohms  
 Output resistance: 350 ± 3 ohms  
 Safe overload: 150% F.S  
 Ultimate overload: 300% F.S  
 Excitation Voltage: 10V AC/DC  
 Max Excitation Voltage: 15V AC/DC  
 Insulation resistance: ≥ 5000M ohms (50V DC)  
 Environmental Protection: IP67

### Wiring colour code:

Excitation + Red  
 Excitation - Black  
 Signal + Green  
 Signal - White

### Kelba ( Australia ) Pty Ltd

Reference	KPA 6245A Shear Beam Load Cell 500 - 5000 Kg			
Date	8/07/08			
Drawn By	J. Dagang			
Approved		Drg No.	KPA - 6245A-1	Rev 2
Scale	NTS			Date 28/07/08