

UNITED

Forklift and
Access Solutions



CSERIES

Powered Pallet Trucks

1.2 - 2.5 Tonne



UNITED It's all about you

WE'VE UNITED ALL YOUR WAREHOUSE LIFTING NEEDS

Introducing the **C-Series** range of **Powered Pallet Trucks** from United.

These innovative and affordable pallet trucks are highly suited for both light and heavy use lifting in the warehouse. Quality built and smartly designed, they include a range of ergonomic and safety features designed for the operator in mind. With a nimble chassis and competitive power features capable of lasting a long shift, the C-Series pallet trucks will improve productivity and boost efficiency in your business.

Discover for yourself, why at United it's all about you.



C-SERIES
Powered Pallet Trucks

A-SERIES
Walkie Stackers

T-SERIES
Walkie Reach Stackers

C SERIES

Powered Pallet Trucks



NPP12E
Pedestrian Pallet Truck - 1.2T

Pg 4



NPP15E
Pedestrian Pallet Truck - 1.5T

Pg 6



NPP18E
Pedestrian Pallet Truck - 1.8T

Pg 8



NPP20 / 25EA
Pedestrian Pallet Truck - 2-2.5T

Pg 10

NPP12E Pallet Truck

Compact and smart, the **C-Series NPP12E** is a revolutionary truck that runs on the use of a **Lithium Ion battery pack**, and is proven to be the best alternative options to replace the manual intensive hand pallet truck.

Designed with an **ultra-low maintenance 1.2T chassis** and **paired with a simple-to-use tiller arm**, they provide an **excellent turning radius** that can be quickly deployed to operate in the most demanding warehouses.



Features

Ultra Light Chassis

Total service weight of only 120kg including battery (3.7kg).

Compact Turning Circle

Light duty operation with up to 1390mm tight turning radius.

Lithium Battery

Higher energy density with longer usage life-cycle compared to lead-acid batteries.

Quick Charging

2.5 hours to fully charge battery allowing 3 hours of continuous work cycle.

Automatic Power Shut Down System

Saves power when the pallet truck is not in use.

Easy Maintenance

Easy accessibility to all key components for diagnosis and replacing, as well as for lubrication of chain and gears.

Options

Enhanced drive wheel upgrade
2000hrs high charging cycle battery pack



Ergonomic Handle

A comfortable handle with a long tiller arm facilitates effortless steering.



Intuitive Display

Displays to operator the battery level, running status, hours and fault code for quick diagnosis.



Contactless Key & Safety Button

Enhances security and limits unauthorised usage, and safety button cuts power when pressed.



One Easy Step Battery Exchange

The battery pack can be simply plugged in and out of the battery slot.



Low Profile Forks

Forks can be lowered to 80mm for low profile picking.



Characteristics		NPP12E
Power unit		Battery
Operation type		Pedestrian
Lowering type		Manual
Load capacity (kg)	Q	1200
Load centre (mm)	c	600
Load distance	x	950
Wheelbase (mm)	y	1190
Weights		
Service weight (include battery) (kg)		120
Axle loading with load,driving side / Loading side kg		410/910
Axle loading without load,driving side / Loading side		100/20
Wheels / Tyres		
Tyre type driving wheels / Loading wheels		PU/PU
Tyre size, driving wheels (diameter x width) (mm)		Ø130x55
Tyre size, loading wheels (diameter x width) (mm)		Ø80x60
Wheels, number driving / Loading (x=drive wheels)		1x+2/4
Dimensions		
Lift height h mm	h_3	115
Height of tiller arm in driving position, min./max. (mm)	h_{14}	800/1170
Fork height,lowered (mm)	h_{13}	80
Overall length (mm)	l_1	1540
Length to fork face (mm)	l_2	390
Overall width b (mm)	b_1	560
Fork dimensions (mm)	$s \times e \times l$	53x150x1150
Distance between fork-arms (mm)	b_5	560
Ground clearance, center of wheelbase (mm)	m_2	27
Aisle width for pallets 1000 x 1200 crossways (mm)	A_{st}	1640
Aisle width for pallets 800 x 1200 lengthways	A_{st}	1840
Turning radius	W_a	1390
Performance		
Travel speed, with/ without load (km/h)		3.8 / 4
Lifting speed, with/ without load (m/s)		0.02/0.025
Lowering speed, with/ without load (m/s)		0.06/0.03
Max. gradeability, with/ without load (%)		2/8
Service brake		Electric
Drive		
Drive motor rating 60 min (kW)		0.45
Lift motor rating at 15% (kW)		0.5
Battery Type		Li-ion
Battery voltage / Rated capacity (5h) (V/Ah)		24/20
Battery weight (kg)		3.7
Power consumption according to VDI cycle (kW/h)		0.16
Additional Data		
Type of drive control		DC
Sound pressure level at the driver's ear		<74

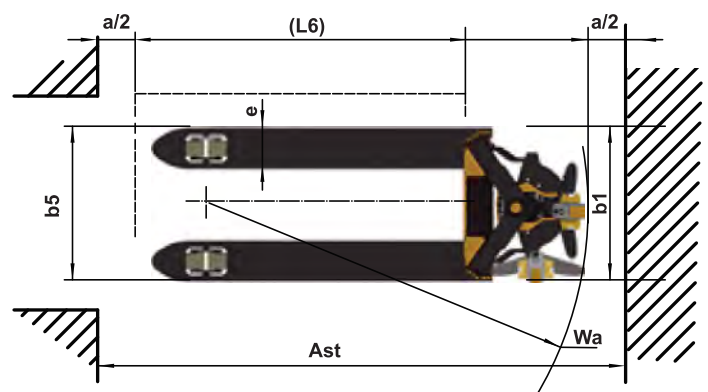
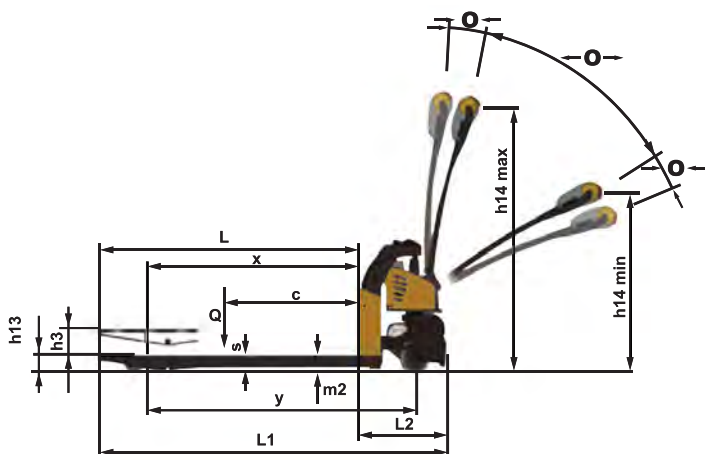

NPP15E Pallet Truck

An innovative award winner of the Red Dot Design, the **C-Series NPP15E** is a highly customisable electric powered pallet truck model, competent of handling up to 1.5T load capacity with its **lightweight and ergonomic** chassis design.

Designed to improve productivity, and ease operator from physical fatigue, the NPP15E is capable of enduring longer operational hours shuttling from point to point **safely and conveniently** deployed **anywhere, and anytime!**



**reddot award
winner**

The Red Dot is the prestigious distinction for high design quality. The international jury awards this coveted quality seal exclusively to products that stand out from comparable entries due to their good design or innovative character.



Features

Light Weight Design

The light weight and compact size creates excellent maneuverability and passing ability.

Standard Built-in Charger

Convenient for onboard charging and includes a temperature indicator that prevents battery from overcharging.

Auto-vibration Technology for Batteries

To extend maintenance free batteries operational life cycle.

Limit Switches

Includes magnetic sensor tiller and lift limit switch.

V-Side Stabiliser

Prevents truck from toppling sideways due to an uneven terrain or uneven weight distribution, by acting as a side counterbalance.

Automatic Power Shut Down System

Saves power when the pallet truck is not in use.

Options

Automatic speed reduction upon cornering

Enclosed drive wheel with casters

For enhanced drive wheel protection and stability

75mm low profile forks

Suitable for tight aisle operation

Digital weight scale



Ergonomic Handling

Fully integrated control buttons enhance ease of control over the electric lifting and lowering of forks with up to 115mm lift height.



Standard Pin Code Start

Exclusive pin pad to increase security and limit unauthorised use.



Intuitive Display

Displays to operator the battery level, running status, hours and fault code for quick diagnosis.



Document Holders

Pockets on each side of the pallet truck allow storage of documents, pens and other material.



Easy Maintenance and Serviceability

The removable cover provides easy battery replacement and maintenance.



Characteristics		NPP15E
Drive unit		Electric
Operation type		Pedestrian
Rated capacity (kg)	Q	1500
Load centre (mm)	c	600
Load distance	x	889/946
Wheelbase (mm)	y	1268/1231
Weights		
Service weight (include battery) (kg)		205
Axle loading with load,driving side / Loading side kg		550/1155
Axle loading without load,driving side / Loading side		180/25
Wheels / Tyres		
Tyre type driving wheels / Loading wheels		PU/PU
Tyre size, driving wheels (diameter x width) (mm)		Ø210x70
Tyre size, loading wheels (diameter x width) (mm)		2x Ø80x60 (Ø74x88)
Tyre size, caster wheels (diameter x width) (mm)		-
Wheels, number driving, caster/loading (x=drive wheels)		1x /4 (1x /2)
Track width, front, driving side	b ₁₀	-
Track width, rear, loading side	b ₁₁	410 (535)
Dimensions		
Lift height (mm)	h ₃	115
Height of tiller arm in driving position, min./max. (mm)	h ₁₄	750/1170
Fork height,lowered (mm)	h ₁₃	85 (75)
Overall length (mm)	l ₁	1632
Length to fork face (mm)	l ₂	482
Overall width (mm)	b ₁ /b ₂	560 (685)
Fork dimensions (mm)	s x e x l	50x150x1150
Distance between fork-arms (mm)	b ₅	560 (685)
Ground clearance, center of wheelbase (mm)	m ₂	35
Aisle width for pallets 1000 x 1200 crossways (mm)	Ast	1739
Aisle width for pallets 800 x 1200 lengthways	Ast	1939
Turning radius	Wa	1485
Performance		
Travel speed, with/ without load (km/h)		4/4.5
Lifting speed, with/ without load (m/s)		0.026/0.031
Lowering speed, with/ without load (m/s)		0.029/0.021
Max. gradeability, with/ without load (%)		2/6
Service brake type		Electromagnetic
Drive		
Drive motor rating S2 60 min (kW)		0.65
Lift motor rating at S3 15% (kW)		0.84
Maximum allowed size battery		265x185x215
Battery voltage / nominal capacity K20		24/85
Battery weight (kg)		25.5x2
Additional Data		
Type of drive control		DC
Steering type		Mechanical
Sound pressure level at the driver's ear		74

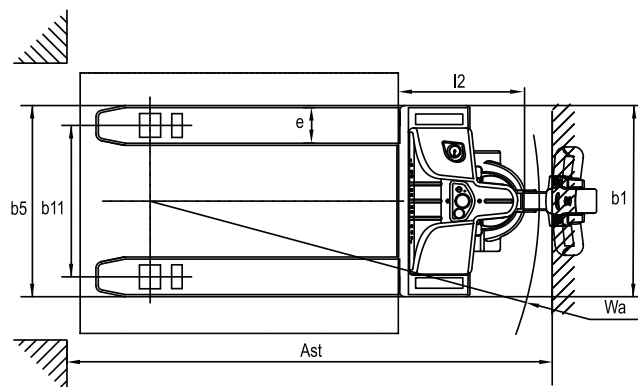
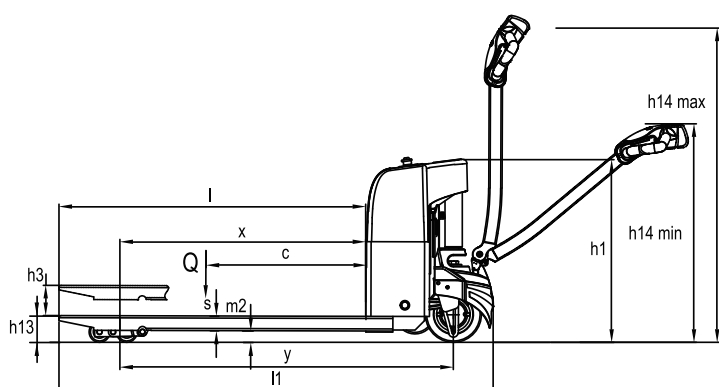

NPP18E Pallet Truck

If you are looking for **performance** that packs a punch for dynamic load handling experience, the **C-Series NPP18E** is probably one of the best optimal truck models for you to actualise results with a core aim to optimise productivity.

The NPP18E is a **perfect logistic mover solution** that works incredibly well in **indoor, outdoor and even inside a trailer**, with the capability of lasting almost a full day work shift with the largest battery option installed. It is also the **world's 1st half pallet handling truck model** famed for its **superb versatility** to operate in any challenging environment.



Features

Powerful DC Drive

Travels up to maximum speed of 6km/h with 1.1kW rated drive motor.

Compact Turning Circle

Light duty operation with up to 1465mm tight turning radius.

Creep Speed Mode

Automatically decreases the truck travel speed when the tiller arm is at near vertical position.

Standard Battery Discharge Indicator

Automatically limits truck performance if the battery level hits 20% or below.

Enclosed Protective Cover

Protects truck components from external elements making it perfect for outdoor applications.

Limit Switches

Includes a magnetic sensor tiller and lift limit switch.

Options

Vertical handling option

Suitable for tight aisle operation where operators can maneuver with the tiller arm fully upright.

High Capacity 240Ah Battery



Ergonomic Handling

Long tiller arm provides 180° rotational movement with a fully integrated electric control handle enhancing lifting and lowering of forks.



Standard Pin Code Start

Exclusive pin pad to increase security and limit unauthorised use.



Intuitive Display

Displays to operator the battery level, running status, hours and fault code for quick diagnosis.



Onboard Charging

Equipped with a standard 15 Amp built-in charger that allows charging of batteries while moving on trailer ends.



Easy Battery Access

Detachable front cover for easy access to maintenance free batteries for inspection or replacement.

Characteristics		NPP18E
Drive unit		Electric
Operation type		Pedestrian
Rated capacity (kg)	Q	1800
Load centre (mm)	c	600
Load distance	x	945
Wheelbase (mm)	y	1270
Weights		
Service weight (include battery) (kg)		285
Axle loading with load,driving side / Loading side kg		770/1315
Axle loading without load,driving side / Loading side		230/55
Wheels / Tyres		
Tyre type driving wheels / Loading wheels		PU/PU
Tyre size, driving wheels (diameter x width) (mm)		Ø230x75
Tyre size, loading wheels (diameter x width) (mm)		Ø74x88 / Ø80x60
Tyre size, caster wheels (diameter x width) (mm)		Ø85x48
Wheels, number driving / Loading (x=drive wheels)		1x+2/2 / 1x+2/4
Track width, front, driving side	b ₁₀	435
Track width, rear, loading side	b ₁₁	390/495/535
Dimensions		
Lift height (mm)	h ₃	115
Height of tiller arm in driving position, min./max. (mm)	h ₁₄	715/1200
Fork height,lowered (mm)	h ₁₃	85
Overall length (mm)	l ₁	1625
Length to fork face (mm)	l ₂	475
Overall width mm)	b ₁	645
Fork dimensions (mm)	s x e x l	50x150x1150
Distance between fork-arms (mm)	b ₅	540/645/685
Ground clearance, center of wheelbase (mm)	m ₂	35
Aisle width for pallets 1000 x 1200 crossways (mm)	Ast	1720
Aisle width for pallets 800 x 1200 lengthways	Ast	1920
Turning radius	Wa	1465
Performance		
Travel speed, with/ without load (km/h)		5.5/6
Lifting speed, with/ without load (m/s)		0.051/0.060
Lowering speed, with/ without load (m/s)		0.032/0.039
Max. gradeability, with/ without load (%)		6/16
Service brake		Electromagnetic
Drive		
Drive motor rating S2 60 min (kW)		1.1
Lift motor rating at S3 15% (kW)		0.84
Maximum allowed size battery		269x182x300
Battery voltage / nominal capacity K20		2x 12/85
Battery weight (kg)		25x2
Additional Data		
Type of drive control		DC
Steering type		Mechanical
Sound pressure level at the driver's ear		74

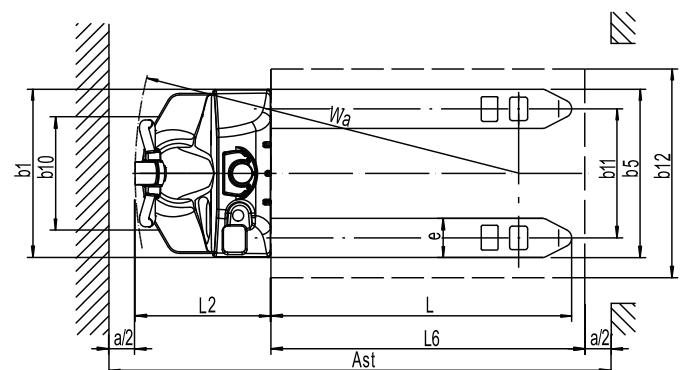
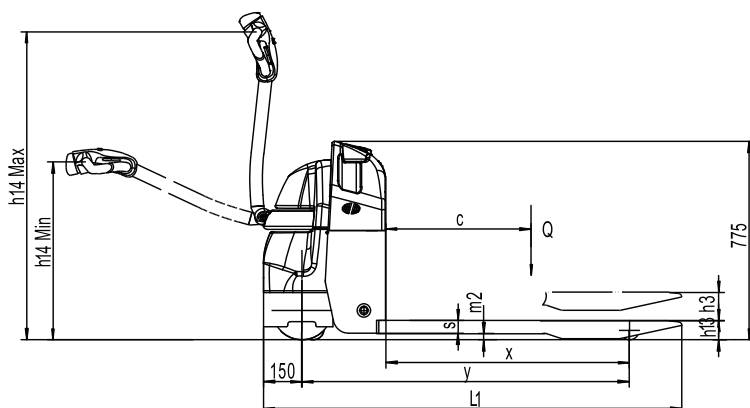

NPP20-25EA Pallet Truck

Specially designed to achieve non-stop performance, the **NPP-EA series** is built to offer alternative solutions to ensure that all kinds of **low-level load transfer possibilities were satisfied**.

Regardless whether the operator is using it for **short shuttle distance** or **heavy duty operations**, the NPP-EA is the truck that displays high **resilience to perform** and meet business daily **expectations**.



Features

Powerful AC Drive

Travels up to maximum speed of 6km/h with 1.1kW rated drive motor.

Standard Battery Discharge Indicator

Automatically limits truck performance if the battery level hits 20% or below.

Top Loading Battery

Design allows the battery to be changed efficiently and provides easy access to the battery water refueling point.

Creep Speed Mode

Automatically decreases the truck travel speed when the tiller arm is at near vertical position.

Anti-Roll Back with Electric Brake

Enhances operator safety while operating on ramps.

AC Electric Traction

Maintenance free AC electric traction motors deliver powerful load handling.

Options

Long fork length up to 2400mm

Wheels Options

Non-marking tyres, pattern drive tyres, single or dual load wheels.

Cold Room Package

Operation in -20° temperature cold rooms.

Vertical handling option

Suitable for tight aisle operation.

High Capacity 240Ah Battery

78mm low profile forks

Battery side loading transfer



Ergonomic Handling

Long tiller arm provides 180° rotational movement with a fully integrated electric control handle enhancing lifting and lowering of forks.



Standard Pin Code Start

Exclusive pin pad to increase security and limit unauthorised use.

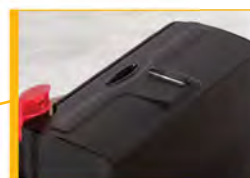

Document Holder

A clip on the top of the truck allows operators to hold documents during operation.



Intuitive Display

Displays to operator the battery level, running status, hours and fault code for quick diagnosis.



Easy Maintenance

Quick access to internal key components for inspection, replacement maintenance and works.

Characteristics		NPP20EA		NPP25EA	
Drive unit		Electric			
Operation type		Pedestrian			
Rated capacity (kg)	Q	2000		2500	
Load centre (mm)	c	600			
Load distance	x	916/982		937/1003	
Wheelbase (mm)	y	1418		1488	
Weights					
Service weight (include battery) (kg)		535		565	
Axle loading with load,driving side / Loading side kg		955/1580		1070/1995	
Axle loading without load,driving side / Loading side		430/105		445/120	
Wheels / Tyres					
Tyre type driving wheels / Loading wheels		PU/PU			
Tyre size, driving wheels (diameter × width) (mm)		Ø230x75			
Tyre size, loading wheels (diameter × width) (mm)		Ø85x70 / Ø83x115			
Tyre size, caster wheels (diameter × width) (mm)		Ø85x48			
Wheels, number driving / Loading (x=drive wheels)		1x+2/4 / 1x+2/2			
Track width, front, driving side	b ₁₀	498			
Track width, rear, loading side	b ₁₁	370/430/515			
Dimensions					
Lift height (mm)	h ₃	120			
Height of tiller arm in driving position, min./max. (mm)	h ₁₄	715/1200			
Fork height,lowered (mm)	h ₁₃	85			
Overall length (mm)	l ₁	1748		1818	
Length to fork face (mm)	l ₂	598			
Overall width mm)	b ₁	710			
Fork dimensions (mm)	sxexl	50x170x1150		55x170x1220	
Distance between fork-arms (mm)	b ₅	540/600/685			
Ground clearance, center of wheelbase (mm)	m ₂	30			
Aisle width for pallets 1000 × 1200 crossways (mm)	Ast	1815			
Aisle width for pallets 800 × 1200 lengthways	Ast	2015			
Turning radius	Wa	1595			
Performance					
Travel speed, with/ without load (km/h)		5/5.5			
Lifting speed, with/ without load (m/s)		0.051/0.060			
Lowering speed, with/ without load (m/s)		0.032/0.039			
Max. gradeability, with/ without load (%)		8/16		6/16	
Service brake		Electromagnetic			
Drive					
Drive motor rating S2 60 min (kW)		1.1			
Lift motor rating at S3 15% (kW)		0.84			
Maximum allowed size battery		680x205x600			
Battery voltage / nominal capacity K20		24/210		24/240	
Battery weight (kg)		190		220	
Additional Data					
Type of drive control		AC			
Steering type		Mechanical			
Sound pressure level at the driver’s ear		74			

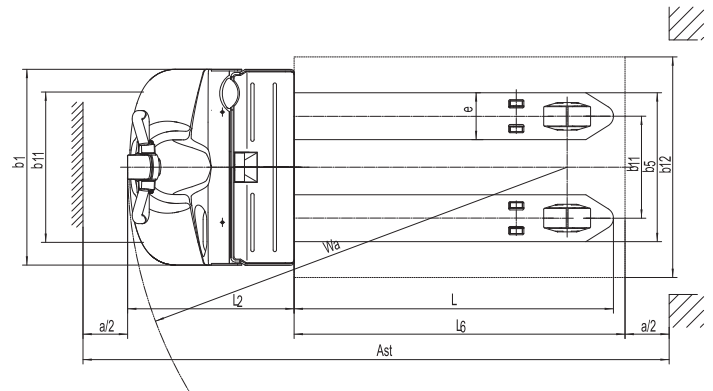
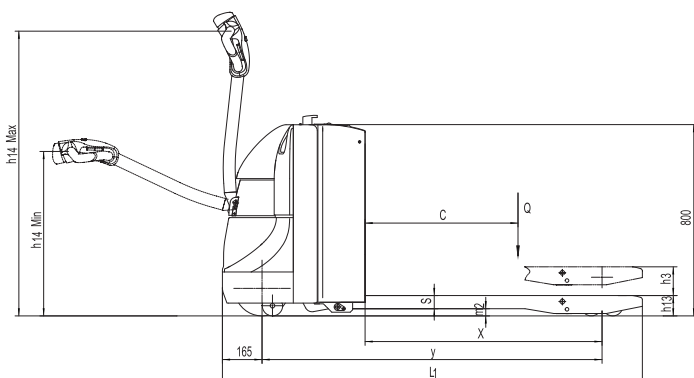

WE'RE UNITED BEHIND YOUR BUSINESS



T: 131 607

unitedequipment.com.au

SALES | RENTALS | SERVICE | PARTS | FINANCE | TRAINING

WE BRING MORE OF THE WORLD'S BEST TO YOU



KONECRANES

Haulotte



ALMACRAWLER



WA

Perth
Bunbury

NT

Darwin

SA

Adelaide

QLD

Brisbane
Mackay
Rockhampton

NSW

Sydney

VIC

Melbourne
Ballarat

TAS

Burnie