

SL-8MCY SL-8MCSY



FEATURES

- 45 degree slant saddle type with simulated Y axis design, allowing for bigger internal working space and bigger Y axis travel 110mm(±55mm).
- BMT55 turret provides better vibration resistance capability.
- Built-in intelligent functions.(opt.)
- Chip disposal at machine rear side to minimize the floor space requirement.

ITEM	Unit	SL-8MCY	SL-8MCSY
SWING OVER BED	mm	ø540	ø540
SADDLE DIA.	mm	ø430	ø430
STANDARD TURNING DIA. / MAX. TURNING DIA.	mm	ø260 / ø305	ø260 / ø305
MAX. TURNING LENGTH	mm	350	350
SPINDLE NOSE	ASA	A2-6	A2-6 SUB:A2-5
SPINDLE SPEED	rpm	4,500	4,500 SUB:4,500
SPINDLE INNER BORE DIA.	mm	ø62	ø62 SUB:ø56
ROD HOLE DIA.	mm	ø52	ø52 SUB:--
SPINDLE BEARING DIA.	mm	ø100	ø100 SUB:ø80
SPINDLE TAPER		01:20	1:20 SUB:MT#6
MILLING SPEED	rpm	4000	4000
HYDRAULIC CHUCK DIA.	inch	8"	8" SUB: 6"
X AXIS / Y AXIS / Z AXIS / E AXIS TRAVEL	mm	210 / 110(±55) / 440 / -	210 / 110(±55) / 440 / 405
X AXIS / Y AXIS / Z AXIS RAPID FEED	mm/min	30 / 30 / 30	30 / 30 / 30
NUMBERS OF TOOL STATION		BMT55,12	BMT55,12
O.D. TOOL	mm	□25	□25
BORING BAR DIA.	mm	ø40	ø40
TAILSTOCK DIA.	mm	ø58	-
TAILSTOCK TRAVEL	mm	88	-
QUILL TAPER		MT#4	-
QUILL TRAVEL	mm	370	-
TAILSTOCK MOVEMENT METHOD		MANUAL	-
CONTROLLER		Fanuc TF1 PLUS	Fanuc TF1 PLUS
SPINDLE MOTOR		7.5/9.0kw	7.5/9.0kw SUB:5.5/7.5kw
X/Y/Z/E AXIS MOTOR		3.0kw/1.6kw/3.0kw	3.0kw/1.6kw/3.0kw/1.6kw
MILLING MOTOR		3.0kw	3.0kw
COOLANT TANK CAPACITY	Liter	135	135
FLOOR SPACE(L) / FLOOR SPACE(W) / MACHINE HEIGHT(H)	mm	2,820(L) / 1,820(W) / 2,050(H)	2,820(L) / 1,820(W) / 2,050(H)
N.W.	kg	4,400	4,500

SL-8MCSY TOOL INTERFERENCE DIAGRAM

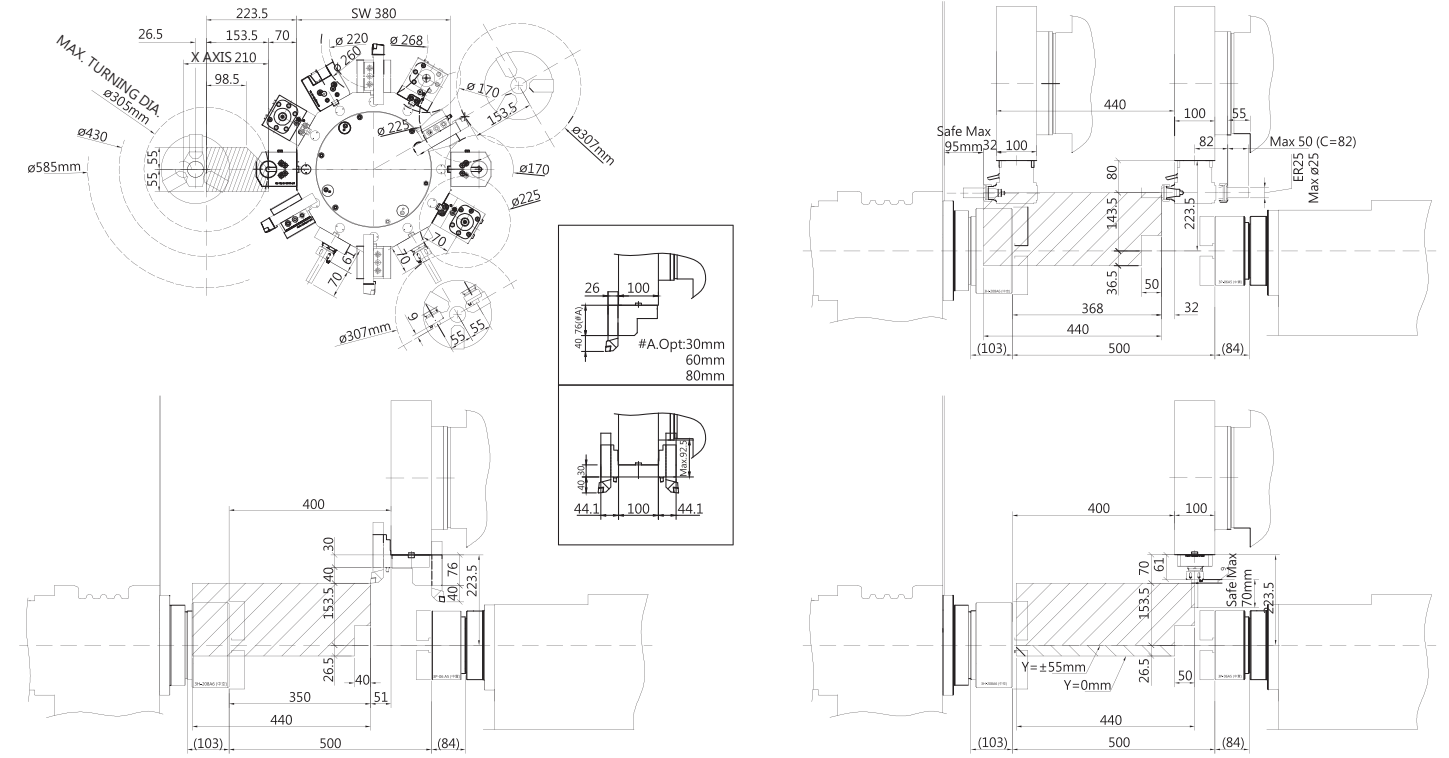

SL-8MCSY TORQUE DIAGRAM

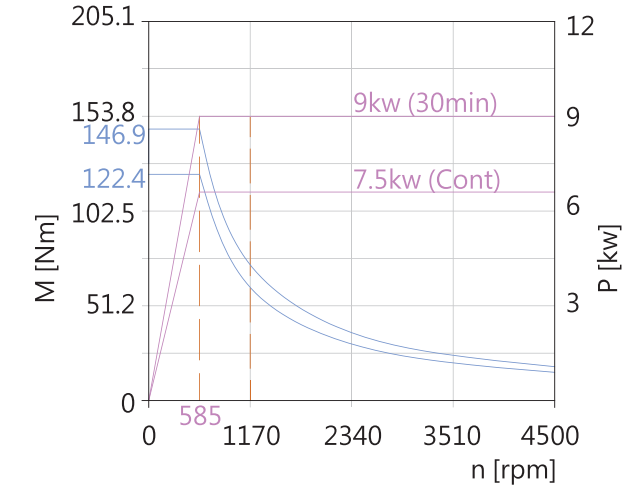

SL-8MCSY MACHINE DIMENSIONS

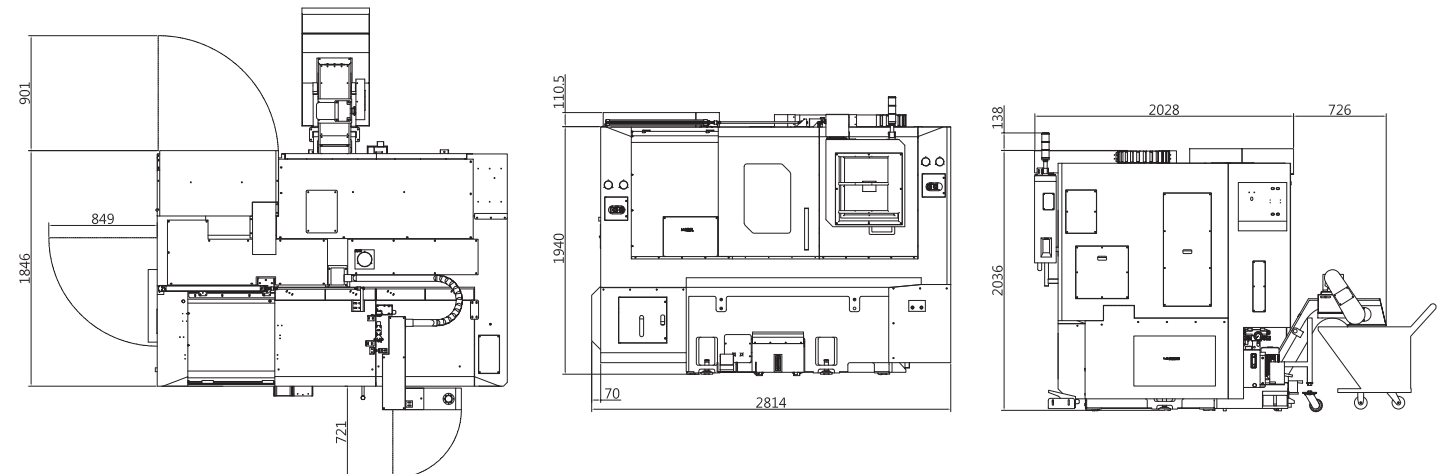

MT-208MCY MT-208MCSY



FEATURES

- 30 degree one piece slant bed design, providing machine stability and excellent chip disposal capability.
- X, Y, Z axis are with box way design, hardness HRC55, increasing the machine rigidity for heavy duty capability.
- Bed, guid ways, sliding set, turret and all axes contact surfaces have to be hand scarping to reach the optimized assembly accuracy, structure rigidity and balanced load.
- Y axis is orthogonal with X axis, enable Y axis movement with lower gravity center and within the range of machine bed. Machine is with excellent support, minimized turret deformation and high machining accuracy performance and minimum floor space requirement.

ITEM	Unit	MT-208MCSY 500/750/1000	MT-208MCY 500/750/1000
SWING OVER BED	mm	ø600	ø600
SADDLE DIA.	mm	ø380	ø380
STANDARD TURNING DIA.	mm	ø200	ø200
MAX. TURNING DIA.	mm	ø210	ø250
MAX. TURNING LENGTH	mm	330/580/830	400/650/900
SPINDLE NOSE	ASA	A2-6 SUB:A2-5	A2-6
SPINDLE SPEED	rpm	4,500 SUB:6,000	4,500
SPINDLE INNER BORE DIA.	mm	ø62 SUB:ø56	ø62
ROD HOLE DIA.	mm	ø52 SUB: --	ø52
SPINDLE BEARING DIA.	mm	ø100 SUB:ø80	ø100
SPINDLE TAPER		1:20 SUB:MT#6	01:20
MILLING SPEED	rpm	4000	4000
HYDRAULIC CHUCK DIA.	inch	ø210 SUB:ø169	ø210
X AXIS / Y AXIS / Z AXIS / E AXIS TRAVEL	mm	105+10 , 80(±40) , 450/700/950 , 400/650/900	125+10 , 80(±40) , 450/700/950 , EAXIS:-
X AXIS / Y AXIS / Z AXIS RAPID FEED	mm/min	20 / 12 / 20	20 / 12 / 20
NUMBERS OF TOOL STATION		BMT55,12	BMT55,12
O.D. TOOL	mm	□25	□25
BORING BAR DIA.	mm	ø32	ø32
TAILSTOCK DIA.	mm	-	90
TAILSTOCK TRAVEL	mm	-	85
QUILL TAPER		-	MT#5
QUILL TRAVEL	mm	-	460/710/960
TAILSTOCK MOVEMENT METHOD		-	Z AXIS
CONTROLLER		Fanuc TF1 PLUS	Fanuc TF1 PLUS
SPINDLE MOTOR		7.5/9.0kw SUB:5.5/7.5kw	7.5/9.0kw
X/Y/Z/E AXIS MOTOR		3.0kw/1.6kw/3.0kw/1.6kw	3.0kw/1.6kw/3.0kw
MILLING MOTOR		3.0kw	3.0kw
COOLANT TANK CAPACITY	Liter	125	125
FLOOR SPACE(L) / FLOOR SPACE(W) / MACHINE HEIGHT(H)	mm	(L)3060/3500/3900 , (W)2,060 , (H)2,280	(L)3060/3500/3900 , (W)2,060 , (H)2,280
N.W.	kg	5000/5600/6200	4800/5400/6000

MT-208MCSY TOOL INTERFERENCE DIAGRAM

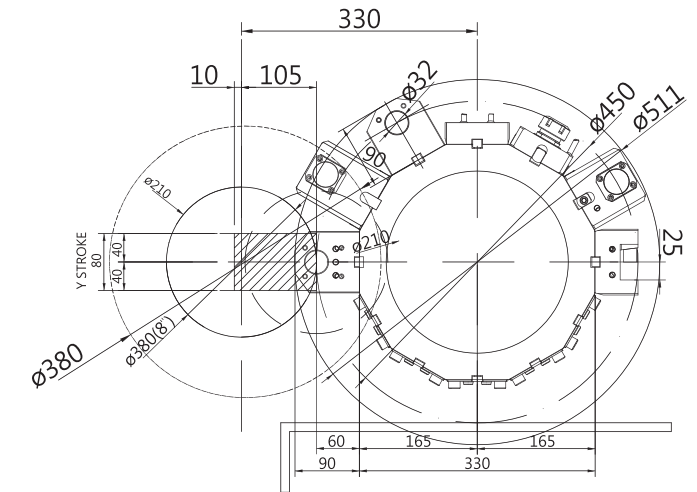

MT-208MCSY TORQUE DIAGRAM

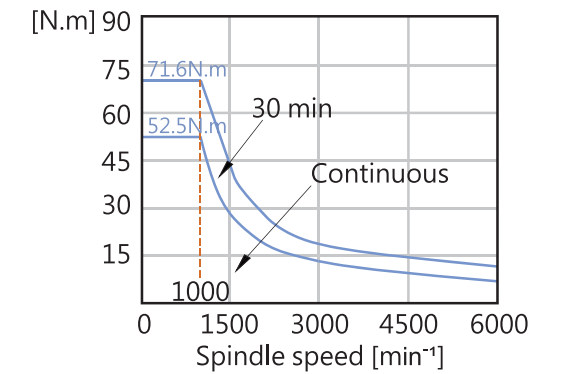
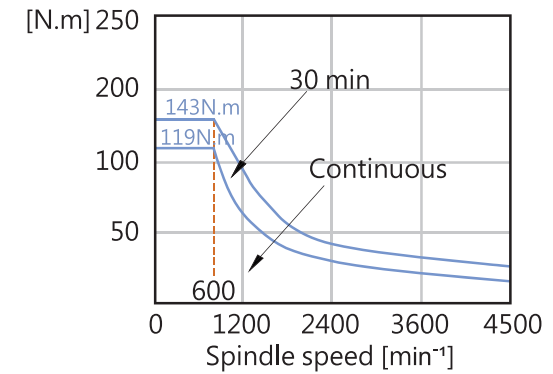
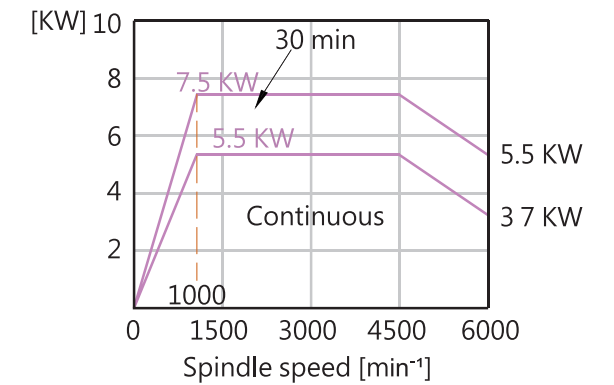
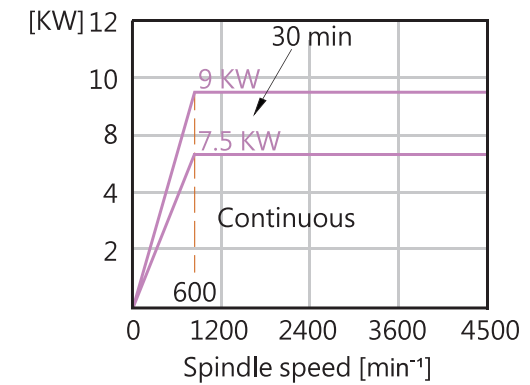

MT-208MCSY MACHINE DIMENSIONS

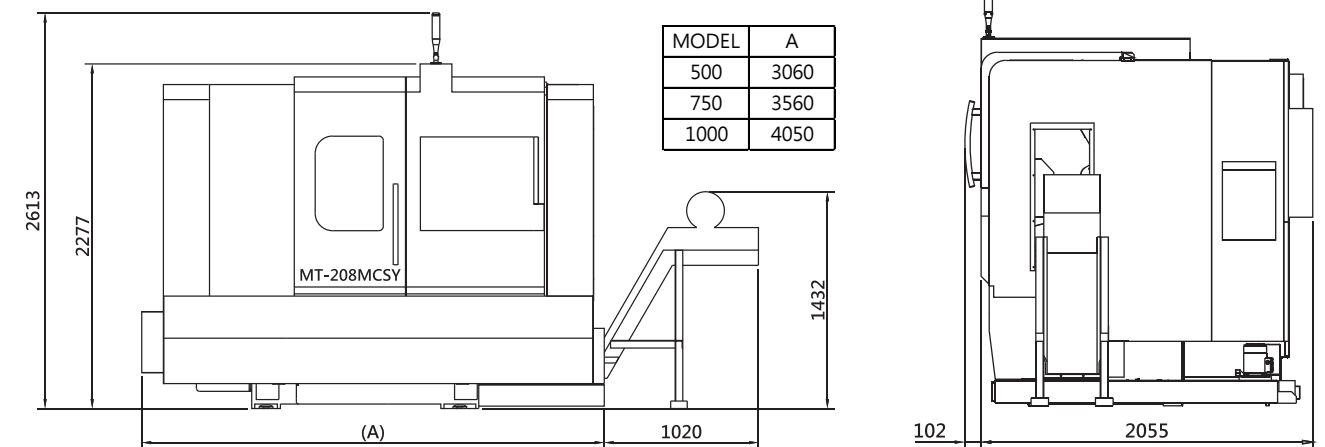

MT-310MCY MT-312MCY

500/750/1000/1500/2000



TOOL INTERFERENCE DIAGRAM

MT-310/312MCY LS-200DTR-BMT55

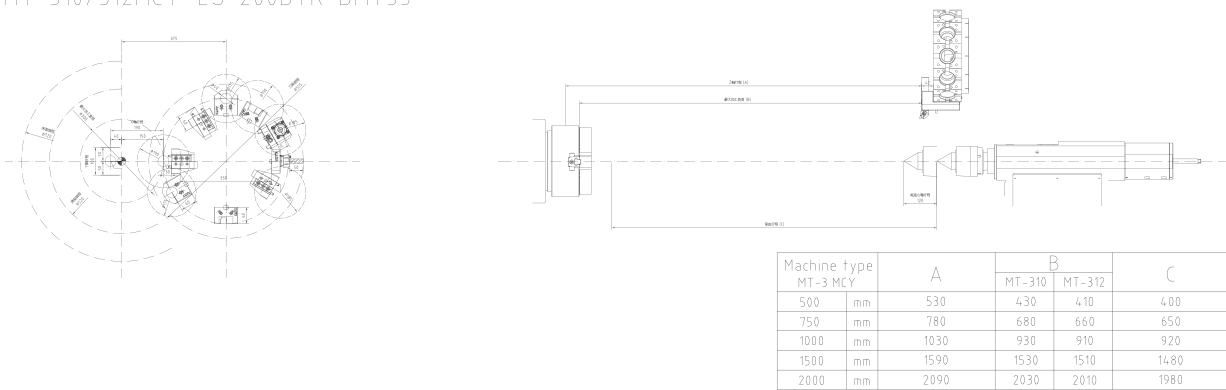

TORQUE DIAGRAM

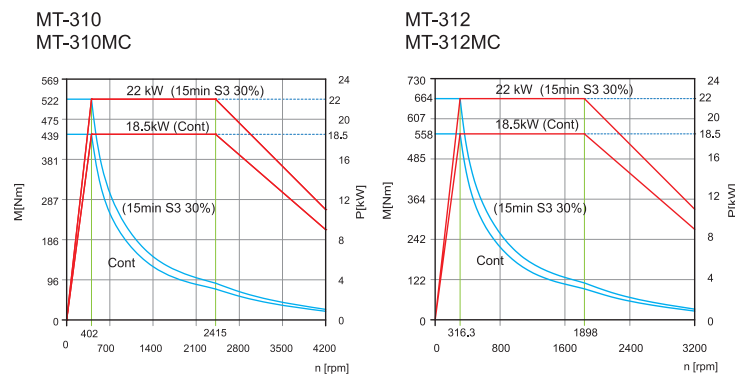

MACHINE DIMENSIONS

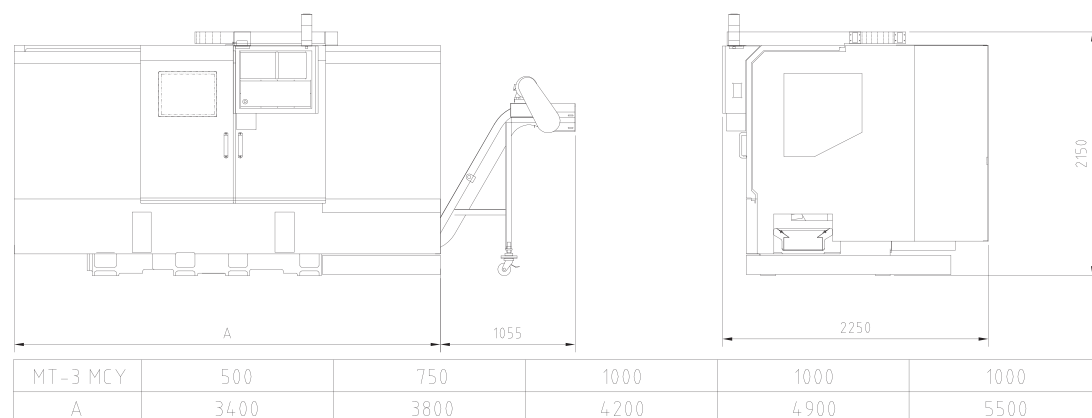

ITEM	Unit	MT-310MCY 500/750/1000/1500/2000		MT-312MCY 500/750/1000/1500/2000	
		SWING OVER BED	mm	ø720	
SADDLE DIA.	mm	ø520		ø520	
STANDARD TURNING DIA.	mm	ø190		ø190	
MAX. TURNING DIA.	mm	ø300		ø300	
MAX. TURNING LENGTH	mm	430/680/930/1510/2010		420/670/920/1500/2000	
SPINDLE NOSE	ASA	A2-8		A2-8	
SPINDLE SPEED	rpm	4200		3200	
SPINDLE INNER BORE DIA.	mm	ø92		ø102	
ROD HOLE DIA.	mm	ø75		ø91	
SPINDLE BEARING DIA.	mm	ø130		ø140	
SPINDLE TAPER		1/20		1/20	
MILLING SPEED	rpm	4000		4000	
HYDRAULIC CHUCK DIA.	inch	10"		12"	
X AXIS TRAVEL	mm	150		150	
Y AXIS TRAVEL	mm	100(±50)		100(±50)	
Z AXIS TRAVEL	mm	510/760/1010/1590/2090		510/760/1010/1590/2090	
E AXIS TRAVEL	mm	-		-	
X AXIS RAPID FEED	mm/min	16		16	
Y AXIS RAPID FEED	mm/min	10		10	
Z AXIS RAPID FEED	mm/min	16		16	
NUMBERS OF TOOL STATION		LS-200DTR-BMT55-12T		LS-200DTR-BMT55-12T	
O.D. TOOL	mm	□25		□25	
BORING BAR DIA.	mm	ø40		ø40	
TAILSTOCK DIA.	mm	ø90 (opt:ø110)		ø90 (opt:ø110)	
TAILSTOCK TRAVEL	mm	120		120	
QUILL TAPER		MT#5		MT#5	
QUILL TRAVEL	mm	400/650/950/1450/1950		400/650/950/1450/1950	
TAILSTOCK MOVEMENT METHOD		Z AXIS			
CONTROLLER		Fanuc TF1 PLUS		Fanuc TF1 PLUS	
SPINDLE MOTOR (30min)		18.5/22 kw (αP40)		18.5/22 kw (αP40)	
X/Y/Z/E AXIS MOTOR		4.0kw/3.0kw/4.0kw(α22B/α12B/α22)		4.0kw/3.0kw/4.0kw(α22B/α12B/α22)	
MILLING MOTOR		3.7/5.5kw (α3)		3.7/5.5kw (α3)	
COOLANT TANK CAPACITY	Liter	150		150	
FLOOR SPACE(L)	mm	3400/3800/4200/4900/5500		3400/3800/4200/4900/5500	
FLOOR SPACE(W)	mm	2,250		2,250	
MACHINE HEIGHT(H)	mm	2,150		2,150	
N.W.	kg	5700/6100/6600/7100/7700		5700/6100/6600/7100/7700	

MT-412MCY MT-415MCY

750/1000/1500/2000/3000



TOOL INTERFERENCE DIAGRAM

MT-412/415MCY LS-200DTR-BMT65 SW380

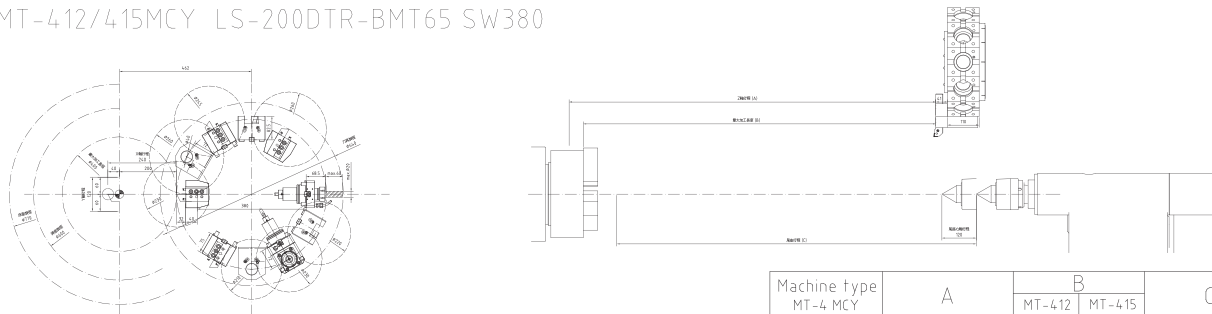

Machine type MT-4 MCY		B			C
		A	MT-412	MT-415	
750	mm	760	690	645	600
1000	mm	1020	940	895	850
1500	mm	1520	1440	1395	1350
2000	mm	2020	1940	1895	1850
3000	mm	3020	2940	2895	2850

TORQUE DIAGRAM

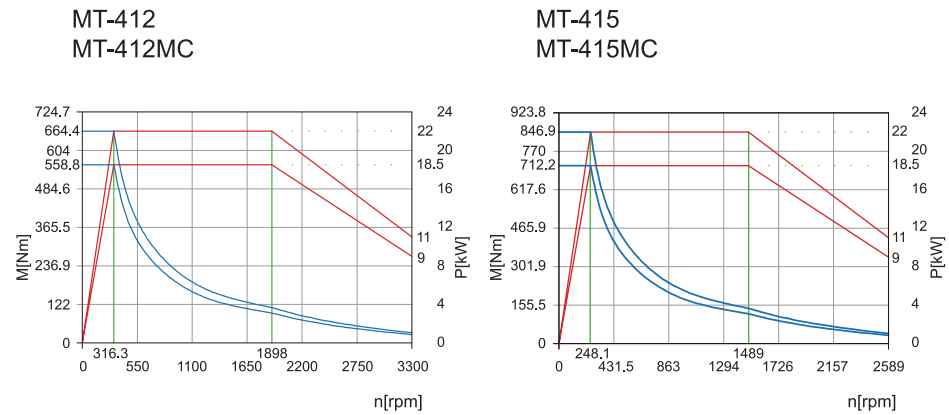

MACHINE DIMENSIONS

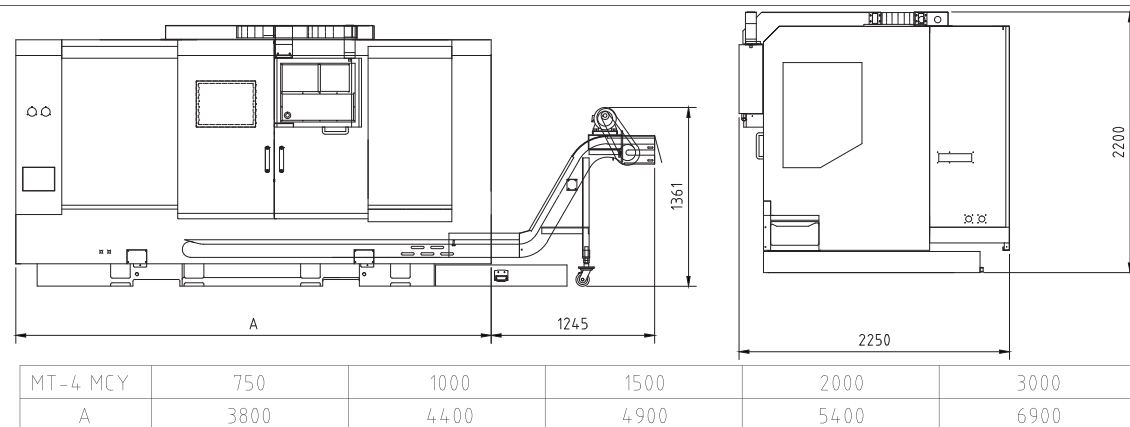

ITEM	Unit	MT-412MCY	MT-415MCY
		750/1000/1500/2000/3000	750/1000/1500/2000/3000
SWING OVER BED	mm	ø770	ø770
SADDLE DIA.	mm	ø600	ø600
STANDARD TURNING DIA.	mm	ø230	ø230
MAX. TURNING DIA.	mm	ø400	ø400
MAX. TURNING LENGTH	mm	690/940/1440/1940/2940	645/895/1395/1895/2895
SPINDLE NOSE	ASA	A2-8	A2-11
SPINDLE SPEED	rpm	3200	2500
SPINDLE INNER BORE DIA.	mm	ø102	ø131
ROD HOLE DIA.	mm	ø91	ø117
SPINDLE BEARING DIA.	mm	ø140	ø170
SPINDLE TAPER		1/20	1/20
MILLING SPEED	rpm	4000	4000
HYDRAULIC CHUCK DIA.	inch	12"	15"
X AXIS TRAVEL	mm	194 (187+7)	194 (187+7)
Y AXIS TRAVEL	mm	120(±60)	120(±60)
Z AXIS TRAVEL	mm	760/1020/1520/2020/3020	760/1020/1520/2020/3020
E AXIS TRAVEL	mm	-	-
X AXIS RAPID FEED	mm/min	16	16
Y AXIS RAPID FEED	mm/min	10	10
Z AXIS RAPID FEED	mm/min	16 ; 10 (Z≥3000)	16 ; 10 (Z≥3000)
NUMBERS OF TOOL STATION		LS-200DTR-BMT65-12T	LS-200DTR-BMT65-12T
O.D. TOOL	mm	□25	□25
BORING BAR DIA.	mm	ø40	ø40
TAILSTOCK DIA.	mm	ø100 (opt:ø130)	ø100 (opt:ø130)
TAILSTOCK TRAVEL	mm	120	120
QUILL TAPER		MT#5	MT#5
QUILL TRAVEL	mm	600/850/1350/1850/2850	600/850/1350/1850/2850
TAILSTOCK MOVEMENT METHOD		Z AXIS	
CONTROLLER		Fanuc TF1 PLUS	Fanuc TF1 PLUS
SPINDLE MOTOR (30min)		18.5/22 kw (αP40)	18.5/22 kw (αP40)
X/Y/Z/E AXIS MOTOR		4.0kw/4.0kw/7.0kw(α22B/α22B/α30)	4.0kw/4.0kw/7.0kw(α22B/α22B/α30)
MILLING MOTOR		3.7/5.5kw (α3)	3.7/5.5kw (α3)
COOLANT TANK CAPACITY	Liter	150	150
FLOOR SPACE(L)	mm	3800/4400/4900/5400/6900	3800/4400/4900/5400/6900
FLOOR SPACE(W)	mm	2,250	2,250
MACHINE HEIGHT(H)	mm	2,200	2,200
N.W.	kg	8200/8700/9200/9800/10300	8200/8700/9200/9800/10300

MT-415MCY plus

750/1000/1500/2000/3000/4000

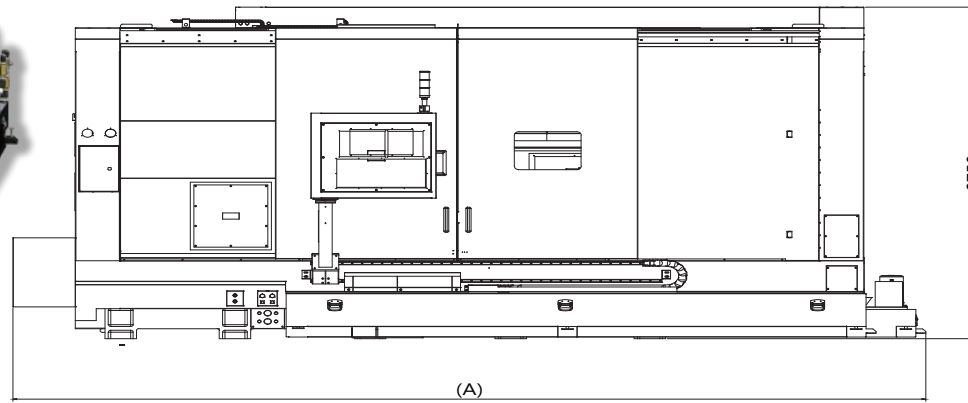
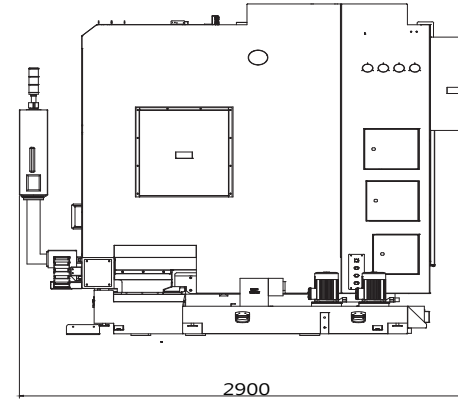

MT-415MCY plus		750	1000	1500	2000	3000	4000
A	mm	5000	5200	5700	6200	7200	8500

LS-250DTR-BMT75-12T SW430

434.025-BMT75-12T SW430

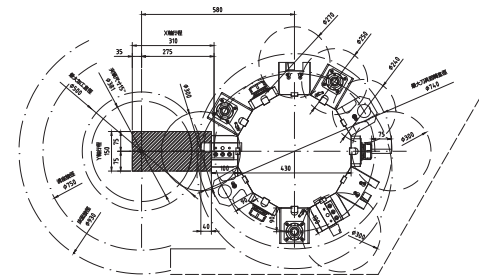
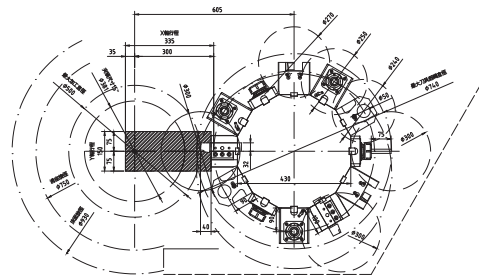

MT-415MCY plus Z AXIS TRAVEL

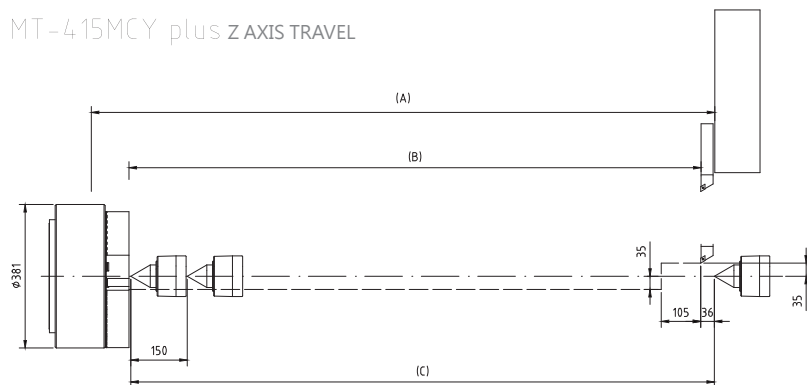

Machine type	MT-415MCY plus	A	B	C
750	mm	850	750	750
1000	mm	1100	1000	1000
1500	mm	1600	1500	1500
2000	mm	2100	2000	2000
3000	mm	3100	3000	3000
4000	mm	4100	4000	4000

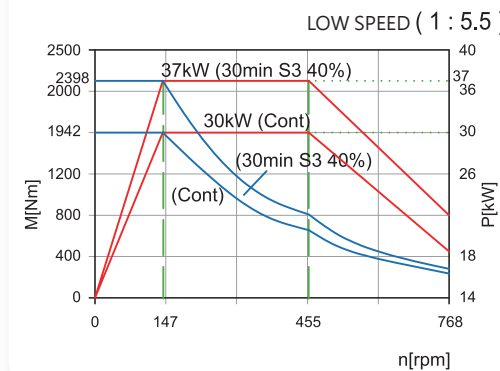
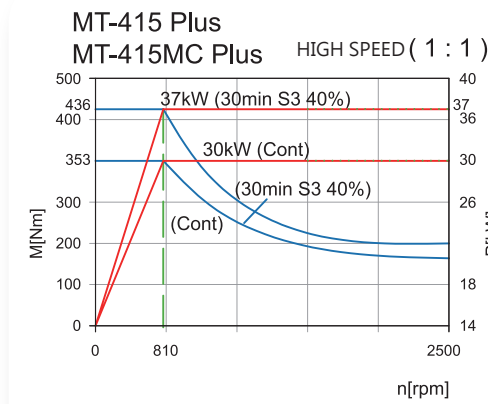

ITEM	Unit	MT-415MCY plus 750/1000/1500/2000/3000/4000
SWING OVER BED	mm	ø930
SADDLE DIA.	mm	ø750
STANDARD TURNING DIA.	mm	ø300
MAX. TURNING DIA.	mm	ø500
MAX. TURNING LENGTH	mm	690/940/1440/1940/2940/3940
SPINDLE NOSE	ASA	A2-11 (opt:A2-15)
SPINDLE SPEED	rpm	2500 (opt:1200)
SPINDLE INNER BORE DIA.	mm	ø131 (opt:ø160)
ROD HOLE DIA.	mm	ø117 (opt:ø140)
SPINDLE BEARING DIA.	mm	ø170 (opt:ø220)
SPINDLE TAPER		1/20
MILLING SPEED	rpm	3500
HYDRAULIC CHUCK DIA.	inch	15"(opt:21")
X AXIS TRAVEL	mm	300+35
Y AXIS TRAVEL	mm	150(±75)
Z AXIS TRAVEL	mm	850/1100/1600/2100/3100/4100
E AXIS TRAVEL	mm	-
X AXIS RAPID FEED	mm/min	16
Y AXIS RAPID FEED	mm/min	10
Z AXIS RAPID FEED	mm/min	16(≤2000) 10(≥3000)
NUMBERS OF TOOL STATION		LS-250DTR BMT75,12T
O.D. TOOL	mm	□32
BORING BAR DIA.	mm	ø50
TAILSTOCK DIA.	mm	ø150
TAILSTOCK TRAVEL	mm	150
QUILL TAPER		MT#6
QUILL TRAVEL	mm	750/1000/1500/2000/3000/4000
TAILSTOCK MOVEMENT METHOD		Z AXIS
CONTROLLER		Fanuc TF1 PLUS
SPINDLE MOTOR (30min)		30/37 kw (α30)
X/Y/Z/E AXIS MOTOR		4.0kw/4.0kw/7.0kw(α22B/α22B/α30)
MILLING MOTOR		5.5/7.5kw (α6)
COOLANT TANK CAPACITY	Liter	300
FLOOR SPACE(L)	mm	5000/5200/5700/6200/7200/8500
FLOOR SPACE(W)	mm	2,900
MACHINE HEIGHT(H)	mm	2,750
N.W.	kg	9500/10000/10500/12200/13300

MT-520MCY

1000/1500/2000/3000/4000/5000

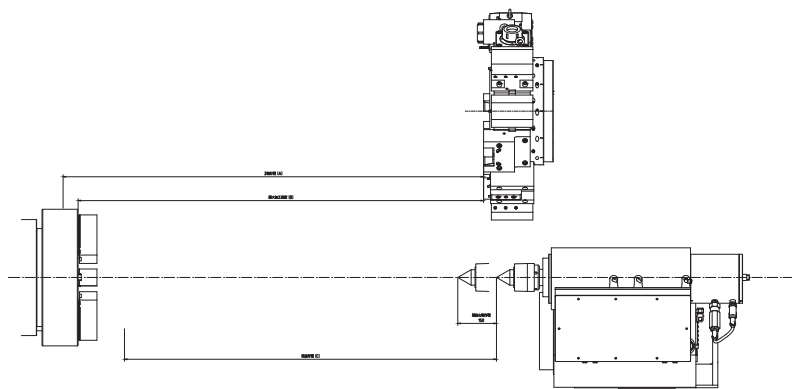

Machine type		A	B	C
MT-5MCI plus				
1000	mm	1000	900	700
1500	mm	1500	1400	1200
2000	mm	2000	1900	1700
3000	mm	3000	2900	2700
4000	mm	4000	3900	3700
5000	mm	5000	4900	4700

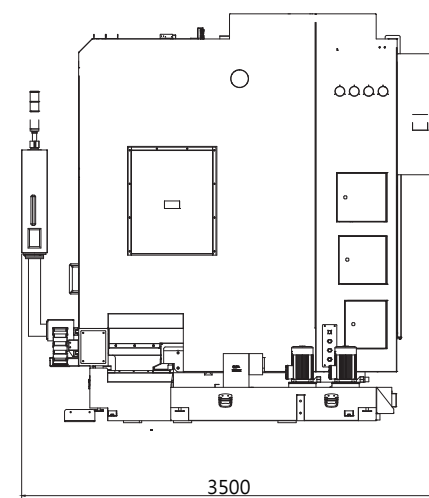
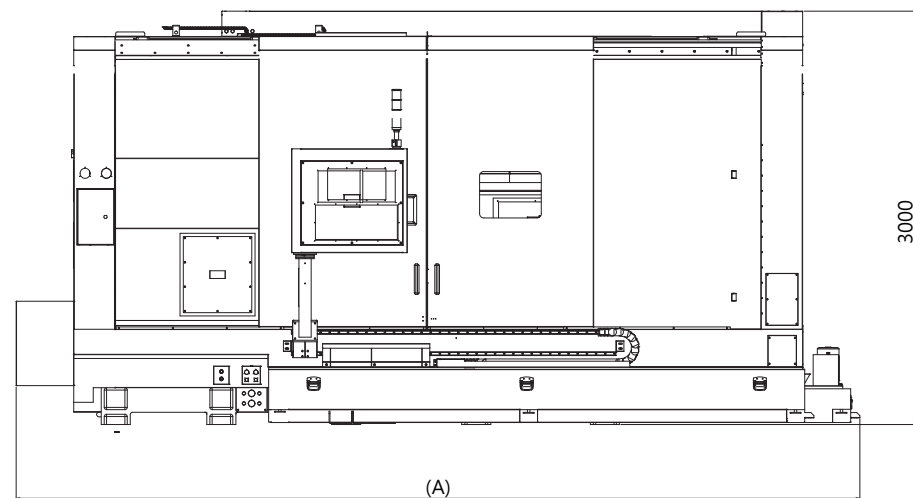

MT-5MCI		1000	1500	2000	3000	4000	5000
A	mm	5180	5680	6180	7180	8180	9180

MT-520MCY LS-320DTR-BMT85 中心高160

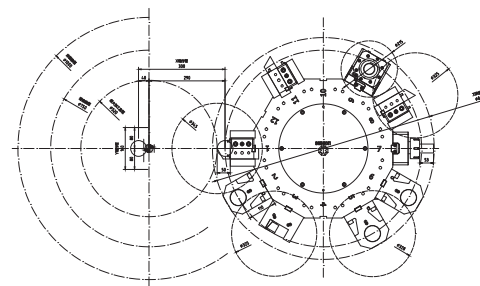

MT-520
MT-520MC
HIGH SPEED(1 : 1)

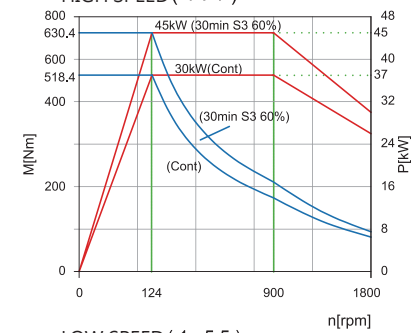

LOW SPEED(1 : 5.5)

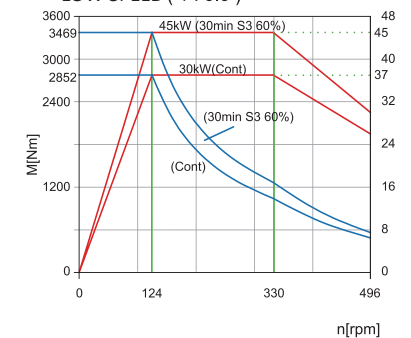

ITEM	Unit	MT-520MCY	
		1000/1500/2000/3000/4000/5000	
SWING OVER BED	mm	ø1000	
SADDLE DIA.	mm	ø750	
STANDARD TURNING DIA.	mm	ø330	
MAX. TURNING DIA.	mm	ø520	
MAX. TURNING LENGTH	mm	900/1400/1900/2900/3900/4900	
SPINDLE NOSE	ASA	A2-15	
SPINDLE SPEED	rpm	1800	
SPINDLE INNER BORE DIA.	mm	ø160	
ROD HOLE DIA.	mm	ø140	
SPINDLE BEARING DIA.	mm	ø220	
SPINDLE TAPER		1/20	
MILLING SPEED	rpm	3000	
HYDRAULIC CHUCK DIA.	inch	21"	
X AXIS TRAVEL	mm	290+40	
Y AXIS TRAVEL	mm	160(±80)	
Z AXIS TRAVEL	mm	1000/1500/2000/3000/4000/5000	
E AXIS TRAVEL	mm	-	
X AXIS RAPID FEED	mm/min	12	
Y AXIS RAPID FEED	mm/min	10	
Z AXIS RAPID FEED	mm/min	10 8(≥2000)	
NUMBERS OF TOOL STATION		LS-320DTR-BMT85,12	
O.D. TOOL	mm	□32	
BORING BAR DIA.	mm	ø60	
TAILSTOCK DIA.	mm	ø150	
TAILSTOCK TRAVEL	mm	150	
QUILL TAPER		MT#6	
QUILL TRAVEL	mm	700/1200/1700/2700/3700/4700	
TAILSTOCK MOVEMENT METHOD		HYDRAULIC GEAR RACK	
CONTROLLER		Fanuc TF1 PLUS	
SPINDLE MOTOR (30min)		37/45 kw(α40)	
X/Y/Z/E AXIS MOTOR		6.0kw/7.0kw/6.0kw(α40B/α30B/α40)	
MILLING MOTOR		7.5/11kw (α8)	
COOLANT TANK CAPACITY	Liter	300	
FLOOR SPACE(L)	mm	5180/5680/6180/7180/8180/9180	
FLOOR SPACE(W)	mm	3,500	
MACHINE HEIGHT(H)	mm	3,000	
N.W.	kg	12800/13300/13900/15000/16100/17800	

MT-624MCY

2200/3200/4200/5200



ITEM	Unit	MT-624MCY 2200/3200/4200/5200
SWING OVER BED	mm	ø1200
SADDLE DIA.	mm	ø1000
STANDARD TURNING DIA.	mm	ø308
MAX. TURNING DIA.	mm	ø780
MAX. TURNING LENGTH	mm	2100/3100/4100/5100
SPINDLE NOSE	ASA	A2-15
SPINDLE SPEED	rpm	1200
SPINDLE INNER BORE DIA.	mm	ø160
ROD HOLE DIA.	mm	ø140
SPINDLE BEARING DIA.	mm	ø220
SPINDLE TAPER		1/20
MILLING SPEED	rpm	3000
HYDRAULIC CHUCK DIA.	inch	21"
X AXIS TRAVEL	mm	390+20
Y AXIS TRAVEL	mm	160(±80)
Z AXIS TRAVEL	mm	2200/3200/4200/5200
E AXIS TRAVEL	mm	-
X AXIS RAPID FEED	mm/min	12
Y AXIS RAPID FEED	mm/min	10
Z AXIS RAPID FEED	mm/min	10 8(≥2000)
NUMBERS OF TOOL STATION		LS-320DTR-BMT85,12
O.D. TOOL	mm	□32
BORING BAR DIA.	mm	ø60
TAILSTOCK DIA.	mm	235
TAILSTOCK TRAVEL	mm	200
QUILL TAPER		MT#6
QUILL TRAVEL	mm	1880/2880/3880/4880
TAILSTOCK MOVEMENT METHOD		HYDRAULIC GEAR RACK
CONTROLLER		Fanuc TF1 PLUS
SPINDLE MOTOR (30min)		37/45 kw(α40)
X/Y/Z/E AXIS MOTOR		6.0kw/7.0kw/6.0kw(α40B/α30B/α40)
MILLING MOTOR		7.5/11kw (α8)
COOLANT TANK CAPACITY	Liter	800
FLOOR SPACE(L)	mm	6800/7800/8800/9800
FLOOR SPACE(W)	mm	3,300
MACHINE HEIGHT(H)	mm	3,200
N.W.	kg	18000/19500/21500/23500

Machine type		A	B	C
MT-5MCY plus				
2200	mm	2200	2100	1880
3200	mm	3200	3100	2880
4200	mm	4200	4100	3880
5200	mm	5200	5100	4880

MT-6MICY	2200	3200	4200	5200	
A	mm	6800	7800	8800	9800

MT-6 MICY LS-320DTR-BMT85 刀具干涉图 中心高160

MT-624
MT-624MC
HIGH SPEED (1:1)

LOW SPEED (1:5.5)