

SnapIT

Multi-Use | Ampoule Opener

Instructions for Use

QLICKSMART Pty Ltd.

+61-7-3844-1182 T

+61-7-3844-1183 F

mjs@quicksmart.com | www.quicksmart.com

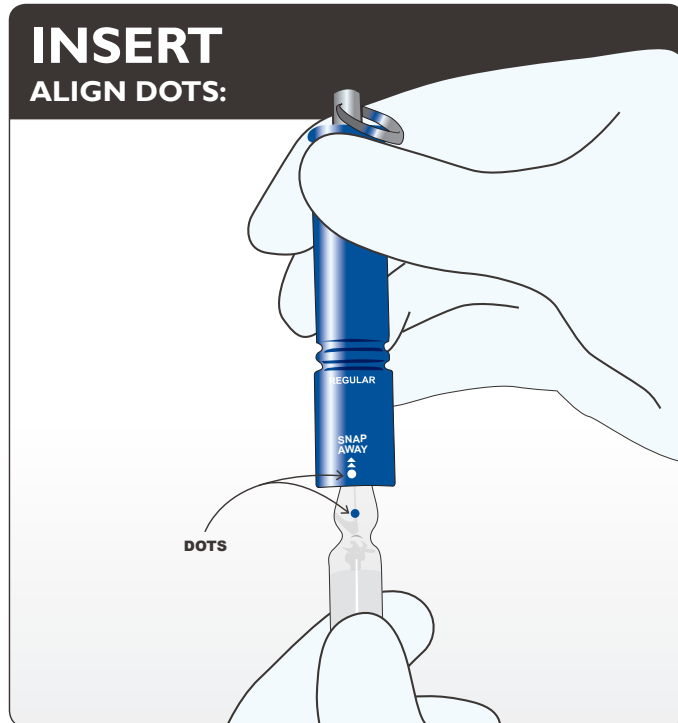

1. Align the dots if present. Gently insert all of the ampoule lid into the SnapIT. The ampoule lid becomes locked in at the neck.

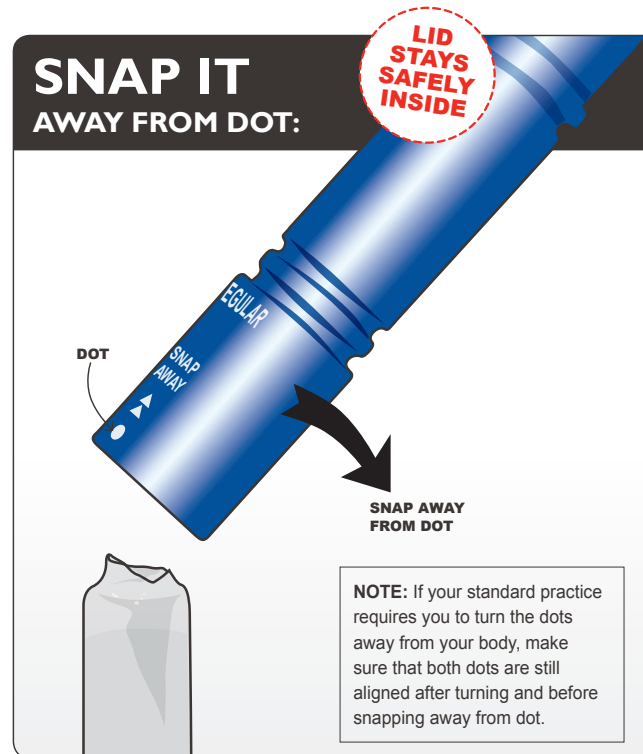

2. With little effort, lever away from the dot to snap off the lid. The lid should remain held in the SnapIT.

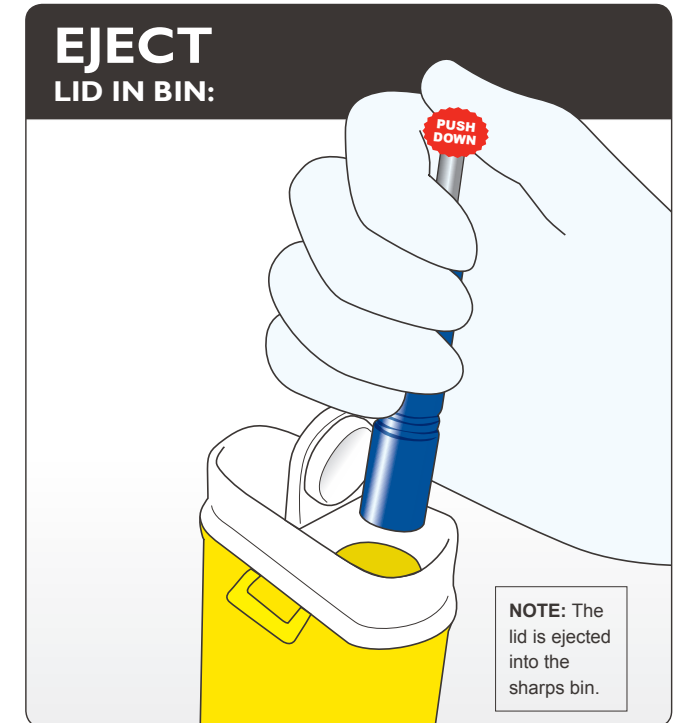

3. Carefully aim over a sharps bin and eject the lid by pushing down on the rod with your thumb.

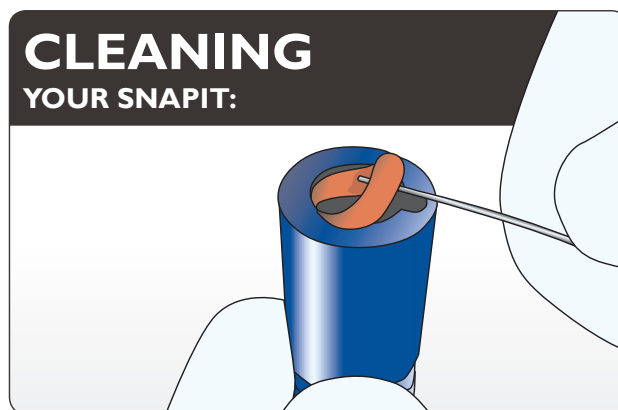

4. Clean your SnapIT regularly. Remove O-ring as shown to disassemble the parts and clean with water or hospital grade cleaner. Do this in a clean dish to avoid loss of parts. Dry completely then re-assemble.

NOTE: If the ampoule lid breaks, tap the SnapIT over a sharps bin to remove excess glass pieces then rinse under running water before disassembling.

SIZES:

If the ampoule lid is too big, it will not fit through the entrance. Use a larger SnapIT.

If the ampoule is too small, the SnapIT will not hold the top securely. Use a smaller SnapIT.