

Schmalz Quick-Change SQC

Working heights 80 mm and 120 mm

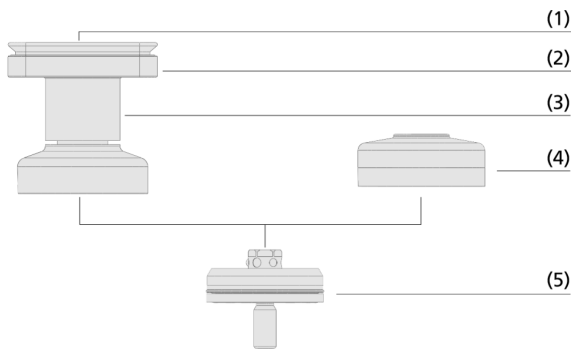

Schmalz Quick-Change SQC



System design Schmalz Quick-Change SQC

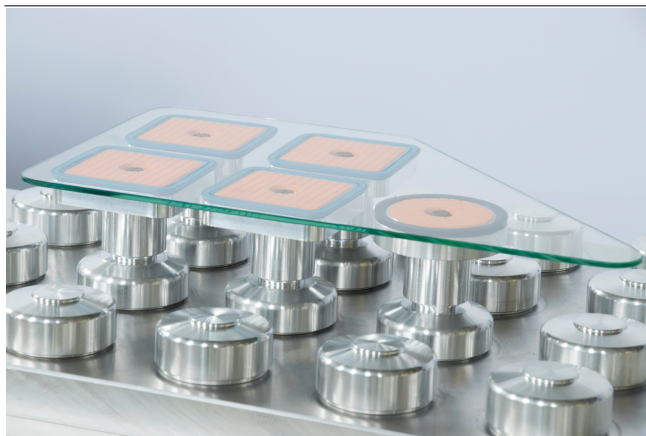

Schmalz Quick-Change SQC for clamping glass

Suitability for industry specific applications

Applications

- Vacuum clamping system for grinding glass workpieces using CNC machines from the manufacturer Bystronic
- Used for grinding high-quality building, design and automotive glass
- Tool-free changeover to reduce set-up times and downtimes as well as simple retrofitting of existing machine tables
- Fully compatible with original equipment suction cups
- Working heights of 80 mm and 120 mm

Design

- Suction cup with sealing frame (1) made of HT1-material leaving few marks
- Square and round suction areas available (2)
- Aluminum housing with break joint (3)
- Mono-Base with hollow bolt for long-term mounting on a machine table (5)
- Cover (4) for bases that are not equipped with suction cups

Product highlights

- Quick change system consisting of only three parts for short set-up times for new machine layouts
- Sealing frame made of low-marking material that can be exchanged without tools
- Quick cleaning during layout changes, as base remains permanently on the machine table
- Very high holding forces on dry, moist glass
- Working heights and interference contour suitable for mixed operation with original equipment vacuum blocks

Designation code Schmalz Quick-Change SQC

Schmalz Quick-Change SQC

Working heights 80 mm and 120 mm

Module 1: Suction Cup

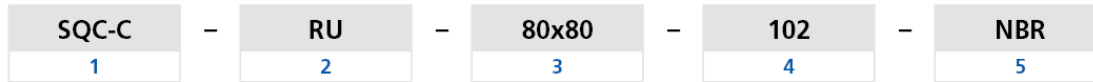

1 – Abbreviated designation

Code	Type
SQC-C	Quick-Change Suction Cup

2 – Design

Code	Type
RU	Round
VI	Rectangular

3 – Suction area

Code	Diameter / LxW in mm
80	ø 80
80x80	80x80

4 – Height

Code	Height in mm
62	For working height 80 mm
102	For working height 120 mm

5 – Material

Code	Material
HT1	High temperature material
NBR	Nitrile caoutchuc

Module 2: Mono-Base



1 – Abbreviated designation

Code	Type
SQC-MB	Quick-Change-Mono-Base

2 – Dimensions

Code	Diameter in mm
62.9	ø 62.9

3 – Height

Code	Height in mm
x18	18

4 – Connection

Code	Connection thread
M12-AG	M12-AG (AG = Male (M))

Module 3: Cover

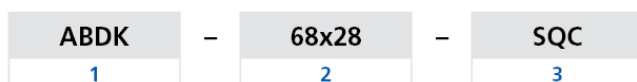

1 – Abbreviated designation

Code	Type
ABDK	Cover for Quick-Change-Mono-Base

2 – Dimensions

Code	Diameter in mm
68	ø 68

3 – Product addition

Code	Type
SQC	For SQC Mono-Base

The Schmalz Quick-Change System is not supplied assembled. The system consists of three components, which are ordered independently of each other:

- Machine table interface: Schmalz Quick-Change Mono-Base SQC-MB with hollow screw, for permanent retention on machine table
- Suction cup: Schmalz Quick-Change Cup SQC-C, suction surface optionally square or round
- Cover: Schmalz Quick-Change Cover ABDK SQC

Available spare parts: Sealing frame, V-ring, hollow screw, pressure piece for 30° grid

Schmalz Quick-Change SQC

Working heights 80 mm and 120 mm



Ordering data Schmalz Quick-Change SQC

Type	Part no.
SQC-C-RU-80x62-HT1	10.01.18.01091
SQC-C-RU-80x62-NBR	10.01.18.01033
SQC-C-RU-80x102-HT1	10.01.18.01090
SQC-C-RU-80x102-NBR	10.01.18.01037
SQC-C-VI-80x80x62-HT1	10.01.18.01038
SQC-C-VI-80x80x62-NBR	10.01.18.01093
SQC-C-VI-80x80x102-HT1	10.01.18.01039
SQC-C-VI-80x80x102-NBR	10.01.18.01092

Type	Part no.
SQC-MB-62.9x18-M12-AG	10.01.18.01031

Type	Part no.
ABDK 68x12 SQC	10.01.18.01022

Ordering data Spare parts Schmalz Quick-Change SQC

Type		Part no.
Sealing frame	ISDR 81x81x12 Cup 1 HT1	10.01.15.00962
Sealing frame	ISDR 81x81x12 Cup 1 NBR-50	10.01.15.00158 
Sealing frame	ISDR 81x12 SQC HT1	10.01.18.00842 
V-ring	V-RING 63x11 V-070 NBR	10.07.08.00554
Hollow screw, special shape	SCHR M12x52.9 VC-SYS	10.01.18.01030
Pressure piece	DRUC-STK 2.4x14 M5-AG GN615.1	20.05.07.00137

Technical data Schmalz Quick-Change SQC

Type	Sealing material	Material workpiece support
SQC-C-RU-80x62-HT1	High temp material HT1	ED
SQC-C-RU-80x62-NBR	Perbunan	ED
SQC-C-RU-80x102-HT1	High temp material HT1	ED
SQC-C-RU-80x102-NBR	Perbunan	ED
SQC-C-VI-80x80x62-HT1	High temp material HT1	ED
SQC-C-VI-80x80x62-NBR	Perbunan	ED
SQC-C-VI-80x80x102-HT1	High temp material HT1	ED
SQC-C-VI-80x80x102-NBR	Perbunan	ED
SQC-MB-62.9x18-M12-AG	-	-
ABDK 68x12 SQC	-	-

Schmalz Quick-Change SQC

Working heights 80 mm and 120 mm

Design data Schmalz Quick-Change SQC

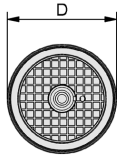
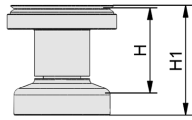

SQC-C-RU

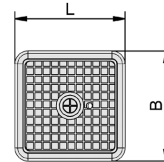
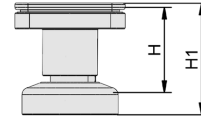

SQC-C-VI

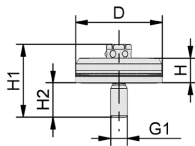

SQC-MB

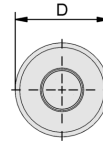
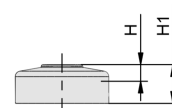

ABDK SQC

Schmalz Quick-Change SQC

Working heights 80 mm and 120 mm

Design data Schmalz Quick-Change SQC

Type	B [mm]	D [mm]	H [mm]	H1 [mm]	L [mm]
SQC-C-RU-80x62-HT1	-	80	62	80	-
SQC-C-RU-80x62-NBR	-	80	62	80	-
SQC-C-RU-80x102-HT1	-	80	102	120	-
SQC-C-RU-80x102-NBR	-	80	102	120	-
SQC-C-VI-80x80x62-HT1	80	-	62	80	80
SQC-C-VI-80x80x62-NBR	80	-	62	80	80
SQC-C-VI-80x80x102-HT1	80	-	102	120	80
SQC-C-VI-80x80x102-NBR	80	-	102	120	80

Type	D [mm]	G1	H [mm]	H1 [mm]	H2 [mm]
SQC-MB-62.9x18-M12-AG	63	M12-M	18	53	25

Type	D [mm]	H [mm]	H1 [mm]
ABDK 68x12 SQC	68	12	28