

9KG LARGE CAPACITY DRYERS

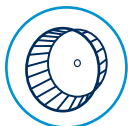

MDE20 AND MDG20



TURBOVENT® SYSTEM

- A high-speed blower wheel optimizes performance in long vents
- High airflow helps reduce drying times for a wide variety of loads
- Helps to increase efficiency and increase the life of the machine



CONTROLS TO MEET YOUR NEEDS

- Mechanical controls provide a simple user interface with robust, easy-to-use knobs
- Get flexibility and individual cycle pricing options for optimal earnings through Intelligent Controls with M-Series Technology, while end users can easily choose their preferred wash experience with one-touch cycle selection



LARGE CAPACITY

- 9kg capacity dryer helps allow for large loads to be dried efficiently and effectively
- Delivers an optimal drying experience for users and helps maximize productivity



BUILT TO LAST

- Porcelain enamel top — a durable finish that stands up to the demands of high-traffic
- Full wrap console — designed to help protect the internal components
- Front-panel accessibility — provides fast entry to internal components for streamlined self-service
- Extra-large reversible door — provides users unhindered access while loading and unloading



CARD READER COMPATIBLE

- Order your new washer as Card Only to prevent vandalism and increase safety on site.
- Never have to worry about where the gold coins from your laundry end up with real time reporting and payment deposited straight into your nominated bank account.



COIN DROP EQUIPPED

MDE20PD (pictured)
Also available in gas



NON-COIN

MDE20MN (pictured)
Also available in gas

Single-Load Top-Load MATCHING Dryer Models - 50 Hz

Payment Configuration	Electric	Gas
Coin Drop or Card Reader Ready	MDE20PD	MDG20PD
Non-Coin	MDE20MN	MDG20MN



See maytagcommerciallaundry.com for warranty details.

9KG LARGE CAPACITY DRYERS



MDE20 AND MDG20

SIDE VIEW

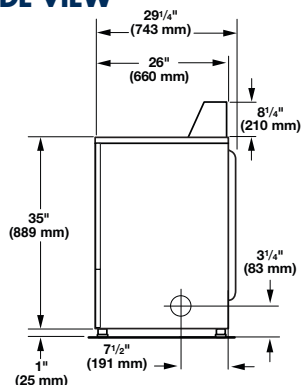

BACK VIEW

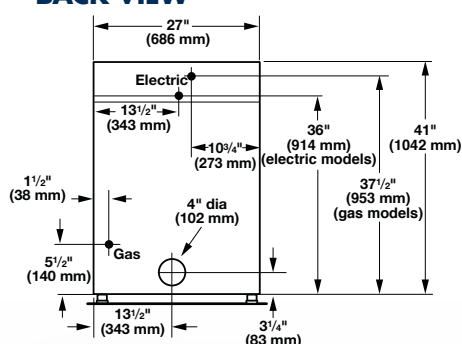

Maximum EXHAUST DUCT length PER NUMBER OF TURNS

Rigid Metal Vent

Box Hood and
Louvered Style

Angled Hood Style

No. of
90° Turns



0	64 ft. (19.5 m)	58 ft. (17.7 m)
1	54 ft. (16.5 m)	48 ft. (14.6 m)
2	44 ft. (13.4 m)	38 ft. (11.6 m)
3	35 ft. (10.7 m)	29 ft. (8.8 m)
4	27 ft. (8.2 m)	21 ft. (6.4 m)



*Includes height of metercase.

**Based on 2018 United States DOE J2 Testing with factory preset cycles.

Dimensions are for planning purposes only. See specific instructions for proper installation. Because of continuous product improvement, Maytag reserves the right to change specifications without notice.

MODELS		
COIN DROP / CARD READY COIN SLIDE NON-VEND	MDE20PD MDE20MN	MDG20PD MDG20MN
Fuel Type	Electric	Gas
CAPACITY		
Cylinder Volume — liters	210	210
Cylinder Diameter — mm	667	667
Cylinder Depth — mm	590	590
DIMENSIONS		
Width — mm	686	686
Depth — mm	743	743
Height — mm	1,092*	1,092*
Door Opening — mm	514	514
Exhaust Duct Diameter — in. (mm)	4 (101.6)**	4 (101.6)**
CRATED DIMENSIONS		
Crated Width — mm	731	731
Crated Depth — mm	782	782
Crated Height — mm	1,134	1,134
APPROXIMATE WEIGHT		
Uncrated — kg Coin Drop & Card Ready Models	56.7	64.4
Uncrated — kg Non-Coin Models	52.2	57.6
Crated — kg Coin Drop & Card Ready Models	61.2	68.9
Crated — kg Non-Coin Models	56.7	62.1
ELECTRICAL REQUIREMENTS		
Voltage	220-240V - 50Hz	220-240V - 50Hz
Breaker/Fuse — amps	25	10
Airflow — CFM (CMM)	215 (6.10)	230 (6.50)
Electric Heating Element (watts)	4,600	N/A
Gas Rating — BTU/hr (kcal/hr)	N/A	20,000 (5,040)
Gas Inlet Size — in.	N/A	3/8 N.P.T.
Motor Size — HP (kW)	1/3 (.25)	1/3 (.25)



DEPENDABLE
LAUNDRY SOLUTIONS

For more information visit dependablelaundry.com.au or call **1800 629 824**