



Technology made with passion

EdgeBreaker® 6000

Flexible all-rounder for any type of laser cut and punched parts.

EdgeBreaker® 6000

ARKU

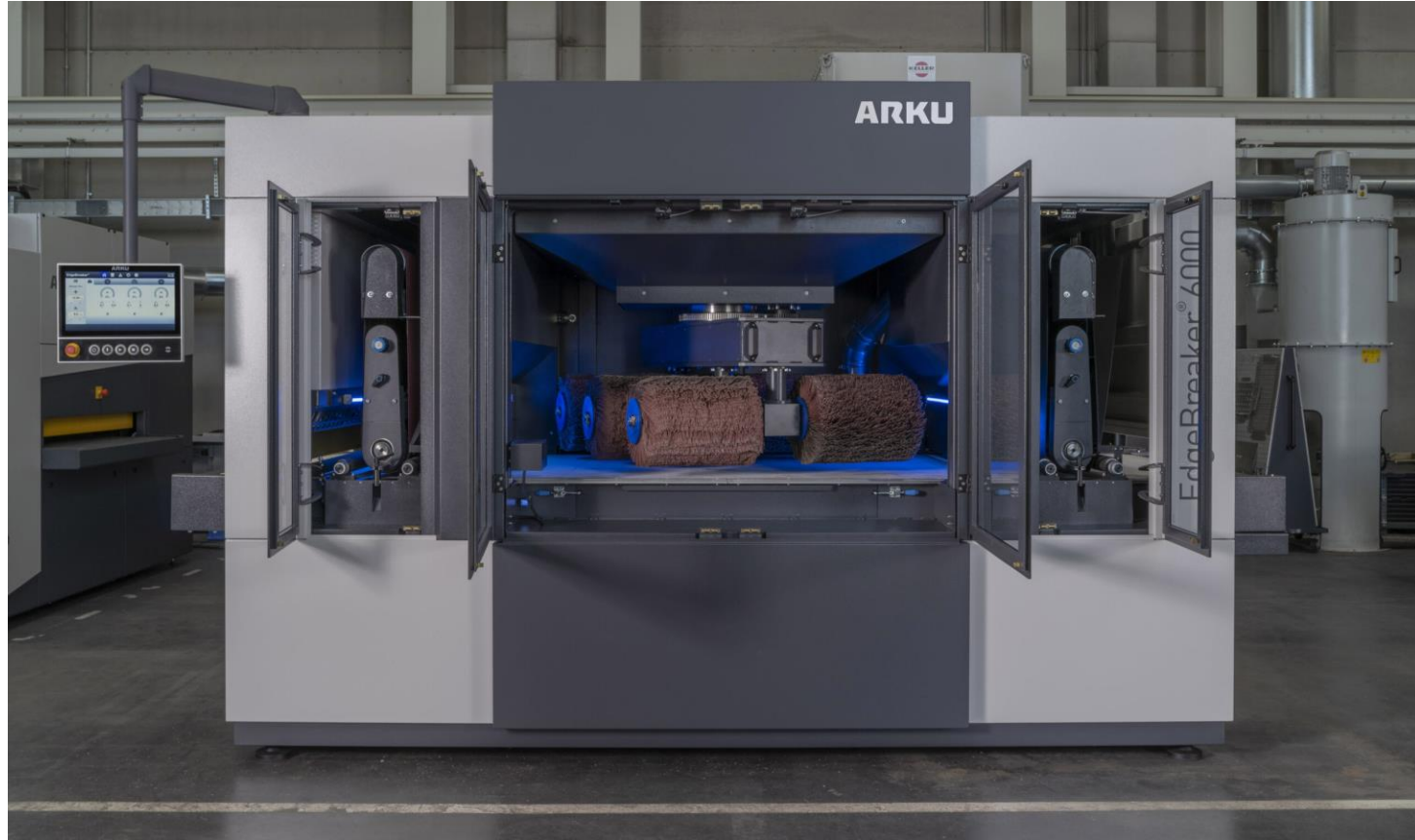

EdgeBreaker® 6000: 3 processing units

ARKU

Grinding unit

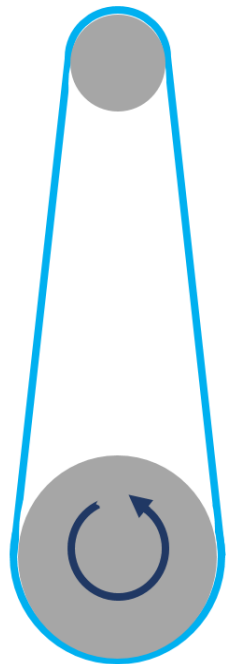

8 rotor bushes

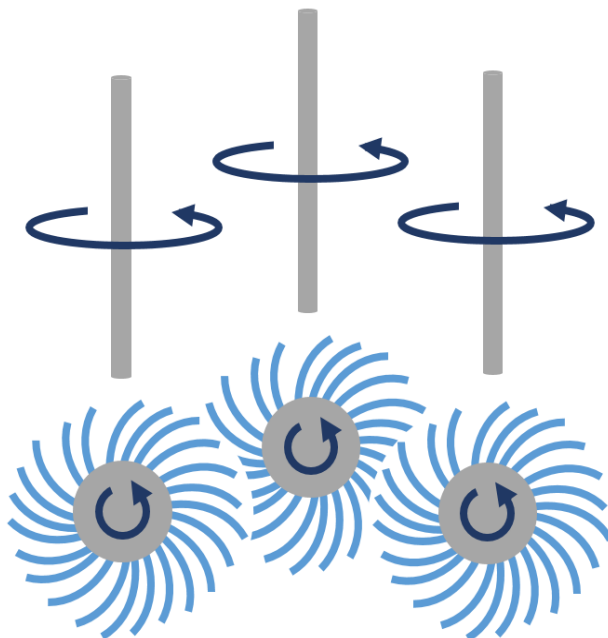

finishing unit

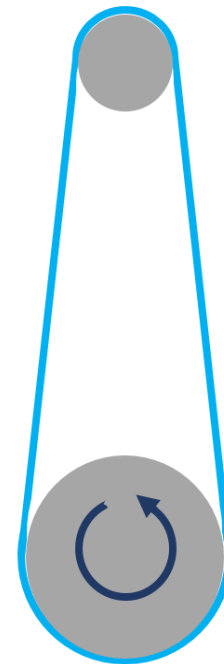

1. Grinding unit: Removing of the burr

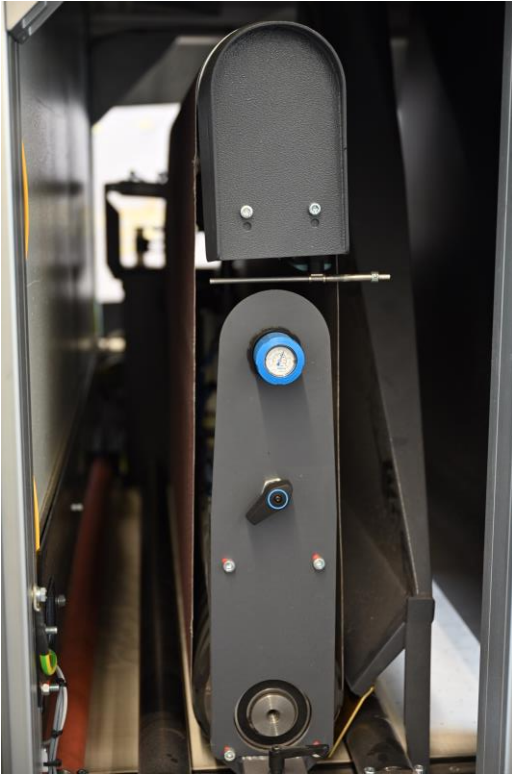

- Burr removal from the top
- Different abrasives for various parts requirements
- Quick and easy to change
- Pressure roller (protection against damage due to misadjustment)

1. Before and after grinding

ARKU



2. 8 rotor brushes: rounding of the edges



- Uniform edge rounding of all edges
- 8 brushes which rotate in opposite directions
- Best possible edge rounding up to 2 mm radius!

2. Before and after rounding

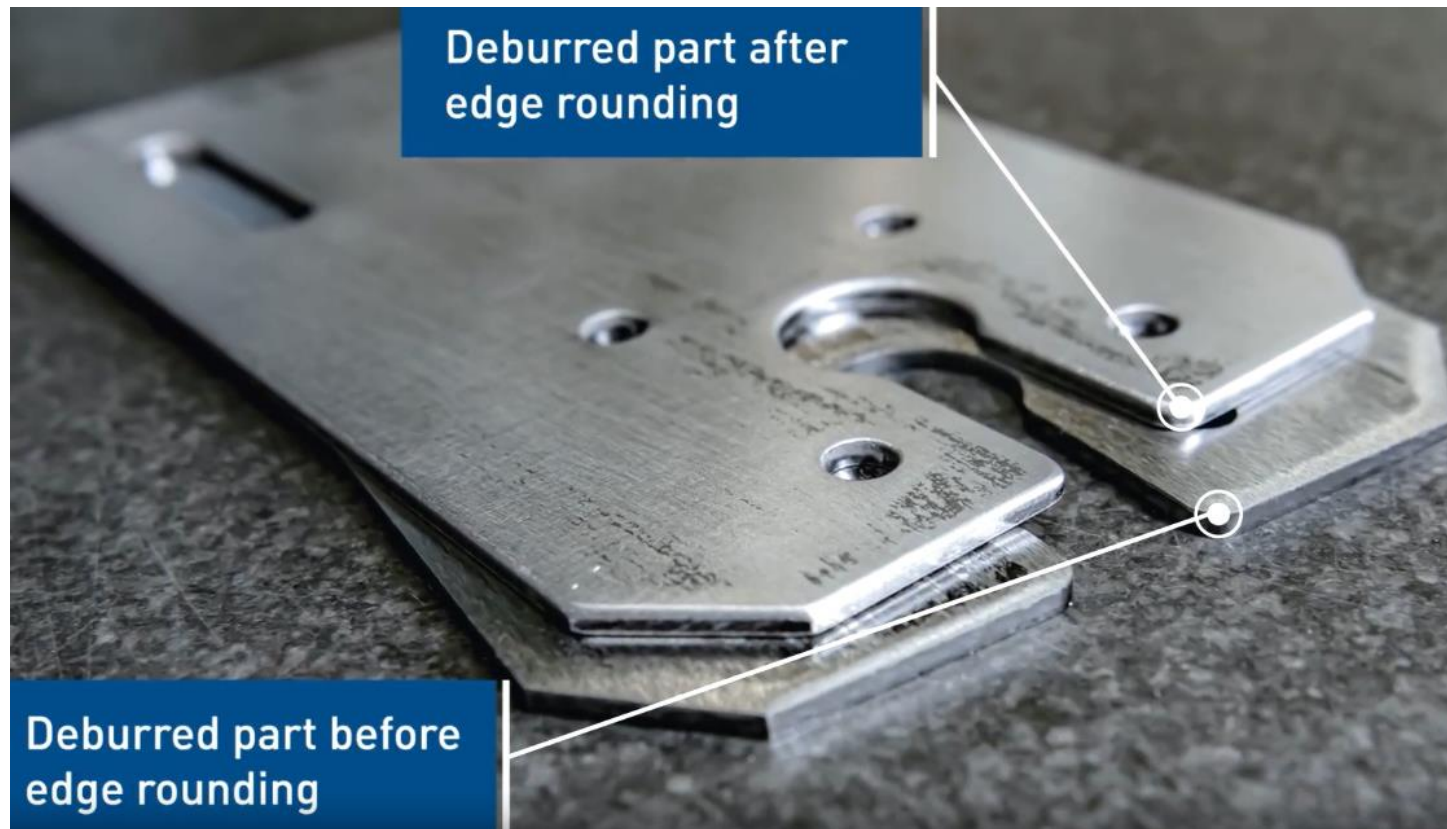

3. Finishing unit: high quality finish

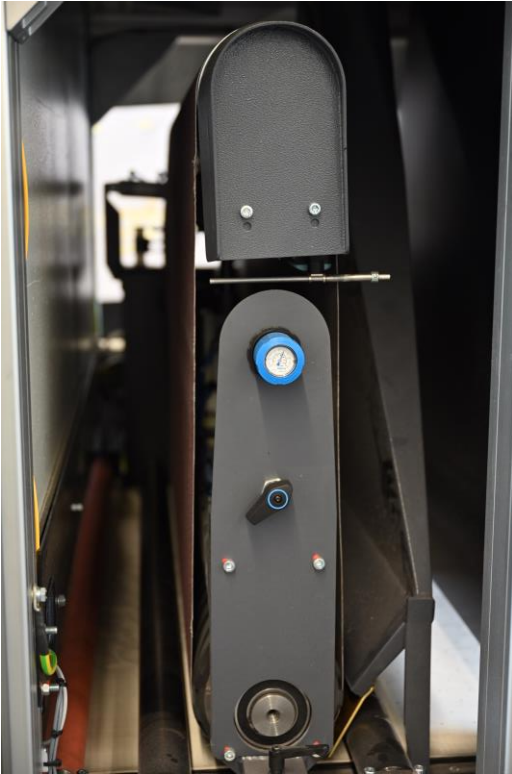

- A high quality finish and uniform result from the top
- Different abrasives for various parts requirements
- Quick and easy to change

3. Before and after finishing



Intuitive touch display

ARKU

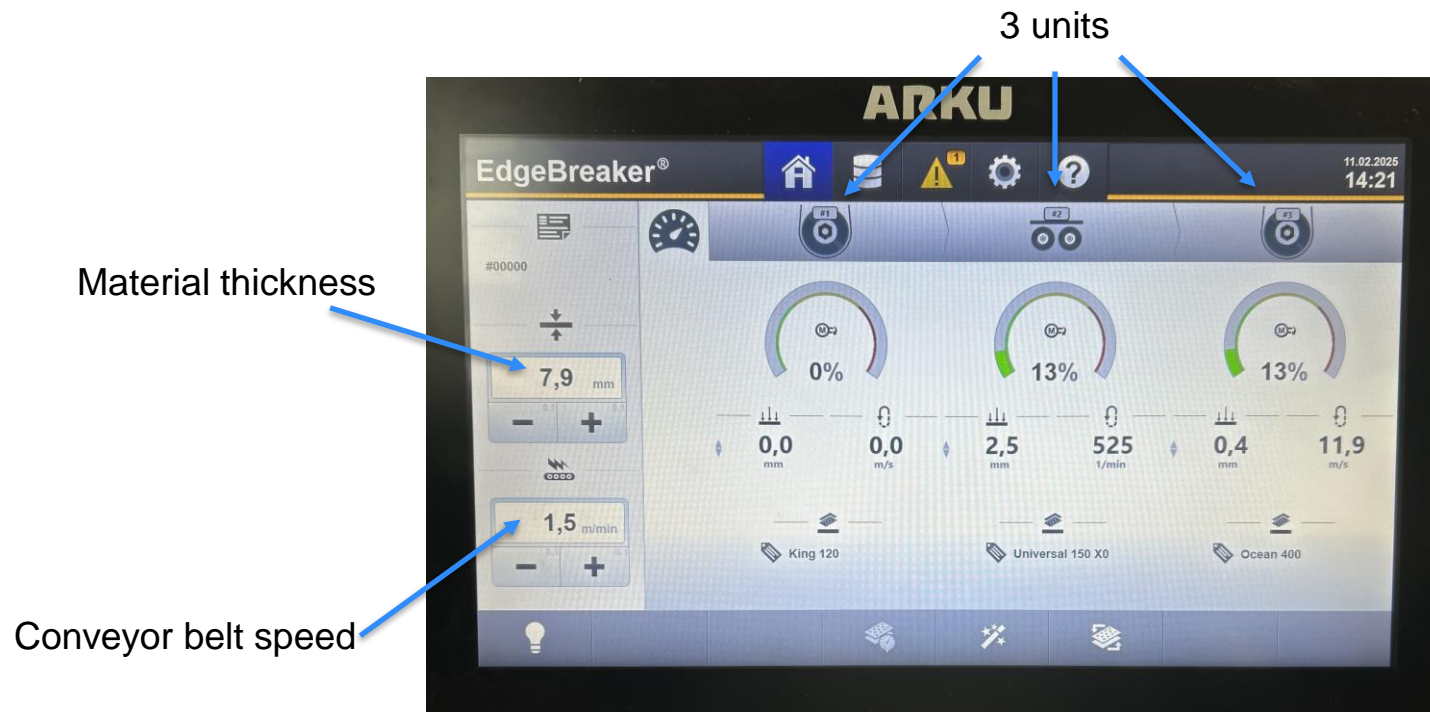

What advantages does the EB 6000 offer

- Easy tool change, rotor brushes are secured by a split pin
- Material thickness control
- Easy cleaning of the machine
- Easy cleaning from vacuum table
- Wizard automatic setting of machining parameters
- Wear compensation, measurement of the rotor
- Optimal vacuum performance
- Sweeping unit for the conveyor belt
- Drawer at the end of the conveyor belt for collecting debris
- Industry 4.0 prepared
- Table height is fixed, aggregates adjust, easy adjustment of aggregates

EdgeBreaker® 6000	
Processing:	single-sided, dry
Max. passageway width:	1.300 mm
Min. part dimensions:	50 x 50 mm
Optimal material thickness:	up to 25 mm
Max. part weight:	150 kg/m
Feed rate:	0,2 to 8 m/min
Machine weight:	6.500 kg
Dimensions:	2.100 x 4.200 x 2.350 mm