

# AGILA

7470PJC150P30-13

EAN 4031582349702

Swivel castor, housing made of Stainless Steel, double ball bearing swivel head, wheel axle with nut, bolt hole. Wheel centre made of Polypropylene, Tread: TENTEprene (thermoplastic rubber), grey non-marking, with threadguards, precision ball bearing, stainless



BETTER MOBILITY. BETTER LIFE.



Picture may differ from original product

## Technical Data

Wheel diameter	150 mm
Width of Tread	32 mm
Centre hole	13 mm
Offset	45 mm
Swivel Interference	240 mm
Overall height	183 mm
Temperature	- 20 / + 60 °C
Standard	EN 12530
Weight	0.8 kg
Swivel Radius	120 mm
Hardness of tread	Shore A 87
Load capacity	100 kg
Load capacity (static)	200 kg

## Advantages at a glance

Roll performance	● ● ● ○ ○
Movement noise	● ● ● ○ ○
Attrition	● ● ● ○ ○
Corrosion resistance	● ● ● ● ●

## Dimensions

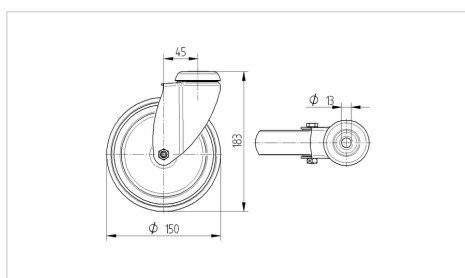

## Structure & Mounting

