



EISENBLATTER

High tech grinding and polishing technique



First Class High Tech grinding and polishing equipment!

For stainless steel – steel – non-ferrous metals – wood

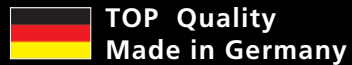

POLY-PTX® Professional Guide

User's guide

EISENBLÄTTER DEMONSTRATION CENTER



Imprint

Editorial work:

Gerd Eisenblätter GmbH
Jeschkenstraße 10
82538 Geretsried
GERMANY
Phone: +49 (81 71) 93 84 - 0
Fax: +49 (81 71) 93 84 - 55
E-mail: info@eisenblaetter.de

Photos and graphics:

P. 5 and 18: Dr. Stephan Barth/pixelio.de

All other photos and graphics:

Gerd Eisenblätter GmbH

Print:

Druckerei Schefenacker GmbH & Co KG

Subject to alterations



The Demonstration Center:

Already since February 2009 our demonstration center near Koblenz has been available to our customers and it is becoming increasingly popular: a growing number of customers are using the opportunity to have our technicians show their employees how to properly use Eisenblätter tools in **free and individually arranged instructions**. The result: thanks to the "first-hand information", following the product training your employees are able to **work** with our machines and tools in a **time-saving, economic and rational way**. The tips and information which you are given in our demonstration center help you to optimize your grinding and polishing technique from rough grinding to flawless mirror finish.

From now on our center is mobile and if required comes directly to you with the "Eisenblätter Bus"! This means you can have us train your employees on how to properly handle our products directly at your place.

Would you like to arrange an appointment with the Eisenblätter Demonstration Center?

Eisenblätter Demonstration Center · Alter Güterbahnhof · D-56656 Brohl-Lützing
Phone: 0151 / 22 67 29 - 60 oder -58 · E-Mail: demo@eisenblaetter.de

NEW



Dear customer,

Here you are receiving our new application guide, the "Professional Guide", for working with our new multi-functional grinder POLY-PTX® 800.

From professionals for professionals: in Eisenblätter's new "Professional Guides" we provide you with valuable tips and help for the effective, time-saving and cost-cutting use of our machines and tools. The application guides are sorted according to our products, so that you are presented with helpful application opportunities for every machine and many tools at a glance. The "Professional Guide" is conceived with a high-quality, large-format layout and appropriate look, and will serve you as a practice-oriented manual for your daily working schedule.

You will find out when you can order "Professional Guides" from Eisenblätter free of charge and without any obligations in our customer magazine, on our homepage and for the first time on our Facebook website! Naturally you can also phone us any time to ask about our new application guide.

Do you have a tip for our application guide? Have you gained interesting experience with our machines and tools, which you would like to share with other artisans? Then write to us: the most interesting application tips will be published in our "Professional Guides" and in our customer magazine and will be rewarded with interesting material prizes!

Your Gerd Eisenblätter GmbH wishes you plenty of enjoyment reading our guide.



Table of contents for POLY-PTX® 800

• POLY-PTX® 800

- **POLY-PTX® 800 – an overview**
 - **TIP:** Ideal solution for professionals: the POLY-PTX® sets

• POLY-PTX® 800

- **Grinding out scratches. Creating industrial finish on flat surfaces**
 - **TIP:** Using the Eco Smart Adapter
 - **TIP:** Using the oscillation technology

• POLY-PTX® 800

- **Miter grinding with the INOX cover plate**
 - **TIP:** Using the Eco Smart Rollers
 - **TIP:** Removing adhesive residue with BRILLIANCE Clean

• POLY-PTX® 800

- **Perfect mirror finish on all even surfaces made of INOX and non-ferrous metals**
 - **TIP:** Effective grinding with Trizact™ sleeves

• POLY-PTX® 800

- **Deburring perforated sheet**
 - **TIP:** Using inflatable expansion rolle
 - **TIP:** POLY-PTX® accumulator 28V

• POLY-PTX® 800

- **Removing paints**
 - **TIP:** Oversized fleece wheels for more effective grinding



SURFACE **METAL**

SURFACE **METAL**
SQUARE TUBE

SURFACE **METAL**

SURFACE **METAL**

SURFACE **METAL**
WOOD

Page

6

8

10

12

14

16

Table of contents for POLY-PTX® 800

• POLY-PTX® 800

- Grinding out scratches and creating industrial finish on round pipes
 - TIP: Correct use of spacing rings, safety guard and grinding belt
 - TIP: Belt with buttonhole fastening system

• POLY-PTX® 800

- Mirror finish on open and closed round pipes
 - TIP: Belt with special adhesive tape
 - TIP: Grinding belt roller with M14 thread for speed-controlled angle grinder

• POLY-PTX® 800

- Cleaning and care products

• POLY-PTX® 800

- Wood working
 - TIP: Using the POLY-PTX® 800 suction cover

• POLY-PTX® 800

- Overview of POLY-PTX® accessories and tools



PIPE

METAL



18



PIPE

METAL



20



METAL

22



SURFACE

WOOD



24



26

Overview of all the advantages of POLY-PTX®



Quintuple swiveling handle for right and left-handers. Vibration-reduced handle for fatigue-free work.



Convenient speed regulation during operation with speedometer generator for constant speed also under load.



QUICK-LOCK cable quick connection for fast convenient change (cable damage, machine change, etc.).



Dustproof field coil through special coating.



Infinitely variable swiveling safety guard with possibility of attaching new suction cover.



Removable polycarbonate safety guard for grinding roller widths of up to 150 mm.



Eco Smart adapter for roller widths of up to 150 mm and vibration-free operation (optional).



Exclusively at Eisenblätter: Rubberized handle for optimum and anti-slip handling.



Technical data	
Mains connection	220 V ~ 50 – 60 Hz (Alternatively 110 V ~ 50 – 60 Hz)
Rating	1,750 watts
Speed	Infinitely adjustable from 1,000 to 3,500 rpm, with tachometer generator for constant speed even under load
Speed controller	With fine adjustment to ensure abrasives are used at optimum efficiency
Grinding width	up to 100 mm (with Eco Smart 150 mm)
Roller diameter	up to 115 mm
Weight	3,3 kg
Toolholder	19 mm spline (optional Eco Smart fitting with Eco Smart adapter)

1,750 watts
For professional use!

1,750 watts: The POLY-PTX® 800 sets new standards! High torque and enormous power reserves guarantee professional continuous operation and greater efficiency.



POLY-PTX® Professional Complete Set



POLY-PTX® Basic Set Metal Working



POLY-PTX® Wood Working Set

Application	Surface	Pipes
Smoothing weld seams	✓	✓
Rough grinding	✓	✓
Removing scratches	✓	✓
Fine grinding	✓	✓
Satin finishing, matt finishing	✓	✓
Industrial finish	✓	✓
High-gloss finish	✓	✓
Mirror finish	✓	✓
Sealing surface	✓	✓

Application	Surface	Pipes
Smoothing weld seams	✓	✓
Rough grinding	✓	✓
Removing scratches	✓	✓
Fine grinding	✓	✓
Satin finishing, matt finishing	✓	✓
Industrial finish	✓	✓
High-gloss finish	✗	✗
Mirror finish	✗	✗
Sealing surface	✗	✗

Application	Hard wood	Soft wood
Rustic effect	✓	✓
Brushing out annual rings	✓	✓
Polishing impregnated surfaces	✓	✓
Pore-deep dust removal	✓	✓
Dust-free working (suction cover)	✓	✓

Ideal solution for professionals: The POLY-PTX® Sets



With the POLY-PTX® Sets you always have the right tool at hand – in the workshop and during outdoor work. Apart from this you also save considerably compared to buying the tools individually.

For metal working

■ **Complete professional set for rough grinding right through to mirror finish on surfaces and pipes**

This set, including additional Eco Smart adapter in the practical, stable and shock-resistant transport case contains everything for shadowless industrial finish right through to mirror finish on metals (surfaces and pipes) as well as the newly developed cleaning and preservation agents for optimal surface protection against stains and fingerprints.

■ **Basic set for rough grinding right through to perfect industrial finish on surfaces and pipes**

Basic set, including Eco Smart adapter for rough grinding, industrial finish and fine grinding on surfaces and pipes.

For wood working

■ **Set for wood working from rustic to polished**

The complete set for processing wood surfaces: POLY-PTX® 800, an assortment of different brush wheels for different wood structures from rustic to polishing impregnated surfaces and a suction cover sucking away grinding dust.



Save time!

Effortless tool change with the optional POLY-PTX® ECO SMART ADAPTER:

Simply push the Eco Smart adapter onto the splined shaft and screw on the appropriate ECO SMART tool. For all 19 mm drive shafts.



POLY-PTX® 800

Removing scratches, smoothing weld seams and creating industrial finish (satinized, matted or brushed)

For producing stainless steel containers, switch cabinets or stainless steel furniture usually panels with a so-called industrial finish are used. The production process involves welding, bending, drilling, etc. Scratches can therefore be hardly avoided, and these then have to be removed.

Rough grinding

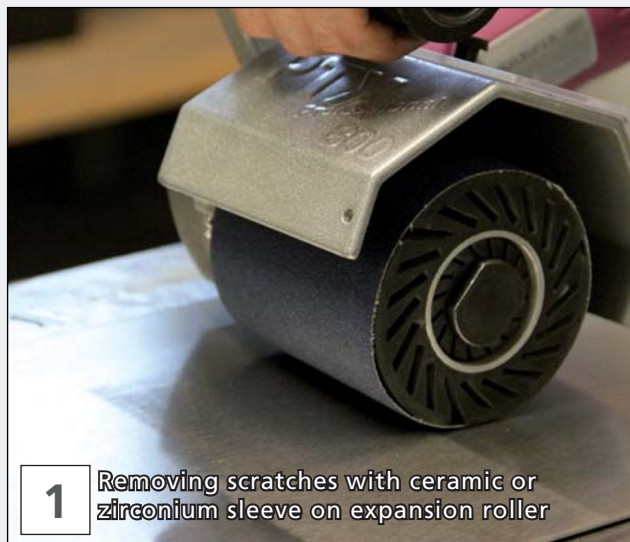

Careful removing of scratches with POLY-PTX® zirconium sleeve K80. In the case of very deep scratches on stainless steel we recommend the ceramic sleeve grit 60.

(Larger welding seams are flattened in advance with flap disks).



Ceramic sleeve

Available grit sizes:
40, 60, 80, 120



Zirconium sleeve

Available grit sizes:
24, 36, 40, 60, 80, 120, 150, 180

Intermediate grinding

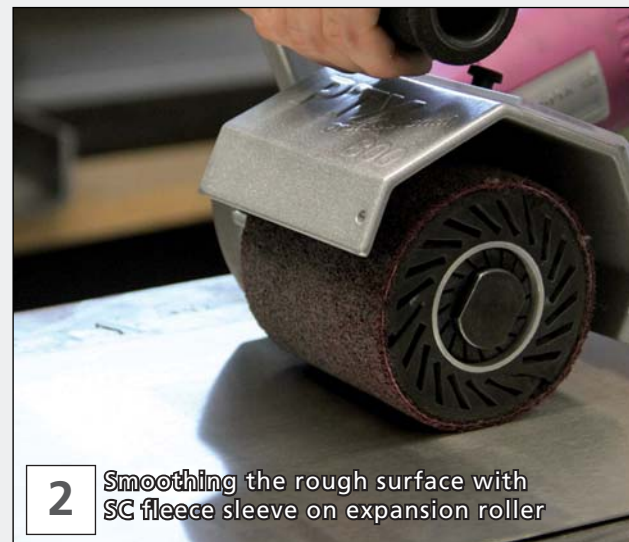

In the next working step the POLY-PTX® SC fleece sleeve (grit size: medium) is used for smoothing the surface roughened by the zirconium sleeve.



Available grit sizes:
rough, medium, fine, super fine

Smoothing

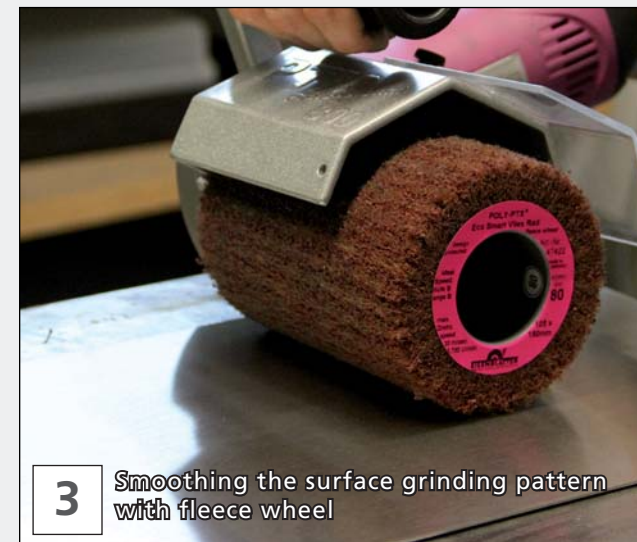

Subsequently the entire surface is reworked through oscillation with the POLY-PTX® fleece wheel (grit 80).



Oscillation technique:

Through short forward and backward movements in a longitudinal direction and at the same time shifting to the side you achieve seamless, decorative surfaces (industrial finish).

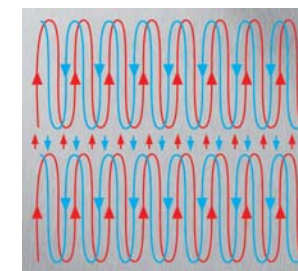

Available grit sizes:
60, 80, 180, 280, 400, 600, 900



Simple tensioning of the Eco Smart rollers in any position on the shaft.



Thanks to the extra length of the 150 mm wide roller, working directly on the inner edges is also no problem.

SQUARE TUBE

METAL

SURFACE

METAL

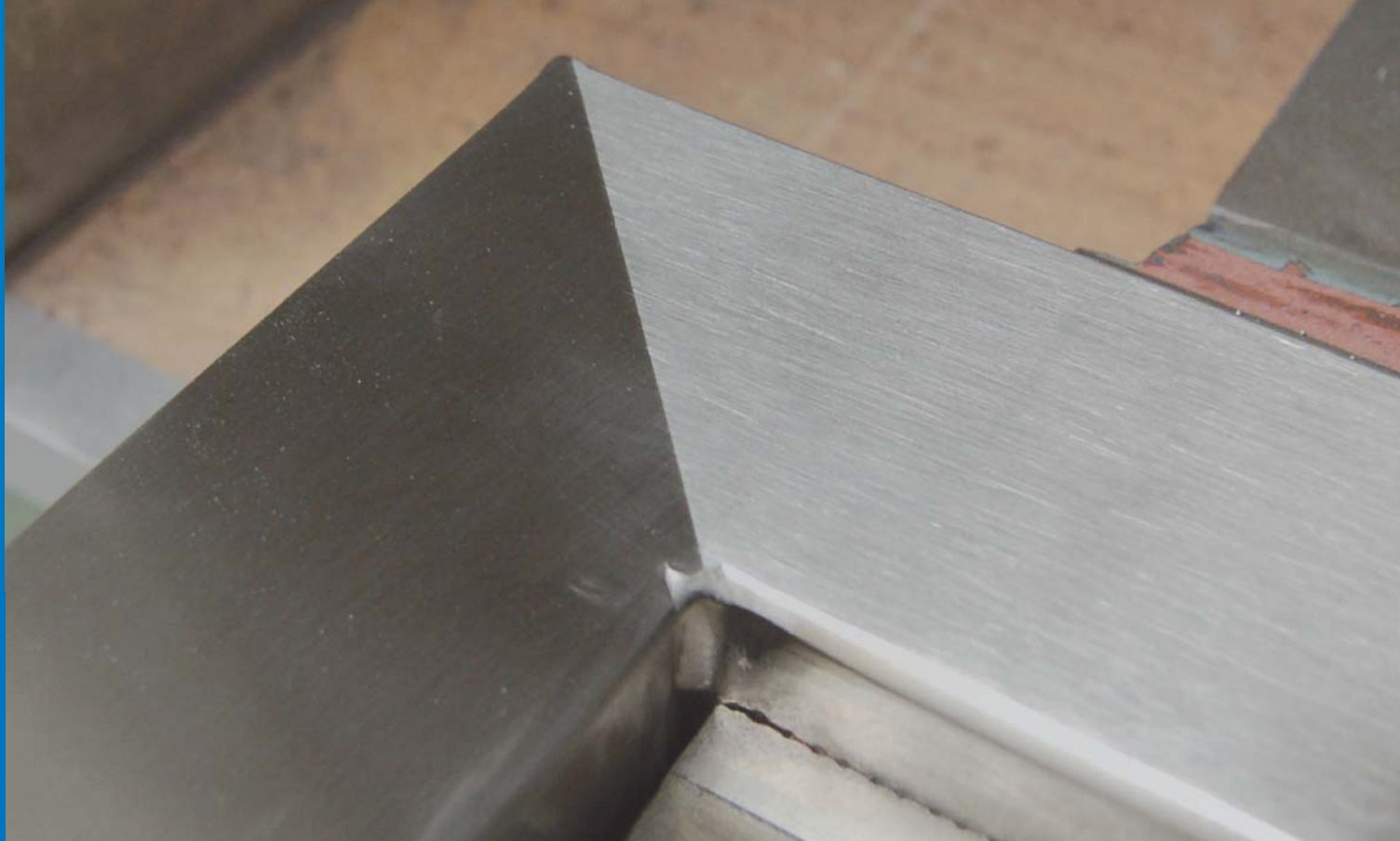

POLY-PTX® 800

Miter grinding on the frame construction with the INOX cover plate (picture frame effect)

Particularly in railing construction, elevator construction and in framework construction terms, which must have a clean transition with each other to ensure an optically perfect result.



Masking



Pull out required length from roll dispenser and cut off with scissors. Then pull off the protective paper and place the self-adhesive cover plate slightly offset in the required angle. In the case of round tubes press onto the curvature.



Because of the round form of the grinding tools and the thickness of the cover plate the cover plate has to be stuck on slightly offset.

Grinding 1st side



Completely work the surface which has not been masked until the required surface finish has been achieved. In doing so always grind beyond the edge of the cover plate. In the case of rough pre-grinding, carefully grind over the edge, in order to avoid grinding through the thin cover plate.

Miter grinding



Remove cover plate and attach slightly offset masking on the side where grinding has been completed with the undamaged edge (if necessary, use new sections of cover plate).

Now, as in step 2, work the area which has been masked.



In the case of unusually high heat development adhesive residue may remain on the workpiece. This can be easily and quickly removed using Eisenblätter's BRILLIANCE Clean.



Fast and cost-effective working with Trizact™

Thanks to its pyramid-shaped structure, the Trizact™ grinding cloth enables a high material removal and at the same time a very fine grinding surface pattern. When you are grinding with Trizact™ sleeves only work with limited pressure: The weight of the grinding machine is generally sufficient, because otherwise the tips of the pyramids would break off and considerably reduce the working life.

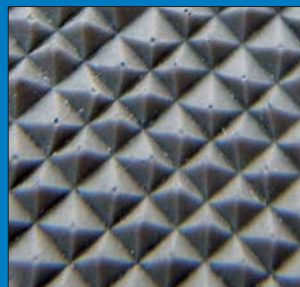

Mirror finish polishing of uneven areas

In practice for uneven surfaces the following rings have proved themselves to be most effective: medium high-gloss rings for stainless steel for the main polishing with pastes, soft high-gloss rings for the final polishing with polishing cream and cotton rings for non-ferrous metals. These rings optimally adapt to the contours of the workpiece surface.



POLY-PTX® 800

Perfect mirror finish on INOX and non-ferrous metals

In today's age it is becoming increasingly important to achieve a perfect result with a mirror finish, for instance in public sanitary areas as a mirror, in luxury façade construction, in shipyards (yachts) and in the medical industry (installations and fittings for operations).

The ideal solution for level surfaces:
POLY-PTX® 800 in combination with Trizact™ and SuperPolish.

Perfect mirror finish on all level surfaces made of INOX and non-ferrous metals

Pre grinding



With rough Trizact™ sleeve (depending on surface: A160, A100, A65) careful removal of scratches and rolling skin. We recommend the ceramic sleeve K60 and the zirconium sleeve K60 for very deep scratches on stainless steel.

(Larger weld seams are smoothed out in advance with flap disks).

Intermediate grinding



Now the workpiece is ground with the different grits of Trizact™ sleeves from A45 to A16.

It is essential to also grind laterally and diagonally to the working direction, so that the surface is evenly "removed" and a plane "polishing level" is created.

Polishing



It is then polished using the SuperPolish sleeve and white polishing paste (prepolishing), then the next polishing step with the SuperPolish sleeve and blue polishing paste (re-polishing).

IMPORTANT: Do not mix different pastes. Spread the pastes and the cream on sleeve or rings (not on the workpiece).

Removing paste residue



After each polishing step put POLY lime on the paste residue (simply sprinkle it), and carefully wipe it off the surface of the workpiece with a clean microfiber cloth.

Final polishing



The subsequent mirror finish polishing is now carried out with the SuperPolish sleeve and pink polishing cream. This polishing must only be carried out in one direction.

If any minor streaks should still appear because of the material used, these are removed using high-gloss rings (soft) and pink polishing cream.



Ceramic sleeve



Zirconium sleeve



Trizact™

Available grit sizes:

Comparison table for Trizact™ grit							
Trizact™ grit	A160	A100	A65	A45	A30	A16	A06
Surface finish corresponds with grit	120	220	320	400	600	1.200	2.000
Material removal corresponds approximately with grit	24	36	40	50	60	80	120





**The inflatable expansion roller:
pinpoint accuracy for best results.**

For the individual "hardness setting" of the respective zirconium, SC fleece, Trizact™, SuperPolish and felt sleeves we recommend the inflatable, particularly adaptable expansion roller. It is particularly suitable for deburring on perforated sheet and for grinding surfaces and edges in all places where work has to be carried out with pinpoint precision.

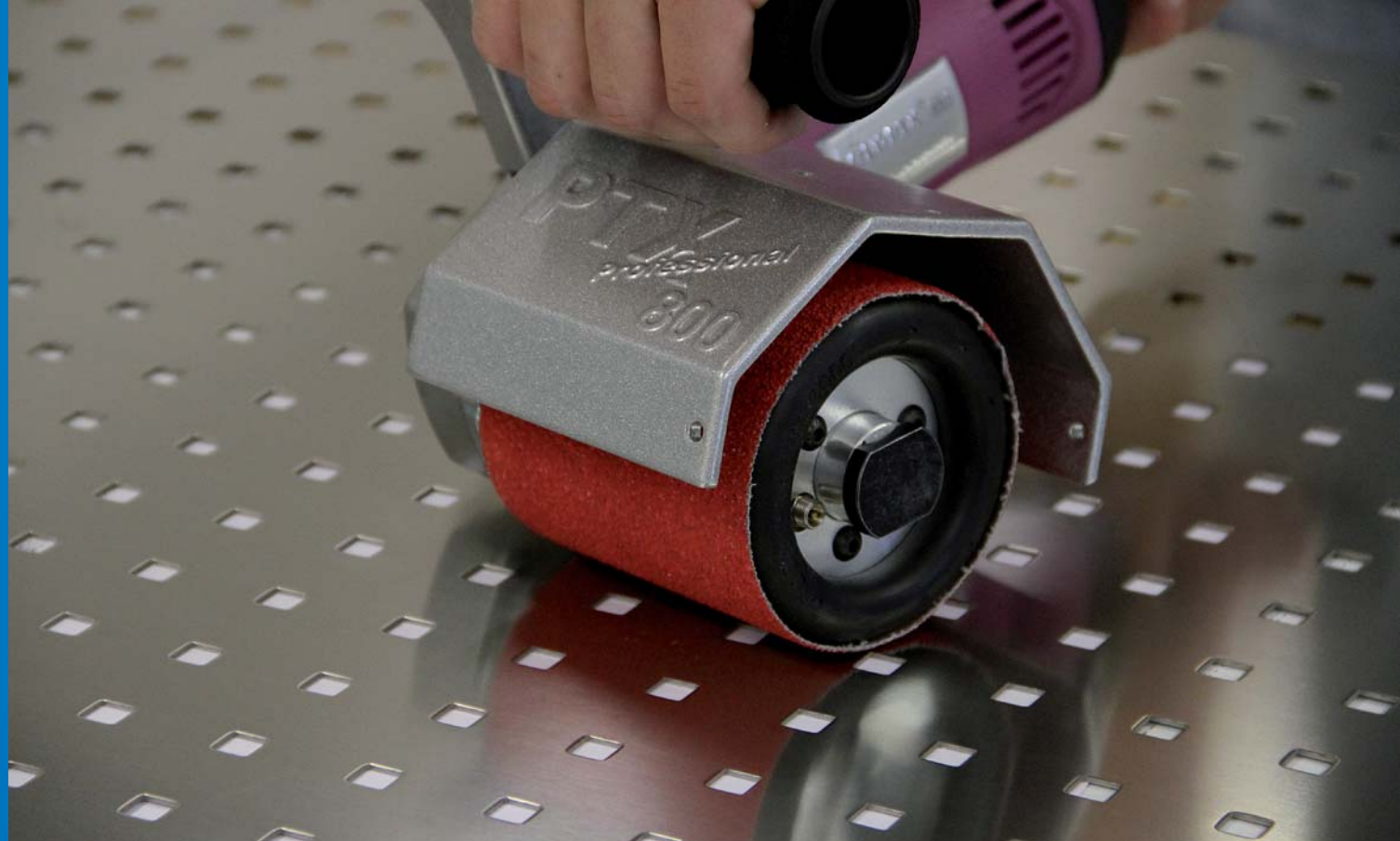

POLY-PTX® 800

Deburring on perforated sheet

Particularly when building individual switch cabinets (for instance in the case of circuit boards) after the punching process the burrs have to be processed in such a way that a clean, non-rounded edge is formed.

(optional)

Preliminary work

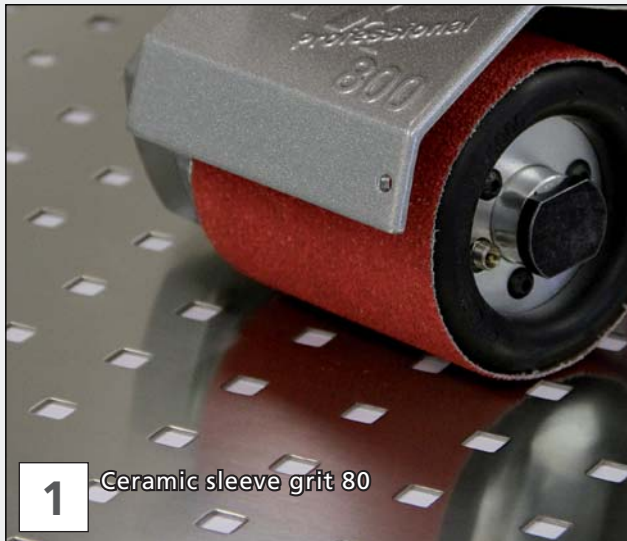

1 Ceramic sleeve grit 80

Deburring



2 VLIES-TOP wheel grit 80

Large burrs and deep scratches are removed in advance, using the POLY-PTX® zirconium sleeve or ceramic sleeve and hard inflated expansion roller.

The POLY-PTX® VLIES-TOP wheel or MIX (combi) wheel (for light rounding of holes) are used for actually removing burrs. Since this wheel is compressed with PUR foam and therefore has a particularly hard contact surface, clean, non-rounded edges are created.



Ceramic sleeve

Available grit sizes:
80, 180, 280, 400, 600, 900



VLIES-TOP wheel

Available grit sizes:
80, 180, 280, 400, 600, 900



MIX (combi) wheel

Available grit sizes:
60, 80, 180

For mobile, wireless use!

POLY-PTX® accumulator 28V



Surface grinding and polishing



Two 28 V, 3.0 Ah rechargeable batteries in the basic set. This means a fully charged battery is always available.



Quick charging device for the batteries. Charging time only 30 to 40 minutes.



Quintuple swiveling handle for right and left-handers. Vibration-reduced handle for fatigue-free work.



The battery can be quickly changed and is positioned so that the tool fits well-balanced in the user's hand.



Battery capacity LED display



**Grinding into every corner
with the extra length
system**



FLEECE wheels 115 x 100 mm K80+K180 and CLEAN wheel 115 x 100 mm are supplied in extra width (110 mm) and fit onto all standard drive shafts (100 mm). This enables approx. 20 % better performance. The clamping nut is completely countersunk in the extension.

ADVANTAGE: grinding is possible right into the corners without any problems.

WOOD

SURFACE

METAL



POLY-PTX® 800

Removing paints

The right solution for every material:

No matter whether there is paint, lacquer, etc. on stainless steel, steel, non-ferrous metals or wood – this can be removed, leaving no residue, using the right grinding roller.

Thick layer of paint

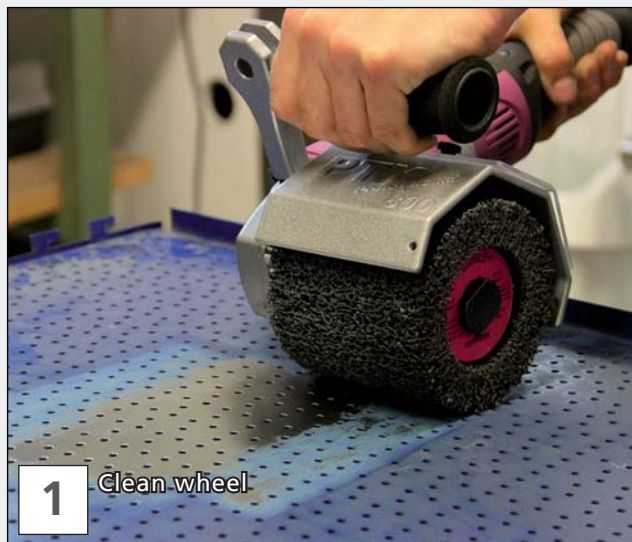

Particularly well-proven for removing thick or obstinate layers of lacquer and paint on wood, stone and metal (for instance, window frames, doors, furniture, house façades, railings, fences, machines, boat hulls and propellers) and for removing graffiti. Ideal for body manufacturing (no grinding through thin panels) as well as for renovation, painting and construction work. Does not contain any metals, so there is no danger of corrosion.

Cleans without removing any material from the workpiece and without damaging the basic material (sandblast effect).



Thin layer of paint



Removes thin layers of paint and lacquer and at the same time leaves a structured surface. Particular when working wood the fibers are additionally smoothed, enabling the workpiece to be immediately repainted – completely without any additional pretreatment and loss of time. For removing a more persistent layer we recommend the use of the MIX (combi) wheel.



SC-fleece sleeve



MIX (combi) wheel

Available grit sizes:
rough, medium, fine, super fine

Tarnishes



Tarnishing and heart tinting can be very easily removed with the polishing cream and a suitable carrier material (felt, SuperPolish or polishing rings) without leaving any residue. Cream residue can be removed as usual by using POLY lime and a microfiber cloth.





Basics – correct handling

Correct use of safety guard and grinding belt



For safety at work and perfect grinding:
Set up the safety guard as shown in the illustration,
and keep the belt tensioned during grinding.

Spacing rings

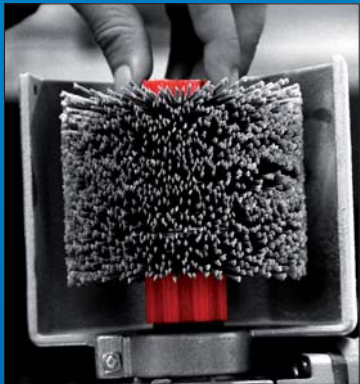

The Eisenblätter spacing rings enable narrower wheels, brushes, rollers, polishing rings and the grinding belt roller with the INOX edge to also be used in combination with the POLY-PTX® 800:
The spacing rings ensure a width compensation of up to 50 mm.



POLY-PTX® 800

Removing scratches, smoothing welding edges and creating industrial finish (satinized, matted or brushed)

Whether on railings, ship railings, stands or other constructions made of round pipes: everywhere these have to be welded, bent and screwed, and yet an even surface finish still has to be achieved.

Rough grinding



Careful removal of scratches and weld seams with POLY-PTX® pure corundum grinding belt grit 80. For very deep scratches on stainless steel we recommend K40 as pre grinding.

(Larger weld seams are leveled in advance with highly elastic grinding disks such as Eisenblätter's FIX-KLETT).

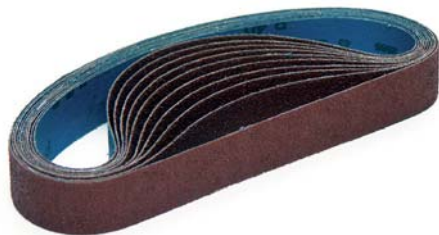

Available grits:
40, 60, 80, 120

Leveling (fine grinding)

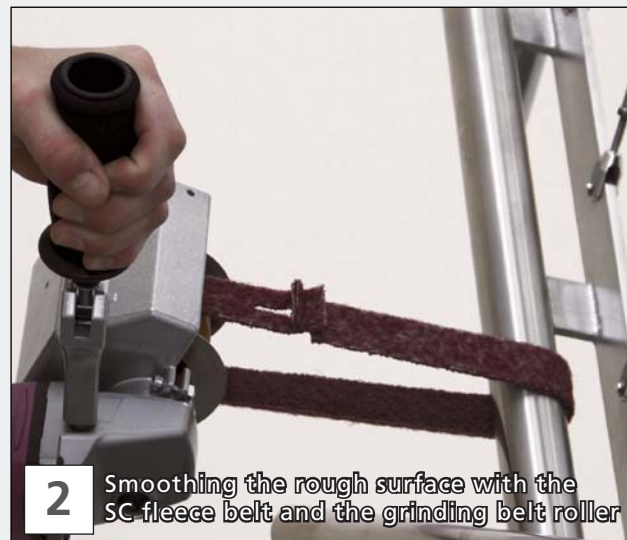

In the next working step the POLY-PTX® SC fleece belt is subsequently used for smoothing the surface which was roughened by the pure corundum grinding belt grit.



Available grits:
rough, medium, fine, super-fine

Grinding on closed pipe constructions



Buttonhole fastening system

The SC fleece and felt belts with the patented "buttonhole fastening system" are ideal for working on closed pipe constructions and handrails. Thanks to the "buttonhole fastening system", the grinding belt placed over the pipe is quickly connected and also opened again. This makes changing the grinding belt rational and child's play. It can be opened and closed as often as required.



Grinding on closed pipe constructions



Special adhesive tape

Closed grinding belts, such as the grinding belt or the Trizact™ belt are cut open for working on closed pipe constructions, placed over the pipe and stuck overlapping (approx. 370°) around the whole length of the grinding belt with our special adhesive tape.



POLY-PTX® 800

Mirror finish on open and closed round pipe constructions

Mirror finish provides an aura of warmth and luxury – whether in railing construction or in the automobile industry: In an increasing number of areas an optimal mirror finish has to be achieved, including on pipes.

Perfect mirror finish on round pipes made of INOX and non-ferrous metals

Pre grinding

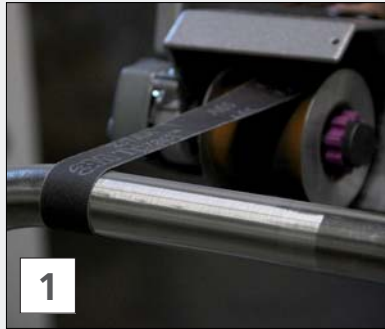

Using the rough Trizact™ belt (depending on surface: A100 or A65) for carefully removing scratches, weld seams and rolling skin. For working on closed pipe constructions the Trizact™ belt can be closed again with the adhesive tape.

Intermediate grinding

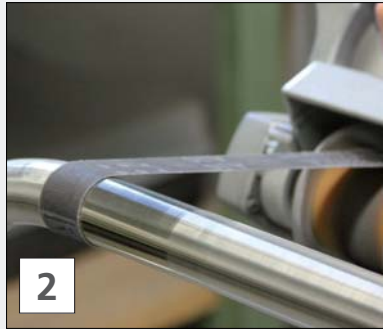

Now you grind step by step with the different grits of the Trizact™ belts from A45 to A16.

In the case of "poor" working material qualities these can be additionally reworked with grit A06.

Main polishing

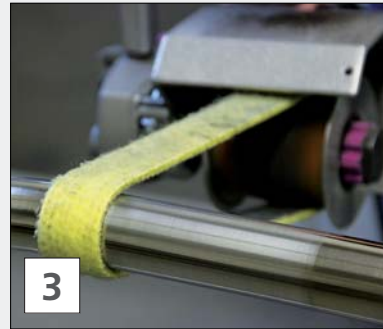

The workpiece is then polished using the SuperPolish belt and white polishing paste. Here, in contrast to level surfaces, the blue polishing paste is not used.

For closed pipe constructions a POLY-PTX® Merino felt belt with patented buttonhole fastening system is used.

Removing paste residue



After each polishing step remove the paste residue with POLY lime (simply sprinkle it on) and carefully wipe it from the surface of the workpiece with a clean microfiber cloth.

Final polishing

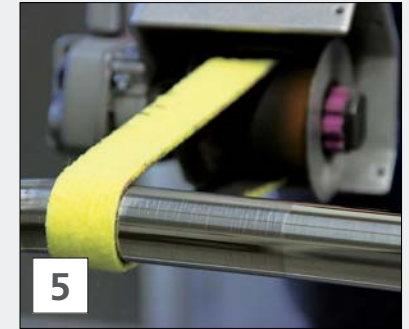

The subsequent mirror finish polishing is now carried out with a SuperPolish belt (or Merino felt belt) and pink polishing cream.



The grinding belt roller is also available with M14 screw thread for speed-controlled angle grinders (e.g. VARILEX®).



Available grits:

Comparison table for Trizact™ grit							
Trizact™ grit	A160	A100	A65	A45	A30	A16	A06
Surface finish corresponds with grit	120	220	320	400	600	1.200	2.000
Material removal corresponds approximately with grit	24	36	40	50	60	80	120





Cleaning and care products

Ideal for large kitchens, elevator and railing construction: wherever surfaces are subjected to severe conditions.

Grinded and polished surfaces are very sensitive to all types of dirt and therefore have to be carefully protected and maintained.

Cleaning



Finger prints, grinding dust, light soiling with oil and fat as well as adhesive residue can be easily removed without leaving any streaks through using BRILLIANCE Clean. Any residue immediately evaporates.



Protecting inside (dry)



Spray INOX Protect onto the surface, then rub it with a microfiber cloth, dry wipe it and briefly repolish it with the cloth. The surface is sealed by a dry, invisible protective film (hard wax). The protective effect lasts several weeks; polished surfaces do not darken.



Protecting outside (oil film)



For cleaning and preserving grinded and polished surfaces in outdoor areas. Fingerprints and water spots or shading remain invisible for a long time. The sealer can also be used in the food industry. The oil film slightly darkens the surface.



POLY-PTX® 800 suction cover

Ideal where a lot of dust is generated (e.g. aluminum working or wood working): The POLY-PTX® aluminum suction cover with centering knurled screws is compatible with all standard industrial vacuum cleaners. Can be used for up to 100 mm roller width.



POLY-PTX® 800

Wood working

Polishing impregnated wood surfaces, creating rough rustic effects or brushing out soft annual rings: for high quality wood working it is important to have the right tool.

Rough rustic effect

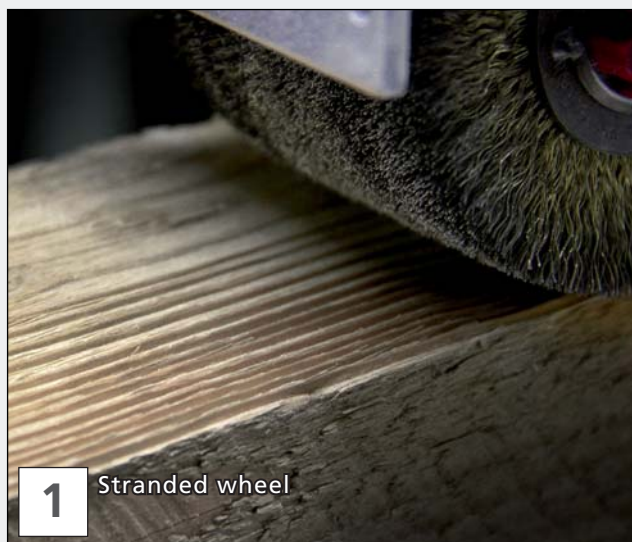

In combination with the stranded wheel the POLY-PTX® 800 is excellently suited for brushing out soft annual rings on soft wood. Thanks to the materials used (steel stranded brush) rough rustic effects can be easily created.

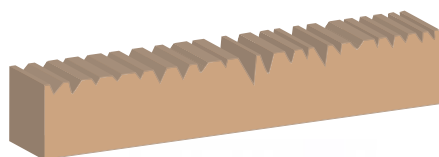

Soft rustic effect



With the bristle wheel, an elastic plastic brush with bristles, the POLY-PTX® 800 is an ideal tool for creating rustic effects with a soft annual ring transition.

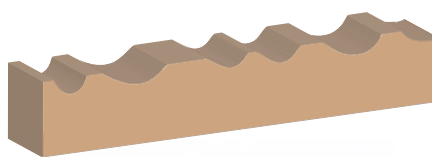

Wax impregnated wood surfaces



The fiber wheel ensures an uncomplicated and high quality polish impregnated wood surface. The elastic fiber brush guarantees perfect matt finish effects and is ideally suited for pore-deep dust removal and cleaning.

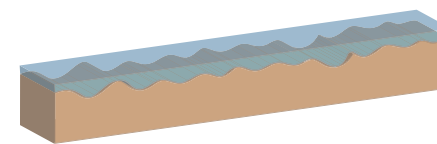

Overview of POLY-PTX® accessories and tools

■ Accessories



Professional case (empty)

Sturdy, impact resistant plastic version with shaped foam inlay for mobile and outdoor use (lockable).



Special handle bar (optional)

For an even better and safer use of the POLY-PTX® 800. Made of high quality materials



INOX cover plate

Application:

For clean covering before grinding the miter in perfect line on all materials. Self-adhesive and residue-free removing - guarantees simple use without preliminary work and reworking afterwards.

Material: stainless steel with a material thickness of only 0.1 mm

Dimensions: 2.5 m length x 150 mm width



Hand fleece

For producing a shadow-free industrial grinding surface (mat and satin finish), pre-polishing, removal of oxide layers as well as adjusting "pre-grounded" metal sheets. Suitable for stainless-steel, non-ferrous metals and wood for smoothing the surface.

Application:

Places which are difficult to reach with a grinding machine can also be manually reworked with the appropriate fleece grit (corners, interior angles, etc.).

Material: Grinding fleece with grit

Dimensions: 20 m x 100 mm

Grit: 80, 180, 280, 400

Plastic spacer ring set

Application:

Width compensation for brushes, rollers and polishing rings.

Material: plastic

Content: 2 x 20 mm; 1 x 10 mm



Suction cover

Application:

For connecting to all standard industrial vacuum cleaners, with centering knurled screws and ideal where a lot of dust is generated (for instance aluminum working or wood working). Can be used for up to 100 mm roller width.

Dimensions of flange: interior-Ø 35 mm; exterior-Ø 40 mm



■ Tools for rough and fine grinding



POLY-PTX® flap wheel

Application:

For the removal of rust, oxide-layers, color, scratches and also for coarse regaining for satin finishing of metals.

Materials to be worked: all metals

Material: pure corundum

Dimensions: Ø 105 mm x 100 mm; Ø 105 mm x 50 mm

Grit: 24, 40, 50, 60, 80, 120, 180, 240



MIX (combi) wheel

Application:

Metal: matt finishing, satin finishing, removal of light scratches

Wood: removal of old paint

Materials to be worked: all metals and wood

Material: grain coated nylon fleece with grinding linen

Dimensions: Ø 115 mm x 100 mm; Ø 115 mm x 50 mm; 105 mm x 100 mm; Ø 105 mm x 50 mm

Grit: 60, 80, 180



FLEECE wheel

Application:

Creating shadow-free industrial finish (matt finishing, satin finishing), pre-polishing, removing oxide layers and for smoothing "pre-ground" plates. For smoothing wood surfaces.

Materials to be worked: INOX, stainless steel, non-ferrous metals and wood

Material: elastics, grain coated nylon fleece

Dimensions: Ø 115 mm x 100 mm; Ø 115 mm x 50 mm; Ø 105 mm x 100 mm; Ø 105 mm x 50 mm

Grit: 60, 80, 180, 280, 400, 600, 900



CLEAN wheel

Application:

Application:

Cleaning and scaling weld seams, pore-deep removal of rust, oxide layers and paint, cleaning wooden benches, bricks, etc. without harming the basis material (functions like sandblasting).

Materials to be worked: metal, wood, brick

Material: grain coated coarse nylon fleece

Dimensions: Ø 115 mm x 100 mm; Ø 115 mm x 50 mm



GUM wheel

Application:

For removing small scratches and black scale, ideal bright, shining, well-structured decorative longitudinal finish.

For wood for smoothing wood surfaces.

Materials to be worked: INOX, non-ferrous metals, wood

Material: soft, grain coated rubber

Dimensions: Ø 105 mm x 100 mm; Ø 105 mm x 50 mm

Grit: 60, 180



VLIES-TOP wheel

Application:

For effective, decorative, bright linear finishes and light beveling on punched metal plates.

Materials to be worked: all metals

Material: fleece material compressed with PUR foam

Dimensions: Ø 112 mm x 100 mm

Grit: 80, 180, 280, 400, 600, 900

■ Special brushes



Stranded wheel

Application:

Metal: for rust removal, deburring, roughening and cleaning (steel). **Wood:** for brushing out soft annual rings on soft wood and for creating rough rustic effects.

Material: steel stranded brush

Dimensions: Ø 100 mm x 70 mm;

Ø 100 mm x 25 mm; Ø 100 mm x 12 mm

Wire thickness: 0,2 mm



INOX wire wheel

Application:

For roughening, deburring, cleaning weld seams and removing paints.

Materials to be worked: all metal

Material: elastic INOX wire brush

Dimensions: Ø 100 mm x 70 mm;

Ø 100 mm x 25 mm; Ø 100 mm x 12 mm

Wire thickness: 0,2 mm



Bristle wheel

Application:

Metal: for roughening and deburring

Wood: for creating rough rustic effects with soft annual ring transition

Material: elastic, grain coated plastic brush

Dimensions: Ø 100 mm x 70 mm;

Ø 100 mm x 25 mm; Ø 100 mm x 12 mm

Bristle thickness: 1,27 mm



Fiber wheel

Application:

For polishing impregnated wood surfaces, creating matt finishes and for pore-deep dust removal and cleaning

Material: elastic fiber brush

Dimensions: Ø 100 mm x 100 mm

Bristle thickness: 0,4 mm

Overview of POLY-PTX® accessories and tools

■ Eco Smart accessories



Adapter for Eco Smart tools

Adapter for using the Eco Smart tools with the POLY-PTX® 800 Professional or with other longitudinal grinders with Ø 19 mm spline shaft. Simply push adapter into the spline shaft, and the cost effective Eco Smart tools can already be used.

Dimensions: exterior-Ø 45 mm, interior-Ø 19 mm with 2 splines; width 100 mm

Alternate quick-release system

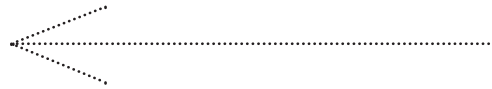

Expansion roller

Application:

For use of the zirconium, Trizact™ SC-fleece, felt, and SuperPolish sleeves.

Highly elastic through patented segments, therefore best adjustment to the work piece is accomplished and it's very simple to change grinding sleeves.

Dimensions: Ø 90 mm x 100 mm



POLY-PTX® flap wheel

Application:

For the removal of rust, oxide-layers, paint, scratches and also for coarse regraining for satin finishing of metals.

Materials to be worked: all metals and wood

Material: pure corundum

Dimensions: Ø 105 mm x 100 mm;
Ø 105 mm x 50 mm

Grit: 24, 40, 50, 60, 80, 120, 180, 240



MIX (combi) wheel

Application:

Metal: matt finishing, satin finishing, removal of light scratches, rust, oxide, etc.

Wood: Metal removal of old paint.

Materials to be worked: all metals and wood

Material: grain coated nylon fleece with grinding linen

Dimensions: Ø 105 mm x 150 mm;
Ø 105 mm x 100 mm; Ø 105 mm x 50 mm

Grit: 60, 80, 180



FLEECE wheel

Application:

Creating shadow-free industrial finish (matt finishing, satin finishing), pre-polishing, removing oxide layers and for smoothing "pre-ground" plates. For smoothing surfaces.

Materials to be worked: INOX, stainless steel, non-ferrous metals and wood

Material: elastic, grain coated nylon fleece

Dimensions: Ø 105 mm x 150 mm;
Ø 105 mm x 100 mm; Ø 105 mm x 50 mm

Grit: 60, 80, 180, 280, 400



Expansion roller with new soft expansion segments for optimal adjustment to workpiece

Application:

For using the zirconium, Trizact™, SC fleece, felt and SuperPolish sleeves.

Dimensions: Ø 90 mm x 100 mm; Ø 90 mm x 50 mm



Inflatable expansion roller

We recommend this inflatable roller for the individual "hardness setting" of the respective zirconium, SC fleece, Trizact™, SuperPolish and felt sleeves. It is particularly suitable for surface and edge grinding.

Dimensions: Ø 90 mm x 100 mm

■ Sleeves for expansion rollers



Ceramic sleeve

Application: for stainless steel. For removing deep scratches, rust, scale and weld seams (pre grinding)

Materials to be worked: all metals

Material: high-quality ceramic cloth

Dimensions: Ø 90 mm x 100 mm

Grit: 40, 60, 80



Zirconium sleeve

Application: removing deep scratches, rust, scale and weld seams. Thanks to the time-saving longitudinal grinding, far less reworking is necessary

Materials to be worked: all metals

Material: zirconium cloth

Dimensions: Ø 90 mm x 100 mm; Ø 90 mm x 50 mm

Grit: 24, 36, 40, 60, 80, 120, 150, 180



Trizact™ sleeve

Application: very high material removal and at the same time very fine surface grinding pattern (saves several working steps). Ideal for removing scratches and for pre-grinding for the mirror-finish polishing

Materials to be worked: all metal

Material: innovative grinding cloth with pyramid-shaped grain structure

Dimensions: Ø 90 mm x 100 mm; Ø 90 mm x 50 mm

Grit: A160, A100, A65, A45, A30, A16, A06

ORIGINAL
3M
QUALITÄT



ORIGINAL
3M
QUALITÄT

SC fleece sleeve

Application: for removing light scratches and oxide layers, matt finishing, satin finishing, deburring and fine grinding

Materials to be worked: all metals

Material: impregnated, grain-coated nylon cloth

Dimensions: Ø 90 mm x 100 mm; Ø 90 mm x 50 mm

Grit: rough, medium, fine, super fine

■ Polishing tools for expansion rollers



Merino felt sleeve

Application: for quick mirror-finish polishing of large surfaces. Only in combination with polishing pastes or cream

Materials to be worked: INOX, non-ferrous metals, hard plastic

Material: soft Merino felt

Dimensions: Ø 90 mm x 100 mm



SuperPolish sleeve

Application: for flawless, brilliant, shadow-free mirror finish (removes even finest streaks).

SuperPolish fleece is absorbent, does not clog and saves a lot of working time. Only in combination with polishing pastes or cream

Materials to be worked: INOX, non-ferrous metals

Material: revolutionary special nylon fleece

Dimensions: Ø 90 mm x 100 mm; Ø 90 mm x 50 mm

Overview of POLY-PTX® accessories and tools

■ Tools for pipe finishing



Grinding belt roller with INOX flange

Application: for grinding, SC fleece, Trizact™, SuperPolish and felt belts

Material: wear-resistant, soft Vulcan with side stop disks made of stainless steel and vibration-damped core

Dimensions: Ø 85 mm x 70 mm



Special adhesive tape

Application: for rejoining the grinding and Trizact™ belts.

Heat-resistant and strong adhesive power

Material: adhesive tape with linear backing strip for tear-free hold

Dimensions: 25 mm x 50 m



Pure corundum grinding belt

Application: for rough grinding, for pre-grinding, descaling, derusting and sanding

Materials to be worked: round metal pipes

Dimensions: 30 mm x 600 mm

Grit: 40, 60, 80, 120, 150, 180, 240



Merino felt belt (open)

Application: for the main polishing on closed pipe constructions and handrails. This is used with the grinding belt roller and our polishing pastes and creams

Material: soft Merino felt with **polishing pastes and creams.**

Material: soft Merino felt with "Buttonhole fastening system" (international patent and legal protection of design)

Dimensions: 30 mm x 660 mm



Trizact™ belt

Application: for removing scratches, rolling skin and welding points and for pre-grinding for subsequent mirror-finish polishing. Trizact™ belts enable a very high material removal and at the same time a very fine grinding surface pattern

Material: innovative grain structure (pyramid-shaped)

Dimensions: 30 mm x 600 mm

Grit: A100, A65, A45, A30, A16, A06



SC fleece belt (open)

Application: for removing light scratches and oxide layers, matt finishing, satin finishing, fine grinding, pre-polishing and deburring on closed pipe constructions and handrails

Material: grain coated fleece cloth + cloth reinforcement with "Buttonhole fastening system" (international patent and legal protection of design)

Dimensions: 30 mm x 660 mm

Grit: rough, medium, fine, super fine



SuperPolish belt (closed)

Application: for flawless, brilliant mirror finish on pipe constructions and handrails without streaking and shadows. SuperPolish is absorbent, saves a lot of working time and does not clog. Only in combination with polishing pastes or cream

Material: revolutionary special nylon fleece

Dimensions: 30 mm x 650 mm

■ Polishing tools for 19 mm supporting shaft



Merino felt wheel

Application: For pre-polishing and mirror-polishing of small to medium flat surfaces. Only in combination with polishing pastes or cream

Materials to be worked: INOX, non-ferrous metals

Material: hard felt contact wheel made of compressed Merino

Dimensions: Ø 100 mm x 50 mm



Cotton ring (impregnated)

Application: Ideal for pre-polishing.

Only in combination with polishing pastes or cream

Materials to be worked: non-ferrous metal (for instance aluminum, brass)

Material: impregnated cotton cloth

Dimensions: Ø 100 mm x 10 mm



Mirror-finishing ring – medium

Application: for pre-polishing narrow or uneven INOX surfaces. Only in combination with polishing pastes or cream

Materials to be worked: INOX surfaces

Material: impregnated, technical fleece material

Dimensions: Ø 100 mm x 10 mm



Mirror-finishing ring – soft

Application:

for the **Final polishing** – ideal mirror-finish effect.

Only in combination with polishing pastes or cream

Materials to be worked: INOX and non-ferrous metals

Material: technical fleece material

Dimensions: Ø 100 mm x 10 mm

■ Polish and care products



Polishing pastes

Application: for pre-polishing and main polishing:

White for pre-polishing

Blue for main polishing

Materials to be worked:

all metals (INOX / non-ferrous metals)

Content: Cardboard sleeve dispenser for pressing out; content approx. 650 g; mini-paste white and blue, each approx. 60 g



Polishing cream pink

Application: for the subsequent polishing. With SuperPolish and POLY-PTX® mirror-finishing rings a perfect mirror finish can be created

Materials to be worked: all metals (INOX / non-ferrous metals)

Content: can 1 kg; mini-tube approx. 60 ml



POLY lime

Application:

For removing cream and paste residue.

Is simply sprinkled on the surface and wiped off with a microfiber cloth

Materials to be worked: all metals and hard plastics

Content: can 1 kg; aluminum sprinkle can 150 g



Microfiber cloths

Application: for pore-deep cleaning and at the same time spreading preserving agents and polishes, removing paste and cream residue

Size: 400 mm x 400 mm

Quantity: 25 pieces



Brilliance-Clean

Application: removes finger prints, grinding dust, paste residue and light dirt caused by oil and fat as well as adhesive residue on all surfaces, without leaving any leftovers and streaks and without harming the surfaces. Evaporates in seconds.

Can be used for:

stainless steel, steel, aluminum, brass, copper, plastic, wood, glass, acrylic glass and painted surfaces

Content: canister 5 liters; spray bottle 500 ml



INOX protect (dry wax coating)

Application:

Seals and protects grinded and polished surfaces through a clear, invisible and dry adherent protective film. Removes finger prints and other dirt. Guarantees long-term protection of grinded surfaces

Can be used for:

stainless steel, steel, aluminum, brass, copper

Content: canister 5 liters; spray bottle 500 ml



POLY-Sealer (oil film)

Application: for cleaning and preserving grinded and polished surfaces. Finger prints and water spots or shading remain invisible for a long time. Can be used in exterior areas and the food industry

Can be used for:

Polished stainless steel and non-ferrous metal-surfaces

Content: canister 5 liters; spray bottle 500 ml

■ Product and applications videos POLY-PTX® 800

The ideal supplement to the Professional Guide: the new high-quality videos on POLY-PTX® 800! A product film demonstratively explains all features and properties of our innovative longitudinal grinding system. The application videos elaborate on the tips, which can be found in the Professional Guide, and hence explain each individual step in an easily comprehensible way.

You can order the videos on POLY-PTX® 800 free of charge and without any commitments by phone or e-mail and watch and download videos on our homepage at www.eisenblaetter.de/anwendungen/videos.html! The videos are also available for you on our Facebook page!

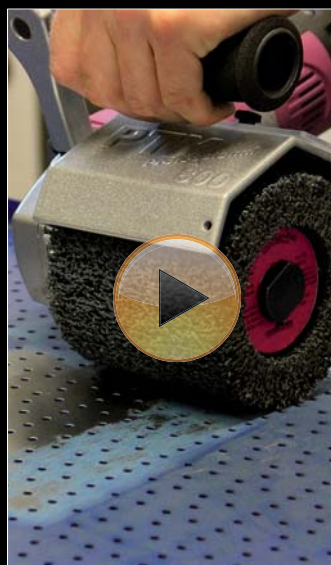

Gerd Eisenblätter GmbH
Jeschkenstraße 10
82538 Geretsried
GERMANY

Phone: +49 (81 71) 93 84 - 0

Fax: +49 (81 71) 93 84 - 55

E-Mail: info@eisenblaetter.de

www.eisenblaetter.de

