

INOX-STAR

Eye bolt

Full WLL in any direction
with 4:1 design factor

100% electro-magnetic
crack detection tested

Manufactured from
Stainless Steel

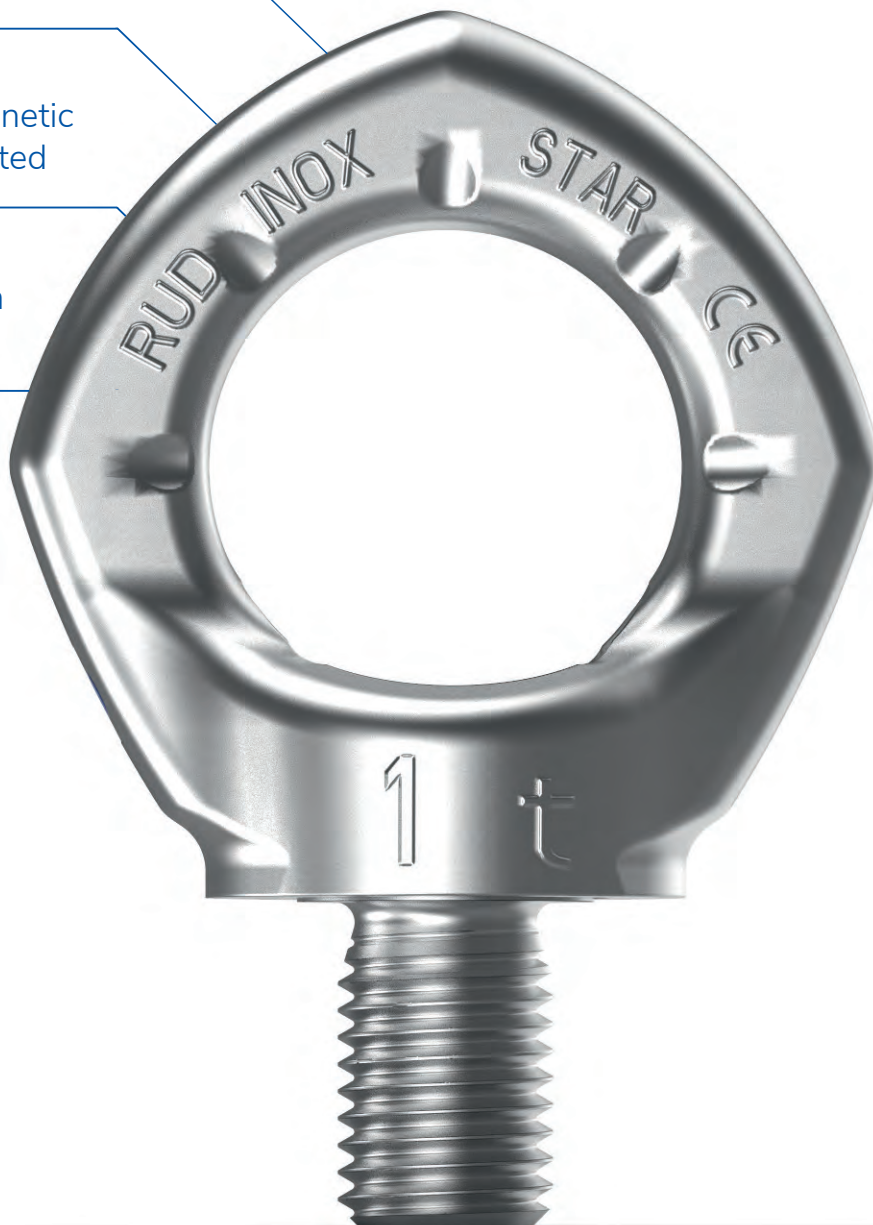

Product features / INOX-STAR Eye bolt

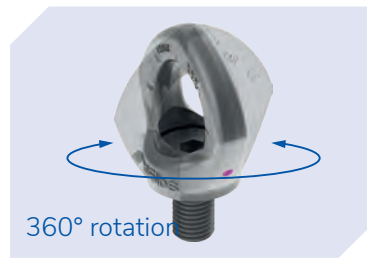

- ✓ Full WLL in any direction with 4:1 design factor
- ✓ 100% electro-magnetic crack detection tested
- ✓ Manufactured from stainless steel – 50% more than DIN with no directional restrictions.
- ✓ Turns through 360°. Can be set in the direction of the load

- ✓ Forged eye body and screw with captive, mounted bolt
- ✓ Pentagonal shape (clearly distinguishable from other eye bolts)
- ✓ Colour: stainless steel
- ✓ Longer Bolts available - M12, M16 and M20

TYPE	WLL (t)		B	C	D	E	G	I	K	L	M	T	N	Weight (kgs)	Reference No.
	F1	F2													
INOX-STAR M12	1.2	0.5	14	12	30	30	32	20	56	18	M12	43	8	0.19	7993835
INOX-STAR M16	2.4	1.0	16	14	35	36	38	23.5	65	24	M16	50	10	0.31	7993836
INOX-STAR M20	3.6	2.0	19	16	40	42	47	29	74	30	M20	57	12	0.53	7993837
INOX-STAR M24	5.2	2.5	24	19	48	50	56	35	92	36	M24	70	14	0.92	7993838

Dimensions and specifications subject to change

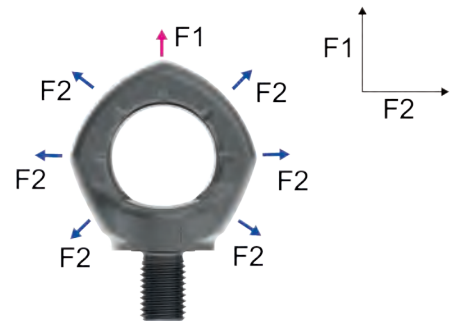
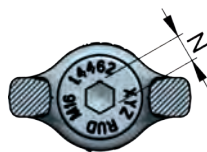
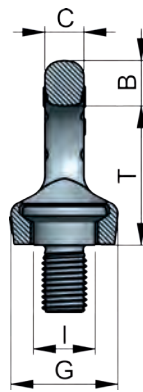
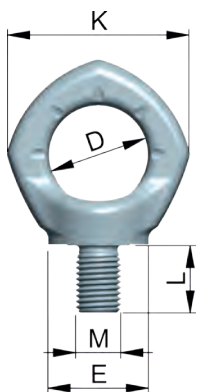

Head Office
12 Commerce Place, Larapinta QLD 4110
T: +61 7 3809 1300 F: +61 7 3809 1301

WA Office: Perth
107 Broadway, Bassendean WA 6054
T: +61 8 6278 1788 F: +61 8 6278 4788

E: sales@rud.com.au
W: www.rud.com.au
ABN: 74 010 547 949



Full Member

Quality ISO 9001

Environment ISO 9001

ISO 45001 Occupational Health and Safety

SAI GLOBAL

SAI GLOBAL

SAI GLOBAL

SAI GLOBAL