

**CELLIFE COVID-19 ANTIGEN**  
(SARS-COV-2) TEST CASSETTE (SWAB)

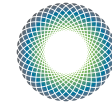

**LATERAL**  
TESTING



**TGA APPROVED**

**EASY**

Easy 2 Step  
Process

**FAST**

Test takes 2 minutes  
Results in 15 minutes

**ACCURATE**

Sensitivity up to 97.6%  
Specificity up to 98.4%  
Clinical specificity is up to 99.6% of Nasal Swab Specimen

*The Cellife COVID-19 Antigen Test Cassette is a chromatographic immunoassay for the qualitative detection of SARS-CoV-2(COVID-19) nucleocapsid antigen in Nasopharyngeal, oropharyngeal and nasal swabs to aid in the diagnosis of SARS-CoV-2 virus infection.*

# CELLIFE COVID-19 ANTIGEN (SARS-COV-2) TEST CASSETTE (SWAB)



## PACKAGING DETAILS

Products	Box Size (mm)	QTY/CTN	Carton Size (cm)	GW (Kg)	NW (Kg)
COVID-19 Antigen Test Cassette	160x70x18	300	50.5x38.5x37.5	8.2	7.2
1 Test / Box					
COVID-19 Antigen Test Cassette	190x70x50	600	59.5x42.5x37.5	10	9
5 Tests / Box					

## ADDITIONAL PPE PRODUCTS

- MakriteSekura N95 Masks
- BYD N95 Masks
- AirQueen Nano Masks
- Medical Grade Gowns
- Medical Grade Gloves
- 70% Alcohol-Based Hand Sanitiser  
(Made in Australia)

# CELLIFE COVID-19 ANTIGEN (SARS-COV-2) TEST CASSETTE (SWAB)

## Materials Provided:

Test Device  
Package Insert

Extraction Buffer  
Sterile Swab

Extraction Tube  
Workstation

## Test:

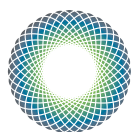
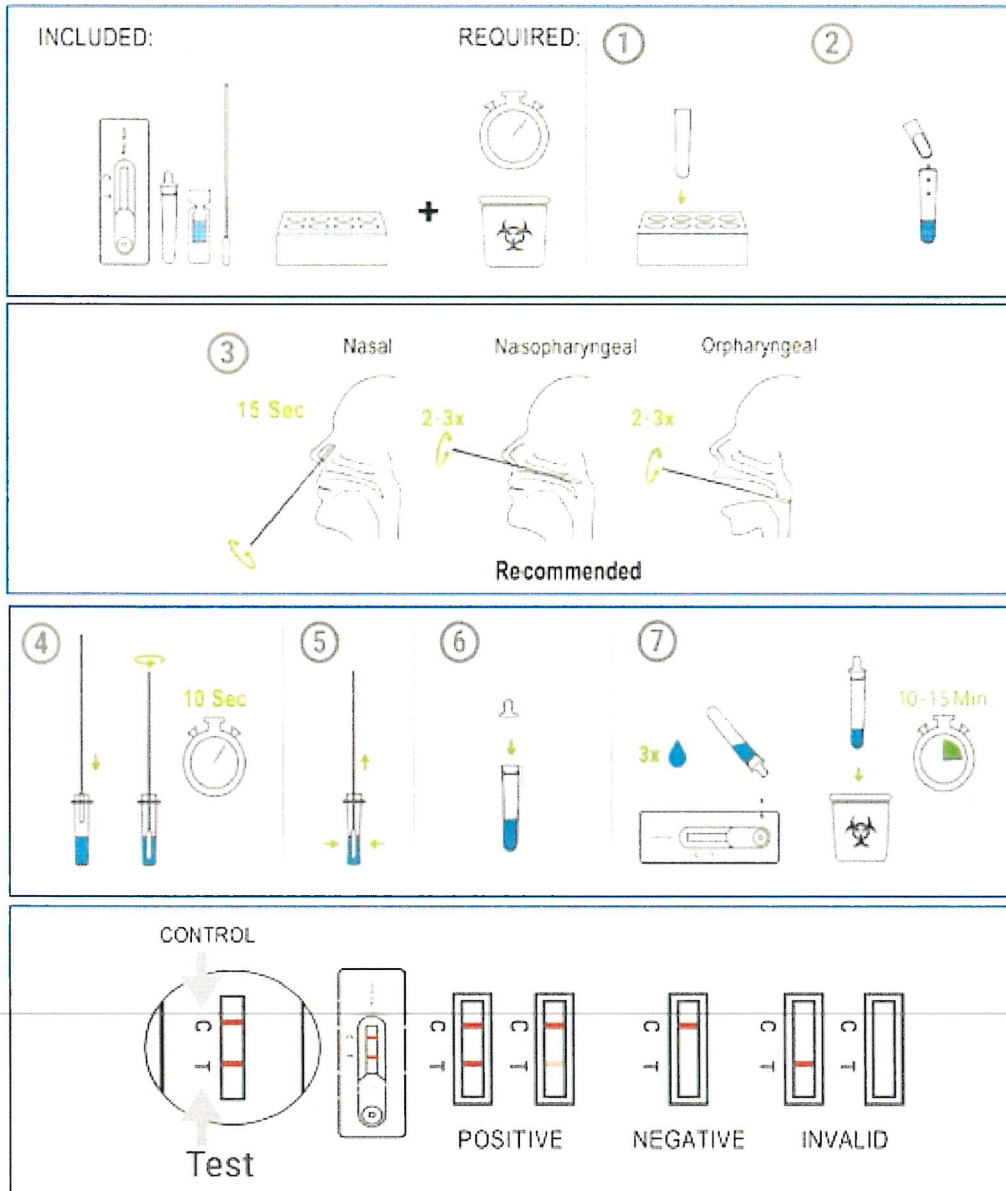

**LATERAL  
TESTING**

[lateraltesting.com.au](http://lateraltesting.com.au)