

## Laboratory Sets Type 16

Type 16 laboratory tapware is supplied standard with vandal resistant handle and button, 15mm male BSP inlet and standard jumper valve, finished with a heavy duty, bright chrome plating.



### TW-LBSET-01

Lab Set 1-Way Type 16:DOC Fixed Jumper Valve #8 V/R Aerator 5LPM [WELS 5 Star]. Approved to NSW Department of Commerce and is commonly specified for NSW schools.

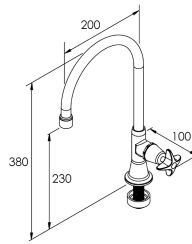

### TW-LBSET-01A

Lab Set 1-Way Type 16:DOC Fixed Goose-neck, Jumper Valve #16 XT Tube Nozzle with Integral Mini Dual Check Valve 5LPM [WELS 5 Star]. Approved to NSW Department of Commerce and is commonly specified for NSW schools.

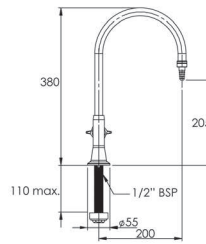

### TW-LBSET-02

Lab Set Type 16 Swivel, Jumper Valve and Aerator Nozzle with Integral Mini Dual Check Valve.

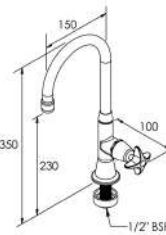

## Laboratory Sets Type 13

Type 13 laboratory tapware is supplied standard with vandal resistant handle and button, 15mm male BSP inlet and standard jumper valve, finished with a heavy duty, bright chrome plating.



### TW-LBSET-03

Lab Set H & C Mixing Unit Type 13 Swivel Outlet, Jumper Valves and #1 Aerator

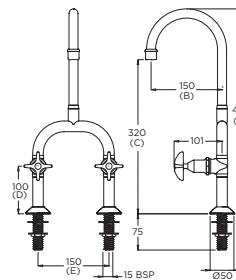

### TW-LBSET-04

Lab H & C Mixing Unit Type 13 Swivel Outlet, Jumper Valves and #16 XT Tube Nozzle with Integral Mini Dual Check Valve.

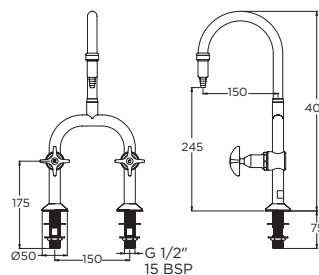

VISIT [BRITEX.COM.AU](http://BRITEX.COM.AU) TO DOWNLOAD BIM FILES, CAD DRAWINGS AND THE MOST CURRENT PRODUCT LITERATURE.

Last Revised 2019

## Laboratory Sets Type 14

Type 14 laboratory tapware is supplied standard with vandal resistant handle and button, 15mm male BSP inlet and standard jumper valve, finished with a heavy duty, bright chrome plating.



### TW-LBSET-06

Lab Set H & C Mixing Unit Type 14 Swivel Outlet, Jumper Valves and XT Tube Nozzle with Integral Mini Dual Check Valve on Spout and Bibs.

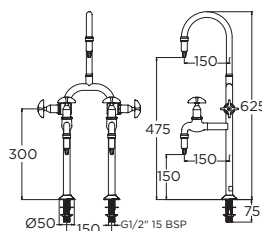

## Laboratory Sets Type 19

Type 19 laboratory tapware is supplied standard with vandal resistant handle and button, 15mm male BSP inlet and standard jumper valve, finished with a heavy duty, bright chrome plating.



### TW-LBSET-07

Lab Set H & C Mixing Unit Type 19 Swivel Outlet, Jumper Valves and #1 Aerator.

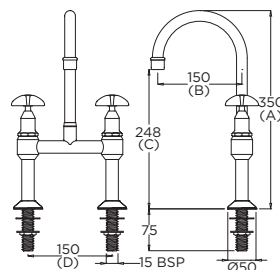

### TW-LBSET-08

Lab H & C Mixing Unit Type 19 Swivel Outlet, Jumper Valves and XT Tube Nozzle with Integral Mini Dual Check Valve.

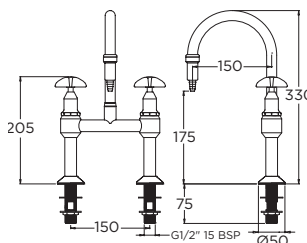

### TW-LBSET-09

Lab Set Bib Cock Bench Mounted Type 26 (NSW School Specification)

AS/NZS 3718 approved. Commonly specified for NSW schools. Supplied with vandal resistant aerator, handle and button, 15mm male BSP inlet with anti-rotating pin on base and standard jumper valve. Bright chrome plate finish.

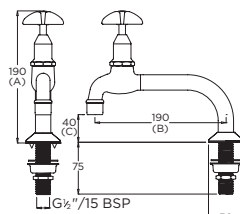

VISIT [BRITEX.COM.AU](http://BRITEX.COM.AU) TO DOWNLOAD BIM FILES, CAD DRAWINGS AND THE MOST CURRENT PRODUCT LITERATURE.

Last Revised 2019



**MELBOURNE**  
Britex Place, Mirra Crt  
Bundoora VIC 3083  
t (03) 9466 9000  
e vic@britex.com.au

**SYDNEY**  
16 Northumberland Drv  
Taren Point NSW 2229  
t (02) 9531 2100  
e nsy@britex.com.au

**PERTH**  
Unit 1/8 Principal Link  
Malaga WA 6090  
t (08) 9249 5464  
e wa@britex.com.au

**BRISBANE**  
19 Manila St  
East Brisbane QLD 4169  
t (07) 3363 2400  
e qld@britex.com.au

**ADELAIDE**  
The Britex Group  
SA State Office  
t 1300 764 744  
e sa@britex.com.au

britex.com.au | info@britex.com.au | A.B.N 83 004 309 737