

## 521 - Straight Line Push-Pull Type Toggle Clamps

Body Mounting Base: Horizontal with Welding

Part Number	F1 (N)	F3 (N)	Fi F1:Fi	Compression Screw	Stroke
19-521-3-012	2960	3200	16:1	M8 x 50	38
19-521-4-018	4500	7200	23:1	M10 x 70	47
19-521-5-020	7500	15000	30:1	M12 x 80	55



F1 Exerting Force. F3 Holding Capacity. Fi Applied Force

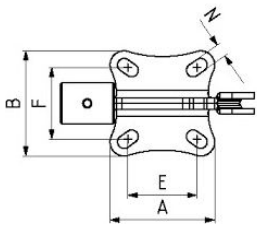
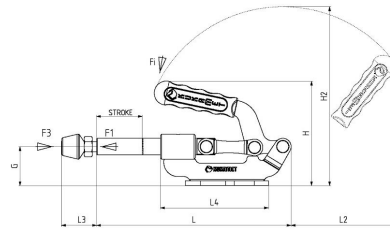

19-521-3

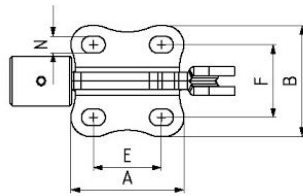

19-521-4

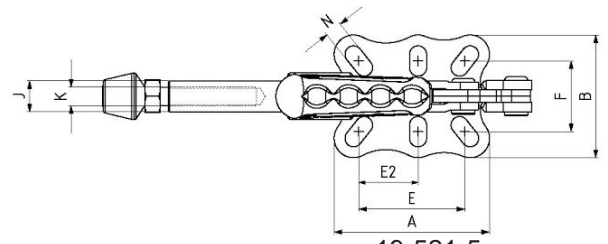

19-521-5

Part Number	A	B	E	E2	F	G	H	H2	J	K	L	L2	L3 min	L3 max	L4	N
19-521-3-012	56	56	32.5-41	-	35-41	32	88	142	12	M8	154	85	24	58	83	7x12
19-521-4-018	64	62	34.5-42.5	-	41	40	107	179	18	M10	186	105	32	81	98	9.5 x 13.5
19-521-5-020	100	79	61.5-75	34.5-41.5	37-54	47	125	216	20	M12	234	125	39	94	130	11 x 22