

Koffeone

8-12 Robert Street, Rozelle, NSW 2039
Phone 02 9818 4677

sales@koffeone.com.au
www.koffeone.com.au

San Remo Zoe Competition 2 Group

Water Requirements Plumbed

- Dedicated cold water line with 1/2" Male fitting.
- Male shut-off valve.

Water Requirements Portable

- Flo Jet Pump Required to run from Portable Water Container
- Water Container (20 Litre Water Drum)

Drain Requirements Plumbed

- Open gravity drains of minimum 7.5 cm Diameter, within 120cm of the machine with waste trap – Opening 25 cm above Water Trap



Hows Franks coffee machine going Waste Trap

Drain Requirements Portable

- Waste Drum To catch Wastewater.

Dimensions in Centimeter's

- Height: 602 mm
- Depth: 528 mm
- Width: 720 mm

Power Requirements

- Volts: 240 Volts
- Watts: 3 300
- Amp draw: 15 amps
- 1 x Fitting 15 Amp Single Phase
- 1 x Fitting 10amp GPO for grinder.



Coffee Machine



Coffee Grinder

Required Hole in Bench
under machine.

7 cm Diameter for
power, water, and waste

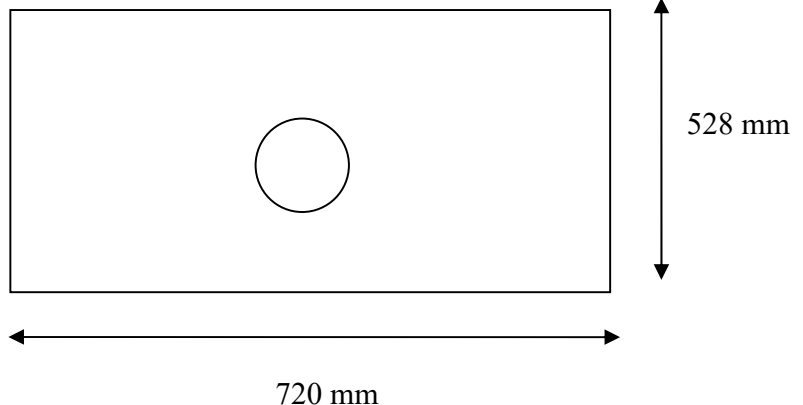

San Remo Zoe Competition 2 Group Coffee machine

I, the customer, understand that these requirements must be in when the installer arrives. Failure to have the site ready will result in additional service and travel charges and may cause further delays in installation.

Customer Name: _____ Signature: _____

Company Name: _____

Phone: _____ Fax: _____ Email: _____

