

Fuse Clips

- Available for 5mm, 1AG, 2AG, 3AG, 5AG, 7AG & 8AG sizes
- Low profile, space saving
- Low contact resistance
- Withstands shock and vibration

- Rated 6.3 to 30 Amps
- Custom designs and modifications available to your specifications

PC THRU MOUNT TYPES

- Snap-fit design enhances assembly and PC retention for wave soldering
- Available with orientation legs to assure proper PC installation
- Available with or without end stops

SURFACE MOUNT & RIVET TYPES

- KTR parts have Kapton Tape added to top service for vacuum pick & place

2AG, 5mm PC Clips



MATERIAL:

0.51 Brass, Tin Plate
UL Current Rating: 15 Amps

CAT. NO.	A	B
K3517	1.5	1.5
K3518P	1.5	2.4

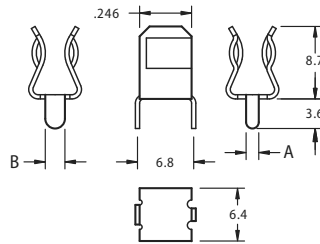

With or Without Orientation Legs
Optional cover available - CAT. NO. K3517C



MATERIAL:

0.51 Brass, Tin Plate
UL Current Rating: 15 Amps

CAT. NO.	A	B
K3512	1.5	1.5
K3512P	1.5	2.4

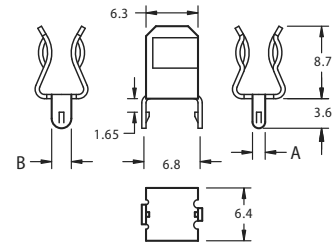

With or Without Orientation Legs
Optional cover available - CAT. NO. K3517C



MATERIAL:

0.41 Brass, Tin Plate
UL Current Rating: 6.3 Amps

CAT. NO. K3520

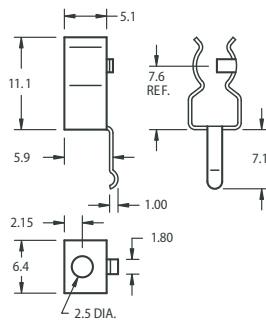

MATERIAL:

0.41 Brass, Tin Plate
UL Current Rating: 15 Amps

CAT. NO. K3519

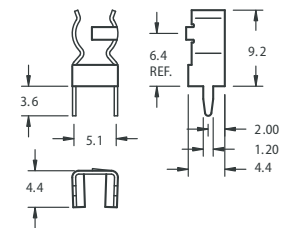

Mounting Detail

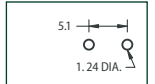

2AG or 5mm



MATERIAL: 0.41 Brass, Tin Plate
UL Current Rating: 15 Amps

CAT. NO.	ON TAPE BULK & REEL	PC LEGS	END STOP
K3521	—	YES	YES
K3621	—	YES	NO*
K3561	K3561 KTR	NO	YES
K3622	K3622 KTR	NO	NO*

Tape & Reel Spec's: 16mm wide, 12mm pitch, 13 inch reel (500 pieces per reel)

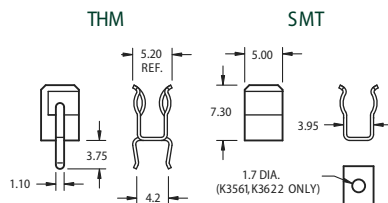

Mounting Detail

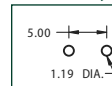

5mm/3AG



MATERIAL:

0.41 Brass, Tin Plate
UL Current Rating: 15 Amps

CAT. NO. K3562

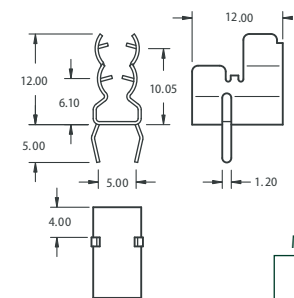

Mounting Detail

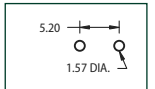

4AG (7.1 mm Dia.)



MATERIAL:

0.51 Brass, Nickel Plate
UL Current Rating: 15 Amps

CAT. NO. K3565 (Without End Stops)*

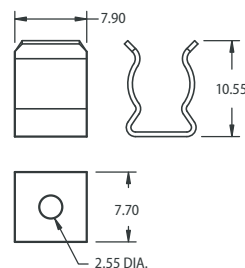

5AG (10.3 mm Dia.) - Solar Protection Fuse



MATERIAL:

0.76 Brass, Tin Plate
UL Current Rating: 30 Amps

CAT. NO. K3566

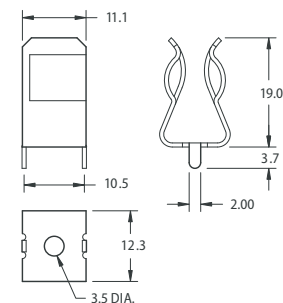

Mounting Detail

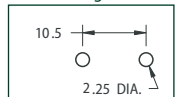

*Fuse clips without end stops are not UL recognized

1AG, 3AG, 7AG, 8AG THRU HOLE MOUNT TYPES

WITH SNAP-IN PC LEGS



MATERIAL:
0.51 Brass, Tin Plate
UL Current Rating: 15 Amps

CAT. NO. K3513

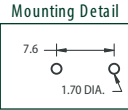
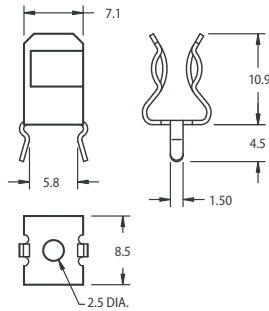

WITH SNAP-IN PC LEGS

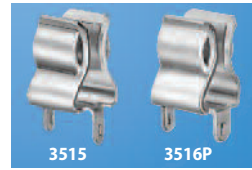

MATERIAL:
0.51 Brass, Tin Plate
UL Current Rating: 15 Amps

CAT. NO.	A	B
K3515	1.5	1.5
K3515P	1.5	2.4
K3516P	1.5	3.0

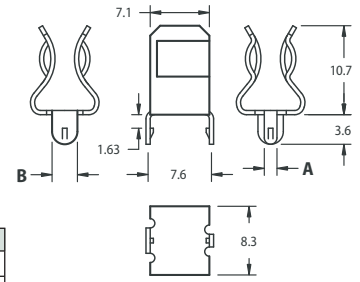

With or Without Orientation Legs

WITH STRAIGHT PC LEGS



MATERIAL:
0.51 Brass, Tin Plate
UL Current Rating: 15 Amps

CAT. NO. K3530

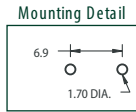
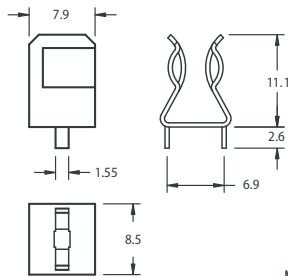

WITH STRAIGHT PC LEGS



MATERIAL:
0.51 Brass, Tin Plate
UL Current Rating: 15 Amps

CAT. NO.	H	L	END STOPS
K3510	10.7	3.6	NO*
K3529	10.7	3.6	YES
K3511	10.9	6.4	NO*
K3514	10.9	6.4	YES

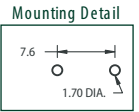
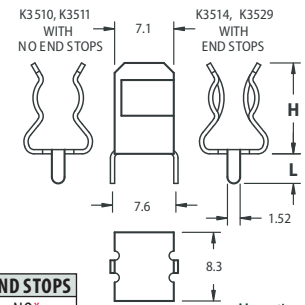

SNAP-IN WITH END STOP



MATERIAL:
0.51 Brass, Nickel Plate
UL Current Rating: 20 Amps

CAT. NO. K3500

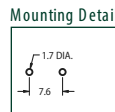
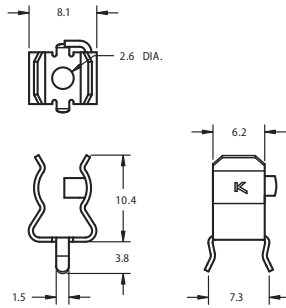

SMT & RIVET MOUNT, LOW PROFILE



MATERIAL:
0.51 Brass, Nickel Plate
UL Current Rating: 15 Amps

CAT. NO. K3531 (Without End Stops)*

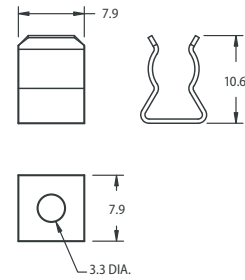

SMT & RIVET MOUNT WITH LUG



MATERIAL:
0.51 Brass, Nickel Plate
Current Rating: 15 Amps

CAT. NO.	A	B
K3533	Flat	16.7
K3535	45°	14.3
K3570	—	NO TAB

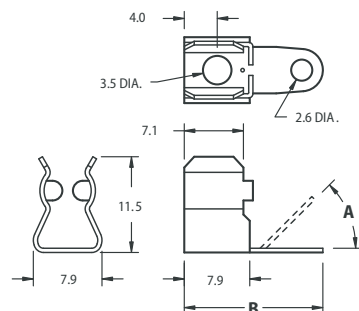

SMT & RIVET MOUNT



MATERIAL:
0.51 Brass, Nickel Plate
UL Current Rating: 15 Amps

CAT. NO.	END STOPS
K3532	YES
K3567	NO*

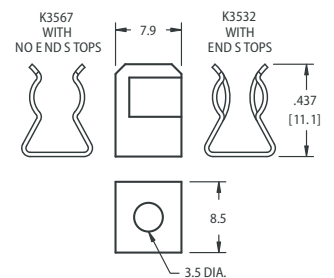

*Fuse clips without end stops are not UL recognized