

# CMB100/CMB101 Series

## Industrial AI Computer

High Performance Flexible Extension System  
Based on MicroATX Solutions



## Features

- Supports 9th/8th/7th/6th Gen Intel® Core™ DT processors (TDP 65W) with specified M/B
- Supports discrete GPU cards with reserved expansion slots
- Multiple expansion slots :  
CMB100M (C236 platform): 1x PCI-E(x16), 1x PCI-E(x8), 1x PCI-E(x4)  
CMB101M (H310 platform): 1x PCI-E(x16), 2x PCI-E(x1), 1x PCI
- 500W 1U Flex ATX power supply [Default]
- 2-pin remote boot extension design
- Supports multi-display interfaces [HDMI, DP, CRT] and GbE ports , USB 3.0 ports
- 4 removable 2.5" storage devices (supports RAID 0/1)
- MiniPCI-E and M.2 M-Key (2280)
- TPM, DIO, iAMT, iSMART [Optional]

## Specifications

System Mainboard	H310/C236 MicroATX motherboards
CPU Type	CMB100M: 7th/6th Gen Intel® Core™ DT processors (TDP 65W) CMB101M: 9th/8th Gen Intel® Core™ DT processors (TDP 65W)
System Speed	CMB100M: Up to 4.20 GHz (C236 supports ECC by CPU SKUs) CMB101M: Up to 4.90 GHz
Memory	CMB100M: 2x DDR4 UIMM, Max. 32GB CMB101M: 4x DDR4 UIMM, Max. 64GB
Graphics	Optional RTX-2080 or equivalent GPU card
LAN	CMB100M: Intel I210AT + I219LM CMB101M: Realtek RTL8111H
Front Panel External I/O	2-pin remote boot extension design Detachable side cover for GFX Card 4x Slots Power button CMB100M: Multi-HDMI 6x USB3.0 ports, 4x USB2.0 (expandable) 2x RJ45 2x RS232/422/485, 2x RS232 CMB101M: DVI-D+D-SUB 2x USB3.2 ports, 4x USB2.0 ports, 2x USB3.2 (expandable) and 2x USB2.0 (expandable) 1x RJ45 GbE port 1x RS232, 1xRS232 (expandable)
Rear Panel External I/O	Pluggable cooling-fan
Expansion Slot	CMB100M: 1x PCI-E(x16), 1x PCI-E(x8), 1x PCI-E(x4) CMB101M: 1x PCI-E(x16), 2x PCI-E(x1), 1x PCI
Storage	CMB100M: 4x 2.5" SATA (supports RAID 0/1)+Mini PCI-E CMB101M: 4x 2.5" SATA (supports RAID 0/1)+M.2 M-Key (2280) storage
Auto Control and Monitoring	Watchdog Timer: 256 segments, 0, 1, 2...255 (sec/min)
Power Requirement	ATX
Power Supply	500W

Construction	SECC
Chassis Color	Black
Mounting	Desktop & wall mount
Dimensions	362.4mm(W) x 350.0mm(D) x 156.0mm(H)
Weight	Depends on the configuration of power supply and motherboard related components
Operating Temperature	0°C~45°C (32°F~113°F) (for 65W CPU) @60°C, non-condensing
Storage Temperature	-20°C~80°C (-4°F~176°F), @60°C, non-condensing
Relative Humidity	10~95%, non-condensing@60°C
Vibration	With SSD: 1Grms, IEC 60068-2-64, random, 5Hz~500Hz
Shock	With SSD: Operating 20G, IEC 60068-2-27, half-sine, 11 ms duration With SSD Non-Operating 40G, IEC 60068-2-27, half-sine, 11 ms duration With SSD
Certification	CE FCC ClassA / LVD
Operating System	Windows 10 64-bit, Linux Ubuntu 18.0.4, Windows 7 64-bit [CMB100M only]

## Ordering Information

CMB100M	Chassis with MicroATX motherboard w/o CPU, memory, storage, support 7th/6th Gen Intel® i7/i5/i3 / Pentium® / Celeron® QC/DC processors, up to 4.2GHz
CMB101M	Chassis with MicroATX motherboard w/o CPU, memory, storage, support 9th/8th Gen Intel® i7/i5/i3 / Pentium® / Celeron® QC/DC processors, up to 4.9GHz



Backplane  
Systems  
Technology

Backplane Systems  
Technology Pty Ltd

TEL 02 9457 6400  
sales@backplane.com.au  
www.backplane.com.au

#### Product Appearance

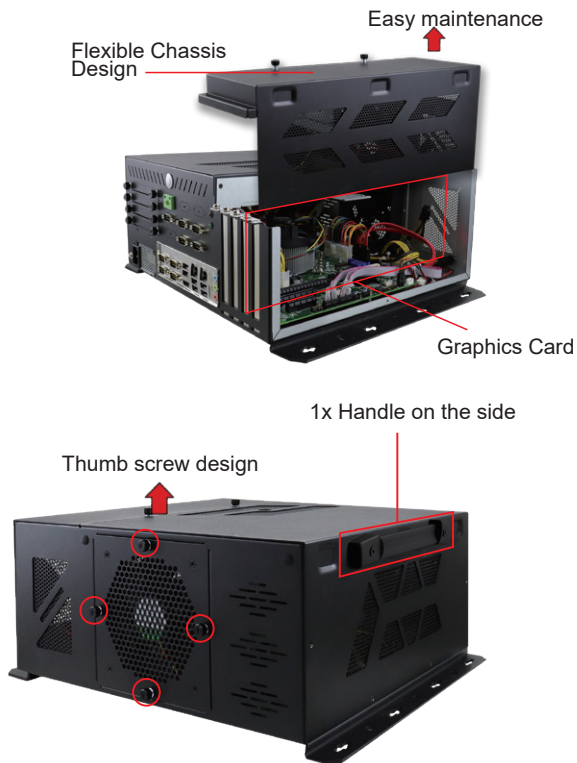

#### Dimensions and Drawing

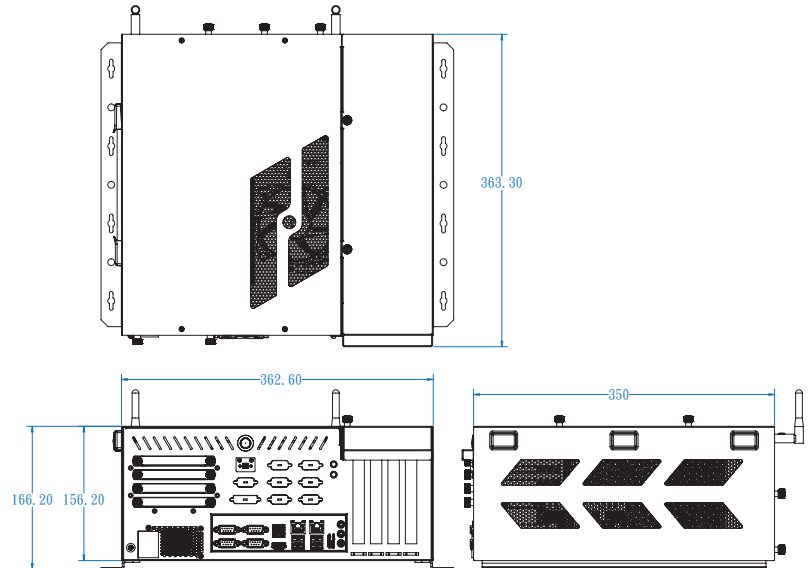

#### Reference Cards VS Non-Reference Cards

