

# Pull Handles - Arch Shape Plastic

Arch Shape Pull Handles are lightweight and provide a clean finish.

## Specifications

**Material:** PA, Zinc Alloy, Die Cast Zinc Alloy

## Features

- Size and style variation suitable for a choice of applications including; electrical and machining, cabinet making, and others.
- Front and Rear mounting options.

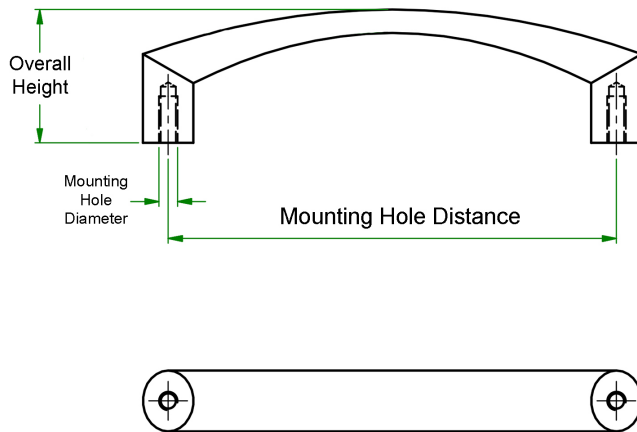

Part Number	Overall Length	Overall Height	Handle Material	Grip Height	Mounting Hole Distance
287500E	500.0 mm   19.685 in	53.0 mm   2.087 in	Aluminium	34.0 mm	500.0 mm   19.685 in
1337626	100.0 mm   3.937 in	49.0 mm   1.929 in	Aluminium	49.0 mm	100.0 mm   3.937 in
1337627	112.0 mm   4.409 in	49.0 mm   1.929 in	Aluminium	49.0 mm	112.0 mm   4.409 in
1337628	117.0 mm   4.606 in	49.0 mm   1.929 in	Aluminium	49.0 mm	117.0 mm   4.606 in
1337629	120.0 mm   4.724 in	49.0 mm   1.929 in	Aluminium	49.0 mm	120.0 mm   4.724 in
1337630	128.0 mm   5.039 in	51.0 mm   2.008 in	Aluminium	51.0 mm	128.0 mm   5.039 in
1337631	160.0 mm   6.299 in	51.0 mm   2.008 in	Aluminium	51.0 mm	160.0 mm   6.299 in
1337632	180.0 mm   7.087 in	51.0 mm   2.008 in	Aluminium	51.0 mm	180.0 mm   7.087 in
1337633	200.0 mm   7.874 in	51.0 mm   2.008 in	Aluminium	51.0 mm	200.0 mm   7.874 in
1337634	235.0 mm   9.252 in	51.0 mm   2.008 in	Aluminium	51.0 mm	235.0 mm   9.252 in
1337635	112.0 mm   4.409 in	55.0 mm   2.165 in	Aluminium	55.0 mm	112.0 mm   4.409 in
1337636	117.0 mm   4.606 in	55.0 mm   2.165 in	Aluminium	55.0 mm	117.0 mm   4.606 in
1337637	120.0 mm   4.724 in	55.0 mm   2.165 in	Aluminium	55.0 mm	120.0 mm   4.724 in

Part Number	Overall Length	Overall Height	Handle Material	Grip Height	Mounting Hole Distance
1337638	125.0 mm   4.921 in	55.0 mm   2.165 in	Aluminium	55.0 mm	125.0 mm   4.921 in
1337639	128.0 mm   5.039 in	55.0 mm   2.165 in	Aluminium	55.0 mm	128.0 mm   5.039 in
1337640	160.0 mm   6.299 in	57.0 mm   2.244 in	Aluminium	57.0 mm	160.0 mm   6.299 in
1337641	179.0 mm   7.047 in	57.0 mm   2.244 in	Aluminium	57.0 mm	179.0 mm   7.047 in
1337642	192.0 mm   7.559 in	57.0 mm   2.244 in	Aluminium	57.0 mm	192.0 mm   7.559 in
1337643	300.0 mm   11.811 in	57.0 mm   2.244 in	Aluminium	57.0 mm	300.0 mm   11.811 in
1337644	400.0 mm   15.748 in	57.0 mm   2.244 in	Aluminium	57.0 mm	400.0 mm   15.748 in
1337645	50.0 mm   1.969 in	57.0 mm   2.244 in	Aluminium	57.0 mm	50.0 mm   1.969 in
1337646	112.0 mm   4.409 in	49.0 mm   1.929 in	Aluminium	49.0 mm	100.0 mm   3.937 in
1337647	124.0 mm   4.882 in	49.0 mm   1.929 in	Aluminium	49.0 mm	112.0 mm   4.409 in
1337648	132.0 mm   5.197 in	51.0 mm   2.008 in	Aluminium	51.0 mm	120.0 mm   4.724 in
1337649	140.0 mm   5.512 in	51.0 mm   2.008 in	Aluminium	51.0 mm	128.0 mm   5.039 in
1337650	172.0 mm   6.772 in	51.0 mm   2.008 in	Aluminium	51.0 mm	160.0 mm   6.299 in
1337651	130.0 mm   5.118 in	55.0 mm   2.165 in	Aluminium	55.0 mm	116.0 mm   4.567 in
1337652	134.0 mm   5.276 in	55.0 mm   2.165 in	Aluminium	55.0 mm	120.0 mm   4.724 in
1337653	146.0 mm   5.748 in	55.0 mm   2.165 in	Aluminium	55.0 mm	132.0 mm   5.197 in
1337654	178.0 mm   7.008 in	57.0 mm   2.244 in	Aluminium	57.0 mm	164.0 mm   6.457 in
1337655	193.0 mm   7.598 in	57.0 mm   2.244 in	Aluminium	57.0 mm	179.0 mm   7.047 in
1337656	210.0 mm   8.268 in	57.0 mm   2.244 in	Aluminium	57.0 mm	196.0 mm   7.717 in
463283	100.0 mm   3.937 in	50.0 mm   1.969 in	Aluminium	37.0 mm	100.0 mm   3.937 in
463284	112.0 mm   4.409 in	50.0 mm   1.969 in	Aluminium	37.0 mm	112.0 mm   4.409 in
463286	120.0 mm   4.724 in	50.0 mm   1.969 in	Aluminium	37.0 mm	120.0 mm   4.724 in
463287	120.0 mm   4.724 in	55.0 mm   2.165 in	Aluminium	38.0 mm	120.0 mm   4.724 in
463288	128.0 mm   5.039 in	50.0 mm   1.969 in	Aluminium	37.0 mm	128.0 mm   5.039 in
463289	128.0 mm   5.039 in	55.0 mm   2.165 in	Aluminium	38.0 mm	128.0 mm   5.039 in
463290	160.0 mm   6.299 in	50.0 mm   1.969 in	Aluminium	37.0 mm	160.0 mm   6.299 in
463291	160.0 mm   6.299 in	55.0 mm   2.165 in	Aluminium	38.0 mm	160.0 mm   6.299 in
463292	180.0 mm   7.087 in	55.0 mm   2.165 in	Aluminium	38.0 mm	180.0 mm   7.087 in
463293	192.0 mm   7.559 in	55.0 mm   2.165 in	Aluminium	38.0 mm	192.0 mm   7.559 in
463294	350.0 mm   13.78 in	55.0 mm   2.165 in	Aluminium	38.0 mm	350.0 mm   13.78 in
463308	100.0 mm   3.937 in	40.0 mm   1.575 in	Stainless Steel	32.0 mm	100.0 mm   3.937 in
463309	120.0 mm   4.724 in	40.0 mm   1.575 in	Stainless Steel	32.0 mm	120.0 mm   4.724 in
463310	150.0 mm   5.906 in	40.0 mm   1.575 in	Stainless Steel	32.0 mm	150.0 mm   5.906 in
463311	180.0 mm   7.087 in	40.0 mm   1.575 in	Stainless Steel	32.0 mm	180.0 mm   7.087 in
463313	350.0 mm   13.78 in	40.0 mm   1.575 in	Stainless Steel	32.0 mm	350.0 mm   13.78 in
463315	120.0 mm   4.724 in	45.0 mm   1.772 in	Stainless Steel	35.0 mm	120.0 mm   4.724 in
463316	150.0 mm   5.906 in	45.0 mm   1.772 in	Stainless Steel	35.0 mm	150.0 mm   5.906 in
463317	180.0 mm   7.087 in	45.0 mm   1.772 in	Stainless Steel	35.0 mm	180.0 mm   7.087 in
463319	350.0 mm   13.78 in	45.0 mm   1.772 in	Stainless Steel	35.0 mm	350.0 mm   13.78 in

Part Number	Overall Length	Overall Height	Handle Material	Grip Height	Mounting Hole Distance
463324	204.0 mm   8.031 in	42.0 mm   1.654 in	Aluminium	42.0 mm	180.0 mm   7.087 in
463325	224.0 mm   8.819 in	42.0 mm   1.654 in	Aluminium	42.0 mm	200.0 mm   7.874 in
463326	274.0 mm   10.787 in	42.0 mm   1.654 in	Aluminium	42.0 mm	250.0 mm   9.843 in
463327	324.0 mm   12.756 in	42.0 mm   1.654 in	Aluminium	42.0 mm	300.0 mm   11.811 in
463328	374.0 mm   14.724 in	42.0 mm   1.654 in	Aluminium	42.0 mm	350.0 mm   13.78 in
463329	424.0 mm   16.693 in	42.0 mm   1.654 in	Aluminium	42.0 mm	400.0 mm   15.748 in
463330	524.0 mm   20.63 in	42.0 mm   1.654 in	Aluminium	42.0 mm	500.0 mm   19.685 in
463331	624.0 mm   24.567 in	42.0 mm   1.654 in	Aluminium	42.0 mm	600.0 mm   23.622 in
465933	137.0 mm   5.394 in	40.0 mm   1.575 in	PA 6	39.0 mm	120.0 mm   4.724 in
465934	137.0 mm   5.394 in	40.0 mm   1.575 in	PA 6	39.0 mm	120.0 mm   4.724 in
465939	156.0 mm   6.142 in	56.0 mm   2.205 in	PA 6	33.0 mm	132.0 mm   5.197 in
465940	156.0 mm   6.142 in	56.0 mm   2.205 in	PA 6	33.0 mm	132.0 mm   5.197 in
465941	132.0 mm   5.197 in	50.0 mm   1.969 in	PA 6	34.0 mm	117.0 mm   4.606 in
465942	132.0 mm   5.197 in	50.0 mm   1.969 in	PA 6	34.0 mm	117.0 mm   4.606 in
466308	119.5 mm   4.705 in	35.0 mm   1.378 in	PA 6	29.0 mm	93.4 mm   3.677 in
466309	145.0 mm   5.709 in	35.0 mm   1.378 in	PA 6	34.0 mm	117.0 mm   4.606 in
466310	163.0 mm   6.417 in	40.0 mm   1.575 in	PA 6	38.0 mm	132.0 mm   5.197 in
466311	119.5 mm   4.705 in	35.0 mm   1.378 in	PA 6	29.0 mm	93.4 mm   3.677 in
466312	145.0 mm   5.709 in	35.0 mm   1.378 in	PA 6	34.0 mm	117.0 mm   4.606 in
466313	145.0 mm   5.709 in	35.0 mm   1.378 in	PA 6	34.0 mm	117.0 mm   4.606 in
466314	163.0 mm   6.417 in	40.0 mm   1.575 in	PA 6	38.0 mm	132.0 mm   5.197 in
466315	134.0 mm   5.276 in	45.0 mm   1.772 in	PA 6	35.0 mm	117.0 mm   4.606 in
491379	55.0 mm   2.165 in	41.0 mm   1.614 in	Aluminium	33.0 mm	55.0 mm   2.165 in
491380	88.0 mm   3.465 in	41.0 mm   1.614 in	Aluminium	33.0 mm	88.0 mm   3.465 in
491381	100.0 mm   3.937 in	41.0 mm   1.614 in	Aluminium	33.0 mm	100.0 mm   3.937 in
491382	120.0 mm   4.724 in	41.0 mm   1.614 in	Aluminium	33.0 mm	120.0 mm   4.724 in
491383	180.0 mm   7.087 in	41.0 mm   1.614 in	Aluminium	33.0 mm	180.0 mm   7.087 in
491385	100.0 mm   3.937 in	32.0 mm   1.26 in	Aluminium	25.0 mm	100.0 mm   3.937 in
491386	125.0 mm   4.921 in	50.0 mm   1.969 in	Aluminium	40.0 mm	125.0 mm   4.921 in
493514	35.0 mm   1.378 in	27.0 mm   1.063 in	Nylon	27.0 mm	28.5 mm   1.122 in
493515	35.0 mm   1.378 in	27.0 mm   1.063 in	Nylon	27.0 mm	28.5 mm   1.122 in
493516	63.5 mm   2.5 in	27.0 mm   1.063 in	Nylon	27.0 mm	28.5 mm   1.122 in
493518	83.1 mm   3.272 in	19.0 mm   0.748 in	PPN	19.0 mm	66.5 mm   2.618 in
493519	112.4 mm   4.425 in	25.0 mm   0.984 in	PPN	25.0 mm	89.9 mm   3.539 in
493520	140.0 mm   5.512 in	32.0 mm   1.26 in	PPN	32.0 mm	112.0 mm   4.409 in
493521	174.0 mm   6.85 in	39.0 mm   1.535 in	PPN	39.0 mm	138.0 mm   5.433 in
491384	235.0 mm   9.252 in	41.0 mm   1.614 in	Aluminium	33.0 mm	235.0 mm   9.252 in
491387	130.0 mm   5.118 in	40.0 mm   1.575 in	Aluminium	30.0 mm	130.0 mm   5.118 in
493517	63.5 mm   2.5 in	27.0 mm   1.063 in	Nylon	27.0 mm	28.5 mm   1.122 in

Part Number	Overall Length	Overall Height	Handle Material	Grip Height	Mounting Hole Distance
08411E	117.0 mm   4.606 in	28.5 mm   1.122 in	Zinc Alloy	23.5 mm	96.0 mm   3.78 in
08512E	76.0 mm   2.992 in	20.0 mm   0.787 in	Zinc Alloy	16.0 mm	64.0 mm   2.52 in
086-1E	140.0 mm   5.512 in	40.0 mm   1.575 in	PA 6	32.0 mm	122.0 mm   4.803 in
087200E	236.0 mm   9.291 in	55.0 mm   2.165 in	Aluminium	32.0 mm	200.0 mm   7.874 in
087400E	400.0 mm   15.748 in	55.0 mm   2.165 in	Aluminium	32.0 mm	400.0 mm   15.748 in
1871000E	1000.0 mm   39.37 in	80.0 mm   3.15 in	Steel	45.0 mm	1000.0 mm   39.37 in
187400E	400.0 mm   15.748 in	80.0 mm   3.15 in	Steel	45.0 mm	400.0 mm   15.748 in
187500E	500.0 mm   19.685 in	80.0 mm   3.15 in	Steel	45.0 mm	500.0 mm   19.685 in
187800E	800.0 mm   31.496 in	80.0 mm   3.15 in	Steel	45.0 mm	800.0 mm   31.496 in
287200E	200.0 mm   7.874 in	53.0 mm   2.087 in	Aluminium	34.0 mm	200.0 mm   7.874 in
287400E	400.0 mm   15.748 in	53.0 mm   2.087 in	Aluminium	34.0 mm	400.0 mm   15.748 in
20021986	140.0 mm   5.512 in	40.0 mm   1.575 in	PA	33.0 mm	122.0 mm   4.803 in
08412E	117.0 mm   4.606 in	28.5 mm   1.122 in	Zinc Alloy	23.5 mm	96.0 mm   3.78 in
08511E	76.0 mm   2.992 in	20.0 mm   0.787 in	Zinc Alloy	16.0 mm	64.0 mm   2.52 in
087500E	536.0 mm   21.102 in	55.0 mm   2.165 in	Aluminium	32.0 mm	500.0 mm   19.685 in
187600E	600.0 mm   23.622 in	80.0 mm   3.15 in	Steel	45.0 mm	600.0 mm   23.622 in
187700E	700.0 mm   27.559 in	80.0 mm   3.15 in	Steel	45.0 mm	700.0 mm   27.559 in
287300E	300.0 mm   11.811 in	53.0 mm   2.087 in	Aluminium	34.0 mm	300.0 mm   11.811 in
087300E	300.0 mm   11.811 in	55.0 mm   2.165 in	Aluminium	32.0 mm	300.0 mm   11.811 in
187300E	300.0 mm   11.811 in	80.0 mm   3.15 in	Steel	45.0 mm	300.0 mm   11.811 in