

Compact bovine ultrasound system

Simply, Smart, Focused

STANDARD
2
YEAR WARRANTY

Technology Driven
2-Year Warranty

BestScan®
S8 Goggles Linear



I-Scan®

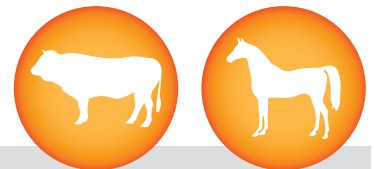

Applications

BestScan® S8 HD Goggles **Linear**

UTECH Medical Device Pty Ltd.

www.utechmd.com.au

Email: info@utechmd.com.au



Maximum comfort while you work

- **Hardware configuration:** enhanced processor+128 elements probe+32 channels
- **Environmental rating:** With IP67 waterproof protective case; IP67 (probe head), IP54 (main unit), IP45 (Remote controller)
- **Remote controller:** Strong LEMO type connector, backlight comfort silica gel Keyboard, ergonomics design
- **I-Scan® HD Goggles:** Strong LEMO type connector, I-Scan® V4 HD Ultrasound goggles.
- **Patent design:** Rectal Convex Curve Probe (wide field of view and deeper penetration) + Works with sizes of IFR™ Probe Introducer; Rectal Linear Probe + Works with sizes of IFR™ Probe Introducer;
- **The Exact Difference:** Linux insider with superior image quality, pseudo color imaging
- **Grid for estimation:** With grid on the image area, you can easily estimate the size of the target substance like follicle, fertilized egg, etc.
Workflow: Simplified workflow with focused on-farm veterinary exams, multi-language support
- **Storage and Export:** Images saved up to 1000 frames, and export via USB/SD supported
- **Battery:** Continuous scan greater than 8 hours with 2 batteries, replaceable battery design
- **Bright LCD monitor:** Works with direct wired Bright LCD monitor (optional)
- **Robust Body:** Fireproofing and anti-corrosion ABS, military level+ splash proof aluminum alloy transport case
- **Modular software:** Easy for upgrade, free lifetime upgrade to new versions

Accessories – professional your BestScan® S8

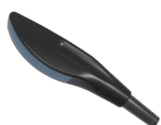

Bovine Scan Curve



Bovine Scan Linear



Equine Scan Linear



Ovine Scan Convex



IFR introducer

Specification

Transducer	7.5 Mhz 60mm linear (6.0/7.5/8.5/10MHz)	Peripheral Ports	USB, TV-OUT (for printer, Goggles)
Viewing options	I-Scan® Video goggles	Gain adjust	Overall, near, far
Battery life	5000mAh, 4h+ working time	Battery charger	home charger, car charger
Image memory	1000 frames	Weight	1.2 kg (2.6 lbs)
Cine-Loop	512 frames	Size	260mm x 154mm x 42mm
Image export	USB/SD supported	Casing	Splash proof aluminum alloy

UTECH Medical Device Pty Ltd.

www.utechmd.com.au

Email: info@utechmd.com.au

