

AGENT



SINCE
1988

Sheet metal
working
machines



ACCURL MACHINE TOOLS
CHINA | ACCURLUSA

INDUSTRIAL PARK IN BOWANG
MA'ANSHAN, ANHUI, CHINA

T | +86 555 2780 563
F | +86 555 2780 553
E | INFO@ACCURL.COM

www.accurl.com



WWW.ACCURL.COM

THIS CATALOG IS NOT A CONTRACTUAL DOCUMENT AND ONLY FOR ILLUSTRATIVE PURPOSES.
ACCURL RESERVES THE RIGHT TO MODIFY ANY SPECIFICATIONS WITHIN THIS CATALOG WITHOUT PRIOR NOTICE.

PINNACLE OF CNC BENDING TECHNOLOGY



A territory with a consolidated technological background and the inventiveness of the Accurl family are the ingredients of the birth of ACCURL, One of the first company to apply hybrid & electric servo bending technology to the bending of sheet metal in 1988, thus gaining a substantial technological edge over the competition.

It is a lean and dynamic company that builds customised automated cutting, welding and bending systems and has a widespread sales network around the world.

SINCE
1988

Sheet metal
working
machines



Shaping your future

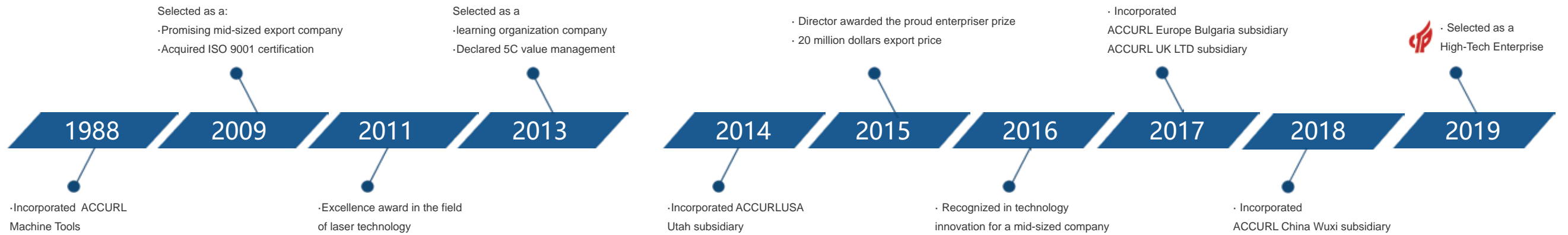



ECOLOGY

ACCURL has always respected ecological principles and was among the first to employ special water-based paints and steam washing machines for cleaning and degreasing instead of common chemical products.

ACCURL has always been complying with the laws for environment protection, developing a production system with respect for ecology.



RESEARCH

Thanks to its constant engineering research, ACCURL is qualified as a Research Laboratory by the MIUR (Ministry of Education, University and Research).

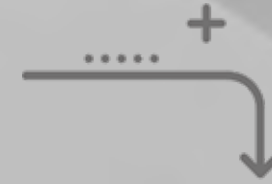

QUALITY

The quality of ACCURL products is granted by the permanent research and development activity for product's innovation and operator's safety.

PATENTS

- AP01 + AP02 CNC Sheet Follower Support
- 5-axis CNC Backgauge with X,R,X2,Z1,Z2
- 6-axis CNC Backgauge with X1,X2,R1,R2,Z1,Z2
- Shears with CE accumulator control
- Servo CNC Press Brake with CNC control



ACCURL's GENIUS are versatile, even in their basic configuration, and offer an enviable price/performance ratio.

Their performance level was so far available only on machines with much higher specifications and price levels. They are also evolutionary press brakes, which according to the needs of each user may be equipped with different equipment and devices to enhance their performance and productivity.

ACCURL® TECHNOLOGY AND PRECISION MORE ACCESSIBLE

Using all the technology ACCURL® model combines quality, performance and accuracy at a competitive price.

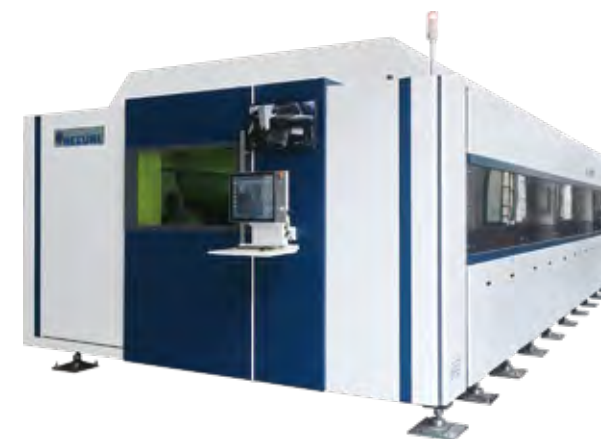

CNC PRESS BRAKE EURO PRO SERIES

ACCURL® EURO-PRO Series press brake features an CNC crowning system for improved quality, a servo driven back gauge system for increased speeds, and 3D capable graphical control unit to simulate bending sequences and collision points. Also has increased working speeds, stroke, daylight, and pressing capacities of PRO Series machines.

The future - as a result of rising energy costs and increasingly cost efficient speed-controlled drives offered on the market, variable-speed solutions are on the advance.



STANDARD EQUIPEMENT

- DELEM DA-58T CNC control unit with 2D graphics
- Y1, Y2 precision ram positioning
- Standard BGA-2 for X, R-axis (X=800mm,R=200mm)
- CNC motorized wave crowning
- HOERBIGER hydraulic valve block, pump and valves
- High Siemens efficiency motor– class IE3
- Stand By Function for energy-saving drive.
- Rear cover: Safety barriers (Category IV)
- Offline software Delem Profile-TL
- OEM Embedded Lazersafe Systems PCSS A0 + LZS-2 Block Laser

OPTIONAL EQUIPEMENT

- Control unit – DELEM DA66T or DELEM DA69T
- Hybrid Servo ECO Function (ECOPOWER technology) 4.0
- CE OEM Embedded LazerSafe PCSS A1 + IRIS
- BGA-4 for X=650mm X,R,Z1,Z2
- BGA-4 for X=800mm X,R,Z1,Z2 with Rear Supports
- BGA-6 for X=800mm X1,X2,R1,R2,Z1,Z2
- Delta X5 axis ± 125 mm with CNC Controlled
- Data M Angle Measurement System LaserCheck 11
- Angle Measurement System for Lazersafe PCSS IRIS Plus
- WILA Hydraulic Tools Clamping Systems
- AP01-AP02 Front Sheet CNC Followers for 2 x 160Kgs each.

HYBRID PRESS BRAE GENIUS PLUS SERIES



GENIUS range is fully configurable following the customer's need.

The standard range features models with capacities varying from 30 to 600 ton.

Furthermore, ACCURL is capable of building machinery with different configurations upon customers' request.



AFTER SALE SERVICE

ACCURL® enriches its service by means of quality and proximity to the customer.

The competence and experience acquired as manufacturer are key factors for the solutions provided and results achieved.

Failure as well as training or clarification of doubts. We employ highly skilled and experienced technicians to provide customer's with the best advice, searching for the best metal plate cutting and shaping solutions.

ACCURL' s customer is to have a service of excellence on previous and after-sale counseling and support. We believe that technical assistance is vital to the best equipment performance and, as such, we decided to provide free lifelong training to all our customer' s since 1988.

We guarantee immediate intervention for all emergencies, both regarding mechanical

We provide our customer' s with qualified technical service, always working with the following goals:

- PROBLEMS SOLUTION AT THE FIRST CONTACT;
- QUICK ANSWER;
- ASSURED QUALITY.

EB · ICON SERVO ELECTRIC PRESS BRAKE

The eB-Icon features the advantages of high acceleration, deceleration and fast response times of the servo-electric drive system. Compared to conventional press brakes considerable productivity increase can be reached; reduction of cycle times by up to 30 % and more is the reality.



eB-Icon is always the best even if compared to a machine that on the catalogue seems to be fast

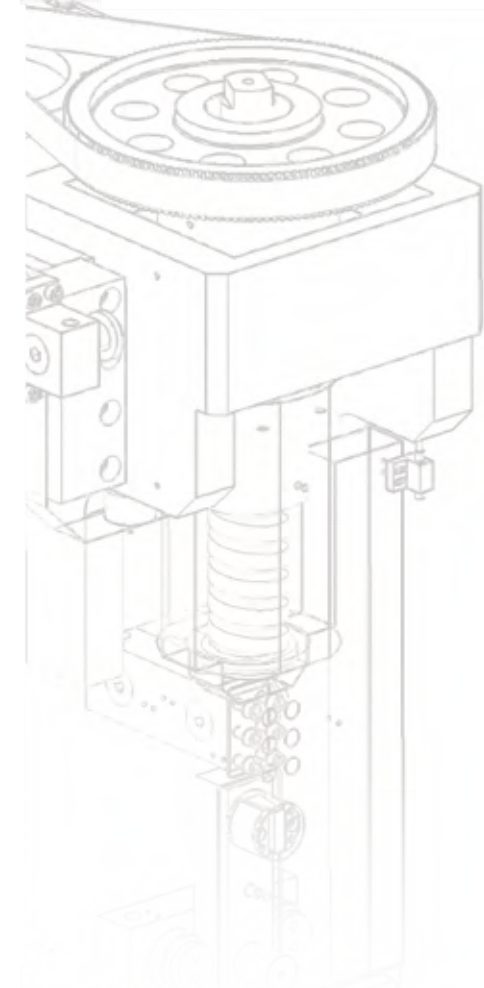
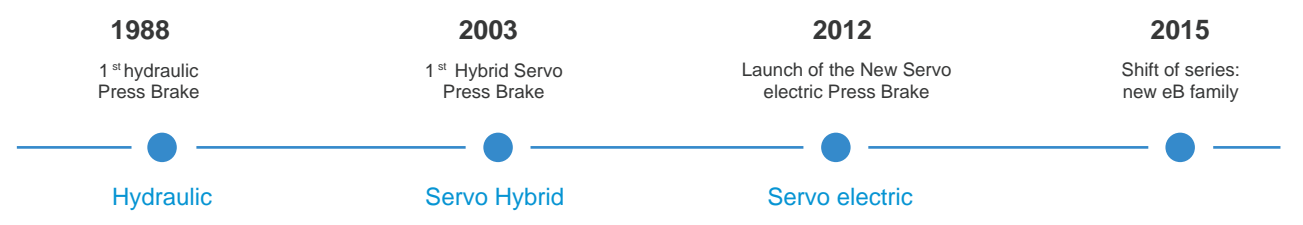
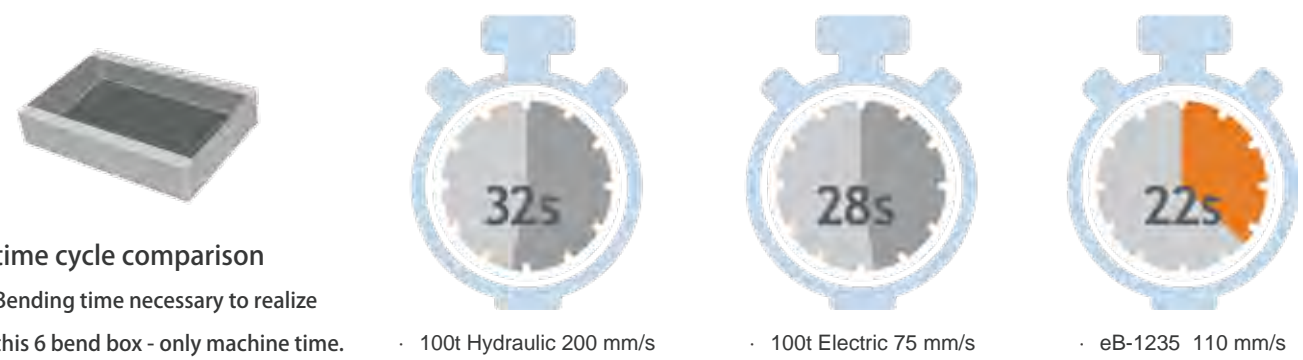

“EXCEED YOUR EXPECTATIONS”



EB · ICON

eB-Icon is a fully electric machine. Using SYNCHRO technology that controls 2 axes during the bending, thus being able to compensate the axes Y1 and Y2 independently. This system developed by ACCURL includes the drive through 2 high-quality ball screws with low noise, guided by two servo motors and helical gear boxes in order to guarantee the best performance and durability. This reduce all effects caused by inertia compared to similar systems of the belt. This press brake is integrated with the highest technology coupled with a friendly use. This model is a top machine that guarantees high precision and competitiveness.

- ADVANTAGES**
- Short cycle time
 - Low energy consumption
 - Low maintenance
 - Low noise

NO

- NOISE
- HYDRAULIC OIL
- HYDRAULIC FILTER
- HYDRAULIC SEALS
- VALVES
- CYLINDERS
- DWELL TIMES

COMPARATIVE

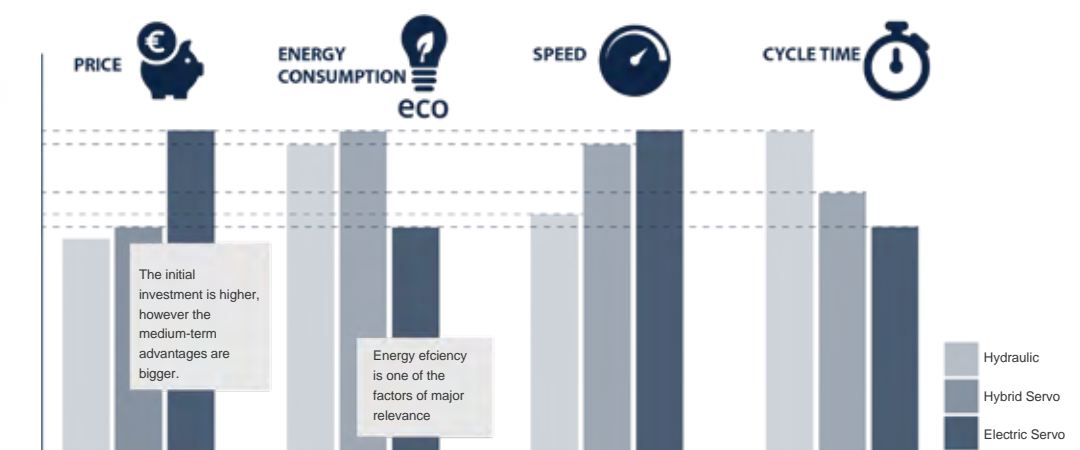

TECHNICAL SPECIFICATION

	Capacity ton	Bending length mm	Daylight mm	Stroke mm	Throat depth mm	Approach speed mm/s	Return speed mm/s	Bending speed mm/s
eB · Icon B0825	25	800	370	100	200	190	190	0.2-50
eB · Icon B1235	35	1250	420	140	260	180	180	0.2-50
eB · Icon B1340	40	1300	420	140	400	190	180	0.2-50
eB · Icon B2040	40	2000	420	140	400	180	175	0.2-50
eB · Icon B2060	60	2000	420	150	355	160	160	0.2-50
eB · Icon B2585	85	2500	470	150	400	120	120	0.2-50
eB · Icon B30125	125	3000	500	200	460	100	100	0.2-50

READY FOR INDUSTRY 4.0

ACCURL® puts industry 4.0 within the reach of companies™

The future of manufacturing is undoubtedly digital. With the fourth industrial revolution taking over (a.k.a Industry 4.0), the Industrial production must adapt and cannot escape to the new reality of Industry 4.0, a production model in which all elements of the chain must be interconnected and communicate with one another.

- Digitally connected manufacturing is key to increasing the levels of productivity and efficiency, also achieving a completely transparent process since these digital solutions and automation provide production information in real time.



Designed in a responsive web environment, possibility to use Delem Profile T3D softwares to simulate, it is accessible from smartphones and tablets also the bending process and



Make corrections to the bending process easily on the tablet PC control!

CONTROL SYSTEM

	DA-52s	DA-58T	DA-66T	DA-69T				
Delem								
Axes	4	4	4	6	12	12	12	12
Screen	10"	10"	15"	15"	17"	15"	17"	19"
2D graphic view	-	●	●	●	●	●	●	●
3D graphic view	-	-	-	●	●	●	●	●
3D programming	-	-	-	-	○	●	●	○
Auto tooling selection	-	-	-	-	○	●	●	○
Touch screen	●	●	●	●	●	●	●	●
USB ports	1	2	1	2	2	4	2	4
2D DXF import	-	-	-	-	-	●	●	●
3D IGES/STEP import	-	-	-	-	-	-	●	○
3D Offline import	-	-	-	-	○	○	●	○
Export DXF 2D FP	-	-	-	-	-	○	●	○
Offline software	Profile TL	Kvara PC	Profile TL	Kvara PC	Profile TL	Kvara PC	PC Profile T3D	EsaBend 3D - M
esa								
	ESA S630	ESA S640	ESA S650W	ESA S660W				

● Standard ○ Optional

OEM EMBEDDED LAZERSAFE SYSTEM

Performance without compromise.™

ACCURL® use LazerSafe LZS-2 guarding system offers a highly effective solution for both operator safety and machine productivity. Designed for use with Lazer Safe's PCSS A Series, the Lazersafe is category 4 compliant and meets the world's most demanding international safety standards (CE Certified Category 4 Safety Controller with integrated).

Advantage

- The most advanced laser systems
- Safety PLCs with manage and monitor
- Constant monitoring of parameters related to safety

Optional

- Lazersafe-PCSS IRIS
- Lazersafe-PCSS A0 LZS-XL
- Lazersafe-PCSS A1 LZS 005-XL (Tandem Adaptor System)

Advantage

- CLASS 1 Dual Block laser
- Fast response time
- Safety speed automatically monitored
- Stopping distance automatically monitored
- Status LEDs - Power / Front/middle/rear Sensors
- Tray mode for high speed bending of tray & box shapes
- Complex shapes can be achieved in high speed with Tray/Box Mode.

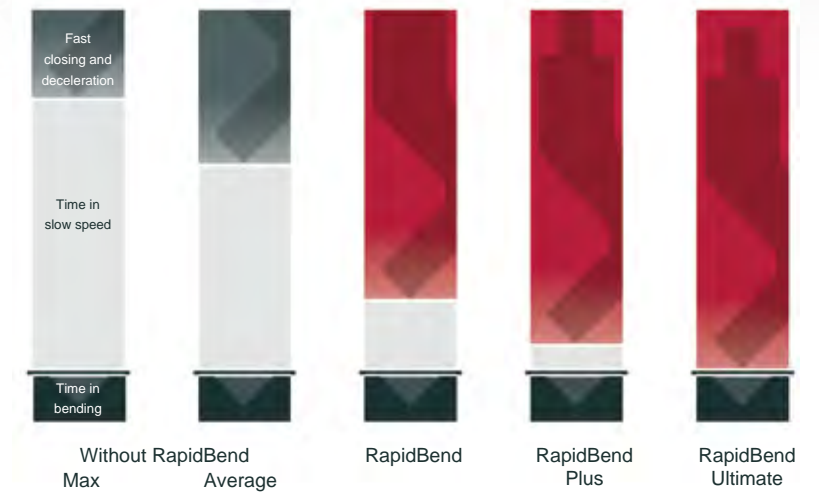

AUTOMATIC TOOL ALIGNMENT

- The systems with a camera receiver feature automatic tool alignment that eliminates the need for precise manual adjustment, and this process can also be fully automated in the CNC via SmartLink, eliminating the need for the operator to press the TOOL ALIGN button.

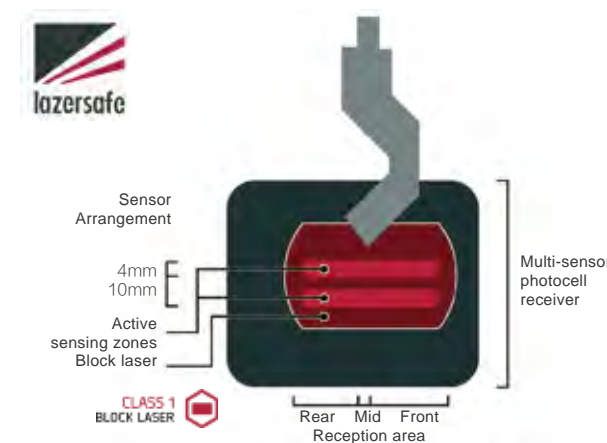

Standard with LZS-2 Block Laser System

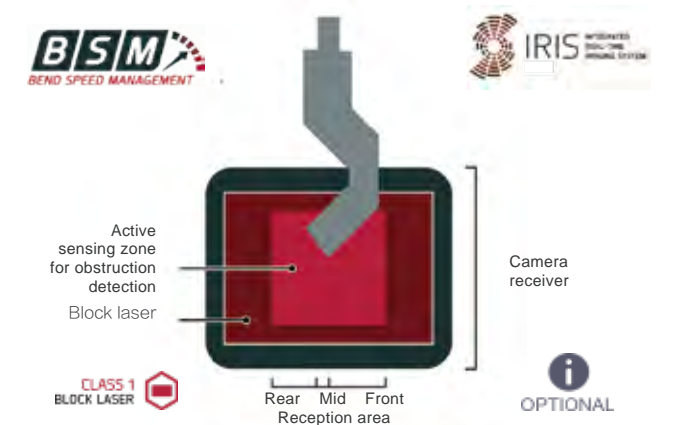

Applies to LZS-XL and IRIS Block Laser System

Certification and standards compliance:

- The OEM Embedded Systems LZS Series and IRIS Series hardware and software is CE Certified and compliant with all international press brake safety standards including EN12622, ANSI B11.3-2012, CSA Z142-10 and NR12.



QUICK CLAMPING

When there are frequent tooling changes, punches or dies can be changed over in a short time by using the quick clamps. The time saved will be more how many times it will be necessary to change the tools.

- In all top clamping the punches can be removed directly from the front, so it is not necessary to slide it on one side.
- This operation compared to conventional allows a reduction of times greater than 8x.



WILA PUNCH TOOL CLAMP HOLDERS

Increase your pressbrake productivity:

The Wila' s 'New Standard' Tooling System has become market leader for precision, quality and flexibility for the Accurl press brake. the WILA' s state-of-the-art clamp systems offer optional for the ultimate efficiently changing tools with Smart Tool Locator® (STL)* have made the changeover process easier and safer. and Premium is available as an option.



Advantage:

- Hydraulic power source
- Quick clamping for europe style tooling
- Simple push-button loading
- Max. load head/shoulders 180 t/m



WILA NEW STANDARD TOOL HOLDERS

TOOL HOLDERS New Standard Pro:

This WILA® system enables the user to offset deformations of the beam while bending. thus, the angle is keeping constant along the entire plate length.

The advantages

- Always provides an extremely consistent bending angle
- Available with automatic or manual drive systems
- Mounted on the right-hand side as standard
- Aluminum Cover strip with integrated slide rule for exact tool positioning
- Compact design which is practically maintenance free



BACK GAUGES

ACCURL® press brake are provided are equipped with BGA Series CNC backgauge constituted by a solid structure in order to assure the best repetitiveness and high precision in axes positioning.



BGA-2
2 axes Y1-Y2-X-R



BGA-4
4 axes Y1-Y2-X-R-Z1-Z2



BGA-5
5 axes Y1-Y2-X1-R-X5-Z1-Z2

BGA-SERIES

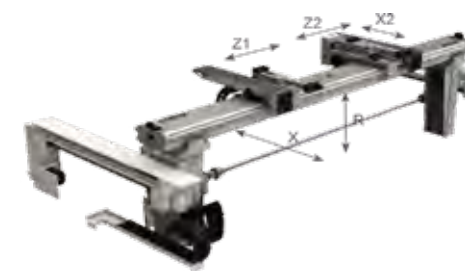

BGA	X [Ⓢ]	R [Ⓢ]	Z1 [Ⓢ]	Z2 [Ⓢ]	X2
Stroke (mm)	750	150	UNDER REQUEST	UNDER REQUEST	190
Speed (mm/s)	500	300	800	800	200
Precision (mm)	±0,02	±0,05	±0,05	±0,05	±0,02
Type of motor	BRUS HLESS	BRUS HLESS	BRUS HLESS	BRUS HLESS	BRUS HLESS
Mechanical system	SCREW	SCREW	RACR	RACR	SCREW

BGA-6

Finger stop Mod. 9L[Ⓢ]



Finger stop Mod. 9P



OPTIONAL



BGA-6	X 1	X2	R1	R2	Z1	Z2
Stroke (mm)	800	800	200	200	UNDET REQUEST	UNDET REQUEST
Speed (mm/s)	600	600	300	300	1000	1000
Precision (mm)	+0,02	+0,02	+0,02	+0,02	+0,05	+0,05
Type of motor	BRUSHLESS	BRUSHLESS	BRUSHLESS	BRUSHLESS	BRUSHLESS	BRUSHLESS
Mechanical system	SEREW	SEREW	SEREW	SEREW	RACK	RACK

SUPPORTS

FRONTAL SUPPORTS

SFS



- Supported on sliding guides;
- Can be placed at any point along the length;
- Manual height regulation;
- Millimetric scale;
- Ball transfer units to facilitate handling parts;
- Adjustable plate stop;
- Device for approaching to the die;
- Removable supports;
- Load capacity:
 - <200 Ton: 100 kg per support
 - ≥ 200 Ton: 150 kg per support.

OPTIONAL

REAR SUPPORTS

SPA



With the Thin-support system even thinner sheets are always correctly positioned and guided:

SPA Thin supports system are installed in the fingers of the back gauge. They can be activated in predefined bending and enable the plate to slide until it lies adjacent to the back gauge.

Advantage:
Back supports have ball sliders and brushes to protect even the most delicate surfaces
Load capacity – 30 kg per support.

OPTIONAL

BENDING ANGLE MEASUREMENT

LASERCHECK



ACCURL® iMeasure system manufactured by Data M Engineering, is a bend angle measurement and correction system by means of a laser beam. Detection is carried out in this way .

- A laser beam is projected on the sheet metal surface
- The camera detects the laser beam
- The angle between the beam and the camera axis determines the bend angle.
- Force reduction + calculation of the springback
- Automatic angle correction

OPTIONAL

FOLLOWER SUPPORTS

AP01/AP02



- Automatic bending follower supports;
- AP1 - AP2 CNC-controlled interpolated axes;
- Recommended for heavy parts or large thin plate;
- Bend as closed as 70°;
- Load capacity – 180 kg per support;
- Brush and support shaft dim 350x900 up to 1200 mm.

OPTIONAL

NEW Hybrid ECO FUNCTION

ACCURL® promotes a friendly environmental policy, and, as such, all our equipment features the Hybrid Eco Function.

- This hybrid servo-drive system positioning accuracy at target position.
- The depending on cycle characteristics and rating, servo pump drives achieve energy savings.

- Energy Saver
- Accurate on each cycle
- Economy Proof
- Hi-Speed & Repeatability



OPTIONAL

Maximum stamina!
It bends and bends and bends....

Easy parameter finding!
Quality Higher Operation Speeds

Faster & more efficient!
Speed more than %40 Oil Save

More faster-on-time!
Save time and costs.....

SAVINGS WITH STANDBY TAKING INTO ACCOUNT THE POWER

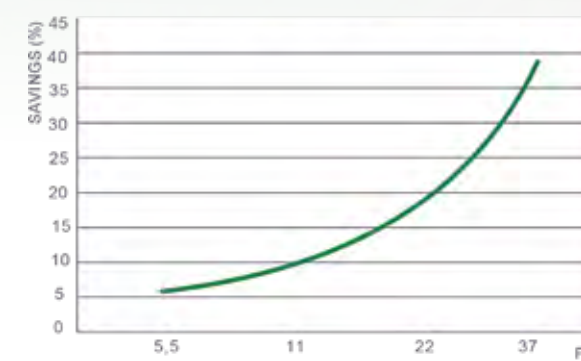

SAVINGS WITH STANDBY TAKING INTO ACCOUNT THE POWER

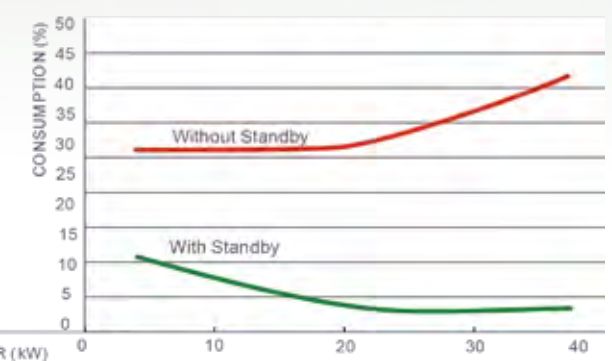

CROWING TABLE

This ACCURL® Pro CNC Crowning system enables the user to offset deformations of the beam while bending. thus, the angle is keeping constant along the entire plate length.

Advantage:

- Easy reversibility of tools because of symmetrical adaption
- Quick clamping for the dies
- Suitable for Europe standard , Amada Tyoe & Single V Dies.

Optional:

- WILA Hydraulic Clamping
- WILA New Standard clamping
- WILACNC Crowning adjustment

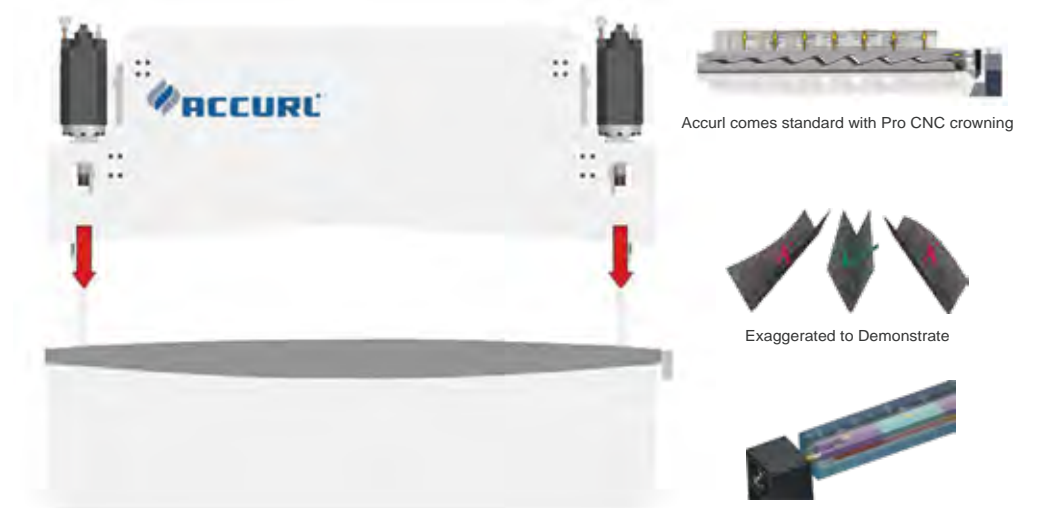

Accurl comes standard with Pro CNC crowning

Exaggerated to Demonstrate

SPECIFICATIONS

Model	Bending length	Tonnage	Throat Depth	Beam Stroke	Daylight	Approach Speed	Slow Speed (Work Speed)	Return Speed	Oil Capacity	Back Gauge Stroke	Motor Power	Dimensions					Approx. Weight
												Total Length (A)	Total Height (B)	Total Width (C)	Distance Between Frames	Height Under the Floor	
	mm	ton	mm	mm	mm	mm/s	mm/s	mm/s	Lts	mm	kW	mm	mm	mm	mm	mm	kg
EURO PRO B1330	1300	30	250	200	395	180	0-10	130	55	500	3	2050	2290	1420	1220	0	2900
EURO PRO B1540	1500	40	250	200	395	180	0-10	130	55	500	4	2780	2290	1420	1600	0	3300
EURO PRO B2070	2000	70	300	200	395	180	0-10	120	125	500	5.5	2850	2520	1530	1600	0	4650
EURO PRO B20110	2000	110	400	200	430	200	0-10	180	125	800	7.5	2880	2520	1550	1600	0	6300
EURO PRO B2580	2500	80	320	200	395	180	0-10	120	125	800	5.5	3350	2520	1530	2100	0	5600
EURO PRO B25110	2500	110	400	200	430	180	0-10	180	125	800	7.5	3650	2630	1800	2100	0	7100
EURO PRO B3280	3200	80	400	200	430	180	0-10	160	125	800	7.5	3850	2520	1530	2600	0	6500
EURO PRO B32110	3200	110	400	200	430	180	0-10	160	125	800	7.5	3880	2520	1550	2600	0	8100
EURO PRO B32135	3200	135	400	200	430	190	0-10	130	160	800	11	3880	2650	1860	2600	0	8500
EURO PRO B32715	3200	175	400	200	430	180	0-10	120	200	800	15	3900	2710	1780	2600	0	10000
EURO PRO B32220	3200	220	400	200	395	160	0-10	120	200	800	18.5	3920	2740	1930	2600	0	11000
EURO PRO B32250	3200	250	400	250	465	180	0-10	110	300	800	22	3950	3180	2020	2600	0	13000
EURO PRO B32300	3200	300	400	250	465	170	0-10	110	345	800	30	3950	3180	2020	2600	0	14000
EURO PRO B40110	4000	110	300	200	430	160	0-10	125	125	800	7.5	4880	2520	1550	3100	0	8900
EURO PRO B40135	4000	135	400	200	430	190	0-10	125	160	800	11	4880	2650	1860	3100	0	10000
EURO PRO B40175	4000	175	400	200	430	180	0-10	115	200	800	15	4900	2720	1900	3100	0	11000
EURO PRO B40220	4000	220	400	200	470	160	0-10	115	200	1000	18.5	4920	2740	1930	3100	0	13200
EURO PRO B40250	4000	250	400	250	470	180	0-10	110	300	1000	22	4920	3180	2020	3100	0	15300
EURO PRO B40300	4000	300	400	250	470	160	0-10	110	345	1000	30	4960	3180	2020	3100	0	16800
EURO PRO B40400	4000	400	300	300	520	170	0-10	100	380	1000	37	4980	3470	2300	3100	0	24000
EURO PRO B40450	4000	450	300	300	520	150	0-10	100	380	1000	37	4980	3510	2300	3100	0	25600
EURO PRO B40500	4000	500	300	300	520	150	0-10	90	380	1000	37	5000	3520	2360	3100	0	28000
EURO PRO B40600	4000	600	300	350	570	140	0-10	80	500	1000	55	5020	3580	2500	3100	900	31000
EURO PRO B60110	6000	110	400	200	430	170	0-10	115	125	800	7.5	6880	2700	1900	5100	0	13000
EURO PRO B60135	6000	135	400	200	430	170	0-10	115	160	800	11	6880	2780	1900	5100	0	15000
EURO PRO B60175	6000	175	400	200	430	170	0-10	110	200	800	15	6900	2880	2000	5100	0	18000
EURO PRO B60220	6000	220	400	200	470	150	0-10	100	200	1000	18	6920	2980	2050	5100	1150	21000
EURO PRO B60250	6000	250	400	250	470	150	0-10	100	300	1000	22	6960	3380	2100	5100	1200	27000
EURO PRO B60300	6000	300	400	250	470	150	0-10	100	345	1000	30	7000	3380	2100	5100	1200	31000
EURO PRO B60400	6000	400	400	300	520	140	0-10	75	380	1000	37	7040	3520	2430	5100	1350	40000
EURO PRO B60450	6000	450	400	300	520	140	0-10	75	380	1000	37	7040	3520	2430	5100	1350	50000
EURO PRO B60500	6000	500	400	300	520	140	0-10	75	380	1000	37	7080	3660	2430	5100	1700	55000
EURO PRO B60600	6000	600	400	350	570	130	0-10	75	500	1000	55	7080	3760	2500	5100	1700	65000
EURO PRO B70600	7000	600	400	300	640	70	0-10	70	650	1000	2x37	7080	3760	2800	5050	1800	67000
EURO PRO B80800	6000	800	500	400	820	70	0-10	70	800	1200	2x37	7000	3760	2950	5760	1800	102000
EURO PRO B80800	8000	800	500	400	820	70	0-10	70	950	1200	2x37	7160	3760	3050	6200	1800	115000
EURO PRO B100800	10000	800	600	400	820	70	0-10	70	1200	1200	2x45	7240	3900	3100	6200	1800	130000
EURO PRO B601200	6000	1200	600	400	920	65	0-10	65	1200	1250	2x45	7000	3900	3200	4760	1800	130000
EURO PRO B801200	8000	1200	600	400	920	65	0-10	65	1500	1250	2x45	7160	3900	3300	5200	1800	155000
EURO PRO B801600	8000	1600	600	400	920	60	0-10	60	1500	1250	2x55	7200	4200	3400	6200	1800	190000

BENDING TABLE

Required bending power (Ton/m)

Rm=42 daN/mm²-Rm=70 daN/mm²

S (mm)																					
R	B	V	0,5	0,6	0,8	1	1,2	1,5	2	2,5	3	4	5	6	8	10	12	15	20	25	30
0,5	3	4	4 ₇	6 ₁₀	12 ₂₀																
0,7	3,5	5	3 ₅	5 ₈	9 ₁₅	15 ₂₅															
0,8	4	6	2 ₄	3 ₆	7 ₁₂	11 ₁₉	18 ₃₀														
1	5,5	8		2 ₄	5 ₈	8 ₁₃	12 ₂₁	21 ₃₅													
1,3	6,5	10			4 ₆	6 ₁₀	9 ₁₅	15 ₂₆	30 ₅₀												
1,5	8	12				5 ₈	7 ₁₂	12 ₂₀	23 ₃₈	39 ₆₆											
2	10,5	16					5 ₈	8 ₁₃	16 ₂₆	27 ₄₅	44 ₇₁										
2,5	13	20						6 ₁₀	12 ₁₉	20 ₃₃	31 ₅₂	60 ₁₀₁									
3,2	16,5	25							9 ₁₅	14 ₂₄	23 ₃₈	44 ₇₃	76 ₁₂₆								
4,4	21	32								11 ₁₈	16 ₂₇	32 ₅₃	54 ₉₀	85 ₁₄₂							
5	26	40									12 ₂₁	23 ₃₈	39 ₆₆	62 ₁₀₃	121 ₂₀₂						
6,5	32,5	50										18 ₃₀	29 ₄₈	45 ₇₆	88 ₁₄₇	151 ₂₅₂					
8	41	63											22 ₃₇	33 ₅₅	70 ₁₁₇	109 ₁₈₂	173 ₂₈₈				
10	52	80												25 ₄₂	46 ₇₇	79 ₁₃₁	124 ₂₀₇	213 ₃₅₄			
12	65	100													35 ₅₉	58 ₉₆	91 ₁₅₁	155 ₂₅₈	302 ₅₀₄		
15	81,5	125														44 ₇₄	66 ₁₁₀	113 ₁₈₉	220 ₃₆₇	373 ₆₃₀	
20	104	160															50 ₈₃	81 ₁₃₅	263 ₄₄₈	425 ₇₀₉	
25	130	200																62 ₁₀₄	115 ₁₉₂	197 ₃₂₈	310 ₅₁₇
37	163	250																	89 ₁₄₈	144 ₂₄₀	227 ₃₇₈
45	195	300																		120 ₂₀₀	173 ₂₈₈

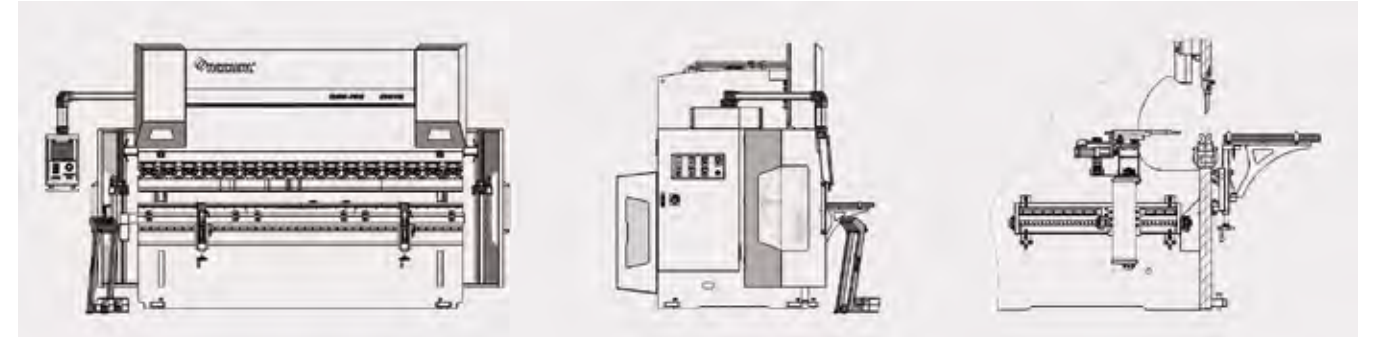
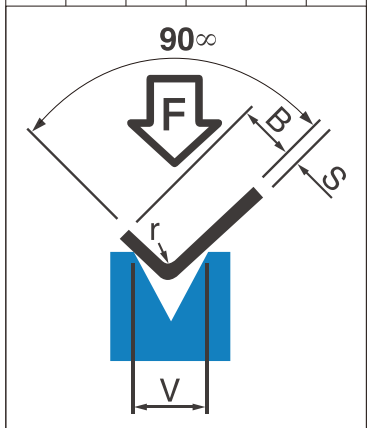

HYDRAULIC GUILLOTINE SHEARS MASTER SERIES

The Genius MS series is the top of the line, incorporating all the latest technology to offer the highest level of functionality. With our hydraulic angle setting and user friendly control panel, you will be able to easily cut different material thicknesses. This series is well named as only the most intelligent machines could provide speed, precision, accuracy and repeatability as our Genius S shears.



STANDARD EQUIPEMENT

- CE-Norm
- Heavy duty steel construction & Stress relieved frame
- User friendly CNC Touchscreen control unit ELGO-P40T Touch
- Automatically adjusted rake angle by CNC
- Adjusted cutting length by CNC
- Ball integrated front tables
- Ball screw back gauge, 1000mm
- Flip-up finger guards 1000mm
- Squaring arm with scale T-Slot (L=1500mm)
- Support arms T-Slot & Tilting stop (L=1000mm)
- Illumination & Shadow line
- Automatically pressure adjusted solid holddowns
- Top and bottom blades with four sides

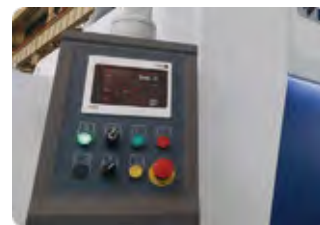

ELGO P40T CNC Control System



Germany Bosch-Rexroth Hydraulic System



Square support arm with 1000mm scale and flip



BackGauge with Linear Guide



ELGO TOUCH P40T CNC SYSTEM

Cuttings are easier With ELGO TOUCH P40T

With easy to use interface P40T enables perfect cutting in seconds by endless programming and material entrance feature.

OPTIONAL EQUIPEMENT

- DELEM DAC360T CNC System
- High speed (Stroke/Min)
- Laser Cutting Line
- Light curtains for finger protection
- Pneumatic sheet support ACCURL I
- Pneumatic sheet support with return to sender
- Pneumatic sheet support ACCURL IV
- Sheet support device with belt conveyor and scrap container
- Stacker + Alignment System
- Hydraulic anti-twisting
- Special throat depth
- Back gauge 1250 mm
- Hydraulic swing-up back gauge
- Oil coolant
- Oil heater
- Central lubrication manual
- Central lubrication motorized
- Adjustable angle stop 0-180°
- Add. Support arms
- Special blades
- Control Panel on opposite position
- Temperature measurement
- Overseas special packaging
- CNC front feeding system

PNEUMATIC SHEET SUPPORT SYSTEM(OPTIONAL)

Monobloc Panel Type support system:

Avoids hanging down the wide and thin sheets via pneumatic table support and provides more precise cuts

ACCURL I

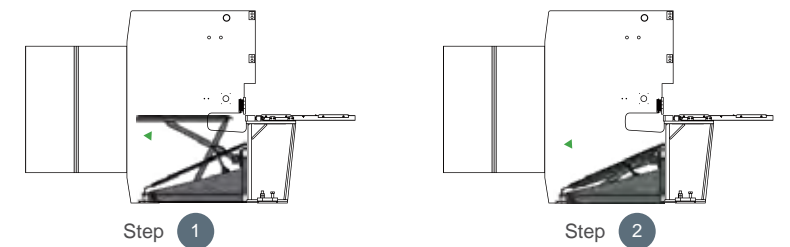

ACCURL IV

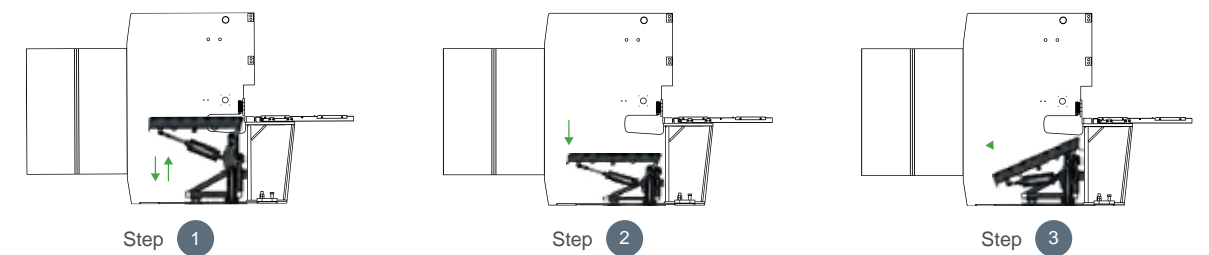

SPECIFICATIONS

Type	Cut Thickness mm	Cut length mm	Shear Angle Degree	SPM min-1	Back Gauge mm	Throat Depth mm	Main Motor kw	Net Weight kg	Outline Size (LxWxH) mm
MS8-6x2500	6	2500	0.5°-1.5°	16	800	100	7.5	5600	3300x1800x2100
MS8-6x3200	6	3200	0.5°-1.5°	14	800	100	7.5	6500	4000x1800x2100
MS8-6x4000	6	4000	0.5°-1.5°	12	800	100	7.5	8400	4800x1900x2200
MS8-8x3200	8	3200	0.5°-1.5°	12	800	100	7.5	7400	4100x1900x2150
MS8-8x4000	8	4000	0.5°-2.0°	11	800	100	11	9500	4800x1900x2300
MS8-10x3200	10	3200	0.5°-2.0°	8	800	120	11	8500	4000x1850x2250
MS8-10x4000	10	4000	0.5°-2.0°	8	800	120	11	11000	4800x2000x2390
MS8-13x3200	13	3200	0.5°-2.0°	7	800	120	18.5	9200	4000x1900x2350
MS8-13x4000	13	4000	0.5°-2.2°	6	800	130	18.5	12800	4800x2000x2490
MS8-13x6000	13	6000	0.5°-2.4°	6	1000	150	18.5	26000	7100x2420x3000
MS8-16x3200	16	3200	0.5°-2.5°	6	800	130	22	12000	4300x2100x2500
MS8-16x4000	16	4000	0.5°-2.5°	6	1000	130	30	26500	4850x2150x2550
MS8-16x6000	16	6000	0.5°-2.5°	6	1000	130	30	33000	7100x2300x2950
MS8-16x8000	12	4000	0.5°-2.5°	5	1000	130	30	75500	9000x3280x3270

FIBER LASER CUTTING MACHINE SMART SINGLE TABLE SERIES

Our ACCURL team now introduces its newest generation in tube and profile processing technology – the fiber laser tube cutting system. Technological innovation has brought us the Smart KJG Series. With exceptional reliability and high beam quality, our fiber laser cutting machines continue to be leaders amongst the competition.



STANDARD EQUIPEMENT

- User friendly Cypcut Windows CAD/CAM CNC control unit.
- Unique features:
- Very easy to operate.
- Quick and easy installation.
- Low investment and operating costs.
- The most cost-efficient solution for every requirement.
- Flexible beam path
- High output power
- High optical quality
- Up to %300 faster cutting
- High wall plug efficiency (>%30)
- Copper, brass cutting ability
- Advanced Raytools cutting head (with air cross blast).
- High performance and high accuracy rack and pinion system.

OPTIONAL EQUIPMENT

- HYPCUT Touch FSCUT8000 TwinCAT CNC System
- Shuttle Table and Clean Room
- Table size 1500x4000mm
- Table size 2000x4000mm
- Pipe cutting system(φ220mm / 3000mm)
- Cutting Head from PRECITEC- Manual(500w-1500w)
- USA.IPG / nLIGHT / China.Raycus Fiber Laser Power(500w-2kw)

FIBER LASER CUTTING MACHINE GENIUS SERIES WITH CE CLEAN ROOM

Incredibly fast and flexible, the Genius KJG fiber laser cutting system is ideal for ultra-high speed cutting of thin sheet materials. The Genius KJG has the ability to cut a wide range of ferrous and non-ferrous metals while maintaining low cost operation.

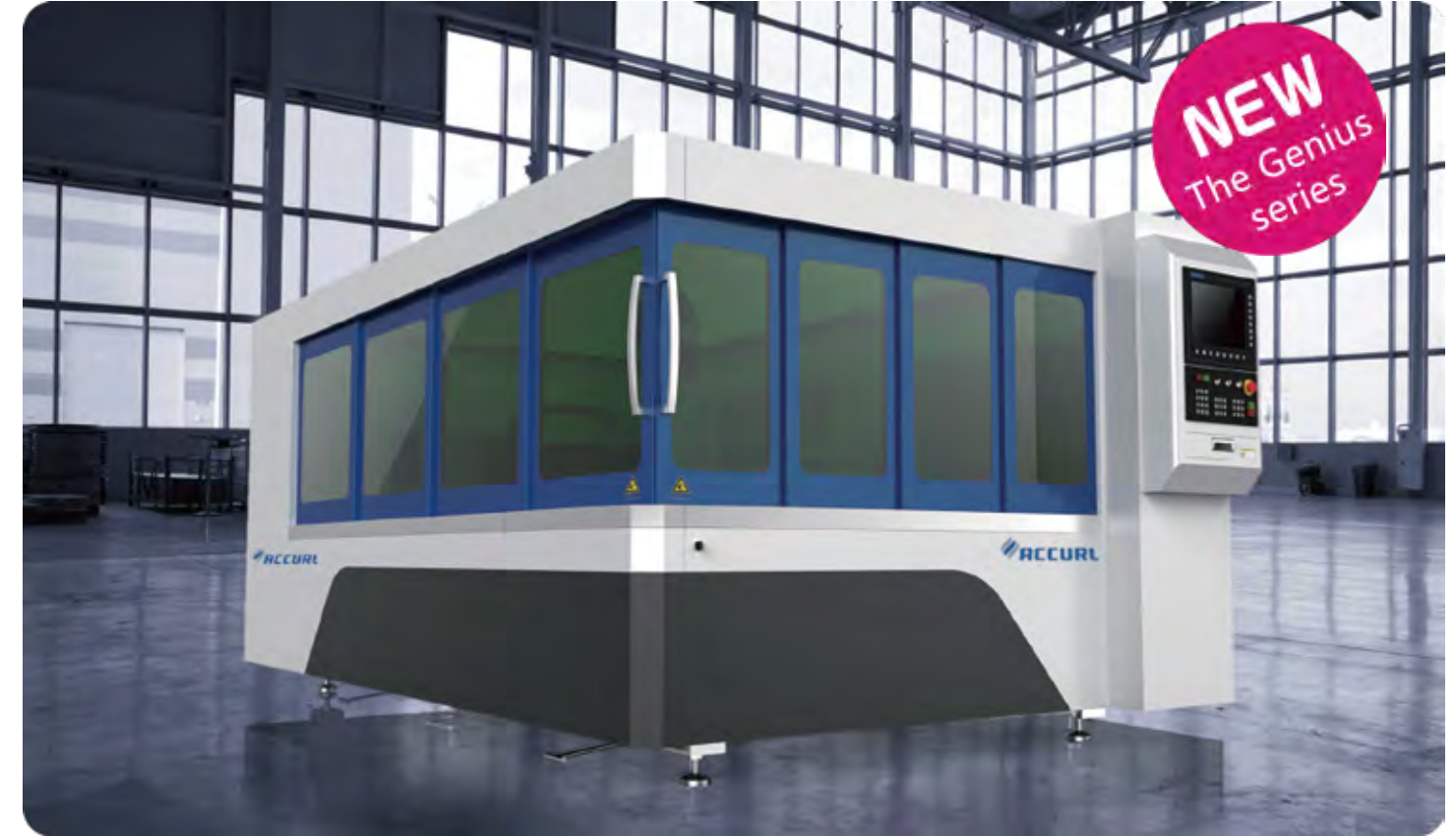

MAIN FEATURES

- Excellent cutting quality for fine thickness and medium thickness sheet metals.
- Maximum simultaneous positioning speed: 160m/min.
- Acceleration speed: 14 m/ s² (1.5G).
- Precision: + - 0.05 mm.
- Energy efficiency: greatly reduced power consumption.
- IPG Resonator. Power output from 500W to 1500w .
- RayTools cutter cutting head with power output up to 2kw.
- Precitec HP cutting head for power output of more than 2kw.
- Fully enclosed and cabbined to ensure maximum operator protection.
- Effective high to low pressure gas exchange system.
- Capacitive Sensor, high pressure cutting head.
- Automatic mechanized Nesting power output control function.
- Automatic time and unit cost calculation function.
- Network connection from external.
- Smoke extraction (included in series models).
- 3 point reference sensor (sheet metal rotation detector).
- Collection of work pieces and trimmings.
- Dual proportional valve control system for different gas pressures and special system for high pressure cutting.

FIBER LASER CUTTING MACHINE SMARTLINE SERIES

ACCURL Fiber lasers outshine with its fast cutting and energy efficiency abilities when especially its compared to CO2 Easy use, maintenance and service has been achieved by the high technology of Fiber Lasers. Globally recognized efficient components used in ACCURL Fiber Lasers add value to your company.



STANDARD EQUIPEMENT

- CypCut Fscut 2000 CNC System
- Reliable laser fiber source from 1 to 6 kw
- Japan Shimpo racks & pinions
- Modern body made of composite material
- Traverse made of steel
- Pallet changer without hydraulics
- Raytools Auto Cutting Head
- Interlock closing system
- Class 1 laser safety windows
- Compact dust extractor

OPTIONAL EQUIPEMENT

- HYPCUT Touch FSCUT8000 TwinCAT CNC System
- BECKHOFF TwinCAT Touch Screen Control System
- Graphite Anti-burn Technology.
- Automatic nozzle cleaning 1.0
- Precitec Cutting head (Auto Focus)
- Pneumatic Pipe & Profile Cutting System
- Automatic loading / Unloading system SMART-LIFTER

SPECIFICATIONS

MACHINE DIMENSION AND WEIGHT			
MACHINE MODEL	[um]	3015	4020
length	[mm]	8000	10500
Width	[mm]	2600	3280
Height	[mm]	2250	2250
Weight	[kg]	12000	15000

WORKING AREA			
MACHINE MODEL	[um]	3015	4020
X axis	[mm]	3060	4060
Y axis	[mm]	1540	2050
Z axis	[mm]	100	100
Max.sheet weight	[kg]	1100	1800

1)Approximate values.The exact parameters are specified in the installation plan.

CUTTING HEAD PRECITEC LIGHTCUTTER AUTO FOCUS

- The cutting head LightCutter 2.0 is the perfect solution for efficient and cost-effective laser cutting. The new generation of our Light Cutter family is designed for cutting applications in the medium power range up to 4 kW and is characterized by a high cutting quality for all metals - especially mild steel, stainless steel and aluminum.
- Due to an automated motor-driven adjustment of the axial focus position, the cutting head works precise and stable at all times, even at accelerations of up to 3G.
- The display of the set focus position on the front of the cutting head makes commissioning much easier. The LightCutter 2.0 Motorized covers a large Focus position range of 23 mm.

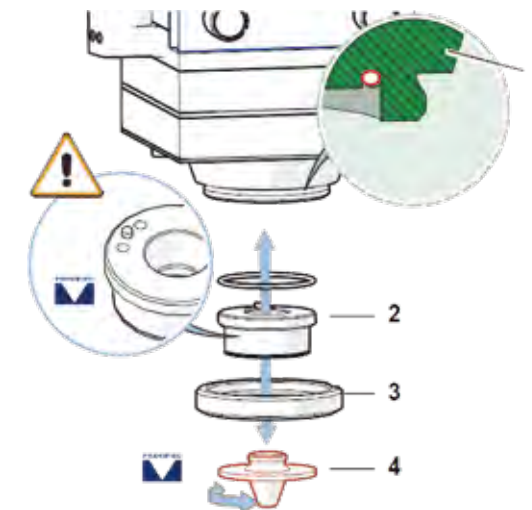

PIERCETEC NEW PROCUTTER 2.0

The new ProCutter 2.0 generation impresses with its increased performance and new automation features. Faster, easier, more efficient, more enduring – this is how laser cutting is shaping up in the new generation, due to numerous developments.

- Motorized focus position adjustment for automatic machine setup and piercing work
- Lightweight and slim design created for fast acceleration and cutting speed
- Drift-free, fast-reacting distance measurement
- Permanent protective window monitoring
- Automated piercing with PierceTec
- Water cooling of the sheet metal with CoolTec
- Completely dustproof beam path with protective windows
- LED operating status display
- Output of all sensor data via WLAN to APP and machine control possible
- Pressure monitoring in the nozzle area (gas cutting) and in the head

Maximum stamina!
It cuts and cuts and cuts...

Faster & more efficient!
Speed ↑ Gas efficiency ↑

Easy parameter finding!
Quality ↑ Process window ↑

More laser-on-time!
Save time and costs.



i
OPTIONAL

BECKHOFF HIGH PERFORMANCE CNC SOLUTION

- The Accurl Masterline Fiber Laser is controlled with a Beckhoff CNC control unit which provides unprecedented control of the cutting process.
- EtherCAT and eXtreme Fast Control (XFC) technology enable fast switching functions at high processing speeds.



PC-BASED CONTROL TECHNOLOGY

- Industrial PC with Multitouch touch screen 19".
- High-speed EtherCAT communication.
- The Beckhoff hardware and software platform
- Integrated retention brake control.
- Automatic adaptation of parameters.
- Adjustable error reaction.
- Motor feedback for absolute position registration.
- Absolute incremental position.



- In combination with the motion control solutions offered by the company's TwinCAT automation software, Beckhoff Drive Technology provides an advanced, all-inclusive drive system.

READY FOR INDUSTRY 4.0

- Industrie 4.0 for sheet metal working with TwinCAT Analytics and TwinCAT IoT

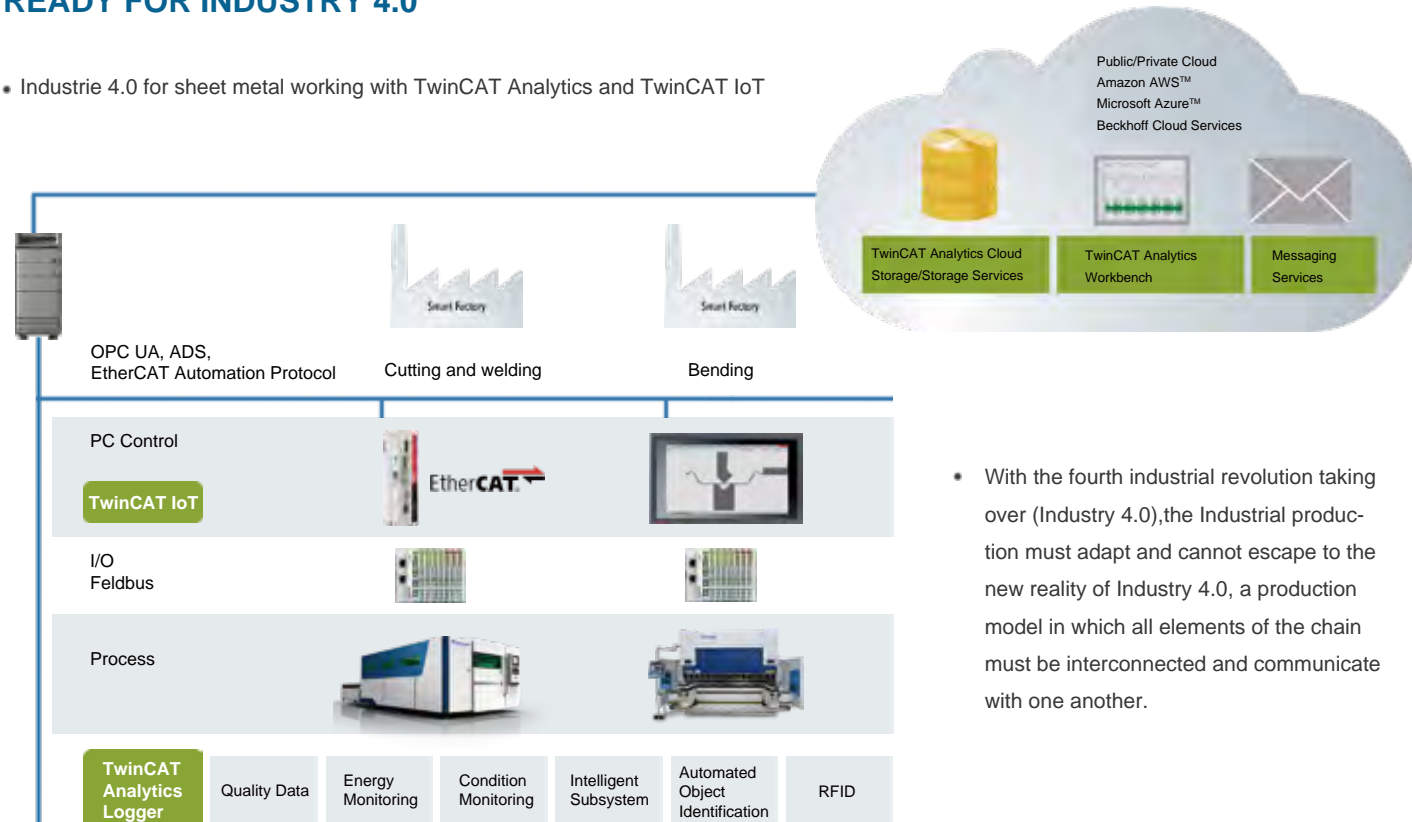

- With the fourth industrial revolution taking over (Industry 4.0), the Industrial production must adapt and cannot escape to the new reality of Industry 4.0, a production model in which all elements of the chain must be interconnected and communicate with one another.

CAD/CAM SOFTWARE .LIBELLULA .CUT

- Libellula.CUT is the cutting edge of Libellula Universe and represents the highest expression of the technological know-how of Libellula.
- Thanks to its integrated CAD and the exclusive One-Click technology, Libellula.
- CUT creates or imports in a moment the geometric details from any other platform of drawing, automatically optimizing profiles and arranging them in an optimum manner for subsequent processing.



Libellula.CUT Is Available For

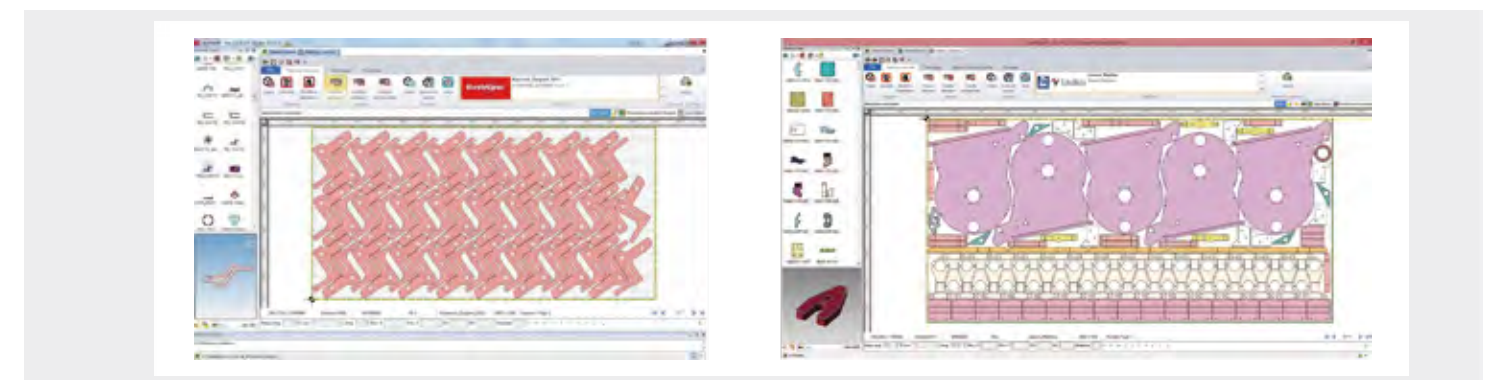

Management of FMS lines and / or of the manual operations:

- Reduction of the cutting number of different nesting
- Automatic Skeleton cutting
- Systems management of loading / unloading and sorting systems

Optimized information for the company with "Total Integration" additional Libellula modules

- Order Management with the option mod.ORDER module
- Warehouse management and reusable remnant with the mod.STORAGE option



TUBE LASER CUTTING

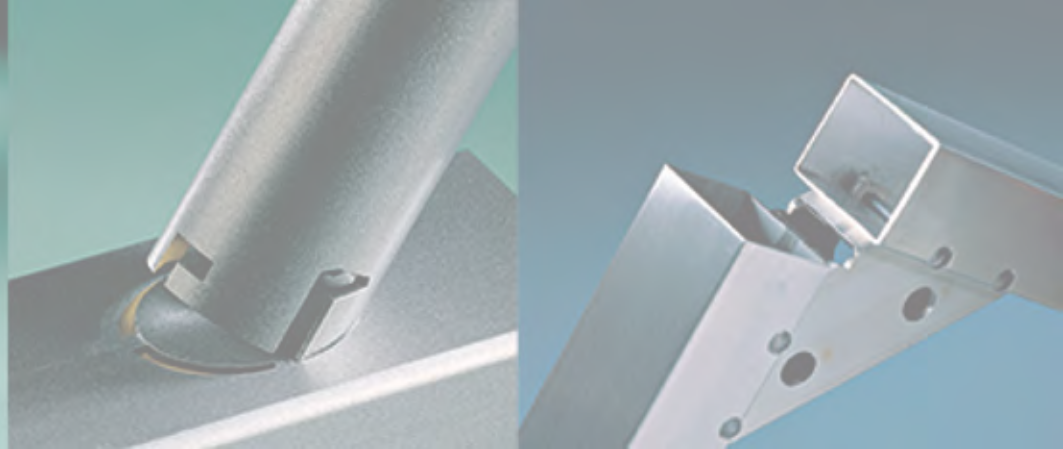

SPECIFICATIONS

WALL THICKNESS 19mm maximum on straight cuts 12.7mm on bevel cuts maximum bevel is 5mm	CONVEYOR SETUP Can queue up to 5pieces of varying material sizes/lengths at a time	DRAWINGS Solid model tubing data can be imported directly via 3D .iges, .satand .step file formats. Manually inputting the tube info,the software is possible but requires more time.
LENGTH 6000mm - 0mm maximum	SMALL PARTS CATCHER Can handle parts up to 698.5mm larger sizes require manual unloading	TOLERANCES Are similar to laser table tolerances +/-0.8mm to +/-0.25mm depending on material

Tube-Cutting Technical Specifications	
Max Diameter (mm)	Ø210
Max Square Tube Dimension(mm)	140x140
Max Rectangular Tube Dimension (mm)	170x120
Min. Diameter (mm)	Ø20 (Ø12 Option)
Max. Tube Length (mm)	6500
Min. Tube Length (for automatic loading)	3000
Max. Tube Weight (kg/m)	37,5
Max. Material Thickness (mm) (for 1kw To 4kw)	0.5-12
Min. Material Thickness(mm)	0,8
Automatic Loading	Optional
Automatic Unloading	Optional
Cutting Head	2D
Amount of Chuck	1
Centering Chuck	Yes
Last Cut Tube Length (mm)	185
Velocity of Driver Chuck (m/dk.)	90
Acceleration of Driver Chuck (m/s ²)	10
Accuracy (mm)	±0,20
Positioning Accuracy(mm)	±0,05
Tube Types	Pipe, Square, Rectangular, Elliptic H, C, U, L

SPECIFICATIONS

TECHNICAL FEATURES(ECO-FIBER)		SmartLine-3015	SmartLine-3015	SmartLine-3015	SmartLine-3015	SmartLine-4020	SmartLine-4020
RESONATOR	Watt	YLR 1000	YLR 1500	YLR 2000	YLS 3000	YLS 4000	YLS 6000
POWER RANGE	%	10-105	10-105	10-105	10-105	10-105	10-105
POWER STABILITY	%	0.5	0.5	1-2	1-2	1-2	1-2
PULSE FREQUENCY RANGE	kHz	5	5	5	5	5	5
LASER WAVE LENGTH	nm	1070 ± 5	1070 ± 5	1070 ± 5	1070 ± 5	1070 ± 5	1070 ± 5
OUTPUT FIBER CORE DIAMETER	µm	100	100	100	100	100	100
EXCITATION	0	Laser diode	Laser diode	Laser diode	Laser diode	Laser diode	Laser diode
COOLING WATER FLOW RATE	l/min	8	8	10	20	20	40
CUTTING CAPACITY (Maximum)							
MILD STEEL	mm	10	12	16	20	25	30
STAINLESS STEEL	mm	4	6	8	10	12	16
ALUMINIUM	mm	3	4	8	8	10	12
COPPER	mm	2	3	6	6	6	8
BRASS	mm	2	3	6	6	6	8
MAXIMUM WORKSHEET DIMENSIONS	mm	3000x1500	3000x1500	3000x1500	3000x1500	4000x2000	4000x2000
MAXIMUM BURDEN CAPACITY	kg	1500	1500	1500	1800	1800	1800
MACHINE AXES	-	4-Axes [X,Y,Z,U]	4-Axes [X,Y,Z,U]	4-Axes [X,Y,Z,U]	4-Axes [X,Y,Z,U]	4-Axes [X,Y,Z,U]	4-Axes [X,Y,Z,U]
AXIAL MOVEMENTS							
X, U AXES	mm	3050	3050	3050	3050	4050	4050
Y AXIS	mm	1530	1530	1530	1530	2050	2050
Z AXIS	mm	150	150	150	150	150	150
ACCELERATIONS							
X, U AXES	G	1.8	1.8	1.8	1.8	1.8	2
Y AXIS	G	1.8	1.8	1.8	1.8	1.8	2
Z AXIS	G	1.8	1.8	1.8	1.8	1.8	2
MAXIMUM AXES VELOCITIES	m/min	170 (simultaneous) (X, Y single axis velocity 120m/min)	170 (simultaneous) (X, Y single axis velocity 120m/min)	170 (simultaneous) (X, Y single axis velocity 120m/min)	170 (simultaneous) (X, Y single axis velocity 120m/min)	170 (simultaneous) (X, Y single axis velocity 120m/min)	170 (simultaneous) (X, Y single axis velocity 120m/min)
POSITIONING ACCURACY	mm/m	± 0.03	± 0.03	± 0.03	± 0.03	± 0.03	± 0.03
REPETITION ACCURACY	mm	± 0.015	± 0.015	± 0.015	± 0.015	± 0.015	± 0.015
SHUTTLE TABLE (Automatic Loading - Unloading Unit)	palette	2 (35 sec)	2 (35 sec)	2 (35 sec)	2 (35 sec)	2 (35 sec)	2 (35 sec)
ASSIST GAS							
OXYGEN	-	0.3-12 Bar	0.3-12 Bar	0.3-12 Bar	0.3-12 Bar	0.3-12 Bar	0.3-12 Bar
NITROGEN	-	0.5-25 Bar	0.5-25 Bar	0.5-25 Bar	0.5-25 Bar	0.5-25 Bar	0.5-25 Bar
DRY AIR	-	0.5-25 Bar	0.5-25 Bar	0.5-25 Bar	0.5-25 Bar	0.5-25 Bar	0.5-25 Bar
CUTTING HEAD	-	PRECITEC	PRECITEC	PRECITEC	PRECITEC	PRECITEC	PRECITEC
CNC	-	FSCUT2000	FSCUT2000	FSCUT2000	FSCUT2000	BECKHOFF CNC	BECKHOFF CNC
CAD/CAM SOFTWARE	-	RADAN CAD/CAM	RADAN CAD/CAM	RADAN CAD/CAM	RADAN CAD/CAM	RADAN CAD/CAM	RADAN CAD/CAM
OPERATION VIA PANEL	-	15" display, alpha numeric keyboard	15" display, alpha numeric keyboard	15" display, alpha numeric keyboard	15" display, alpha numeric keyboard	15" display, alpha numeric keyboard	15" display, alpha numeric keyboard
TOTAL ELECTRIC POWER NECES SITY	kW	17	17	21	31	33.7	33.7
MACHINE DIMENSIONS (L x W x H)	mm	9190 X 3710 X 2200	9190 X 3710 X 2200	9190 X 3710 X 2200	9190 X 3710 X 2200	10150 X 4250 X 2200	10150 X 4250 X 2200
MACHINE WEIGHT	kg	11200	11200	11200	11200	12950	12950

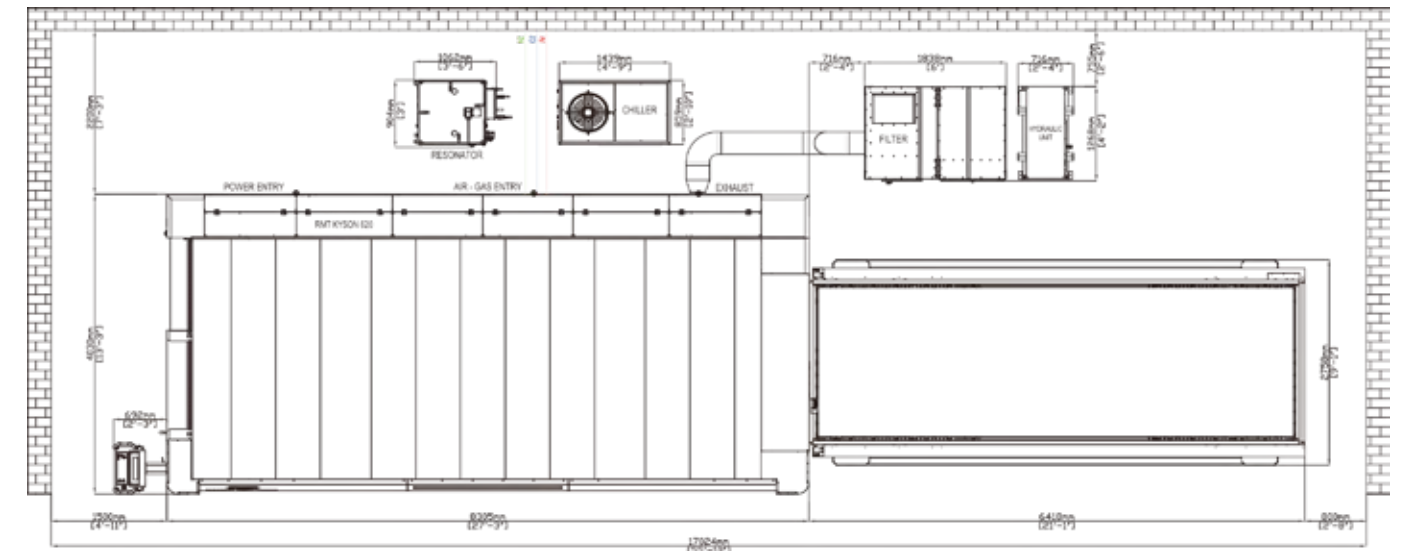

* Different diameter fiber cables are available.
 * Due to ongoing product development, ACCURL reserves the right to modify any technical specifications and dimensions
 * Alternate Optic Configurations: Cutting Capacity may vary depending on optic system settings. Working capacities may be higher or lower depending on the configuration.
 * Conservative cutting capacities may vary depending on optic system settings. Working capacities may be higher or lower depending on the configuration.

HANDHELD LASER WELDING MACHINE OFFER

The machine is compact in design, and the FSC-1000 is only 1/3 of the solid YAG laser welding equipment. Small body shape, free up more space, reduce the cost of equipment to occupy the plant space. Transmission fiber can be optional on demand 5/10/20 meters, up to the range of free-to-adjust.



COMPARE THE PROJECT	THE TRADITIONAL WELDING	LASER WELDING	HANDHELD WELDING
Heat Input to Workpiece	Very high	Low	Low
Deformation and Undercut of Workpiece	Large	Small	Small
Bonding Strength with Base Material	Commonly	Good	Very Nice
Subsequent Processing	Polish	No or Little Polishing	
Welding Speed	Commonly	More than twice of argon arc welding	
Applicable Materials	Stainless steel / Carbon Steel / Galvanized Sheet / Aluminum / Copper		
Consumables	Consumables	Less consumables	Less consumables
Operational Difficulty	Complex	Commonly	Simple
Operator's Safety	Unsafe	Safe	Safe
Environmental Protection Impact	No environmental Protection	Environmental Protection	Environmental Protection
Welding Fault Tolerance	Good	Not good	Good
Spot Brightness Adjustable	None	None	None
Welding Quality Comparison	Difference	Commonly	Very Good
Weld Requirements	Wide	0.2mm	0.2mm

INTRODUCTION OF MAIN COMPONENTS

Compared with traditional arc welding, FSC-1000 enjoy following advantage: user-friendly design and technology upgrade, simple operation, operators do not need skilled technical certificate to achieve exquisite welding. There is no need for secondary grinding after welding, which greatly reduces the professional limitations of the operator and the cost of manpower.



COMPARATIVE	MODEL	FSC 1000	FSC1500
OPTICAL PROPERTIES	Rated Output Power (w)	>1000	>1500
	Operating Mode	Continuous/modulation	
	Polarization direction	Random	
	Output Power Adjustment Range (%)	10-100	
	Center Wavelength (nm)	1080+3	
	Output Power Instability	<3%	
	Maximum Modulation Frequency (kHz)	50	
	Indicates Red Light Power (mW)	>0.5	
	Output Interface	QBH	
	Output Fiber Core Diameter (μm)	20	30/100
Output Fiber Length (m)	15		
ELECTRICAL PROPERTIES	Operating Voltage	220v + 10%、50/60Hz	
	Maximum Power Consumption (w)	<5000	<6000
	Control Method	RS232/AD	
	Size (W x H x D)	483 X 191 X 740	
OTHER PROPERTIES	Weight (kg)	<60	
	Operating Temperature Range (°C)	5-40	
	Operating Humidity Range (%)	<70	
	Type Of Cooling	Water cooling	
	Cooling Water Temperature (°C)	Indoor	
	Cooling Water Temperature (°C)	25	
	Cooling Water Flow (L/min)	>12	>12
	Storage Temperature (°C)	-10-60	

PREEISE CNC PLASMA FLAME CUTTING MACHINE PS SERIES



STANDARD COMPONENTS

- Make up of gas decompression valve and pressure gauge. Clear to check the whole machine pressure.
- Adopt U71 heavy-duty rail by fine machining.
- According to user's requirement, assemble CNC flame single torch, power-spray scribe torch, stamping unit, plasma mechanical torch or linear triple cutting torch, and also fit auto igniter and auto height controller.
- To ensure the beam won't deform, it is designed in welded square structure, tempered to eliminate mechanical stress, and then processed by precision machinery. It has high mechanical strength and good rigidity. High-precision and fine-grounded guide rail, gear wheel and gear rack in high steel quality are assembled on top of the beam. Therefore, the accuracy of lateral movement can be guaranteed. The transverse track is bolted on the beam for the convenience of replacement and adjustment.
- Used in the tracheal cable transmission of numerical control cutting torch, it can work continuously without generating mechanical fatigue.
- To achieve synchronous motion of two supporting plate by steel strip.
- The primary master drive is equipped with horizontal oriented wheel to keep stable guidance in operation. There are scraping crumbs on both sides of the driving shelf. They can clear the guide rail.

MAIN FEATURES

- Beam adopts Q345B welded square steel tube structure with stress release by tempering, it has high intensity and rigidity.
- After precision machining of the surface, the crossbeam has good rigidity and high precision and excellent heat dissipation.
- The product is suitable for equipment with any kinds of CNC systems.



Drilling Head



Shimpo Reducer (made in japan)



Driven System



Hypertherm XPR-170



EDGE® Connect System



Automatic Lubrication Device

SPECIFICATIONS

ITEM	UM	PARAMETER
Track span	mm	Less than 4000 using single driver
Track length	mm	According to customers' requirement
Transverse effective cutting	mm	800 shorter than track span
Longitudinal effective cutting	mm	3000 shorter than track length
Longitudinal rails	m	2m per rail. It may be increased or reduced in accordance with users' requirement
No of torches	set	According to customers' requirement
Cutting speed	mm/min	0-6000
Traveling speed	mm/min	0-12000
Torch lifting range	mm	200
Plasma cutting thickness	mm	Depending on plasma power supply
Flame cutting thickness	mm	6-350

Type	Cutting Table mm	Machine Width min-1	Machine Length mm	Machine Height mm	Table Height mm	Table Width mm	Table Length mm	X Axis Stroke mm	Y Axis Stroke mm	Weight kg
PS 2012	2200 x 12800	4250	14200	2200	750	2200	11200	2800	10200	11000
PS 2016	2200 x 16800	4250	18200	2200	750	2200	14400	2800	16200	13000
PS 2020	2200 x 20800	4250	22200	2200	750	2200	19200	2800	20200	17000
PS 2024	2200 x 24800	4250	26200	2200	750	2200	22400	2800	24200	21000
PS 2028	2200 x 28800	4250	30200	2200	750	2200	27200	2800	28200	25000
PS 2512	2700 x 12800	4750	14200	2200	750	2700	11200	3300	10200	29000
PS 2516	2700 x 16800	4750	18200	2200	750	2700	14400	3300	16200	14000
PS 2520	2700 x 20800	4750	22200	2200	750	2700	19200	3300	20200	18000
PS 2524	2700 x 24800	4750	26200	2200	750	2700	22400	3300	24200	22000
PS 2528	2700 x 28800	4750	30200	2200	750	2700	27200	3300	28200	26000
PS 3012	3200 x 12800	5250	14200	2200	750	3200	11200	3800	10200	30000
PS 3016	3200 x 16800	5250	18200	2200	750	3200	14400	3800	16200	15000
PS 3020	3200 x 20800	5250	22200	2200	750	3200	19200	3800	20200	19000
PS 3024	3200 x 24800	5250	26200	2200	750	3200	22400	3800	24200	23000
PS 3028	3200 x 28800	5250	30200	2200	750	3200	27200	3800	28200	27000
PS 3512	3700 x 12800	5750	14200	2200	750	3700	11200	4300	10200	31000
PS 3516	3700 x 16800	5750	18200	2200	750	3700	14400	4300	16200	20000
PS 3520	3700 x 20800	5750	22200	2200	750	3700	19200	4300	20200	24000
PS 3524	3700 x 24800	5750	26200	2200	750	3700	22400	4300	24200	28000
PS 3528	3700 x 28800	5750	30200	2200	750	3700	27200	4300	28200	32000
PS 4012	4200 x 12800	6250	14200	2200	750	4200	11200	4800	10200	17000
PS 4016	4200 x 16800	6250	18200	2200	750	4200	14400	4800	16200	21000
PS 4020	4200 x 20800	6250	22200	2200	750	4200	19200	4800	20200	25000
PS 4024	4200 x 24800	6250	26200	2200	750	4200	22400	4800	24200	29000
PS 4028	4200 x 28800	6250	30200	2200	750	4200	27200	4800	28200	33000

PRECISE CNC PLASMA FLAME CUTTING MACHINE PS SERIES



STANDARD COMPONENTS

- Make up of gas decompression valve and pressure gauge. Clear to check the whole machine pressure.
- Adopt U71 heavy-duty rail by fine machining.
- According to user's requirement, assemble CNC flame single torch, power-spray scribe torch, stamping unit, plasma mechanical torch or linear triple cutting torch, and also fit auto igniter and auto height controller.
- To ensure the beam won't deform, it is designed in welded square structure, tempered to eliminate mechanical stress, and then processed by precision machinery. It has high mechanical strength and good rigidity. High-precision and fine-grinded guide rail, gear wheel and gear rack in high steel quality are assembled on top of the beam. Therefore, the accuracy of lateral movement can be guaranteed. The transverse track is bolted on the beam for the convenience of replacement and adjustment.
- Used in the tracheal cable transmission of numerical control cutting torch, it can work continuously without generating mechanical fatigue.
- To achieve synchronous motion of two supporting plate by steel strip.
- The primary master drive is equipped with horizontal oriented wheel to keep stable guidance in operation. There are scraping crumbs on both sides of the driving shelf. They can clear the guide rail.

MAIN FEATURES

- Beam adopts Q345B welded square steel tube structure with stress release by tempering, it has high intensity and rigidity.
- After precision machining of the surface, the crossbeam has good rigidity and high precision and excellent heat dissipation.
- The product is suitable for equipment with any kinds of CNC systems.



Drilling Head



Dust Removing Equipment(optional)



Driven System



Hypertherm XPR-170



Connect System



Automatic Lubrication Device



Filter (Optional)

- Capacity: 4000- 8000 - 12000 m³/h.
- Specially designed for extraction and filtration of dust, fume and smoke generated during cutting operation.
- Filter unit assembled and ready to work with motor, fan, control panel and automatic cleaning system.
- Spark separator that minimizes the fire risk is standard for every model.
- Ventilator type santrifuge
- Automatic jet-pulse cleaning Filter
- Low Sound Level



Standard Capacity with MAXPRO 200



Standard Capacity with HPR 130 XD



Standard Capacity with HPR 260 XD



Standard Capacity with HPR 400 XD



Standard Capacity with HPR 800 XD

SPECIFICATIONS

Type	Table Width mm	Table length mm	Height Under Torch mm	Machine Width min-1	Machine Length mm	Machine Height mm	Table Height mm	X Axis Stroke mm	Y Axis Stroke mm	Weight kg	Max. Positioning speed (X-Y) m/min	Total Power consumption (without Plasma system) kw
CPL-1020	1100	2100	150	1850	3420	1710	800	1050	2050	2050	30	4
CPL-1530	1600	3100	150	2350	4420	1710	800	1550	3050	2550	30	4
CPL-2040	2100	4100	150	2850	5420	1710	800	2050	4050	3150	30	4
CPL-2060	2050	6100	150	2200	7420	1710	800	1550	6050	4750	30	4
CPL-2560	2550	6100	150	2850	7420	1710	800	2050	6050	5150	30	4

SERVO CNC TURRET PUNCH PRESS MAX SF SERIES

ACCURL MAX-SF Series CNC Punch Press is the newly developed Multi Index Tools Turret Punch Press equipped with advanced Servo System, introduced by AccurlUSA's professional R&D and production teams who have been dedicated to machineries for decades. With Accurl 30 or 50 tons high speed servo hydraulic punching head, sheet dimensions 2500 x 1300 mm and rotation axis for all tools, the MAX-SF is the perfect CNC turret punching machine. The large fully-brushed sheet support tables and the standard repositioning cylinders, allow for standard sheet sizes to be processed easily.



QUALITY ENGINEERING

All frame configurations are field tested and engineered to last using FEA.

SERVO DRIVE SYSTEM

The punch serve utilizes a direct drive gearbox that supplies power and speed. This servo allows the user to sleeplessly adjust the punch stroke and accommodate any pressure curve requirements.

PROGRAMMABLE RAM

The AC punch servo motor can be programmed for various applications.

- 1.High speed applications
- 2.Low noise applications
- 3.Forming applications.

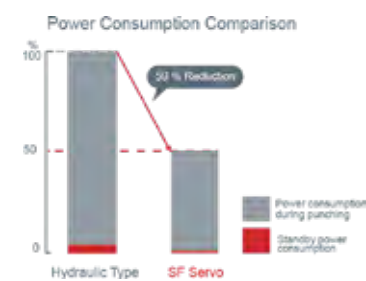

"EXCEED YOUR EXPECTATIONS"



TURRET STRUCTURE

- The ACCURL has a thick turret to provide improved accuracy and longevity of the tools.
- The turret itself is made of s50C and undergoes rigorous testing.
- The turret comes with 4 main layouts from 32 stations to 42 up to 4 auto indexing stations.
- Permanently engaged auto index drive system reduces errors and avoids downtime.
- The auto indexable stations have a dual lead worm structure. The worms are custom machined in pairs and are highly accurate. The worm gear's side clearance can be controlled under 0.0008 " and can be adjusted for wear.



FANUC CNC CONTROLLER

The ACCURL turret punch comes with a FANUC Oi-PF LCD mounted controller. The setup includes an ACCURL operator panel and FUNUC MDI panel.

The FUNUC controller allows for precise and reliable machine control, as well as providing a way to monitor secondary systems and keep track of maintenance tasks.



Sheet jam protectors automatically detects deformed or buckled sheets and automatically stops the machine when triggered.



Automatic clamp positioning reduces setup time and errors, and provides machine run-time flexibility and productivity.



CAD/CAM NESTING SOFTWARE

The G-code for the Oi-PD controller can be generated from nesting software. The operator may nest multiple parts, maximize sheet utilization and streamline their workflow to ensure their turret punch is working in peak condition.

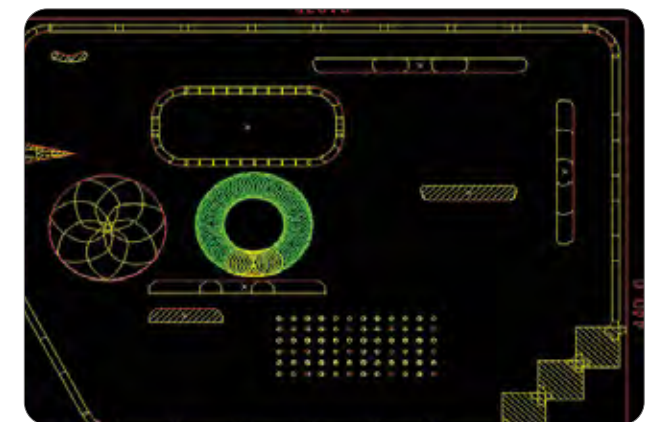

SERVO CNC TURRET PUNCH PRESS MAX SF SERIES



OPTIONAL FEATURES

The ACCURL can be equipped with a variety of productivity enhancing features.

Auto clamp repositioning

Auto part-drop table and work chute

Auto-feed Conveyor and parts bin

ACCURL ultra package, reduce part processing time by up to 40%.

TURRET CONFIGURATIONS

32 Stations 2 Auto index: Our entry level turret offers a full set of tooling with two auto indexing stations.

32 Stations 3 Auto index: With one flex station, the 32 station turret can be upgraded with an additional auto index D station.

42 Stations 4 Auto index: Our most flexible design comes with four auto indexing stations to offer the most advanced material processing capabilities.



i
OPTIONAL



i
OPTIONAL

TABLE SIZES & FLOOR PLAN		
X-Y Travel	X	Y
5x4	110"(2810mm)	219"(5550mm)
5x8	209"(5310mm)	219"(5550mm)
5x10	252"(6410mm)	219"(5550mm)
6.5x4	110"(2810mm)	266"(6750mm)
6.5x8	209"(5310mm)	266"(6750mm)
6.5x10	252"(6410mm)	266"(6750mm)

TURRET CONFIGURATIONS					
Turret Configuration	A	B	C	D	B-AI
32 Station-2 Auto Index	18	8	2	2	2
32 Station-3 Auto Index	16	12	1	0	3
42 Station-4 Auto Index	20	16	2	2	4



VACUUM ASSIST SYSTEM

The optional Vacuum Assist System increases machine reliability by reducing slug pulls and improves material processing.



MIXED BALL AND BRUSH TABLE

The standard configuration features a mixed ball and brush table that comes with an integrated pneumatic ball transfer table to ease loading and unloading.

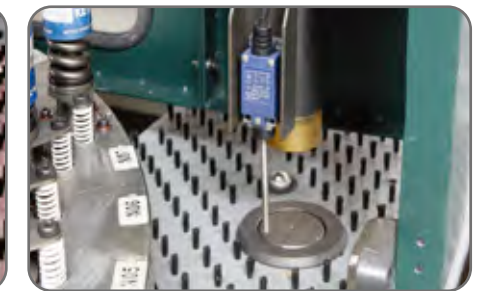

SHEET JAM PROTECTORS

Sheet Jam Protectors automatically detects deformed or buckled sheets and automatically stops the machine when triggered.

SPECIFICATIONS

Item	Unit	MAX-SF-30T	MAX-SF-40T
Punching Capacity	Ton	30	40
X Traverse Length	mm	2500±10	2500±10
Y Traverse Length	mm	1250±10	1250±10
Max Sheet Size	mm	1250x5000	1250x5000
Max Sheet Thickness	mm	6.35	7.35
Max Sheet Weight	kg	110	160
X Axis Traverse Speed	m/min	120	100
Y Axis Traverse Speed	m/min	105	80
Max Traverse Speed	m/min	128	105
Punching Speed at 25mm Pitch	Hist/min	450	380
Nibbling Speed	Hist/min	1200	1050
Tools Type		Thick Turret	
Max Punching Diameter	mm	88.9	
Number of Tool Stations		32 / 42	
Number of Auto Index Stations	Pcs(type)	4(2B+2C) / 3(2B+1C) / 2(2B)	
Turret Rotating Speed	rpm	33	33
Auto Index Rotating Speed	rpm	100	100
Ram Stroke Distance	mm	0~31	0~31
Working Tables Size		Brush + Supporting Ball Set	
Number of Sheet Clamps	Pcs	3	3
Air Supply	NL/min	250	250
Air Pressure	bar	6	6
Size of Control Cabinet	mm	1350x700x2185	
CNC Controller		FANUC Oi-PF	
Number of Controllable Axes	Axis	4	
RAM Memory	KB	512	
Serial Interface		RS232/RJ45/PCMCIA	
Punching Precision	mm	±0.1	
Machine Dimension (L x W x H)	mm	5940x5220x2420	5940x5220x2420
Net Weight (approx.)	kgf	13,500	15,800

CNC WATERJET CUTTING MACHINE MAX-WJ-3015L

The ACCURL® abrasive waterjet machine is a high-pressure waterjet machine that utilizes straight water cutting or abrasive waterjet cutting to cut several types of material. The ACCURL® Water-Jet is a heavy-duty precision, ground ball screw designed system for maximum precision and rigidity.



STANDARD EQUIPEMENT

- WEIHONG® 17" Multi-Touch Displays Control System
- YASKAWA® Highly dynamic EtherCAT servo drive
- HYPERTHERM® High Pressure Pump 50 HP/4200 bar
- ACCURL® Abrasive backstop system CUT CONTROL 3.0
- ACCURL® Abrasive regulation-ABRASIVE 3.0
- Automatic Abrasive feeder with 200L capacity
- ACCURL® Collision Protection 2.0
- Declaration of conformity and CE marking

OPTIONAL EQUIPEMENT

- MAX 3D 5-Axis Bevel Cutting Head 2.0
- Water Jet Soften Treatment
- Auto Sludge Removal System
- IGEMS 3-Axis CAM Minimum 3X Nesting Software
- IGEMS 5-Axis CAM Normal 3D-5XB Nesting Software
- HYPERTHERM® HyPrecision® 75S Pump of 75 HP
- ITALY ESA S600W Series CNC Control system

SPECIFICATIONS

MACHINE DIMENSION AND WEIGHT		
MACHINE MODEL	[um]	3015
Length	[mm]	4250
Width	[mm]	2260
Height	[mm]	1900
Weight	[kg]	2850

WORKING AREA			
MACHINE MODEL	[um]	3015	4020
X axis	[mm]	3060	4060
Y axis	[mm]	1540	2050
Z axis	[mm]	100	100
Max.sheet weight	[kg]	1100	1800

1)Approximate values.The exact parameters are specified in the installation plan.

NEW ESA S600 SERIES CNC WITH COMMAND CONTROL

The ACCURL Waterjet machine is controlled with a ESA S600 PC series CNC control unit which provides unprecedented control of the cutting process.and Real time graphics: the program is provided with a manual and/ or an automatic zoom to visualize the plate contour.



CHARACTERISTICS:

- High Performance AMD Embedded GX-42CC 2,4GHz .
- 19" Multi-Touch (PCAP).
- Absolute position registration.
- Current value output of absolute incremental position.
- Integrated retention brake control.
- Automatic adaptation of parameters.
- Adjustable error reaction.
- Motor feedback for absolute position registration.
- Absolute incremental position.

IGEMS CAM-SOFTWARE

The IGEMS is a modular CAD, CAM and nesting software designed especially for waterjet cutting purposes. Thousands of people around the world use it to make anything they want.



CAD/LAM

- The main 2D CAD functionality similar to AutoCAD
- Support for multiple file formats (DWG, DXF, WMF, CNC, TTF)
- Special commands for drawing completion and optimization
- Support for TTF font formats, CXF and SHX
- Transfer images from raster to vector format
- Parametric parts (elements) Library

NESTING

- Useful manual nesting tools with collision control
- Automatic nesting to fill sheets efficiently



HIGH SAVING OF TIME AND MONEY
THANKS TO THE SOLUTIONS OF NESTING
AND AUTOMATIC CUTTING

MAXIMUM PRODUCTIVITY
WITH MINIMUM SCRAP

SYSTEM SPECIFICATIONS COMPARISON

Our advanced Hypertherm pump technology provides 30% more nozzle horsepower than intensifier pumps. This added power means you can produce parts faster and at lower costs.



	HyPrecision™ 505		HyPrecision™ 605		HyPrecision™ 735		HyPrecision™ 1000		HyPrecision™ 1500	
	50 Hz	60 Hz	50 Hz	60 Hz	50 Hz	60 Hz	50 Hz	60 Hz	50 Hz	60 Hz
Maximum output flow	3.79 lpm	4.16 lpm	4.54 lpm	4.92 lpm	5.68 lpm	6.06 lpm	7.95 lpm	8.33 lpm	11.36 lpm	12.11 lpm
Maximum orifice	0.356 mm	0.38 mm	0.406 mm		0.432 mm	0.457 mm	0.508 mm	0.533 mm	0.610 mm	0.635 mm
Continuous output pressure	Adjustable to 60,000 psi (4137 bar)						Adjustable to 60,000 psi (4137 bar)			
Intensifier configuration	Single						Dual			
Pressure control	Panel-mounted Dual Manual						Electronic Proportional			
Bleed-down valve	Hydraulic						Hydraulic			

	37.3 kW		44.7 kW		56 kW		74.6 kW		111.9 kW	
	400 V	208-230/460 V	400 V	460 V	400 V	460 V	400 V	460 V	400 V	460 V
Full load	73 A	138-125/62 A	75 A	71.1 A	103 A	87.1 A	138.8 A	117.5 A	204 A	173.4 A
Main breaker	80 A	150/80A	100 A		125 A	100 A	150 A		225 A	
Soft start	True Soft Start						True Soft Start			

Overall width * length * height	1016 * 1930 * 1422 mm				1143 * 2184 * 1422 mm				1397 * 2057 * 1422 mm	
Approximate operating weight	1406 kg		1497 kg		1882 kg		2767 kg			

OPTIONS	External air-over-oil cooling	
	Chiller for oil cooling	Chiller for oil cooling
	Redundancy	Water isolation valves / Water and hydraulic isolation valves
	Redundancy ready	-
	Electronic proportional pressure control	-



	YCG-3038	YCG-3742S	YCG-7542S
Max Pressure	380Mpa/55.000Psi	420Mpa/60.000Psi	420Mpa/60.000Psi
Max Water Flow	3.7L/min	3.7L/min	7.4L/min
Max Orifice	0.28mm/0.011"	0.33mm/0.013"	0.40mm/0.016"
Max Nozzle	0.76/0.03"	1.02/0.04"	1.27/0.05"
Power	30Kw/40Hp	37Kw/50Hp	75Kw/100Hp



THE MAX 3D 5-AXIS CUTTING HEAD 2.0

The 3D cutter head has five axes, 3 linear and 2 rotating. It has been designed for both pure 3D cut and 2D 1/2 cut (flat cut with bevel), without losing 2D (flat) cut functionality. Its design features offer great work possibilities. Especially its infinite rotation in the C axis, which avoids the need to rewind with a consequent reduction in working times and a lower risk of reducing the cut quality. On the rotating frame of the C-axis, it is possible to connect the height adjustment and anti-collision control module.



5-Axis Cutting Head

C axis	
Effective range	Infinite
Max positioning speed	300 min-1
A axis	
Effective range	± 60°
Max positioning speed	500 min-1

L-SERIES INTEGRAL GANTRY TYPE

Lathe bed and water tank are non-detachable, After the heating-treatment of whole machine table (to eliminate the stress of 95%), it is much better than the VSR(to eliminate the stress is 35%), It can ensure the accuracy and stability in long time.

Model		MAX-WJ -1010L	MAX-WJ -1313L	MAX-WJ -2030L	MAX-WJ -2040L	MAX-WJ -4030L	MAX-WJ -6020L	MAX-WJ -8030L	
Effective Cutting Area	mm	1000 x 1000	1300 x 1300	2000 x 3000	2000 x 4000	4000 x 3000	6000 x 2000	8000 x 3000	
Axis travel	X axis	mm	1000	1300	2000	2000	4000	6000	8000
	Y axis	mm	1000	1300	3000	4000	3000	2000	3000
	Z axis	mm	150-180	150-180	150-180	150-180	150-180	150-180	150-180
Cutting accuracy	mm	+/- 0.1							
Positioning accuracy	mm	+/- 0.02							
X,Y dry-run speed	m/min	0-15 (if need 30m/min speed,we can do as request)							
Cutting speed	m/min	as to detail material and thickness							